

# INSTRUCTIONS

## Introduction

Thank you for choosing super mini True Wireless Stereo Bluetooth headset. Fashionable appearance design, powerful functions and high compatibility. Headphones with IP67 waterproof waterproof. It makes you achieve the wonderful experience of using wireless which is your best choice in driving, indoor and outdoor.

This model is combined by "intelligent headset" and "intelligent Powerbank", it's the best choice for mobile phone. It's super mini, not only can be used as a car Bluetooth headset, also can be emergency powerbank. Portable design, you don't need wear the headset all the time, and can keep full battery state.

Bluetooth wireless technology allows you to easy and fast pairing with smart phones, tablets and other Bluetooth enabled music devices; True wireless Stereo paring via Bluetooth 4.1: Pairing 2 cordless earbuds wirelessly is now possible, making it the smallest sterer Bluetooth headset on the market. Bluetooth 4.1 with advanced audio decode technology enables wireless connections to your smartphone and other Bluetooth devices and gives thses ultra-small stereo wireless headphones umparalleled sound quality.

## Products Features:

1. Sleek and Innovative Lipstick-Style Portable Charging System.
2. 2 in 1 Bluetooth headset and Bluetooth charger, necessary for driving/work/indoors/outside sports.

3. The main body of the aluminum alloy wire drawing, super texture, ultra-high vision, colorful
4. CVC noise Isolation technology reduces outside noises, enable clearer microphone sound.
5. Built in 850mAh mobile power
6. CSR chip, low power consumption, multi compatibility
7. Stunning LED lights, can display different working conditions
8. Support call hands-free function
9. Optimized circuit design, the product has over-current protection, short circuit protection function, no damage to equipment

## Products Specification:

Bluetooth Version: V4.2, CSR64110.

Bluetooth Profiles: HSP, HFP, A2DP and AVRCP profiles.

Bluetooth transmission range: 10 m

Powerbank Battery: 850 mAh

Earphone battery: 45 mAh

Earphone Total Standby time: 2000 hours

Earphone charge time: 1 hour

Earphone Non-stop talking Time: 4 hours

Earphone total Talking time :100 hours

Powerbank input voltage: 5 V

Transmission frequency: 2402 – 2480MHZ

## User Manual

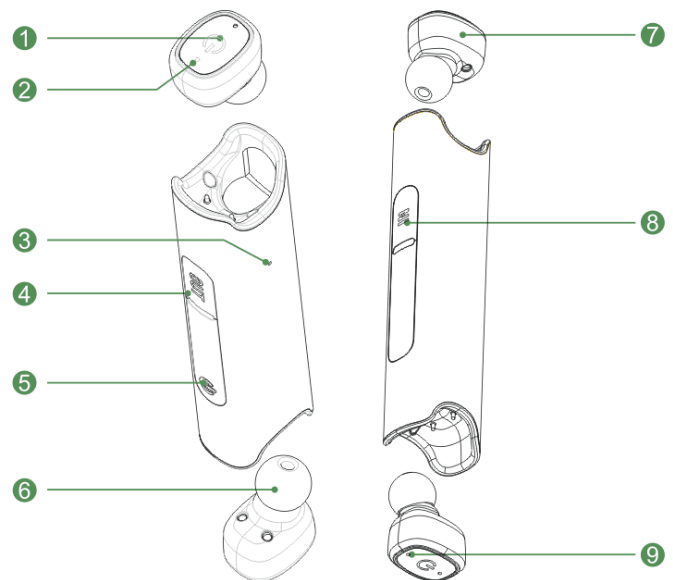

## Component:

- |                                |                      |
|--------------------------------|----------------------|
| 1. Home-Key                    | 6. Earplugs          |
| 2. LED indicator light         | 7. earphone Silicone |
| 3. Power supply indicator lamp | 8. Charging input    |
| 4. Charger output              | 9. conversation hole |
| 5. PowerKey                    |                      |

**Warm prompt::** Please tear up the insulating membrane protector on

the earphone before using the Bluetooth headset.

**Power on:** Long press home key until the blue indicator light flash, then you will hear voice prompt “power on”.

**Power off:** Long press Home-key until the red Indicator light on 2 second, then you will hear voice prompt “power off”.

**Chinese/English Language switch:** Long press the headset to the shutdown (ater the long light red light)

**Standby in no connection:** Blue lights quickly flash 4 seconds twice.

**Connected:** Blue lights flash 4 seconds once.

**Coming calls:** Blue lights flash quickly.

**Talking:** Blue lights flash 4 seconds once.

**Music:** Blue lights flash 4 seconds once.

**Disconnect:** Blue lights quickly flash 4 seconds twice.

**Calls:** press key once Note:Conversation by telephone is only the main earphone

**Reject Calls:** Press home key about one seconds when call coming.

**Recalling the last call:** Double-click the home key.

**Re-connection:** Auto reconnect the paired phone once when turned on (some mobiles need to manual to reconnect on the phone)

### Bluetooth pairing (single ear connection)

1. Long press the headset to red and blue lights flashing
2. Open the phone Bluetooth, mobile search to S2 click on the phone connection

### Bluetooth Pairing (dual headset):

1. Two headphones to open the state, the two headphones need 1-3 seconds of automatic interconnection (red light flashes for the 2 time into the blue lights flashing)
2. One of the headphones is pressed to the red and blue lights. Open the phone Bluetooth, mobilephone search to S2 click on the phone connection. After the success of the headset into the blue light flashing
- 3 After the headset is not power, please charge the boot, will automatically connect the phone
4. Mobile phone Bluetooth to remove memory S2, press 1 - 2 steps to re connect the operation can be

### Note

If there is one earphone no sound.Turn off the phone, Turn off two Bluetooth headset, boot Bluetooth headset , each click of a headset into red and blue lights flashing, 1-3 seconds after the two headset pairing successfully entered the blue light single flash . Then press 1-2 steps to connect the phone

### How to pair with 2 Bluetooth devices at a time?

1. Pairing and connect with A smart phone.
2. Turn off smart phone Bluetooth function.
3. Pairing and connect with B Smart phone.
4. Turn on A smart phone Bluetooth function.
5. Reconnect the A smart phone or manual to click to make sure reconnect (pls make sure the smart phone have reconnect

function)

6. Already connect A and B smart phone at a time.

### Chargers and batteries:

Before charging the headset please check if the specification of the charger label is on accordance with the requirements. If charging voltage is too high it is very likely to damage the power bank.

### Warning:

This headset built-in non-removable rechargeable batteries. Please do not take out the batteries from the headset, otherwise the headset will be damaged. When the headset or power bank is not be use for a long time, please put it in a dry place with good ventilation, and charge it one time in two months.

### Package includes:

- 2 Bluetooth Earbuds
- 1 Portable Charging Case
- 1 USB Charging Cable
- 3 Ear Tips: Small, Large
- 1 User Manual

Warranty: One year

### Headset into the charging bin diagram

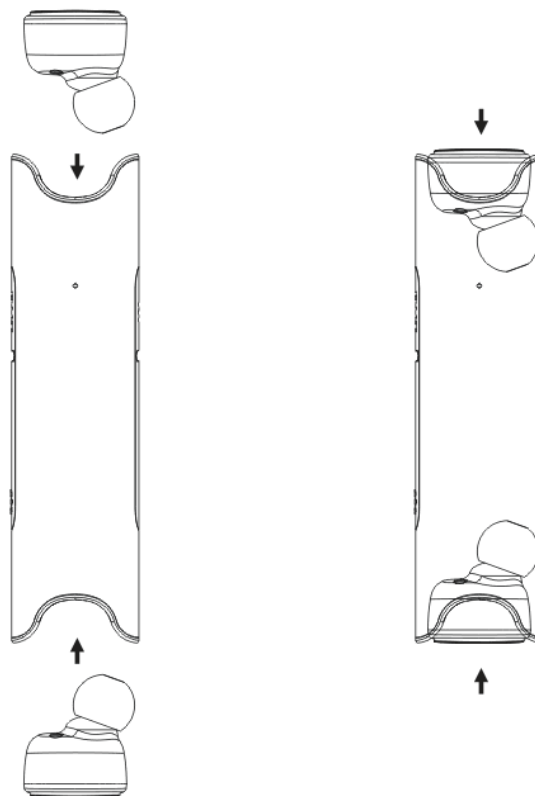

## Headset schematic

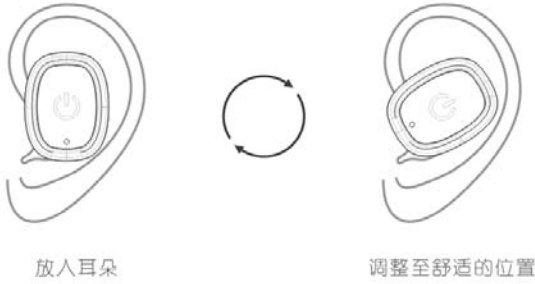

## After sales service

This headset adopts and power bank built-in non-removable rechargeable batteries. Please do not try to take out the batteries from the headset or powerbank in order to avoid damage to the headsets or powerbank. When the headset or power bank is no using for a long time, please put it in a dry place with good ventilation, and recharge it every two months.

## Regular problems and solutions

Problems description	Cause	Solution
Can not Start	The power used up	Charge the battery fully before use
	Press home button too short	Press the home key for 3 seconds to re-start the headset
Can not charge	Plug is not placed well	Check the plug well
Can not find the headset when searching pairing devices	Not enter pairing state	Till the red/blue light flash alternately
	The headset is not in searching status	Set the headset on searching status
	Mobile phone bluetooth software error	Close the mobile phone and re-start

## After sales service

Our company provides the guarantess in strict accordance with state regulations:

The warranty period is one year.

Our products do not provide unsalable goods refund, replacement services.

When met problems when using, please contact lalac salesagent to

deal with, for the following circumstances can not guaranteed free of charge:

1. Fragile label altered tore.
2. Touched By liquid, Damaged by water.
3. Deformed seriously by outside force.
4. Damage be wrongly operation or bad reserved.
5. Damage caused by accident or carelessness.
6. Damage caused by commercial purpose and with non normal using conditions.
7. Other situation similar to the above.

## FCC Statement

This equipment has been tested and found to comply with the limits for a Class B digital device, pursuant to part 15 of the FCC rules.

These limits are designed to provide reasonable protection against harmful interference in a residential installation. This equipment generates, uses and can radiate radio frequency energy and, if not installed and used in accordance with the instructions, may cause harmful interference to radio communications. However, there is no guarantee that interference will not occur in a particular installation.

If this equipment does cause harmful interference to radio or television reception, which can be determined by turning the equipment off and on, the user is encouraged to try to correct the interference by one or more of the following measures:

- Reorient or relocate the receiving antenna.
- Increase the separation between the equipment and receiver.
- Connect the equipment into an outlet on a circuit different from that to which the receiver is connected.
- Consult the dealer or an experienced radio/TV technician for help.

To assure continued compliance, any changes or modifications not expressly approved by the party.

Responsible for compliance could void the user's authority to operate this equipment.

(Example - use only shielded interface cables when connecting to computer or peripheral devices).

This equipment complies with Part 15 of the FCC Rules. Operation is subject to the following two conditions:

- (1) This device may not cause harmful interference, and
- (2) This device must accept any interference received, including interference that may cause undesired operation.

RF warning statement:

The device has been evaluated to meet general RF exposure requirement. The device can be used in portable exposure condition without restriction