

## USER GUIDE

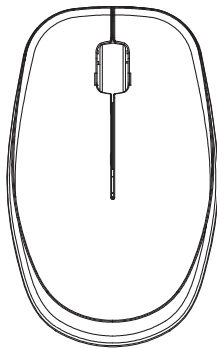

Mouse FCC ID: 2AL4MV8MS1A  
Dongle FCC ID: 2AL4MV8RX1A

## WIRELESS MOUSE

### Before Use

Notes:  
All parts have to be unpacked and the packaging material has to be removed completely. Before use, verify the package contents are complete and undamaged.

### BATTERY WARNING STATEMENT

Do not mix old and new batteries.  
Do not mix alkaline, standard (carbon-zinc), or rechargeable (ni-cad, ni-mh, etc) batteries.

### FCC Statement:

This device complies with part 15 of the FCC Rules. Operation is subject to the following two conditions:

- (1) This device may not cause harmful interference, and
- (2) this device must accept any interference received, including interference that may cause undesired operation.

NOTE: This equipment has been tested and found to comply with the limits for a Class B digital device, pursuant to part 15 of the FCC Rules. These limits are designed to provide reasonable protection against harmful interference in a residential installation.

This equipment generates, uses and can radiate radio frequency energy and, if not installed and used in accordance with the instructions, may cause harmful interference to radio communications. However, there is no guarantee that interference will not occur in a particular installation.

If this equipment does cause harmful interference to radio or television reception, which can be determined by turning the equipment off and on, the user is encouraged to try to correct the interference by one or more of the following measures:

- Reorient or relocate the receiving antenna.
  - Increase the separation between the equipment and receiver.
  - Connect the equipment into an outlet on a circuit different from that to which the receiver is connected.
  - Consult the dealer or an experienced radio/TV technician for help.
- Changes or modifications not expressly approved by the party responsible for compliance could void the user's authority to operate the equipment. This device has been evaluated to meet general RF exposure requirement. The device can be used in portable exposure condition without restriction.

### System Requirements

- \* Windows 7/8/10 or newer version, Mac OS 10.5 or newer version and Chrome OS
- \* Available USB port or Bluetooth®

### What's in the Box

- 1 Wireless Mouse
- 1 USB nano receiver
- 1 AA battery

### Specification

- 3 clickable buttons with 1600 DPI sensitivity
- Connect to up to 3 devices simultaneously with Bluetooth® wireless technology or a USB nano receiver (stores in battery compartment when not in use)
- USB plug and play
- Scroll wheel
- On/off switch
- Easy switch for switching connection: 2.4Ghz/Bluetooth® 1/Bluetooth® 2
- Windows, MacOS, ChromeOS, Android, iOS compatible

### Functional Introduction

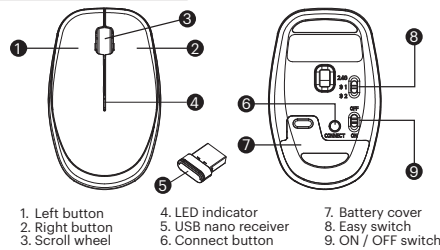

1

### Switch Connection Channel

This mouse can be connect with up to 3 different computers  
Use "Easy switch" to change connection channels in between USB nano receiver and 2 other Bluetooth channels

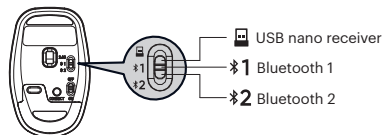

### Switch Devices

You can set  
USB nano receiver ( ) on computer A  
Bluetooth 1 (#1) on computer B  
Bluetooth 2 (#2) on computer C  
and use "Easy switch" to switch connection in between these 3 computers

### Connect button

Press and hold this button to set the mouse in Bluetooth pairing mode, also for reconnect to a paired device

### Installing Batteries

Insert the battery with the correct position according to the instruction labeled on the mouse

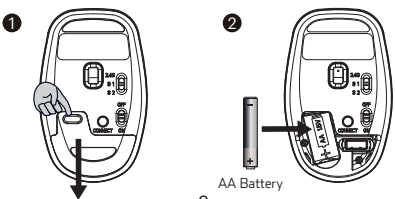

2

### Connection Setup

#### Connect via USB nano receiver

It is plug and play for USB nano receiver, make sure to turn on power and set connection channel on USB nano receiver ( ) then just plug in USB receiver into available USB A port on your computer and you are ready to go

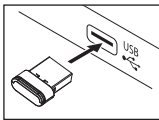

#### Trouble shooting

If it is not working, try steps below to reconnect mouse and receiver

1. Turn off your mouse and re-plug in USB receiver, turn power back on (make sure channel is set on )
2. **Press and hold** "Connect" button (keep mouse close to receiver)  
LED indicator will start flashing in green for 10 seconds and turn off when its connected
3. If it does not work after 10 seconds, repeat step 1 and 2

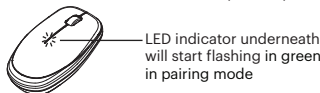

#### Connect via Bluetooth in Windows

Turn on your mouse and set it on either Bluetooth 1 (#1) or Bluetooth 2 (#2)  
Click on "Start" (bottom left corner on your screen)

Go to Settings

- > Device
- > Bluetooth & other devices
- > Turn on Bluetooth
- > Add Bluetooth or other device
- > Add a device (Bluetooth)

**Press and HOLD** "Connect" button to set mouse in pairing mode (LED will start flashing) Click on "BT5.1 Mouse" in the list on your computer to setup pairing, LED will stop flashing and light up for 3 seconds when it is completed

3

### Low Battery

If this LED starts blinking, it means you need to change battery

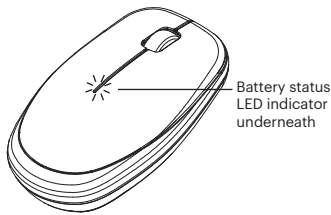

8