

SwitchBot Curtain

User Manual

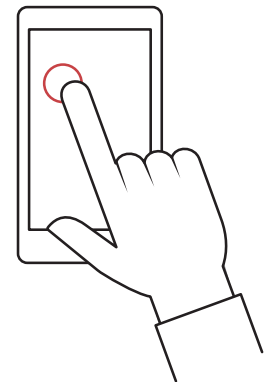
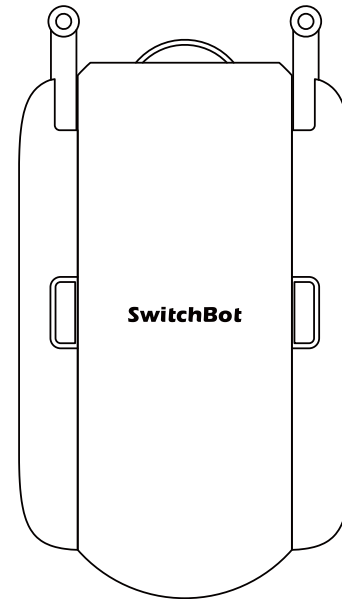

www.switch-bot.com

Installation



Step 1: Add Device

After downloading the App, go to Add Device from the left side menu. Then select Curtain. Follow the App instruction and add your device.

Select the Right Curtain Track

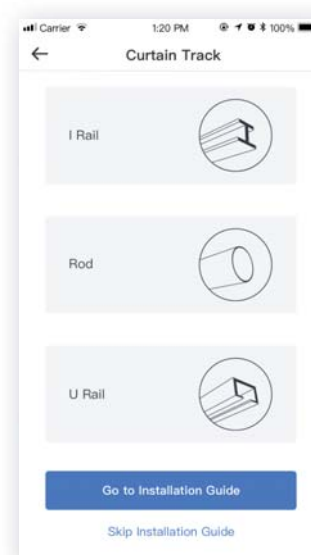

I Rail

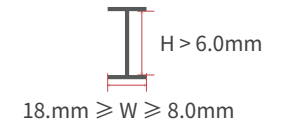

Rod

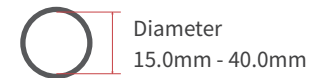

U Rail

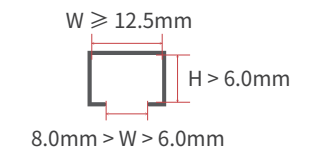

Select the Right Open Mode

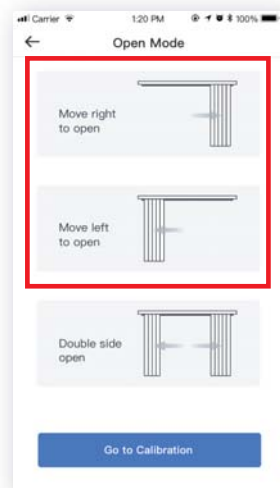

For single side curtain, tap “Move right/left to open” depending which side you want to open your curtain.

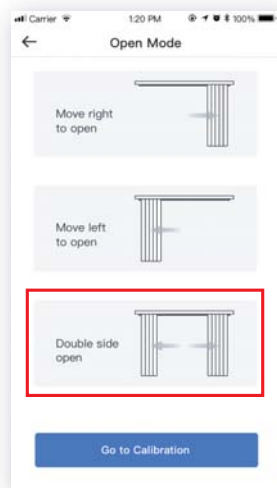

For double side curtain, tap “Double side open”.

Step 2: Install on Your Curtain Track

Retrofitting is simple with SwitchBot Curtain. It only takes a few seconds to make your existing curtains smart. It is straight forward and intuitive with our App instruction.

1. Press and push the clip at the front of the right Hook to detach the Hook from the main body. Please make sure the left Hook is still attached to the main body.
2. Please fully close your curtain and then take down the first clip on your curtain.
3. Make sure the wheels on the left and right Hooks are parallel to your curtain track so you can insert the wheels gently into the curtain track. The SwitchBot LOGO should face indoor.
4. After you insert the wheels into the curtain track, twist both Hooks 90° outwards.
5. Pull the Hooks and main body down with a little force and attach the right Hook back to the main body. You should hear the clip sound. To make sure the Curtain is firmly installed, please move the Curtain by hand along the curtain track and make sure it doesn't fall or detach.

Install the Velcro (Optional)

To use 1 SwitchBot Curtain with double side curtain, you need to use the Velcro to connect the 2 panels of curtains and make them 1 panel. Fully close the curtain so the 2 panels are closest to each other. Find the right most clip of your left panel and the left most clip of your right panel. Then connect the 2 clips with Velcro. Draw the curtain back and forth to make sure the Velcro is tightly connecting 2 clips. Now you can go to Add Device, select Open Mode “Move left/right to open” and set up following the App instruction.

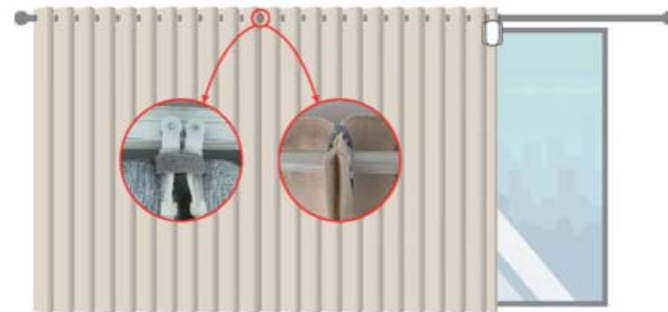

Step 3: Calibration

Calibration is for your Curtain to adapt to your existing curtain track. You need to calibrate before finishing the Installation or every time you change the Open Mode. You may re-calibrate after installing within the Settings.

Control

Lots of convenient ways to control, at your will.



App Control

Open and close the curtain at your fingertip. We offer intuitive App control for iOS and Android, with weekly/bi-weekly updates following feedback from you. OTA firmware update is also available for better user experience.



Touch & Go

Even with SwitchBot Curtain, you'd probably still instinctively draw the curtains by hand sometimes. When it senses you drawing the curtain, the SwitchBot Curtain will kick in and do the work for you. We call this Touch & Go.

Voice Control and Home Automation*

Smart living is powered by your voice commands.

Wouldn't it be great to just say it?

“Alexa, close the curtain.”

“OK Google, close my bedroom curtain.”

“Hey Siri, open the living room curtain.”

* Require SwitchBot Hub Mini (sold separately).



Control with SwitchBot Remote (Sold Separately)

A wireless remote add-on for you to place anywhere.

App Control

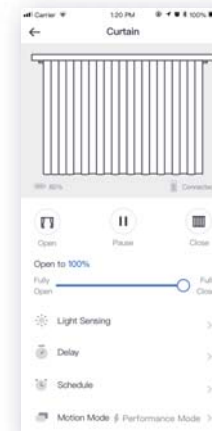

Single side curtain



Double side curtain



App Store



Google play



Touch & Go

Even with SwitchBot Curtain, you 'd probably still instinctively draw the curtains by hand sometimes. When it senses you drawing the curtain by more than 5 cm*, the SwitchBot Curtain will kick in and do the work for you.

For double side curtain, drawing on one side of curtain will trigger both curtains to open or close simultaneously.

“Touch & Go” is turned on by default. To turn off, go to “Advanced Settings”, and turn off “Touch & Go”.

* 5 cm is the best threshold we tested because it lowers the possibility of false trigger by your cats and dogs.

Voice Control and Home Automation*

You need to turn on Cloud Service in Settings and then connect respective service. Voice command can trigger fully open and fully close.

Alexa, close the curtain.

OK Google, close my bedroom curtain.

Hey Siri, open the living room curtain.

* Require SwitchBot Hub Mini (sold separately).



SwitchBot Scene

You can set up SwitchBot Scene for home automation within the SwitchBot eco-system when you turn on the Cloud Service within the Settings. There are unlimited possibilities.



Curtain

Remote

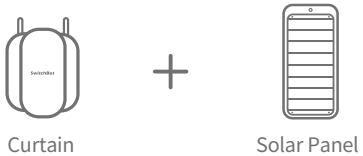

Curtain

Solar Panel



Curtain

Hub Mini

Meter

Control with SwitchBot Remote (Sold Separately)

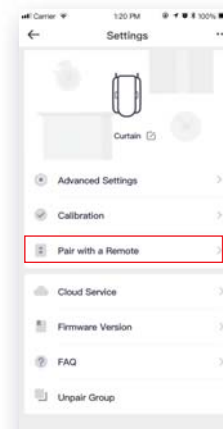

You can pair a Remote in the Settings. Please place your phone, Remote and Curtain close to each other before pairing. The rule of thumb for the distance would be within your eye sight. One key on the Remote can trigger one action of your single side curtain or double side curtain. For example, a key can trigger the curtain to close OR open. Please refer to Remote user manual for the best support.

Settings

Tap the gear icon on the Home Page near the Curtain icon to go to the Settings. Or tap the Curtain icon to go to the Control page.

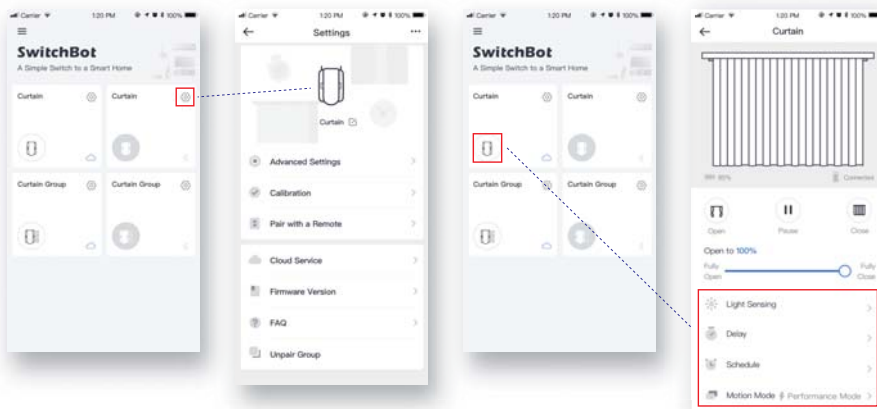

Light Sensing

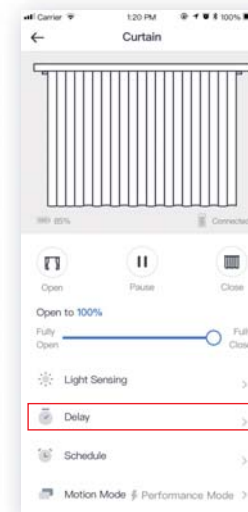

The light sensing feature allows triggering your device by sunlight. It's still in the beta stage and upgrading continuously, so please explore the details in the latest App. Please send feedback via the SwitchBot App in the left side menu with the details. Your feedback is very much appreciated.

Delay

You can set up 1 Delay for countdown action. You can set the countdown time, percentage of opening or closing, and Motion Mode.

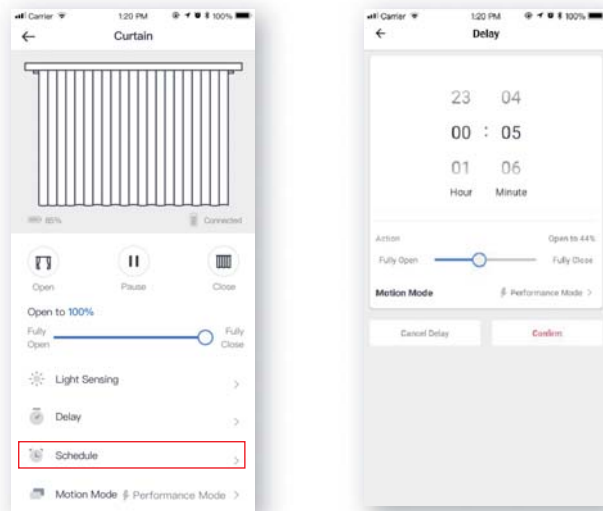

Schedule

You can set up 5 Schedules on board, or unlimited Schedules with a Hub. You can set the day, time, percentage of opening or closing, and Motion Mode.

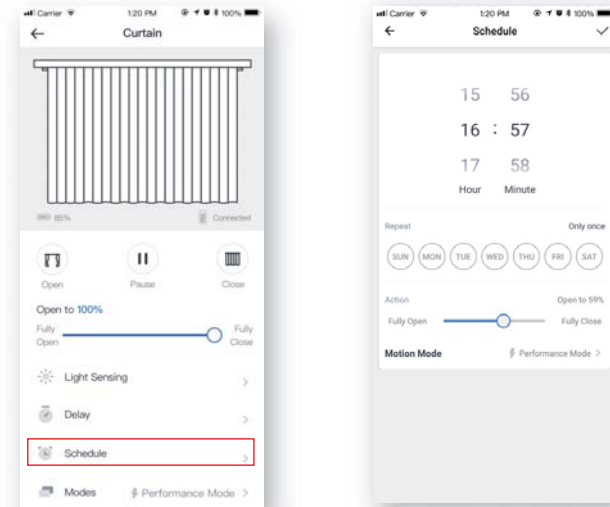

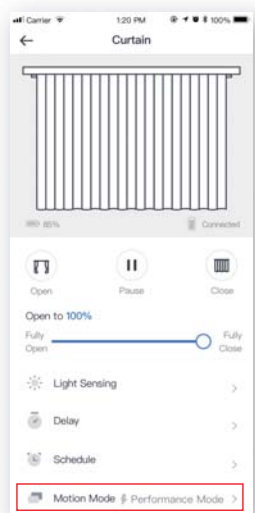

Motion Mode

Performance Mode is the default mode with more powerful strength* but louder noise level.

Silent Mode has lower noise level with less powerful strength. The best use case would be waking up with sunshine.

* Up to 8 kg / 17 pounds of curtain.

Charging, Firmware and Factory Reset

Charging

It takes about 10 hours¹ to fully charge the battery and the battery lasts 8 months after a full charge². You may also purchase our Solar Panel to charge by sunlight³.

1. 5V \approx 1A adapter is required to charge with adapter.
2. Battery life is tested under condition of runway of 3 meters, loaded with 8 kg of curtain, opened and closed twice day, 25°C. Battery life may vary given different condition.
3. Light Intensity Level 5 is required to charge with Solar Panel.

Specification

Our SwitchBot Curtain is very complicated from the inside, so it is very SIMPLE for you on the outside.

Model Number: W0701600

Color: White / Black

Material: ABS plastic with UV-Resistant coating

Product Size (Main Body): 42mm x 51mm x 110mm

Product Net Weight (Main Body): 135g

Power: Type-C, DC 5V \approx 1A, 3350 mAh Lithium-ion Battery. Or by Solar Panel¹

Battery Life: 8 months². Or unlimited with Solar Panel

Connectivity: Bluetooth 5.0 Long Range

Sensor: Accelerometer, light sensor

Strength: Up to 8 kg / 17 pounds of curtain³

Max Runway: 3 meters

Mode: Silent Mode / Performance Mode

Timer: Up to 5. Or unlimited with a Hub⁴

Voice Control (Hub Required): Amazon Alexa, Google Assistant, Siri Shortcuts, SmartThings, IFTTT, and LINE

Certification: TELEC, FCC, CE, ROHS, KC

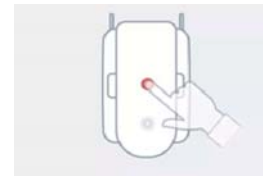

Factory Reset

Long press the button for 15 seconds until the LED light lights up. Then release the button. If you are using double side open mode, you will need to recalibrate both Curtain again.

Caution:

You may lose all the settings after Factory Reset and you may need to add the device again and re-calibrate.

Return and Refund Policy

SwitchBot Curtain has one-year warranty (start from the purchasing day).

The situations below do not fit the Return and Refund Policy:

- Intended damage or abuse.
- Inappropriate storage (drop down or soaking in water).
- User modify or repair.
- Using loss.
- Force majeure damage (Natural disasters).

The battery is not in the warranty.

Contact and Support

Setup and Troubleshooting: support.switch-bot.com

Support Email: support@wondertechlabs.com

Feedback: Please send feedback via the SwitchBot App in the left side menu with the details of the issue.

FCC Warning

This device complies with part 15 of the FCC Rules. Operation is subject to the following two conditions: (1) This device may not cause harmful interference, and (2) this device must accept any interference received, including interference that may cause undesired operation. Any Changes or modifications not expressly approved by the party responsible for compliance could void the user's authority to operate the equipment. This equipment has been tested and found to comply with the limits for a Class B digital device, pursuant to part 15 of the FCC Rules. These limits are designed to provide reasonable protection against harmful interference in a residential installation. This equipment generates uses and can radiate radio frequency energy and, if not installed and used in accordance with the instructions, may cause harmful interference to radio communications. However, there is no guarantee that interference will not occur in a particular installation. If this equipment does cause harmful interference to radio or television reception, which can be determined by turning the equipment off and on, the user is encouraged to try to correct the interference by one or more of the following measures:

- Reorient or relocate the receiving antenna.
- Increase the separation between the equipment and receiver.
- Connect the equipment into an outlet on a circuit different from that to which the receiver is connected.
- Consult the dealer or an experienced radio/TV technician for help. The device has been evaluated to meet general RF exposure requirement. The device can be used in portable exposure condition without restriction.

FCC RF exposure statement:

The equipment complies with FCC Radiation exposure limit set forth for uncontrolled environment. This equipment should be installed and operated with minimum distance 20cm between the radiator and your body.