

# Removable battery-Skateboard User Manual

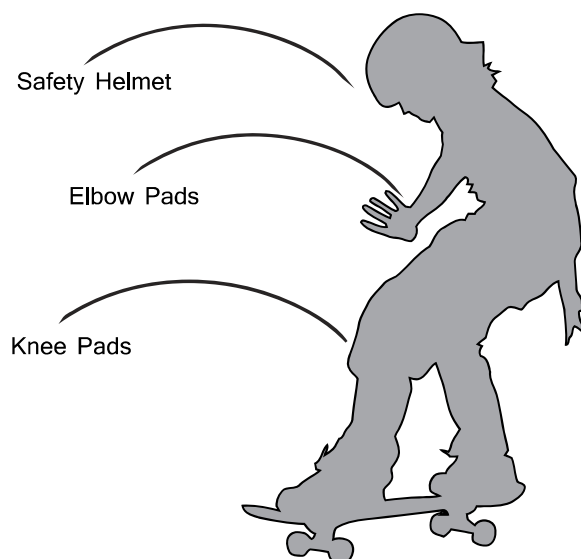

## 1.Preparation



Wear safety gear and read this paper carefully before driving.



In low battery state,it will automatically switch to cruise mode.  
No high speed and high acceleration in low battery status.

## 2. Power off/on

Turn the switch left/right to power off/on the remote controller

Charge port

OFF ← • → ON



## 3. Drive, Brake & Reverse

↑ Low speed  
• Medium speed  
↓ High speed



Change speed mode before you move joystick.



Don't reverse while driving

Press the power button to power on/off



Don't move board until the beeps end (in first 5 seconds after the boot).



## 4. Change Battery

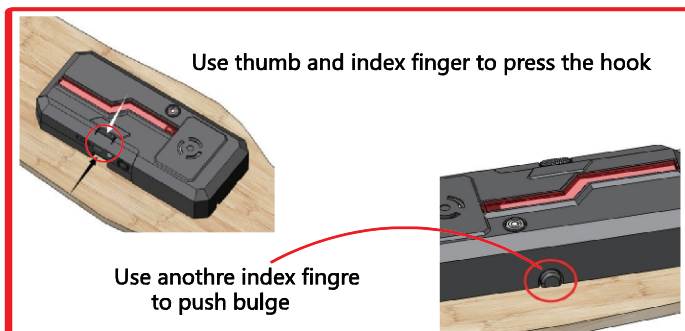

Do not pull out battery pack by only one hand

Pull and push at once,  
let the battery pack release



Check the hook at right place after changed battery

## 1.

Thank you for purchasing a electric skateboard.

Do note that an electric skateboard is not a toy, and takes time to learn.

Please take the time to read this manual carefully, particularly the safety instruction pages.

We hope you will enjoy using this product and have lots of fun riding the skateboard of the future!

## 2.

### BEFORE YOU RIDE

Ensure equipment is charged  
Wear appropriate safety gear  
Be aware of your surroundings

Ride in a safe area  
Abide by local laws and regulations  
Have fun and ride safe!

# 3.

## Getting Started

### Charging

The board and controller need to be fully charged prior to first use.

Ensure that both the board and controller are powered off when charging.

Notice: Using any other charger may cause damage to the control board or batteries, and will void your warranty.

Please contact us if you require a replacement charger.

Charging the skateboard

Only use the supplied adaptor with the unit.

Power off the skateboard if it is on.

Plug the supplied power adaptor into the power socket on the skateboard.

The light on the charger will turn red while charging, and green when fully charged.

Unplug the unit once the charge is completed.

It typically takes about 3 hours to fully charge the skateboard batteries from empty.

Charging the remote controller

The controller uses a standard micro usb cable to charge.

Insert the supplied USB charge cable into the bottom of the remote controller.

Make sure that the cable is oriented correctly when inserting into the controller.

Plug the other end of the USB cable into the charger, and plug into a power socket. It typically takes about 2 hours to fully charge the remote.

# 4.

## Pairing

On very first use, the board and controller need to be paired together.

Before starting the process, ensure that the controller and board are powered off.

-Press and hold the power button on the controller briefly until the LED lights all turn off the controller.

-Press the binding button on the remote controller.

Push the joystick, if the motor rolling, it means paired successfully.

## Testing Pairing

You can test pairing by placing the skateboard on its side, and pushing up on the motion controller until the wheel motors engage and the wheels start spinning. Push backwards on the motion controller to stop the spinning.

The boards is now ready to use.

## 5.

### Remove battery



1. Use index finger to push the bulge.



2. Use another hand's index finger and thumb to press the hook.



3. Push and pull the battery pack at once.



4. Pull out the battery pack.

**Tips :** Take 2 or more battery packs can increase the mileage of skateboard. The battery pack can use as power bank individually

## 6.

### Before you ride

- Prior to use perform a quick visual check that the board looks ok. and equipment is undamaged.
- Ensure that you have appropriate safety gear.
- Find a safe environment to use the skateboard in.

### First Ride

Power up the unit and check that everything is running smoothly. Engage the brake by pressing downwards on the motion joystick. Step onto the board, Find your balance, and gently push up on the joystick until the board.

### Starts rolling.

The more you push up on the joystick, the faster you will travel.

Pushing downward on the joystick will engage the brakes.

Practice going forward slowly until you feel comfortable, then try turning.

We suggest learning with a friend initially, so that you have support in case you fall.

Most users will be able to ride competently within a short period of time. It's easier than you think.

### Basic Riding Tips

Remember to press down on the joystick to engage the brake.

This makes mounting the skateboard a lot easier for beginners.

You should place the foot that you kick with to the rear of the board, and your other foot to the front of the board.

Keep to a pace that you are comfortable with until you are experienced using the board.

Learn to turn by gently leaning your feet forwards to turn left, and backwards to turn right whilst moving forwards.

Remember, Practice makes perfect!

# 7.

## FAQ

Issue	Possible Reasons	Solution
Failed to starting up	Battery runs out	Electric skateboard:Please charge immediately..It generally takes 3to 4 hours Remote controller:please charge immediately..It generally takes 2 hours.
Cruise duration gets shorter	Battery are not fully charged	Remote fully charge the battery. It generally takes 3 to 4 hours.
Battery doesn't accept charge	Plug gets loose.	Make sure power flow to the wall outlet is on.
	Socket is not available	Check if the scoker is available.
	Battery need to be replaced.	The average of rechargeable battery lifi is 1 to 2 years depending on condition and use. Replace only with electric skateboard replacement batteries.
Electric skateboard doesn't run	Binding indicator was not light up.No connection to electric.	Start up electric skateboard.
	Binding indicator flashing on remote controller indicates a fault in electric skateboard.	Restart electric skateboard and remotecontroller. If blinding indicator still light off, please turn off them and consult dealer or manufacturer.
	Indicator on electric skateboard flsahing(notmatch code) indicates a fault in electric skateboard.	Please consult dealer or manufacturer.
	Charge indicator flashing.	Please charge immediately.
Auto power-off	Battery runs out.	Please charge immediately.
	It will auto power-off without any operation on Electric skateboard and remote controller	Start it up.

# 8.

## Specifications

		Dual Hub-Motor	Single Belt-drive
Complete Skateboard	Net weight	4.5kg	4.5kg
	Product size	820*270*120mm	820*270*120mm
	Package	880*320*190mm	880*320*190mm
Deck	Material	1 layers bamboo and 6 layers maple	1 layers bamboo and 6 layers maple
	Size	820*200mm	820*200mm
Battery Pack	Capacity	4.4AH	4.4AH
	Type	Lithium-Ion	Lithium-Ion
	Weight	650 g	650 g
	Charge Time	2 hours	2 hours
	Rechargeable	500 times	500 times
Motor	Type	70mm Hub Motor	N5065 Out-Runner Motor
	Power	Dual-motor 350w X2	Single-motor 900w
Wheel	Material	high performance PU	high performance PU
	Dimensions	70mm*51mm	83mm*52mm
	Hardness	80a	80a
Wireless Remote Controller	Capacity	400mA	400mA
	Type	Lithium-Ion	Lithium-Ion
	Charge Time	2 hours	2 hours
	Max Speed	20 km/h	28 km/h
	Max Mileage	15 km	15 km

# 9.

## ● Component Parts - Board

NO	Name
1	Deck
2	LED
3	Battery display
4	USB port
5	Display button
6	Charging port
7	Power button
8	Loudspeaker
9	Power truck

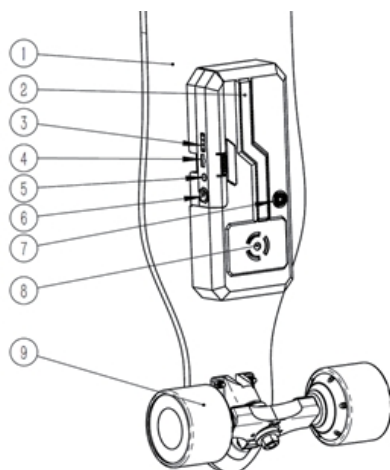

# 10.

## ●Dual Hub-Motor Power truck set

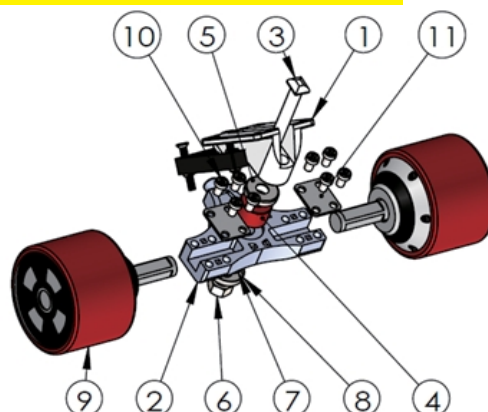

1	Base plate
2	Hanger
3	Kingpin
4	PU cushion
5	Lower cup washer
6	Kingpin nut
7	Cone cushion
8	Top cup washer
9	Hub - motor
10	M6 Screw
11	Pressing plate

# 11.

## •Single Belt-drive Power truck set

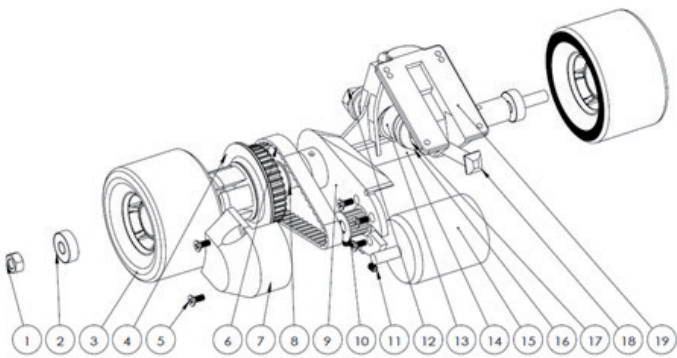

- ①Nut ②Bearing ③Wheel ④Wheel pully ⑤Belt case screw ⑥Belt  
⑦Belt Protector ⑧F608 Bearing ⑨Motor holder ⑩Motor screw  
⑪ Guide screw ⑫Nut ⑬Spring washer ⑭Truck ⑮Motor  
⑯ Gasket ring ⑰Spring washer ⑱ vtruck bolt ⑲Truck holder

# 12.

## •Unpowered truck set

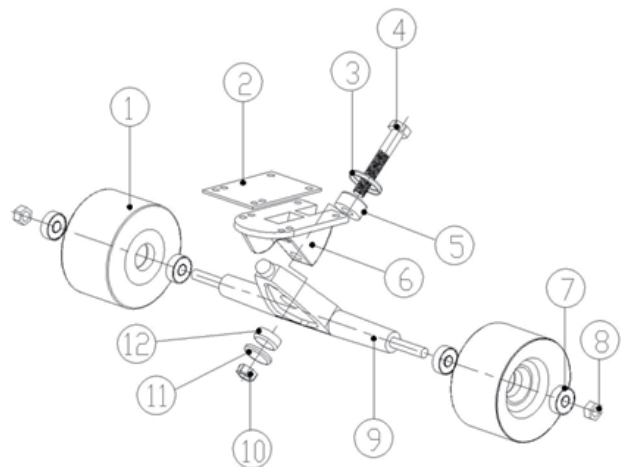

- ①Wheel ②Gasket ③Gasket ring ④Truckbolt ⑤Spring washer ⑥Holder  
⑦Bearing ⑧Nut ⑨Truck ⑩Nut ⑪Gasket ring ⑫Spring washer



# 13.

## Remote Control



# 14.

## Safety Instructions

- An electric skateboard is not a toy, and should be treated with appropriate care. Always practice safety first-as it is possible to lose balance and cause a collision or fall, ensure that you use the board in a safe appropriate environment, and you always wear appropriate safety gear.
- Safety Gear -we recommend that you wear full safety gear when riding. Please wear a suitable skateboard helmet, elbow pads, knee pads, and gloves. Wear suitable attire when skateboarding to protect you from scrapes if you fall. Wear shoes - flipflops or similar loose footwear are not suitable riding wear.
- The board is designed for use by responsible riders of the ages 13 and up.
- Only one person can ride a Skateboard at a time.
- The maximum carrying weight supported by the boards is 60kg /130lbs. Exceeding this weight will affect the skateboard balance and functionality, and may cause the board to fail, act inappropriately or otherwise break.
- Please observe your local traffic laws and regulations.
- The board is designed to be ridden on flat and paved surfaces. Avoid driving on sand, gravel, mud, rugged or open ground. Do not drive on slippery ground, such as snow, ice or wet ground.



# 15.

Keep a safe distance from other people and stationary objects while riding. Do not drive in crowded spaces - you could be a danger to yourself and other people.

Do not ride at night or in dark unit locations.

Always be aware of your surroundings. Please pay attention when riding aboard and always be on the lookout for other road users or dangers. Avoid listening to music when riding, as other road users may not be heard until too late.

Perform a basic safety check of the board before riding to avoid accidents or equipment damage . Check the bolts and trucks are tightly fastened. Check electrical connections are firmly connected. obstructions.

Ensure the drive belts are undamaged and the chassis is clean of Please don't place any items on top of the board when riding.

When the board is low on power, please stop using the board and recharge the battery as soon as possible.

**FCC Caution:**

This device complies with part 15 of the FCC Rules. Operation is subject to the following two conditions: (1) This device may not cause harmful interference, and (2) this device must accept any interference received, including interference that may cause undesired operation.

Any Changes or modifications not expressly approved by the party responsible for compliance could void the user's authority to operate the equipment.

**Note:** This equipment has been tested and found to comply with the limits for a Class B digital device, pursuant to part 15 of the FCC Rules. These limits are designed to provide reasonable protection against harmful interference in a residential installation. This equipment generates uses and can radiate radio frequency energy and, if not installed and used in accordance with the instructions, may cause harmful interference to radio communications. However, there is no guarantee that interference will not occur in a particular installation. If this equipment does cause harmful interference to radio or television reception, which can be determined by turning the equipment off and on, the user is encouraged to try to correct the interference by one or more of the following measures:

- Reorient or relocate the receiving antenna.
- Increase the separation between the equipment and receiver.
- Connect the equipment into an outlet on a circuit different from that to which the receiver is connected.
- Consult the dealer or an experienced radio/TV technician for help.