

poputar
a redefined guitar to play

Instruction Manual:

Part Description



Poputar Smart Guitar
Guitar Charging Rack
Guitar Bag
Adapter Data Cable

APP Download



Download QR Code

Search "Poputar" in App store

How to Use

1. Turn on your poputar for the first time (Push the power button)

- For the first time, you should push the power button inside the body, and the led lights on the fretboard will flash.

(If you stop using Poputar for a long time, please press the power button again before you start)

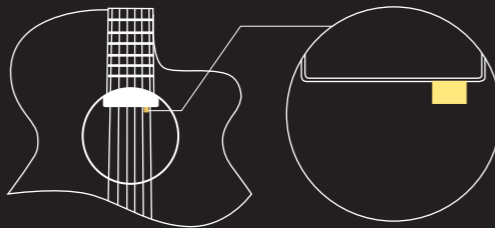

Push the power button in the body of your Poputar

2. Wake up your poputar by swiping the strings. (From Sleeping mode)

- When you turn of the bluetooth connection, your poputar will automatically turn in to sleep mode in 15 minutes.
- You can swipe the strings to wake up your poputar.
- The led lights on the fretboard will flash.



3. How to charge your Poputar



- Connect the Guitar Charging Rack with the Adapter
- Gently laying down your poputar on the charging rack until the metal pad on the back of your poputar touches the convex point
- Connect the adapter to the power outlet, the led lights on the fretboard will indicate the charging process.

4. How to use the smartphone rack

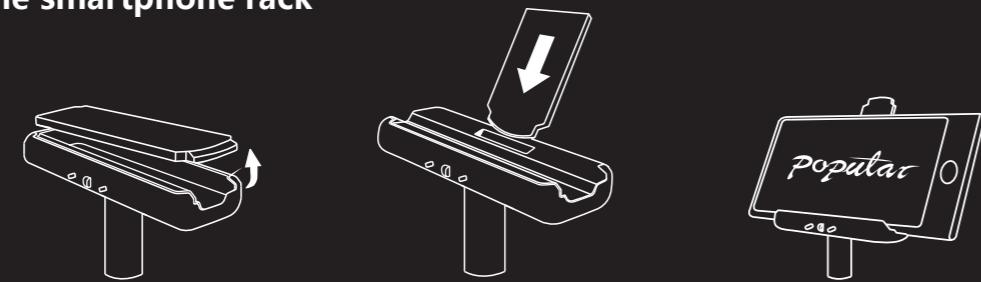

- Open the cover of the smartphone rack
- Insert the cover into the middle slot and secure it
- Open the APP and place your smartphone on the tray

www.poputar.com

Product Precautions

- Please use the original adapter to charge to avoid the incidents of short-circuit and failure to charge the battery.
- Do not place your poputar in a damp or dry place. Such as set next to a stove, or exposure to the sun. Humidity or dryness can cause the neck of Poputar to be deformed or cracked.
- Please place your poputar on the charging rack when not in use. Do not freely display your poputar directly against the wall to avoid accidental damage to the Poputar.
- Do not short-circuit the charging metal patch of your Poputar to prevent damage to the internal circuitry.

Product Specifications

Product Name: Poputar Guitar
Specifications : 40-inch smart guitar
Fret Wire : 2.2mm copper-nickel alloy
Bottom Side Panel: Sapele Splint
Panel: Spruce Panel
Neck : African Wood
Fretboard : G10is ABS
Bridge : Indian Rosewood
Nob : Chrome-plated round-sealed
Edge: White + Black linear
Paint: Eco-Friendly Matte Black Paint
String: Phosphorus brass string
Nut : Black Plastic
Accessories : Strings , QC Certificate
Packing : 5 Layers K=K Ocean import carton

Certification of Warranty

Customer Information

Name : _____ Zip code : _____
Contact Phone : _____ Email : _____
Address : _____

Product Information

Serial Number of Poputar
(Located on the battery and the inner of the body) :

Serial Number of Charging Rack/ Adapter : _____

Sellers

Name : _____ Date of Sale : _____
Contact Number : _____ Invoice Number : _____
Address : _____

Warranty Description

This warranty covers the poputar sold in mainland China (excluding Hong Kong, Macau and Taiwan)
Please scan the QR Code below for detailed warranty regulations and information



web: www.poputar.com
tel: 0755-2302 7858
email: service@poputar.com

FCC Caution:

This device complies with part 15 of the FCC Rules. Operation is subject to the following two conditions: (1) This device may not cause harmful interference, and (2) this device must accept any interference received, including interference that may cause undesired operation.

Any Changes or modifications not expressly approved by the party responsible for compliance could void the user's authority to operate the equipment.

Note: This equipment has been tested and found to comply with the limits for a Class B digital device, pursuant to part 15 of the FCC Rules. These limits are designed to provide reasonable protection against harmful interference in a residential installation. This equipment generates uses and can radiate radio frequency energy and, if not installed and used in accordance with the instructions, may cause harmful interference to radio communications. However, there is no guarantee that interference will not occur in a particular installation. If this equipment does cause harmful interference to radio or television reception, which can be determined by turning the equipment off and on, the user is encouraged to try to correct the interference by one or more of the following measures:

- Reorient or relocate the receiving antenna.
- Increase the separation between the equipment and receiver.
- Connect the equipment into an outlet on a circuit different from that to which the receiver is connected.
- Consult the dealer or an experienced radio/TV technician for help.