

US Wall Socket User Manual

Safety

Please read all of the safety and operating instructions before using your device:

1. The Products are only for indoor use.
1. Do not disassembly the device or attempt to repair.
2. Plug the power cables into properly grounded electrical outlets in order to help prevent against electrical shock.
3. Disconnect the power before you clean the device.
- 4. The devices are not suitable for use in situations or environments where failure, delay or errors or inaccuracies in the data or information provided by the devices could lead to death, personal injury or severe physical or environmental damage, including without limitation in connection with the operation of nuclear facilities, aircraft navigation or communication systems, air traffic control, or life support systems.**

Specification

Model No: UWS-102

Input/ Output: AC 125V, 60Hz, 15A Max

Temperature: 0°C to 40°C (Operating) , -20°C to 65°C(Storage)

Humidity: 10% to 90% Non-condensing (Operating), 5% to 90% Non-condensing (Storage)

Installation and Setup of SmartiBlue Devices

To install SmartiBlue app

Step 1:

Download the SmartiBlue app from App Store[®] or Google Play[™] .



SmartiBlue
Smart iBlue Technology Limited

Once SmartiBlue app is installed, launch the app. Make sure your mobile device are connected with Wi-Fi and Bluetooth.

Step 2:

Log into your Smart iBlue account, or sign up a new account by following the instruction in the app.

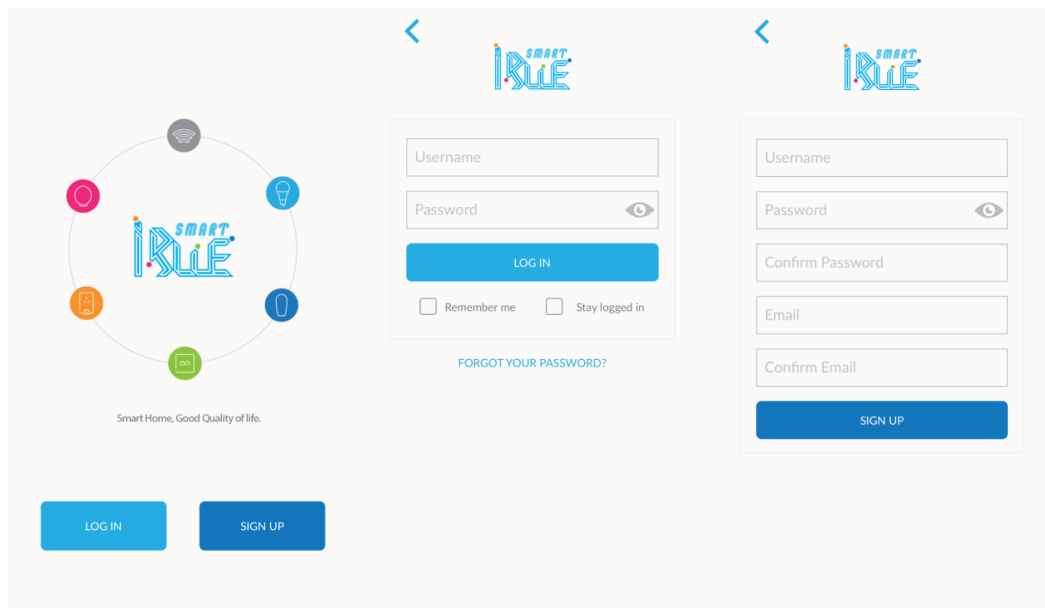

Step 4:

After you have logged in your account, tag '+' icon in the home page of your Smart iBlue app

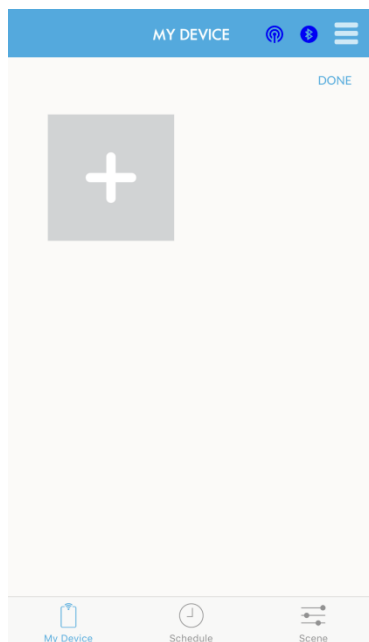

Instruction For US Wall Socket

Step 1:

Turn off the power at the circuit breaker for the socket you are replacing.

Take a photo of original wiring for future reference.

Wire the socket in place of an existing receptacle as shown in below. Make sure the connectors are fastened as tight as possible.

Turn the power back on at the breaker. If the socket is connected correct, you should see the LED blink to indicate the unit is ready to connect to the app.

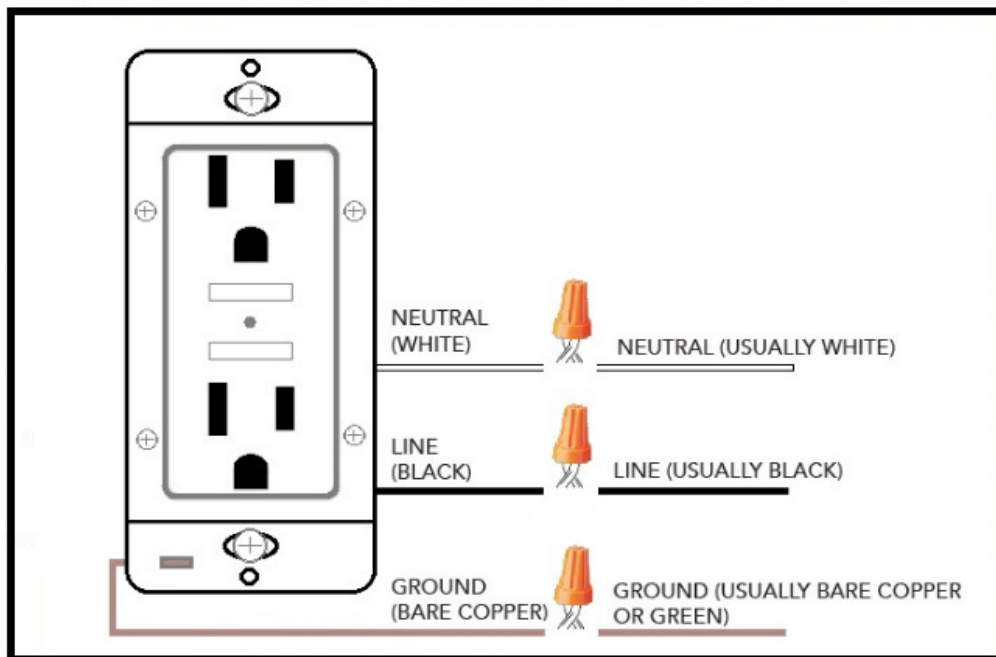

Step 2:

In 'My Device' page, tap '-Search Device' to search the device and finish the association process. You can also name your device after you clicked on it.



The LED light will blink rapidly when associating. The light becomes off when the

device associated successfully. The notice would be popped out to indicate that the association process is finished. The socket will be shown on the 'Associated Devices' list if associated successfully. Tap the 'return' icon in the top left corner

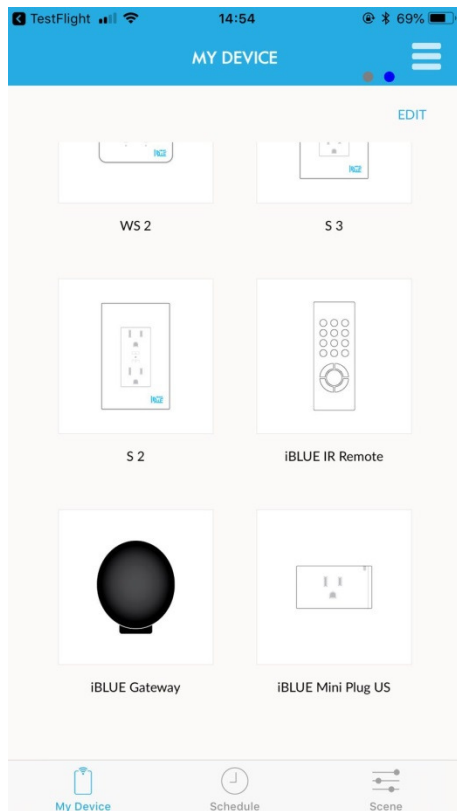

Step 3:

In the home page you will see the name of the associated socket. It means you have successfully associated the socket. Now you can tap the socket to enter the control panel.

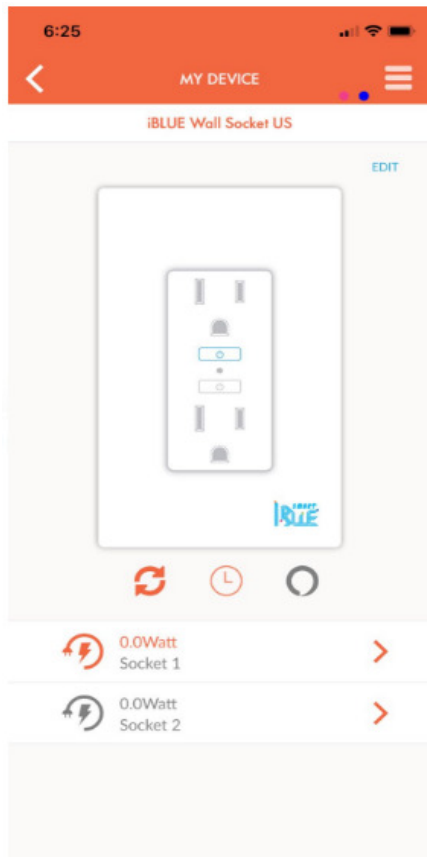

Here is the control panel. **You have successfully set up your Smart wall socket now.**

Note

This device complies with part 15 of the FCC Rules. Operation is subject to the following two conditions:

(1) This device may not cause harmful interference, and (2) this device must accept any interference received, including interference that may cause undesired operation.

Note: This equipment has been tested and found to comply with the limits for a Class B digital device, pursuant to part 15 of the FCC Rules. These limits are designed to provide reasonable protection against harmful interference in a residential installation.

This equipment generates, uses and can radiate radio frequency energy and, if not installed and used in accordance with the instructions, may cause harmful interference to radio communications. However, there is no guarantee that interference will not occur in a particular installation. If this equipment does cause harmful interference to radio or television reception, which can be determined by turning the equipment off and on, the user is encouraged to try to correct the interference by one or more of the following measures:

- Reorient or relocate the receiving antenna.
- Increase the separation between the equipment and receiver.

—Connect the equipment into an outlet on a circuit different from that to which the receiver is connected.

—Consult the dealer or an experienced radio/TV technician for help.

Note: The Grantee is not responsible for any changes or modifications not expressly approved by the party responsible for compliance. such modifications could void the user's authority to operate the equipment.

To maintain compliance with FCC' s RF exposure guidelines, this equipment should be installed and operated with a minimum distance of 20cm between the radiator and your body.