



blackweb

WIRELESS CHARGING STAND

Model: BWA17WI015

PRODUCT GUIDE

V1.0

Thanks for choosing us!

This is a smart phone wireless charger that allows you enjoy the fun of digital products easily.

Please kindly read the user manual before using and keep it for future reference.

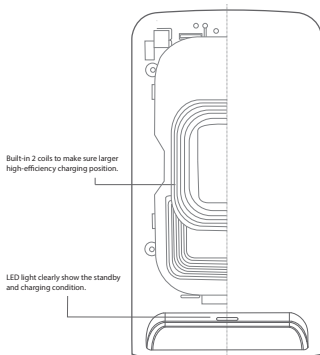

Connect to Power Adapter

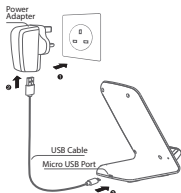

1. Connect the power adapter to socket.
2. Connect adapter to the USB2.0 interface, the other Micro USB to pad.

Note: Charging pad controlled by smart chips, long-term standby can be assured.

Connect to Laptop for Charging

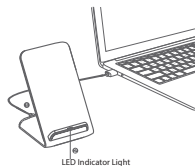

1. Connect the USB 2.0 interface into laptop USB port, the other Micro USB to pad.
2. Standby LED light turn on blue.

Connect to Desktop for Charging

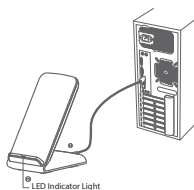

1. Connect the USB 2.0 interface into desktop motherboard USB port, the other Micro USB to pad.
2. Standby LED light turn on blue.

Charging Mode

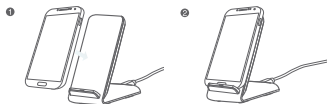

1. Make sure the charging pad indicator light turn on green, under standby status
2. Put wireless charging mobile phone on the pad, the LED light will turn to green from blue and start charging. It shows that the charging position is improper when the LED light flashing. Please move the phone a little and LED light keeps green.

Specification

Input: DC5.0V/2.0A/DC9.0V/1.8A

Output: DC5.0V/1.0A/DC9.0V/1.1A

Frequency: 110-205KHz Conversion: ≥72%

Size: 118x70x87.5mm NW: 150g

Trouble shooting

1. Wireless charging terminal bad
2. Power cable current less than 1.5A
3. Adapter current less than 1A
4. Adapter, power cable, product poor contact
5. Mobile location shift

Notes:

1. Do not squeeze or collisions.
2. Do not disassemble or throw into fire or water, to avoid causing a short circuit leakage.
3. Do not use wireless charger in severely hot, humid or corrosive environments to avoid circuit damage and occurs leakage phenomenon.
4. Do not place too close with magnetic stripe or chip card (ID card, bank cards etc.) to avoid magnetic failure.
5. Please keep the distance at least 20cm between implantable medical devices (pacemakers, implantable cochlear, etc.) and the wireless charger, to avoid potential interference with the medical device
6. To take care of the children, to ensure that they won't play the wireless charger as a toy, to avoid unnecessary accidents.
7. When work radios and products close contact, will produce interference, when product interference, please increase the distance between the product and radio.
8. When don't use the product, please turn off the power supply and unplug the power plug.

CAUTION:

To reduce the likelihood of excessive heat and possible damage, use only the USB cable packaged with this product.

9. Before clean this product, please cut off the power supply, please only used dry rag to clean the product.
10. If the damage caused by improper use of the body, the odd smell, smoke and other phenomena, please stop using immediately.

Changes or modifications not expressly approved by the party responsible for compliance could void the user's authority to operate the equipment.

The involved images are sketch maps, the final product as per the material subjects.

Includes:

Wireless Charger x1pc

Micro USB cable x1pc

User's Manual x1pc

No power adapter, if you need, please purchase separately.

Compatible devices:

SAMSUNG® Note5/S6/S6 Edge/S6 Edge+/S7/S7 Edge/S7 Edge+/S6 NOTE/S6 DUOS

LG® D1/LG LTE2/OPtimus F5/G2(USA)/G3 (four contacts after the shell)/G PRO

OPtimus Vu3/LTE2

NOKIA® Lumia 820/Lumia 1020/Lumia 1520/Lumia 920/Lumia 822/Lumia 930

Lumia 929/Lumia 928

HTC® 8x/HTC Butterfly(USA)/Incredible4G LTE/Droid DNA/Round/One mini2

One M8 Eye(M8E)/TD-LTE 4G/One E9(E9)/TD-LTE 4G/HTC Butterfly3(TD-LTE 4G)

ASUS® Z97-DELUXE/PADPHONES-X

Google® Nexus2/Nexus3/Nexus4/Nexus5/Nexus6/Nexus7

MOTO® Motorola 260/Droid Turbo 2 (XT1585)/XPRO/MAXX(XT1254)

Nexus 6(XT1100/XT1103)/Droid Turbo (XT1254)/Droid MAXX2 (XT1080)

SONY® Z3V/Z4V

BLACKBERRY® PRIV(STV100-1)/PRIV(STV100-2)/Z30

SHARP® SH-07D/SH-04D/SH-02D/SH-13C

Federal Communication Commission Interference Statement

- "This device complies with Part 15 of the FCC Rules. Operation is subject to the following two conditions: (1) this device may not cause harmful interference, and (2) this device must accept any interference received, including interference that may cause undesired operation."

- "Warning: Changes or modifications to this unit not expressly approved by the party responsible for compliance could void the user's authority to operate the equipment."

- "NOTE: This equipment has been tested and found to comply with the limits for a Class B digital device, pursuant to Part 15 of the FCC Rules. These limits are designed to provide reasonable protection against harmful interference in a residential installation. This equipment generates, uses and can radiate radio frequency energy and, if not installed and used in accordance with the instructions, may cause harmful interference to radio communications.

However, there is no guarantee that interference will not occur in a particular installation. If this equipment does cause harmful interference to radio or television reception, which can be determined by turning the equipment off and on, the user is encouraged to try to correct the interference by one or more of the following measures:

- Reorient or relocate the receiving antenna.
- Increase the separation between the equipment and receiver.
- Connect the equipment into an outlet on a circuit different from that to which the receiver is connected.

Consult the dealer or an experienced radio/TV technician for help."