

GLXSS ProInstructionManual

Package

GLXSS Pro smart glass, glass host, rechargeable Li-ion battery, USB Type-C cable, charging cable, charger, glass host case, warranty card, product certificate, safety instruction manual, package case

* Please read and keep this instruction manual carefully before using the product.

Specifications

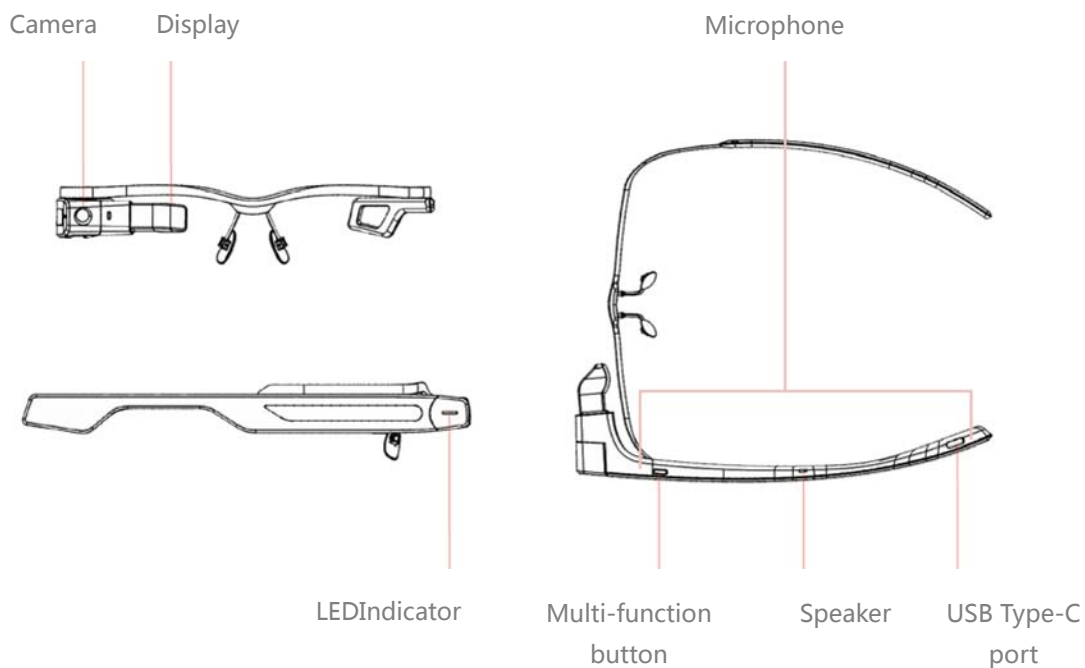

Product	GLXSS Prosmart glass
Camera	13 megapixel SONY CMOSsensor, f2.0 aperture, 1080p FHD video recording, rotatable camera module
Display	0.23 inches 640x400 resolution OLED near-eye display, 21° FOV (Viewing experience equals to a 30 inches display, 2 meter away), adjustable viewing angle
Audio	Dual microphones noisecancellation, mono speaker
Others	USB 3.0 OTG port (mistake proofing), LED indicator, 6 axis motion sensor, light sensor
Accessories (optional)	Lens frame and lenses (compatible with prescription lenses, sunglasses lenses, etc.), head belt

Specifications

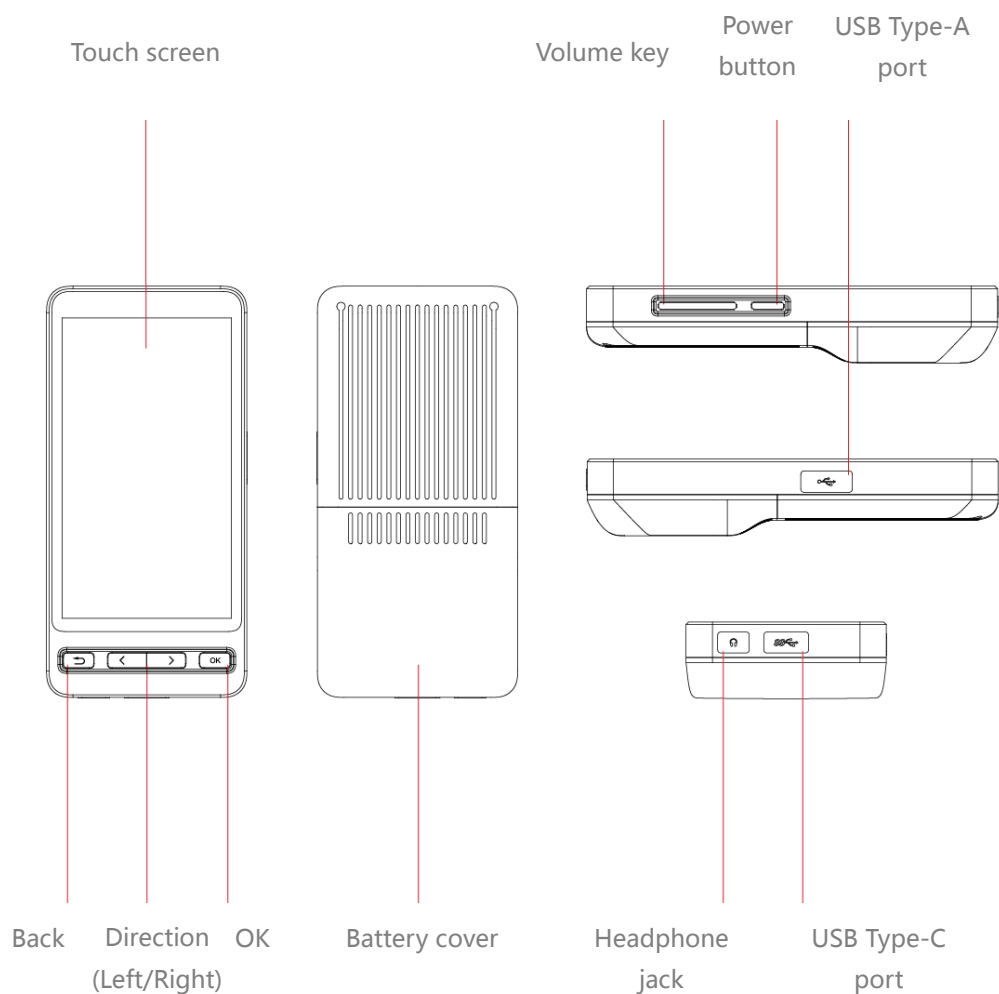

Product	Glass host
Screen	5 inches 1280x720 resolution multi-touch display
CPU	Intel Atom® Z8350quad-core1.92GHz processor
GPU	Intel HD Graphics (Gen8 12EU 500MHz)
RAM	2GB DDR3L (4x16bit 1600)
Wireless	BLE 4.0 (remote control supported), dual band WiFi (802.11 a/b/g/n), GPS/BeiDou
Memory	32/64GB eMMC
Battery	5800mAh rechargeable Li-ion battery
Others	USB 3.0 OTG port (mistake proofing),USB 2.0 type-A Host port, Standard 3.5mm 4 pole headphone jack, LED indicator
Accessories (Optional)	Belt, earphone with controller

Basic operations

1. Connect devices

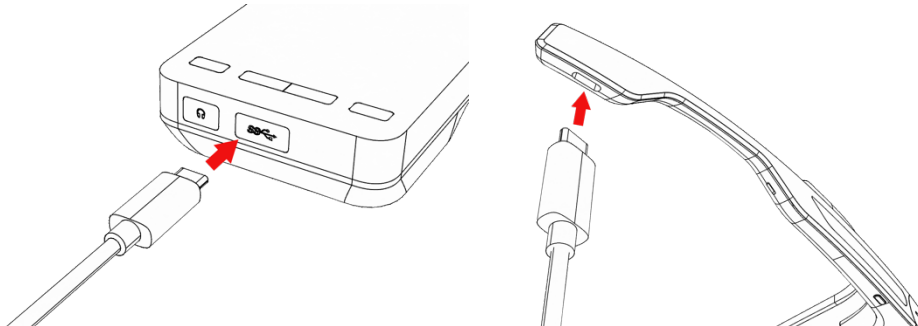

- ① Open the protective cover on USB Type-C port, plug in the USB Type-C cable
- ② Find the USB Type-C port on GLXSS Pro, Plug in another side of this cable

2. Power on/off

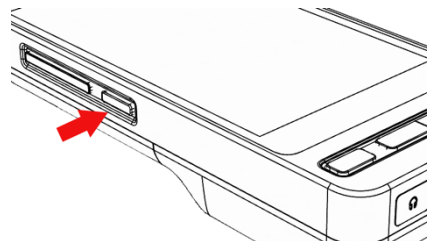

- ① To power on the device, depress the power button for 3 seconds, until the screen is on
- ② To power off the device, depress power button for 1 second, then tap "Power off" on the pop up dialog

3. Charging

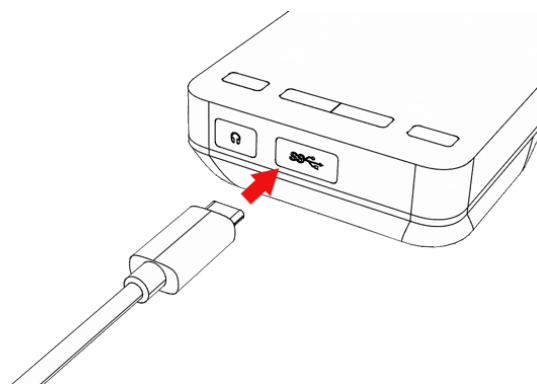

To charge the device, open the protective cover on USB Type-C port, plug in the charging cable

Wear

1. Please make sure GLXSS Pro stays comfortable on your head
2. Adjust display

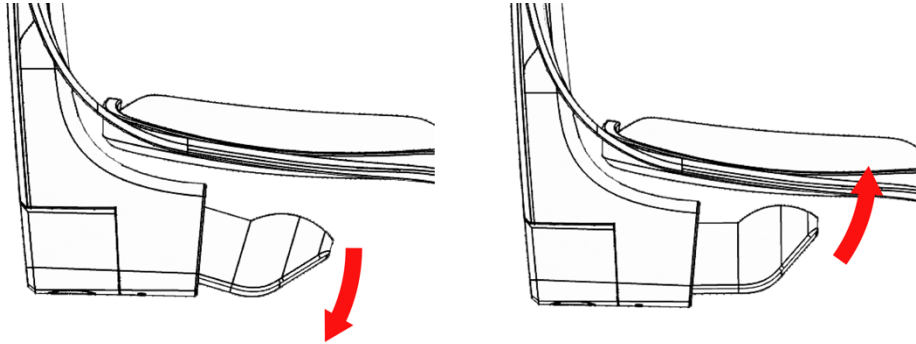

Rotate the display module forward and backward, until you can see the entire display clearly

3. Adjust camera

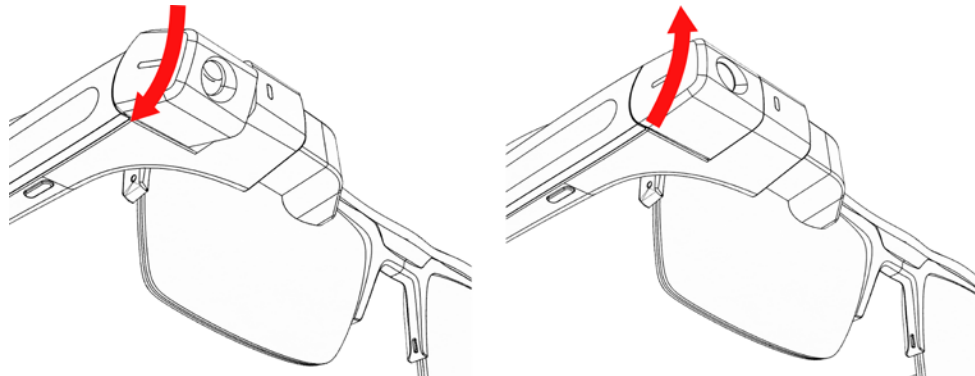

Rotate camera module up and down, until the viewing angle fits your working scenario

4. Install/change glasses lenses

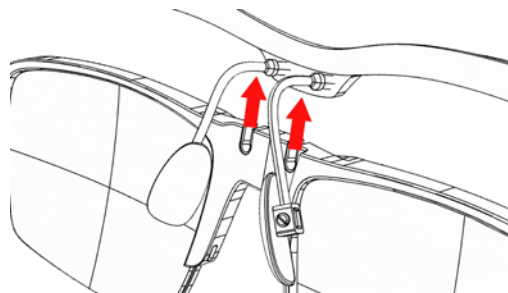

Hook the lens frame on the end of nosepad arms

Buttons

1. Glass host buttons

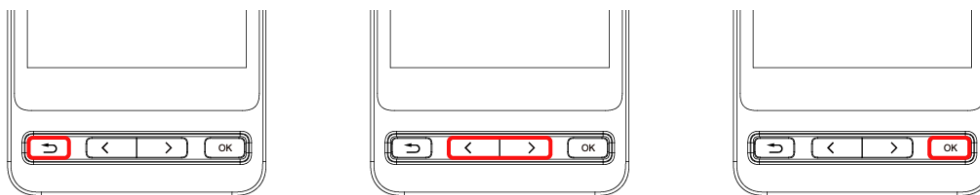

① Back. Same as Android back button

② Direction. Move and select content on smart glass or glass host screen

③ OK. Enter or confirm

*When GLXSS Pro is correctly connected to glass host, while the screen on glass host is off, use these 4 buttons to control content on GLXSS Pro; When the screen on glass host is on, use these 4 buttons to control content on glass host.

2. Smart glass multi-function button

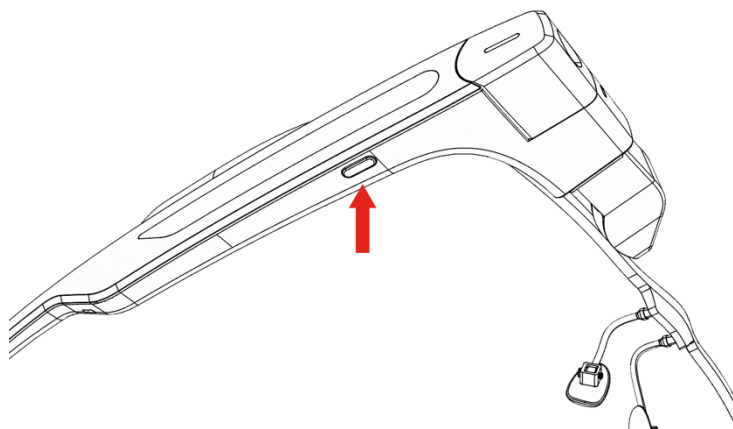

Depress the multi-function on GLXSS Pro to activate application customized functions

FCC statements:

This device complies with part 15 of the FCC rules. Operation is subject to the following two conditions: (1) this device may not cause harmful interference, and (2) this device must accept any interference received, including interference that may cause undesired operation.

NOTE: The manufacturer is not responsible for any radio or TV interference caused by unauthorized modifications or changes to this equipment. Such modifications or changes could void the user's authority to operate the equipment.

NOTE: This equipment has been tested and found to comply with the limits for a Class B digital device, pursuant to part 15 of the FCC Rules. These limits are designed to provide reasonable protection against harmful interference in a residential installation. This equipment generates uses and can radiate radio frequency energy and, if not installed and used in accordance with the instructions, may cause harmful interference to radio communications. However, there is no guarantee that interference will not occur in a particular installation. If this equipment does cause harmful interference to radio or television reception, which can be determined by turning the equipment off and on, the user is encouraged to try to correct the interference by one or more of the following measures:

- Reorient or relocate the receiving antenna.
- Increase the separation between the equipment and receiver.
- Connect the equipment into an outlet on a circuit different from that to which the receiver is connected.
- Consult the dealer or an experienced radio/TV technician for help.

The SAR limit of USA (FCC) is 1.6 W/kg averaged over one gram of tissue. Device types GLXSS Pro (FCC ID: 2AKLNG20A1) has also been tested against this SAR limit. The highest SAR value reported under this standard during product certification for use when properly worn on the body is 0.359 W/kg.

Safety and Security Policy

Please read carefully before using product

Basics

Please read carefully before using product:

1. When you open up the package, device is not fully charged.
2. Please ensure your safety for using this product when driving (vehicles, aircrafts or vessels), riding, skydiving, gliding, drifting, skiing, surfing, rock climbing, or doing other extreme sports.
3. The display on GLXSS Pro is located on the top of right eye, please avoid watching it for too long.
4. This product is limited to daily normal waterproof, it is not designed to use in the rain or under the water.
5. This product is not designed for users under 18s, these users must use the product under adult supervisions.
6. The normal working temperature for this product is from 0°C to 55°C .
7. Please do not drop, throw or try to bent product and accessories.
8. Please follow safety precaution when using this product, to prevent possible injury and penalty. Please remember and follow all the safety regulation, operation instruction and warnings.

*** In order to reduce the chance to get body injure, electric shock, fire disaster and product damage, please follow these precautions.**

Electrical Safety

Use exclusive battery and charger for this product when charging. It may cause danger when using other accessories, and make the warranty invalidated.

Use correct external electrical power

Product is only designed for using the type of electrical powers that marked on voltage power identification. Please consult your authorized service provider or local electricity company. For product require batteries or other electrical powers, please check the

attached Instruction Manual.

Please avoid dropping your device

If you dropped the devices or batteries, especially on hard ground surface, please check if they are damaged, and give it to customer service for further examinations.

Battery leakage

Please avoid to contact leaked liquid with eyes, skin or clothes. If contact occurs accidentally, please rinse thoroughly with water, then go to hospital as soon as possible.

Particular attention, please let leaked battery stay away from fire, to avoid fire disaster or explosion.

Failure and damaged product

Please do not try to disassemble devices and accessories, only authorized professional technicians are qualified to repair devices and accessories.

Accessories

1. Use only authorized accessories.
2. Avoid connect to incompatible product and accessories.

Avoid direct sunshine

Keep this product far away from extreme humidity and temperature situation. Do not leave product inside the car, or environment temperature higher than 55°C , e.g. car dashboard, balcony, direct sunshine behind glass, or under strong ultraviolet rays. This may cause product damage, battery over heat, and danger to vehicles.

Environmental limitation

Please do not use product in the following area: gas station, bunker, chemical factory, any blasting engineering area, explosive gas environment (e.g. bunker, under vessel deck, chemical factory, fuel/chemical transportation or storage), area with chemical product and powder in the air (e.g. dust or metal powder). Please note, in these area, even little spark may cause fire and explosion, or worse, physical disability or death.

Other protective actions

1. Please treat your devices and accessories carefully, keep it away from dust.
2. Please do not expose devices and accessories along with explosive or combustible stuffs.
3. Please do not use acrid chemical matters, clean solvent or spray to clean devices and accessories.
4. Please use soft cloth to clean the display on GLXSS Pro, do not scratch it with sharp objects.
5. Please check your local laws and regulations for handling electronic devices.

Administration identity

For administration purpose, this product name is GLXSS Pro.

To guarantee the reliability and safely for this product, please only use these accessories on your GLXSS Pro.

1. B18650-2 battery.
2. Authorized charger, nominal output 5V direct current, minimal 1A, Maxium 2A, or use USB cable to charge.
3. LLVision authorized USB 3.0 Type-C cable.

RoHS

This product follows 2011/65/EU instruction made by EC on June 8, 2011: limitation of using dangerous matters for electronic devices (RoHS) and amendment.

Warranty

This warranty is only valid for the first customer of this product.

When product is under warranty, LLVision or its delegate dealer will decide whether to follow articles in this policy, to provide free repair or exchange service for defective items. Similar function product might be used during repair. LLVision will return repaired product or replaced similar function product to customers. All defective parts belong to LLVision.

This warranty is only valid for original supplied hardware, not any software or other devices.

For product repaired or exchanged by LLVision, will renew a 3 month warranty after repair or exchange.

Before send any product to repair service, please backup data and delete all classify or personal information. LLVision will not be responsible for the damage of any program, data or removable media which are not backed up.

This warranty does not suit defective caused by these actions:

1. Product serial number, accessories date number, waterproof sticker or warranty seals get removed, erased, dirty, modified or hard to identify.
2. Wear and tear under normal use.
3. Not follow policy, not hold carefully, expose to vapour, use in high temperature or extreme environment, fast environment change, tear and wear, oxidize, unauthorized modification or connection, unauthorized open or repair, use unauthorized backup parts to repair, accident, overexert, or other irrational operation (include but not limited to defective consumable parts), unless the defective caused by material or manual production. This warranty does not include broken surface, include but not limited to display, LCD screen or camera lens crack or scratches.
4. Short-circuit battery, or battery housing or packaging broken or

shows visible mutilated signs, or defective batteries that were used for unauthorized scenarios.

5. Product dropped on hard surface, or suffered external force extrusion, result as appearance damage or functional defective.

If product was defective, customers should:

1. Use this policy as reference, find the problem and try to solve it.

2. If problem can not be solved after read this policy, customer should contact with local dealer or visit LLVision's official website www.llvision.com , to receive detail information.

3. Before contact with LLVision customer service or delegate dealer, please prepare these materials:

- Product model and serial number.
- Customer's address and contact information.
- Customer's original receipt, or a copy of it.

LLVision will contact with customer to check the time and method of send defective product. If defective product is still under warranty, LLVision will pay for the deliver fee caused by sending defective product to LLVision and sending repaired product back to customer.

For more detailed information, please visit our official website or call customer service

Official website www.llvision.com

Customer service 400 0525 102

Hazardous material declare

Component	Hazardous material or elements					
	Pb	Hg	Cd	Cr(VI)	PBB	PBDE
GLXSS Pro	<input type="radio"/>	<input type="radio"/>	<input type="radio"/>	<input type="radio"/>	<input type="radio"/>	<input type="radio"/>
glass host	<input type="radio"/>	<input type="radio"/>	<input type="radio"/>	<input type="radio"/>	<input type="radio"/>	<input type="radio"/>
Circuit and component	<input type="radio"/>	<input type="radio"/>	<input type="radio"/>	<input type="radio"/>	<input type="radio"/>	<input type="radio"/>
Battery	<input type="radio"/>	<input type="radio"/>	<input type="radio"/>	<input type="radio"/>	<input type="radio"/>	<input type="radio"/>
Charger	<input type="radio"/>	<input type="radio"/>	<input type="radio"/>	<input type="radio"/>	<input type="radio"/>	<input type="radio"/>
Cable	<input type="radio"/>	<input type="radio"/>	<input type="radio"/>	<input type="radio"/>	<input type="radio"/>	<input type="radio"/>

Means the hazardous matter in all homogeneous materials in this component is less than GB/T26572-2011 standard.

Means the hazardous matter in one homogeneous materials in this component exceeded GB/T26572-2011 standard.



The number 5 means EFUP is 5 years. During this period, under normal use, the hazardous matter in battery will not leak. There is no environment pollution, and will not cause damage to physical healthy or property.

The number 20 means EFUP is 20 years. During this period, under normal use, the hazardous matter in glasses (except batteries) and accessories will not leak. There is no environment pollution, and will not cause damage to physical healthy or property.

LLVision