

Kinetic wireless doorbell

User Manual

 Before operating, please read this manual carefully. Please follow the instructions to operate properly.

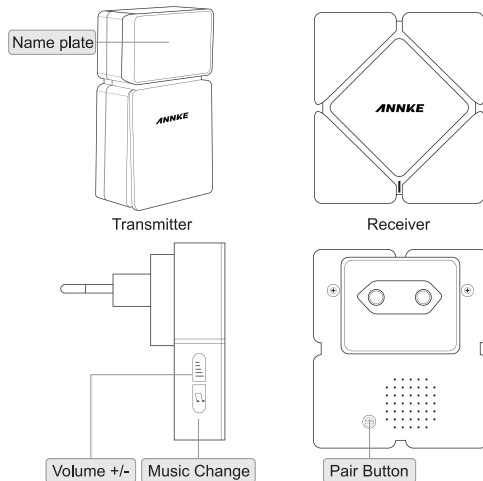

1 Attention

- 1) Avoid locating Transmitter/Receiver on or directly near metallic surface as this may reduce the operation range.
- 2) When locating Transmitter onto a UPVC door frame, always check the operating performance before final installation.

2 Pack Contents

Transmitter x1, Receiver x1, Adhesive Pad x1, User Manual x1, Screws x 2

3 Installation Instruction

Note: Please run a test before installation.

- 1) Receiver
Plug the receiver into the outlet. The receiver will perform better if keeping it away from electric equipment.
- 2) Transmitter
Before mounting the transmitter, please run a test.



- 1 Clean the surface where you intend to mount the transmitter and the back of the transmitter.
2. Stick the transmitter to the wall by adhesive pad
3. Press the transmitter for 30 seconds

Note:

- DO NOT install transmitter on UPVC door frames.
- DO NOT install transmitter on Metal surface.

4 Pairing and cancel pairing

Pairing

Steps:

- 1 Power the Receiver on
- 2 Press the Pair button on the back of the receiver for 5 seconds until the indicator flashes
- 3 Press the Transmitter to pair the receiver and the Transmitter.

Cancel pairing

- 1 Power the Receiver on
- 2 Press the Pair button on the back of the receiver for 8 seconds until the indicator flashes blink
- 3 Cancel pairing successfully.

5 Trouble Shooting

Receiver does not sound	<ol style="list-style-type: none"> 1 Make sure the receiver is plugged in. 2 Make sure the transmitter has been synchronized with receiver.
-------------------------	---

Indicator light off	<ol style="list-style-type: none"> 1. Make sure receiver is plugged in. 2. Check if receiver is in Learn Mode.
Reduced range	<ol style="list-style-type: none"> 1. Metal structures, including door frames, can result in reduced transmission range. Avoid mounting transmitter or receiver on or near metal structures. 2. Other electric equipment can cause radio interference that affects your receiver. 3. Walls, doors and ceilings will reduce the range.

Attentions: If the issue is still not resolved by the above methods, please unplug the receiver and wait for about 3 seconds till the indicator light off, then replug it in. If that does not solve the problem, please contact customer service.

6 Specifications

Specifications	Receiver	Transmitter
Power Supply	AC 100-240V	-
Operating Temperature	-10°C ~ +40°C	-20°C ~ +50°C
Working range	110m (open area)	
RF Frequency	433MHz	
Sound Level	85dBA@3ft(1m)	-
Power Consumption	<280mW	-
Water Proof	-	Yes
Operating Forces	-	10N
Dimensions	90X81X55 mm	79X48X22 mm
Weight	87 g	50 g
Ring Tone	25 polyphony ring tones	-



This marking indicates that this product should not be disposed with other household wastes throughout the EU. To prevent possible harm to the environment or human health from uncontrolled waste disposal, recycle it res possibly to promote the sustainable reuse of material resources. To return your used device, please use the return and collection systems or contact the retailer where the product was purchased. They can take this product for environmental safe recycling.

FCC Caution:

This device complies with part 15 of the FCC Rules. Operation is subject to the following two conditions: (1) This device may not cause harmful interference, and (2) this device must accept any interference received, including interference that may cause undesired operation.

Any Changes or modifications not expressly approved by the party responsible for compliance could void the user's authority to operate the equipment.

Note: This equipment has been tested and found to comply with the limits for a Class B digital device, pursuant to part 15 of the FCC Rules. These limits are designed to provide reasonable protection against harmful interference in a residential installation. This equipment generates uses and can radiate radio frequency energy and, if not installed and used in accordance with the instructions, may cause harmful interference to radio communications. However, there is no guarantee that interference will not occur in a particular installation. If this equipment does cause harmful interference to radio or television reception, which can be determined by turning the equipment off and on, the user is encouraged to try to correct the interference by one or more of the following measures:

- Reorient or relocate the receiving antenna.
- Increase the separation between the equipment and receiver.
- Connect the equipment into an outlet on a circuit different from that to which the receiver is connected.
- Consult the dealer or an experienced radio/TV technician for help.