

105G双铜纸，双面单黑印刷，风琴折页

尺寸: 90*100mm

User manual

2.4G Wireless keyboard and mouse combo

www.links9.us

Thank you very much for using this product, please read the manual carefully before use.

packing list

- 1* Keyboard
- 1* Mouse
- 1* USB Receiver
- 1* User manual
- 1* USB To Type-C charging cable

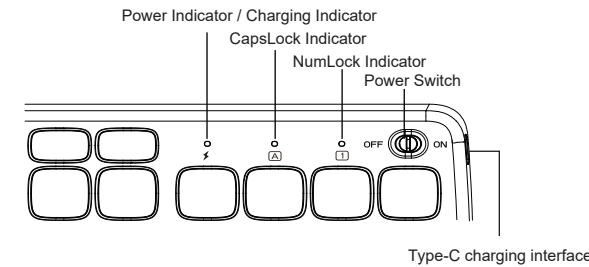

- ⚡ After the keyboard is powered on, the red light will turn on for 3S and then turn off
Red light flashes when the battery is too low; red light when charging, green light when fully charged.
- A Turn on the upper and lower case button, the green light is on; press it again to turn off.
- ① Turn on the upper and lower case button, the green light is on; press it again to turn off.

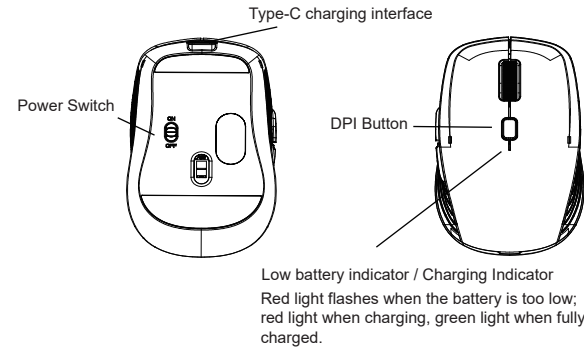

Open the cover from this button and take out the USB receiver; Then close the cover down to ensure that the mouse can be used normally.

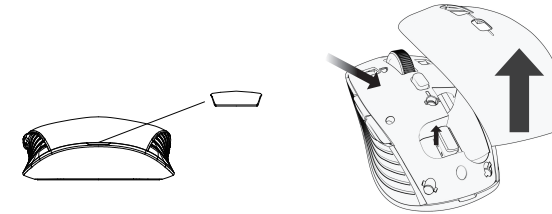

Keyboard and mouse pairing and connection steps

1. When you get a try of the product, the product is already paired.
2. Turn on the power switch of the keyboard and mouse, insert the 2.4G receiver into the USB port of the computer, and you can use it directly.

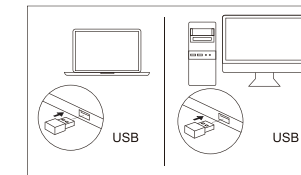

NOTE: This equipment has been tested and found to comply with the limits for a Class B digital device, pursuant to part 15 of the FCC Rules. These limits are designed to provide reasonable protection against harmful interference in a residential installation. This equipment generates uses and can radiate radio frequency energy and, if not installed and used in accordance with the instructions, may cause harmful interference to radio communications. However, there is no guarantee that interference will not occur in a particular installation. If this equipment does cause harmful interference to radio or television reception, which can be determined by turning the equipment off and on, the user is encouraged to try to correct the interference by one or more of the following measures:

- Reorient or relocate the receiving antenna.
 - Increase the separation between the equipment and receiver.
 - Connect the equipment into an outlet on a circuit different from that to which the receiver is connected.
 - Consult the dealer or an experienced radio/TV technician for help
- Changes or modifications not expressly approved by the party responsible for compliance could void the user's authority to operate the equipment.

This device complies with Part 15 of the FCC Rules. Operation is subject to the following two conditions:

- (1) this device may not cause harmful interference, and
- (2) this device must accept any interference received, including interference that may cause undesired operation.

Product charging

When the power of the keyboard or mouse is too low, the red indicator light on the product will start to flash until it is completely turned off. Please plug in the charging cable in time to ensure normal use.
When the power supply is too low: the transmission of the keyboard and mouse will be delayed, stuck, and the connection will be unstable.

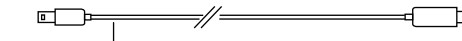

Keyboard Specifications

Project name	Specifications
Applicable system	Default win 8 (and above) system, MAC OS
Battery specifications	210 mAh
Standby time	600 hours
Button life	3 million tap tests
Working current	≤ 2 mA
Continuous working time	260 hours
Product Size	419*220*19mm
Effective transmission distance	Within 10 meters
Wake-up method	Press any key to wake up

Project name	Specifications
DPI	800-1200 (default) -1600
Battery specifications	300 mAh
Standby time	600 hours
Effective transmission distance	Within 10 meters
Working current	≤ 2 mA
Continuous working time	300 hours
Product Size	102*62*35.5mm
Wake-up method	Press any key to wake up

If you have any problem , please feel free to contact us.