

Can't connect? Need help?



DO NOT RETURN THIS  
PRODUCT TO THE STORE

Geeni support:  
[support@mygeeni.com](mailto:support@mygeeni.com)  
**1 (888) 232-3143**  
Tap "Support" in the Geeni app

SWITCH  
START GUIDE

**MERKURY**  
I N N O V A T I O N S

Thank you for purchasing your Merkury smart home product. Ready to get started? Download the Geeni app to manage your switches (and all other Merkury devices) straight from your phone or tablet. Easily connect to your home Wi-Fi and control multiple devices with the touch of your fingertips.

## Contents

Download & Register	2-4
Install	5-7
Reset & Restart	8-9
Connect (Easy Mode)	10-11
Connect (AP Mode)	12-13
FAQ, Troubleshooting, Notices	14-17

### Important Information:

Before installing, read and follow all precautions, including the following:

#### CAUTION: RISK OF ELECTRIC SHOCK OR FIRE

This device must be installed and used in accordance with the National Electric Code. Please consult a licensed electrician if you are uncomfortable or unfamiliar with electrical work. Disconnect power before installing or modifying this product.

**CAUTION:** Suitable for indoor use only.

#### Support:

If you encounter any issues, please contact us at [support@mygeeni.com](mailto:support@mygeeni.com) for help.

To explore our full selection of products, visit us at: [www.mygeeni.com](http://www.mygeeni.com)

**Toll-free support: 1 (888) 232-3143**

© 2019 Merkury Innovations - 45 Broadway 3rd FL, New York NY 10008

The illustrated product and specifications may differ slightly from those supplied. Geeni is a trademark of Merkury Innovations LLC. iPhone, Apple and the Apple logo are trademarks of Apple Inc., registered in the U.S. and other countries. App Store is a service mark of Apple Inc. Galaxy S is a registered trademark of Samsung Electronics Co. Ltd. Google, Google Play, and related marks and logos are trademarks of Google LLC. IOS is a registered trademark of Cisco in the U.S. and other countries and is used under license. Amazon, Alexa and all related logos are trademarks of Amazon.com, Inc. or its affiliates. All other trademarks and trade names are those of their respective owners.

Made in China

**NOTE:** This equipment has been tested and found to comply with the limits for a Class B digital device, pursuant to part 15 of the FCC Rules. These limits are

designed to provide reasonable protection against harmful interference in a residential installation. This equipment generates uses and can radiate radio frequency energy and, if not installed and used in accordance with the instructions, may cause harmful interference to radio communications. However, there is no guarantee that interference will not occur in a particular installation. If this equipment does cause harmful interference to radio or television reception, which can be determined by turning the equipment off and on, the user is encouraged to try to correct the interference by one or more of the following measures:

- Reorient or relocate the receiving antenna.
- Increase the separation between the equipment and receiver.
- Connect the equipment into an outlet on a circuit different from that to which the receiver is connected.
- Consult the dealer or an experienced radio/TV technician for help.

This equipment complies with FCC radiation exposure limits set forth for an uncontrolled environment. This equipment shall be installed and operated with minimum distance 20cm between the radiator & body.

Changes or modifications not expressly approved by the party responsible for compliance could void the user's authority to operate the equipment. This device complies with Part 15 of the FCC Rules. Operation is subject to the following two conditions:

- (1) this device may not cause harmful interference, and
- (2) this device must accept any interference received, including interference that may cause undesired operation.

This device contains licence-exempt transmitter(s)/receiver(s) that comply with Innovation, Science and Economic Development Canada's licence-exempt RSS(s). Operation is subject to the following two conditions:

- (1) This device must not cause interference.
- (2) This device must accept any interference, including interference that may cause undesired operation of the device.

L'émetteur/récepteur exempt de licence contenu dans le présent appareil est conforme aux CNR d'Innovation, Sciences et Développement économique Canada applicables aux appareils radio exempts de licence. L'exploitation est autorisée aux deux conditions suivantes :

- (1) L'appareil ne doit pas produire de brouillage.
- (2) L'appareil doit accepter tout brouillage radioélectrique subi, même si le brouillage est susceptible d'en compromettre le fonctionnement.

This equipment complies with IC exposure limits set forth for an uncontrolled environment. This equipment shall be installed and operated with minimum distance 20cm between the radiator & body.

Cet équipement est conforme aux limites d'exposition IC définies pour un environnement non contrôlé. Cet équipement doit être installé et utilisé avec une distance minimale de 20 cm entre le radiateur et la carrosserie.

CAN ICES-3 (B) / NMB-3 (B)

This Class B digital apparatus complies with Canadian ICES-003.  
(Cet appareil numérique de la Classe B conforme à la norme NMB-003 du Canada.)

## Troubleshooting

### Can't connect to Wi-Fi?

Make sure you entered the correct Wi-Fi password during the Wi-Fi setup. Check whether there are any Internet connection problems. If the Wi-Fi signal is too weak, reset your Wi-Fi router and try again.

### Reset the device

To reconnect to Wi-Fi, hold down the Reset button for 3 seconds.

- Reset 1 time (press and hold) to reach Easy Mode, indicated by rapidly blinking white light. Refer to page 10 to connect in Easy Mode.
- Reset 2 times (press and hold) to reach AP Mode, indicated by slowly blinking white light. Refer to page 12 to connect in AP Mode.

### System Requirements

- Existing neutral wire
- Existing multi-location light switch with box more than 2 inches deep.
- Mobile device running iOS® 9 or higher or Android™ 4.1x or higher
- Existing 2.4GHz Wi-Fi network (not compatible with 5GHz Wi-Fi networks)
- Geeni app

**IMPORTANT:** Please consult a licensed electrician if you cannot locate a neutral wire or are unfamiliar with electrical installations.

### Technical Specifications

- Input: 100V-240V, 50/60Hz
- Wireless Frequency: 2.4GHz
- Wireless Standard: IEEE802.11 b/g/n
- Max Output: 800W INC, 400W CFL, 400W LED
- Minimum Load Required: 120V, 10W INC, 5W LED, 5W CFL

### FCC Notice:

This device complies with Part 15 of the FCC Rules. Operation is subject to the two following conditions:

1. This device may not cause harmful interference.
2. This device must accept any interference received, including interference that may cause undesired operation.

Note: This equipment has been tested and found to comply with the limits for a Class B digital device, pursuant to Part 15 of the FCC Rules. These limits are designed to provide reasonable protection against harmful interference in a residential installation.

**WARNING: RISK OF ELECTRIC SHOCK OR FIRE.** Please follow all safety instructions on page 17 before installing, servicing, or removing your switch.

## What's in the Box

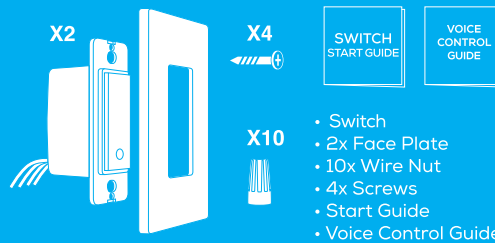

- Switch
- 2x Face Plate
- 10x Wire Nut
- 4x Screws
- Start Guide
- Voice Control Guide

## Get Ready

- Turn OFF power supply at the circuit breaker or fuse. Use a noncontact voltage tester to ensure that power is off. More than one disconnect switch may be needed to turn off power.
- Confirm that you are replacing a 3-way switch where 2 switches control one fixture.
- Make sure the existing switch box has a neutral wire.  
**IMPORTANT:** Please consult a licensed electrician if you cannot locate a neutral wire or are unfamiliar with electrical installations.

# 1

Download the Geeni app

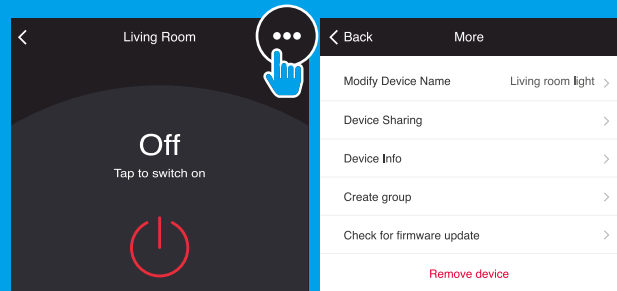
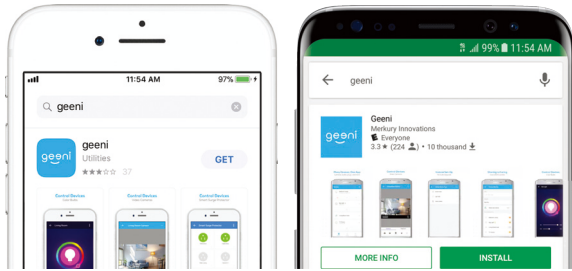

## 6. What's the wireless range?

The range of your home Wi-Fi is heavily dependent on your home router and the conditions of the room. Check with your router specifications for exact range data.

## 7. If my Wi-Fi/Internet goes down, will Geeni App still work?

Mercury products need to be connected to Wi-Fi in order to use them remotely.

## 8. What does the white light mean?

The white light indicates power. If the white light is on, the switch is receiving power; if it is off, it is not receiving power. The white light also indicates connection. If it is solid, the switch is connected; if it is flashing quickly, the switch is ready to connect using the Easy Mode (page 10); if it is flashing slowly, the switch is ready to connect using the AP Mode (page 12).

## Frequently Asked Questions

### 1. Can I share with family and friends?

Yes, you can share access to your Switch and any other Mercurly device. In the Geeni app, press the "Profile" button and click on "Device Sharing" to give or revoke sharing permissions. In order to share, the other user should already have downloaded the Geeni app and registered an account.

### 2. Can I group multiple Geeni devices together?

Yes, you can group multiple same-type devices by room, location, or however else you want. The same devices can be in multiple groups. For example, if you create a group for "Bedroom" and another group for "Entire House," your Bedroom lights can be included in both groups. From your main device list, click on one of the devices you want to group, press the "•••" button on the top right for advanced settings, and click "Create Group." You'll be able to name a new group and choose which devices you'd like to group together.

### 3. How many devices can I control?

Geeni's app can control an unlimited amount of devices in an unlimited amount of locations. Your router may have a limit of how many devices can be connected to one router.

### 4. My Mercurly device has a funny name. How do I rename it?

From your main device list, click on one of the devices you want to rename, press the "•••" button on the top right for advanced settings, and click "Modify Device Name" (or "Modify Group Name"). You'll then be able to choose a more familiar name.

### 5. What should I do if the device appears offline or is unreachable?

Make sure your Wi-Fi router is online and in range, and check that you have the latest Geeni functionality by clicking "Check for firmware update" in your device settings. If power is connected but the switch is not responding, hold down the Restart button to cycle the fuse and give the switch a jump start.

## 2

### Register a Geeni account

The first screenshot shows the registration screen with a back arrow, the title 'Register', and a 'Next' button. The second screenshot shows the verification and password creation screen with a back arrow, the title 'Register', and a 'Confirm' button.

**STEP 1**  
Enter your mobile phone number  
or email address.

**STEP 2**  
Enter the verification code  
and create a password.

# 2

Register a Geeni account, cont.

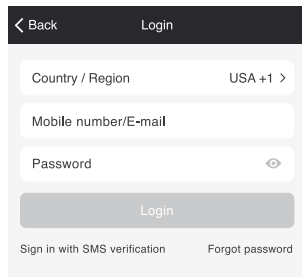

**STEP 3**  
Log into the app.

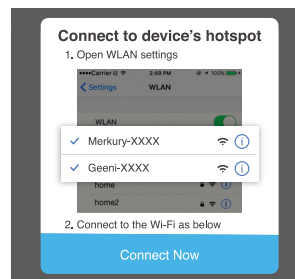

**STEP 4**  
Follow the instructions to choose the device from your Wi-Fi list.

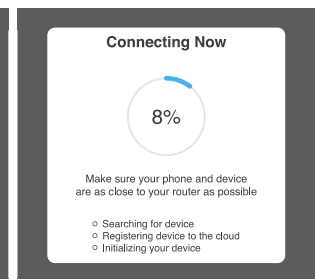

**STEP 5**  
The Geeni app will connect to your Switch.

**NOTE:** Geeni can't connect to 5GHz networks.

# 6 Connect: AP Mode

# 3 Install

**STEP 1**  
Make sure the switch's light is slowly flashing white.  
If not, reset to reach AP mode (page 9).

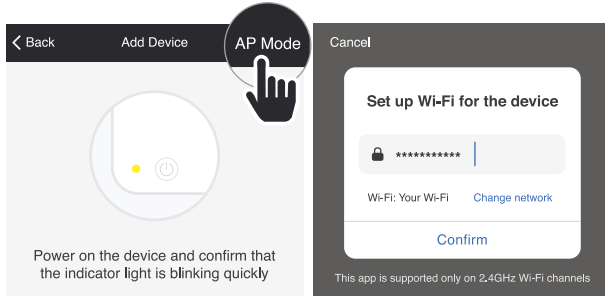

**STEP 2**  
Open the Geeni app. In the top corner of the Devices screen, click (+).  
Choose "Smart Power".  
Choose "AP Mode" in the top corner.

**STEP 3**  
Press "Next" and enter your Wi-Fi details.

**STEP 1**  
Shut off power at the circuit breaker for the switch that you are replacing. More than one disconnection may be required to turn off power. Use a noncontact voltage tester to ensure that power is off.

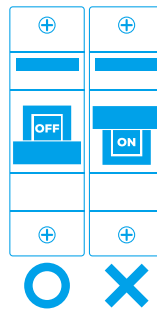

**STEP 2**  
Make sure the existing switch box has a neutral wire\*. Remove old switch by disconnecting all wires.  
\*Neutral wire is typically white.

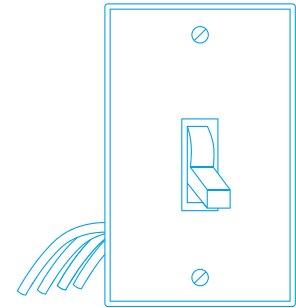

Disconnect all wires.

# 3 Install, cont.

## STEP 3

1. Connect Switch 1 & Switch 2's neutral wire (white) & load's neutral wire to your home's neutral wire.
2. Connect Switch 1's live wire (black) with load's live wire.
3. Connect Switch 2's live wire (black) to your home's live wire.
4. Connect Switch 1 & Switch 2's SW1 wires (brown) together.
5. Connect Switch 1 & Switch 2's SW2 wires (blue) together.
6. Connect Switch 1 & Switch 2's ground wire (green) to your home's ground wire.
7. Check that all wire nuts are secured.

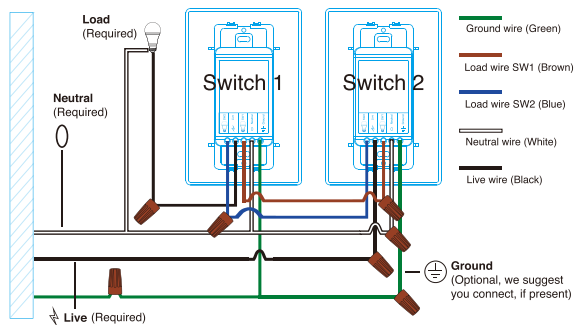

6

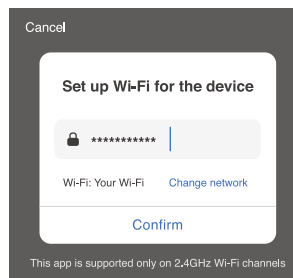

**STEP 3**  
Enter your Wi-Fi network and password.

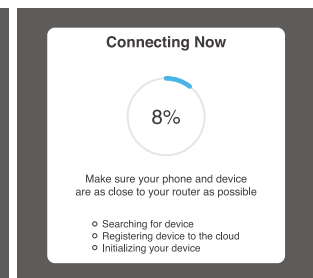

**STEP 4**  
The Geeni app will connect to your switch.

**NOTE: Geeni can't connect to 5GHz networks.**  
\*If the connection fails, try to connect using AP Mode.

11



# 5

## Connect: Easy Mode

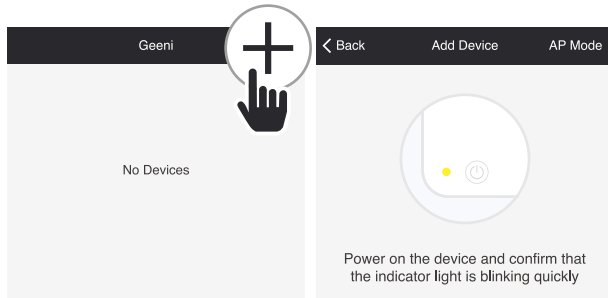

**STEP 1**  
Open the Geeni app. In the top corner of the Devices screen, click (+).  
Choose "Smart Power".

**STEP 2**  
Make sure the switch's light is rapidly flashing white.  
If not, reset to reach Easy Mode to connect (Page 9).  
Press "Next Step" in the app.

# 3

## Install, cont.

**STEP 4**  
Use screws to secure the switch into your wall. Snap on the included faceplate.

**STEP 5**  
Restore power by reversing step 1.

**STEP 6**  
Once power is connected, the white indicator light will blink to indicate that the switch is ready to connect to Wi-Fi. Refer to page 9 for reset instructions.

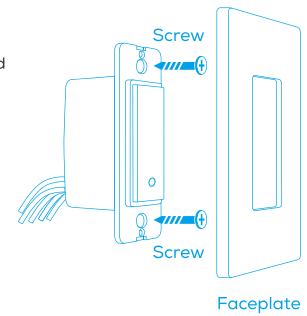

**WARNING: RISK OF ELECTRIC SHOCK OR FIRE.** Please follow all safety instructions on page five before installing, servicing, or removing your switch.

## 4 Reset and restart

**QUICK TIP:** On the Switch Faceplate, the Reset button is also known as the Power Reset button and the Restart button is also known as the Wi-Fi Reset button.

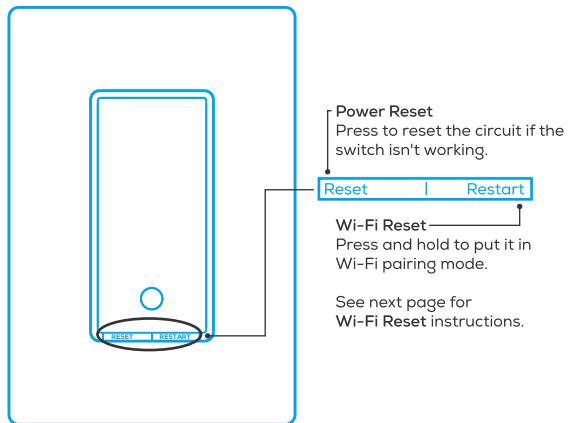

8

## 4 Reset and restart, cont.

**How do I reset the switch and what does the blinking light mean?**

Reset the switch by pressing and holding the Wi-Fi Reset (Restart) button for 3 seconds until the indicator begins to rapidly flash. The Wi-Fi Reset button is located on the bottom right side of the switch (not the switchplate) labeled "Restart".

- Reset one time (press and hold) to reach Easy Mode (Rapidly blinking white, 2x per second)
- Reset again (press and hold) to reach AP Mode (Slowly blinking white, every 3 seconds)

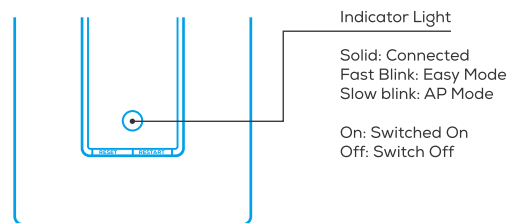

9