

User Manual for defunc TRUE Wireless Stereo Bluetooth Earbuds + Power bank

Thank you for choosing defunc TRUE Wireless stereo Bluetooth earbuds with Power bank, this manual will help you know how to use your Bluetooth earbuds, before using Bluetooth headset, you should know and familiar with the Bluetooth functions of your mobile phone.

Accessories List

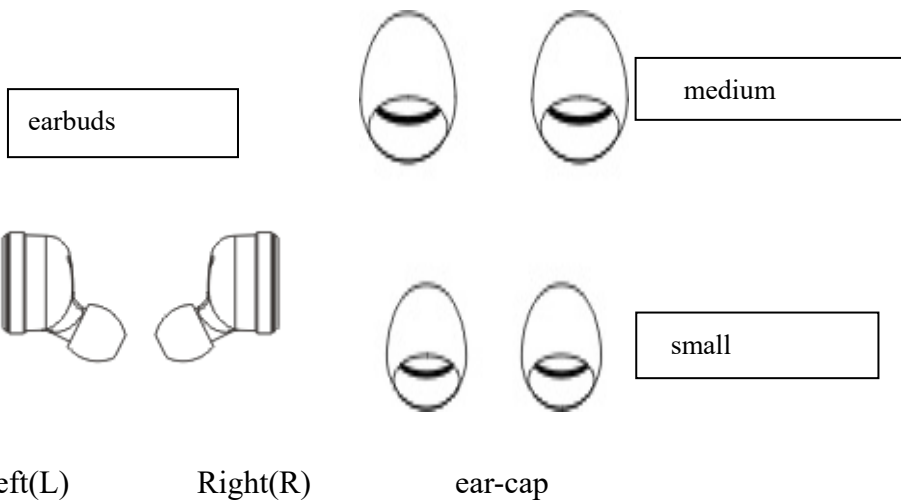

Power bank

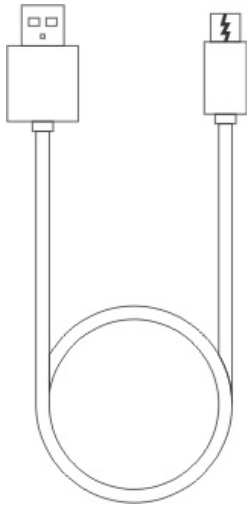

USB cable

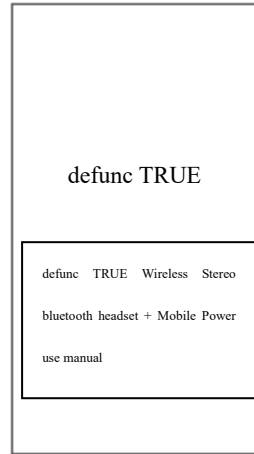

User manual

Product diagram

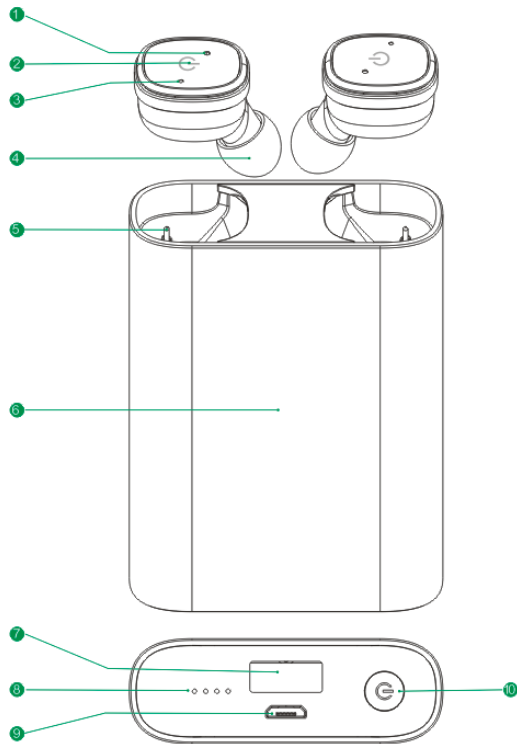

- 1: LED light
- 2: Power on/off
- 3: Microphone
- 4: Ear Cap
- 5: Charge Port

- 6: Power bank
- 7: USB charging port
- 8: Power bank Indicator light
- 9: Micro USB charging port
- 10: Power Indication light

Parameters

Bluetooth version: 5.0
Earbuds Battery: 50 mAh
Power bank Battery: 2100 mAh
Power bank Voltage: 5V
Transmission frequency: 20hz-20khz
Bluetooth protocol: A2DP/HFP/HSP/AVRCP/SPP

Wearing

1: In order to get the best sound quality, please select the suitable ear-caps for your ears. When using outdoors, please put your cell phone on the same side of your right ear.



Bluetooth® set up

1. Put the earbuds into the charging stand

Put the earbuds into the charging stand, while the red indicator is on, which means it is charging. When charging finished, the indicator lights on the earbuds will be off after 5 times flashing, the earbuds charging time takes about 45 minutes. (If the charging stand in low power. Please charge it at first.)

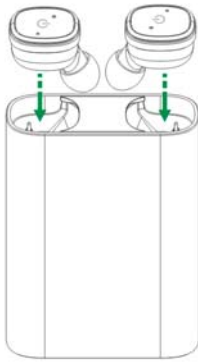

2. Take out the earbuds

Take out the “L” and “R” earbuds from the charging stand, the earbuds will power on automatically, after 10 seconds, the “L” and “R” will finish pairing automatically, then the red/blue indication light on the “R” headset will alternatively flashing, “L” headset will light off.

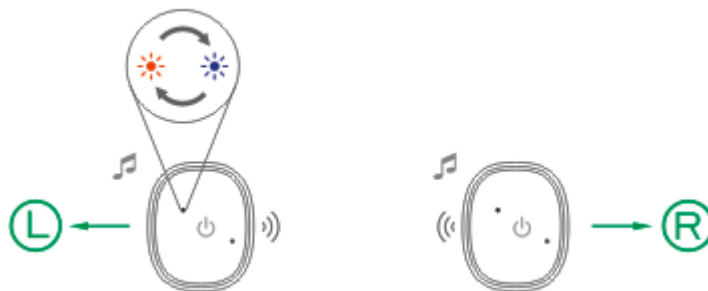
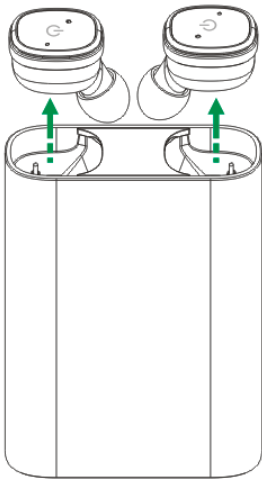

Red & blue light alternatively flashing light off

3. Enable Bluetooth on your device, select “defunc TRUE” in the Bluetooth list and accept pairing. If your device doesn’t connected, please turn off Bluetooth on your device and turn it on again.

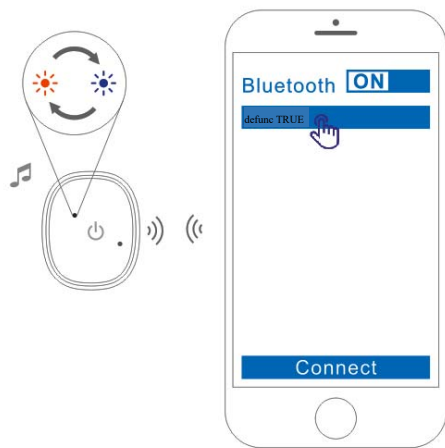

4. For next time use, when you take out the earbuds from charging stand, the earbuds will pair to your device automatically.

Charging Instruction

How to charge the power bank

Connect it to the computer or USB Charger via the USB cable.

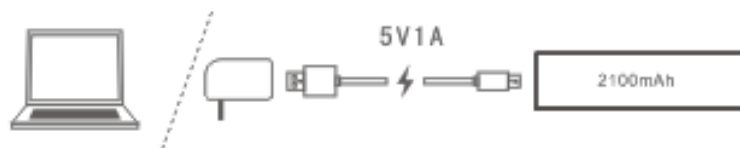

While low battery, the first LED indicator will keep flashing in blue colour then light off.

While charging it, the first LED indicator will keep flashing in blue colour.

While charging is finished, all 4 LED indicators will keep lighting on.

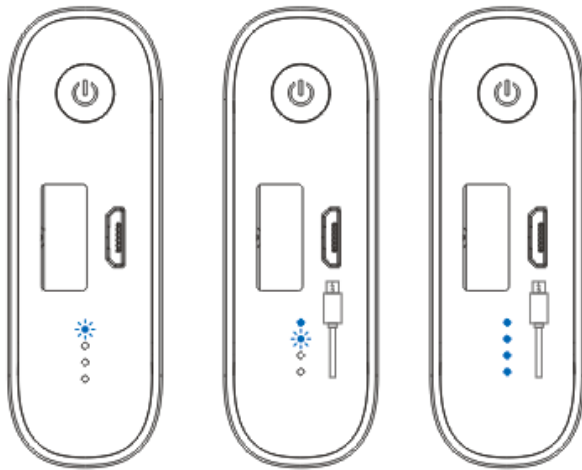

First light flashing

LED flashing

Four Lights lighting on

Earbuds Battery Display

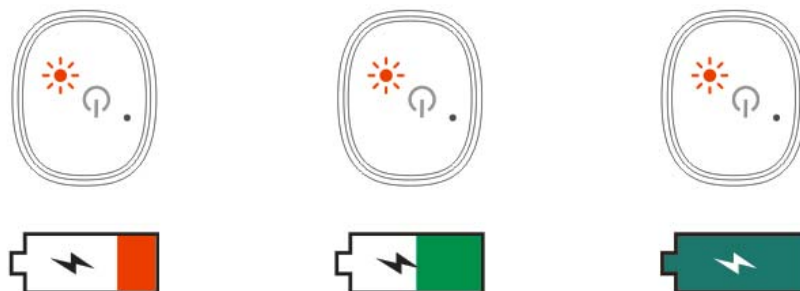

Red light keep flashing means low power.

Red light keep lighting on means charging.

Red light flashing 5 times and then light off while charging is finished.

Power bank function

Connect the USB cable to the USB port for charging your device.

Function list:

1 Phone Call

Bin-aural mode: Call status, only the main earbuds (right earbuds) has sound.

Single ear mode: Call status, single earbuds has sound (left and right earbuds can work separately)

Coming call status: Single click to answer the phone, long press for two seconds to reject the call.

Standby status: Double-click the main-earbud (rights earbud) key, will dial back the last number automatically.

Call Status: Single click the key to hang up the call, double-click the key to transfer the call to the phone.

2. Play music

Play: single click the key

Pause: single click the key

Next: Double click the key when playing the music

3. Power off

Put the earbuds back into the charging stand or long press the earbuds key for 4 seconds.

Trouble shooting

Fault	Cause	Solutions
cant power on	Earbuds low power	Charge the earbuds
Earbuds' red light keep flashing	Earbuds low power	Charge the earbuds
Charging without indication	The earbuds didn't connected well	Adjust earbuds position
Automatically shutdown	Earbuds low power	Charge the earbuds
The earbud has an echo.	The volume may too loud or the environment may too noisy.	Adjust the volume or change the environment.
The earbuds are noisy.	Outside environment is bad or too far away from the phone.	Change position, or move close to the mobile phone
Sound is low	The headset is not wearing correctly or the volume is too low.	Adjust the earbud position or adjust the phone volume
Signal Intermittent	Outside environment interference or too far away from the phone	Change to better environment or move close to your mobile phone
Earbud has no sound	Pairing failed	Pair the headset correctly

Warning

1: Do not keep the equipment in too low or too high temperature for a long time, extreme temperatures may cause equipment to deform and reduce the battery capacity, also shorten the service life of the equipment.

2: Don't use the equipment in heavy rain, thunderstorms may cause equipment to malfunction, and increase the risk of electric shock.

3: Please do not disassemble or refit earbuds for any reason, which may cause earbudss to malfunction

or burn down, please send the earbuds to the dealer for maintenance.

4: Please put the equipment and accessories in places where children and pets are not accessible, so as to avoid accidents.

Compliance with FCC regulations

Caution! The user is cautioned that changes or modifications not expressly approved by the party responsible for compliance could void the user's authority to operate the equipment. This equipment has been tested and found to comply with the limits for a Class B digital device, pursuant to Part 15 of the FCC Rules. These limits are designed to provide reasonable protection against harmful interference in a residential installation. This equipment generates, uses and can radiate radio frequency energy and, if not installed and used in accordance with the instructions, may cause harmful interference to radio communications. However, there is no guarantee that interference will not occur in a particular installation. If this equipment does cause harmful interference to radio or television reception, which can be determined by turning the equipment off and on, the user is encouraged to try to correct the interference by one or more of the following measures:

- Reorient or relocate the receiving antenna.
- Increase the separation between the equipment and receiver.
- Connect the equipment into an outlet on a circuit different from that to which the receiver is connected.
- Consult the dealer or an experienced radio/TV technician for help.

This device complies with Part 15 of the FCC Rules. Operation is subject to the following two conditions: (1) this device may not cause harmful interference, and (2) this device must accept any interference received, including interference that may cause undesired operation.

THE SPECIFICATION AND EXTERNAL APPEARANCE OF THE HEADPHONES MAY BE SUBJECT TO CHANGE WITHOUT PRIOR NOTICE. If at any time in future you should need to dispose of this product, please note that waste electrical products should not be disposed of household waste. Please recycle where facility exist. Check with your local authority or retailer for recycling advice.