

Smart Heating Jacket User Manual



Flexwarm

www.flexwarm.com

5 heating zones

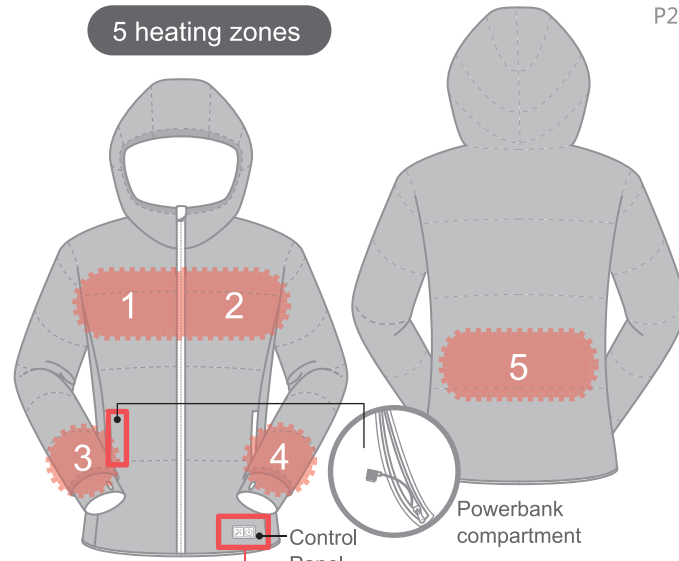

Rated Voltage: 5V DC
Rated Power: 6W
Rated Powerbank Output: $\geq 5V/2A$ (5V/2A is recommended)
Temperature Range: 37°C — 65°C (98.6°F—149°F)

P2

Instruction on how to use

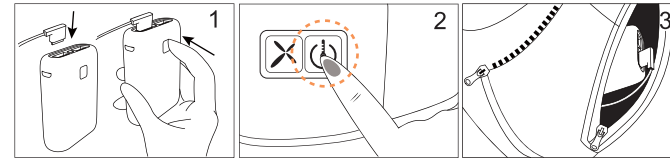

1. Pull out the cable from the powerbank compartment, connect the jacket with the powerbank, then turn on the powerbank (Pic. 1)
2. Press and hold the on/off () switch until the light is on (Pic. 2)
3. Put the powerbank into the powerbank compartment then zip it up. (Pic. 3)

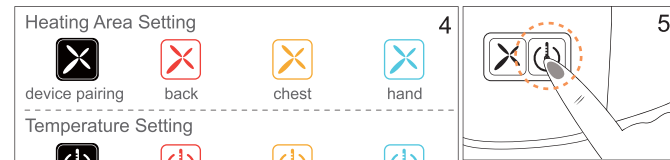

4. After the jacket is switched on, you can choose heating area and temperature (Pic. 4)
 - (1) Press "X" to choose heating area
(White: Cycle Heating Mode/Red: back/Yellow: chest/Blue:hand)
 - (2) Press " " to choose temperature
Red:High Power 65°C/149°F
Yellow:Medium Power 45°C/113°F
Blue:Low Power 37°C/98.6°F
5. Press and hold " " until the light is switched off (Pic. 5)

P3

App Control

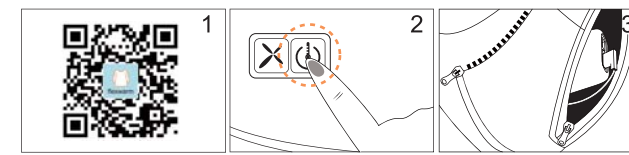

1. Scan the QR code to download the Flexwarm app. (Pic. 1)
2. Press and hold the on/off switch until the light is blinking in white color. (Pic. 2)
3. Pull out the cable from the powerbank compartment, connect the jacket with the powerbank, then turn on the powerbank. (Pic. 3)

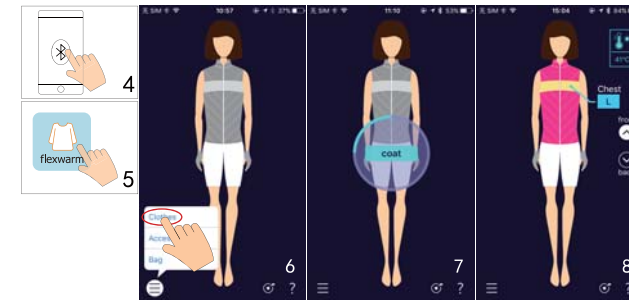

4. Turn on the Bluetooth on your handheld device. (Pic. 4)
5. Turn on the Flexwarm App.(Pic. 5)
6. Tap " " at the lower left corner and choose clothes.(Pic. 6)
7. Tap the chest area and the pairing process will be initiated.(Pic. 7)
8. Pairing succeed, temperature acquired and displayed on the app.(Pic. 8)

P4

Flexwarm Warranty Card

Thank you for supporting us at Indiegogo, we are hereby offering you the following warranty terms and conditions.

- 1) The period of warranty shall start from the date of delivery of the product to the customer and shall cover a period of ONE(1) year.
- 2) Every and all parts of the product are under Flexwarm warranty coverage.(against any defect that may occur during production, assembly and/or defective parts)
- 3) Within the warranty period, if the product fails either because of general material or workmanship, it will be replaced with shipping costs on the customer's account.
- 4) Product replacement or refund is mandatory depending on the choice of the consumer in case of failure occurs in the product at least THREE (3) times within the warranty period.
- 5) Free repair and product exchange obligations will be annulled under the following conditions:
 - a) If the product becomes faulty due to use contrary to the terms or conditions stated in the user guide.
 - b) If the product has been opened, used, or previously repaired by unauthorized persons.
 - c) Use of the product by plugging into inappropriate or unstable or unsafe power supplies.
 - f) A break or scratch to the product's exterior while in the customer's possession
 - g) When our product is damaged due to use with accessories purchased from other firms or unauthorized services.
 - h) Those damages caused by natural disasters such as fire, lightning, flood, earthquake, etc.
- 6) For the given services supplied by service stations compulsorily within the warranty period in the periodical maintenance stipulated by the manufacturer or importer, any charge like workmanship will not be demanded from the customer.
- 7) The warranty certificate should be kept throughout the warranty period.

The warranty starts from December 1st,2016.

Please cut along the dotted line (receipt in the envelope to send back to the above address).

Flexwarm Warranty Card

FCC statement

This device complies with Part 15 of the FCC Rules.

Operation is subject to the following two conditions:

- (1) This device may not cause harmful interference, and
- (2) this device must accept any interference received, including interference that may cause undesired operation.

Caution: Changes or modifications not expressly approved by the party responsible for compliance could void the user's authority to operate the equipment.

Guangdong Flexwarm Advanced Materials & Technology Co.,Ltd

Zi Ni Tang, No.7 Xi An Road, Panyu District, Guangzhou, Guangdong, China

+86 020 34833982

Thank you for supporting us at Indiegogo.

App Control

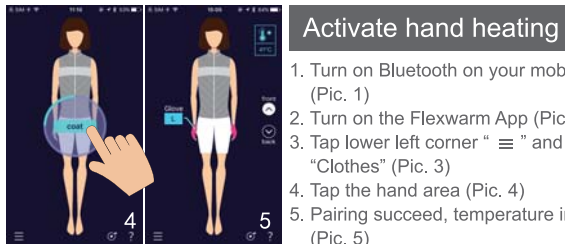
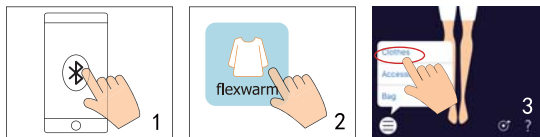

1. Turn on Bluetooth on your mobile device (Pic. 1)
2. Turn on the Flexwarm App (Pic. 2)
3. Tap lower left corner "≡" and choose "Clothes" (Pic. 3)
4. Tap "☺" to switch between back control and front control (Pic. 6)
5. Tap the back area (Pic. 7)
6. Pairing succeeds, temperature indicated. (Pic. 8)

P5

Adjusting the temperature

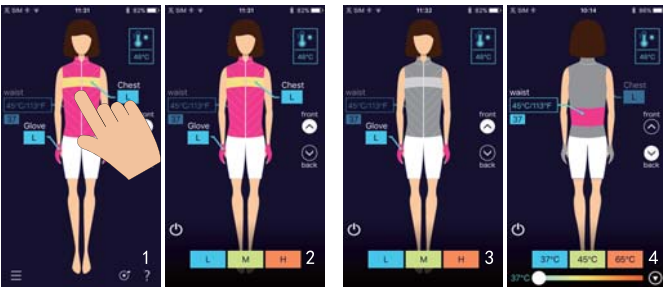

- Step 1: Tap on chest area on the app.
(you can also tap on areas such as hands or back)
- Step 2: You will see 3 hot keys: L for low temperature (37°C/98.6°F), M for medium temperature (45°C/113°F) and H for high temperature. (65°C/149°F)
- You can slide the slider to adjust the temperature from 37°C/98.6°F to 65°C/149°F by degree.

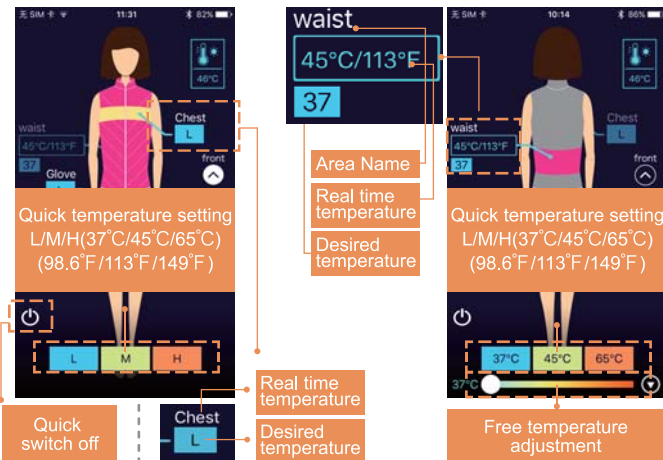

P6

How to switch off

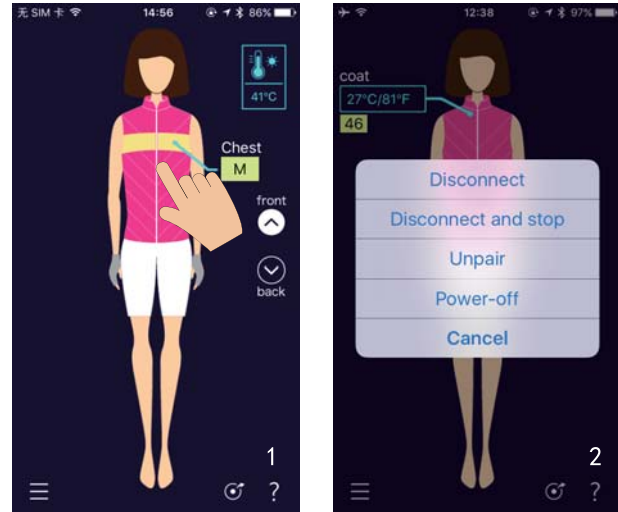

1. Press and hold the heating area. (Pic. 1)
2. And choose the following option. (Pic. 2)
 - (1) "Disconnect" - disconnect the app from the jacket.
 - (2) "Disconnect and Stop Heating" - disconnect the app from the jacket and turn off the heating.
 - (3) "Unpair" - Disconnect the app from the jacket and unpair current device. (Heating will not be turned off but you need to pair your mobile terminal with the jacket again next time when you use the product)
 - (4) "Power off" - disconnect the product from the App and power off the product.
 - (5) "Cancel" - Return to main interface.

P7

Warning

1. Do not use high temperature setting to avoid getting burned.
2. Please make sure the powerbank is taken out BEFORE washing and connect the product to the powerbank only after the product is fully dried.

This product is not suitable to:

1. Patients with moderate and severe cardiovascular disease, or are currently with pacemaker.
2. Diabetes, hyperthyroidism patients.
3. Those who are bleeding or bleeding tendencies were banned.
4. Patients who are suffering from severe anemia and/or hypertension (systolic blood pressure greater than 180mmHg, diastolic blood pressure greater than 110mmHg) or low blood sugar syndrome.
5. People who have the wound are prohibited to use.
6. Those who are suffering from malignant tumors.
7. Those who are suffering from all kinds of medical emergencies, serious illness (life-threatening disease) and/or infectious diseases.
8. Pregnant women, infants and young children and those who are with mental retardates.
9. Those who are with skin sensory disturbances or skin abnormalities.

P8

How to download the App

Scan the QR code and download the App from App Store or Google Play Store.

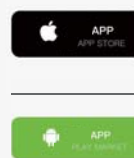

iOS:

Search with keyword "Flexwarm" in App store for download & installation.

Android:

Search with keyword "Flexwarm" at Google Play Store
(<http://play.google.com/store>) for download & installation.