

Model: N1

somnoval
User Manuel

Please read this manual carefully before using the product.
And please keep this manual in a safe place for future reference.



Welcome to use SOMNOVA. N1 is a smart device for snorer, which helps user to adjust his or her sleeping positions. When the control case detects snoring, one of the two airbags in the mat will be inflated and bulge slowly, gently shifting the user' s body to its side. In this position, air passes the the airway in the throat more gently and the sound of snore will be reduced.

Caution: The user is cautioned that changes or modifications not expressly approved by the party responsible for compliance could void the user's authority to operate the equipment.

This device complies with Part 15 of the FCC Rules. Operation is subject to the following two conditions: (1) this device may not cause harmful interference, and (2) this device must accept any interference received, including interference that may cause undesired operation.

NOTE: This equipment has been tested and found to comply with the limits for a Class B digital device, pursuant to Part 15 of the FCC Rules. These limits are designed to provide reasonable protection against harmful interference in a residential installation. This equipment generates, uses and can radiate radio frequency energy and, if not installed and used in accordance with the instructions, may cause harmful interference to radio communications. However, there is no guarantee that interference will not occur in a particular installation.

If this equipment does cause harmful interference to radio or television reception, which can be determined by turning the equipment off and on, the user is encouraged to try to correct the interference by one or more of the following measures:

- Reorient or relocate the receiving antenna.
- Increase the separation between the equipment and receiver.
- Connect the equipment into an outlet on a circuit different from that to which the receiver is connected.
- Consult the dealer or an experienced radio/TV technician for help.

FCC Radiation Exposure Statement:

This equipment complies with FCC radiation exposure limits set forth for an uncontrolled environment. This transmitter must not be co-located or operating in conjunction with any other antenna or transmitter.

Main Accessories and Tools:

- Control Case x1
- Power Adapter x1
- Inflatable Mat x1
- Cloth Cover x1
- Air Tube x1
- User Manuel x1

Optional Accessories:

- Handbag
- Denoising Pad

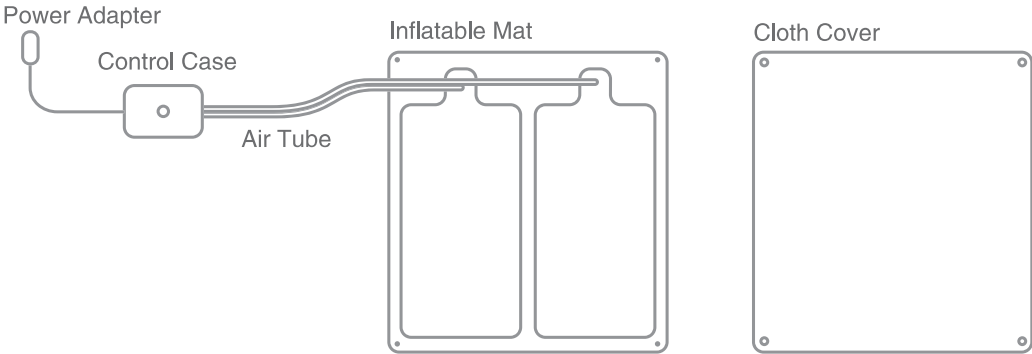

Step 1. Set the Inflatable Mat

The inflatable mat has two installation methods, you can choose according to your needs.

Method 1. Use the Inflatable Mat Only

Put the inflatable mat under the bedsheet. If your sleeping position is consistent, in this method, the mat blends seamlessly with your bed and you won't perceive its presence.

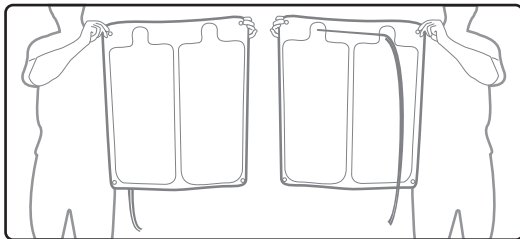

1. The inflatable mat is not divided into front and back sides, so both sides can be used.

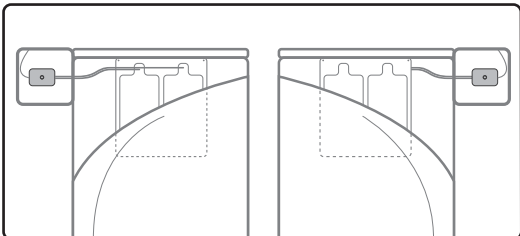

2. You can put the control case in the right side or left side as the picture did.

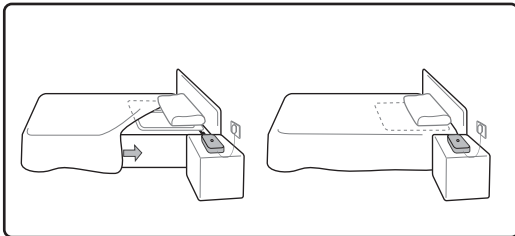

3. As shown in the picture, put the inflatable mat under the pillow and the bedsheet.

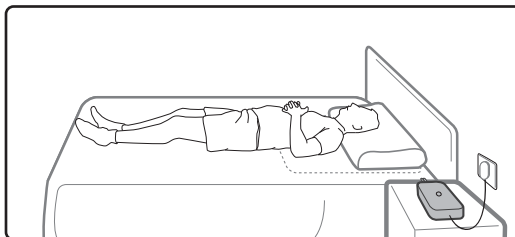

4. Place the pillow on the area of inflatable mat as the picture did.

Method 2. Use the Inflatable Mat with Cloth Cover

Wear the cloth cover and place the mat on the top of your bedsheet. If you have multiple sleeping positions, this method allows more freedom and convenience for you to change the position of the mat at any time.

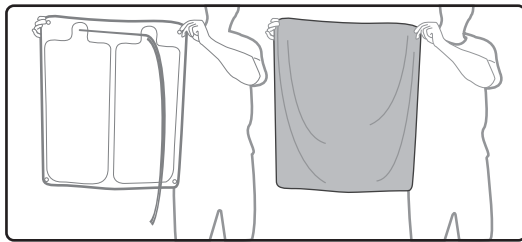

1. Both sides (front or back) can be used.

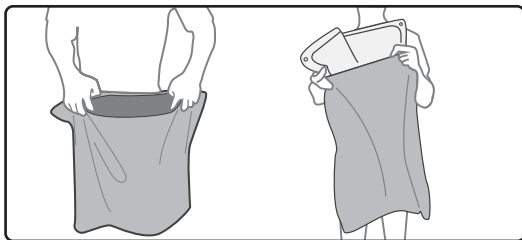

2. Take on the cloth cover for the inflatable mat.

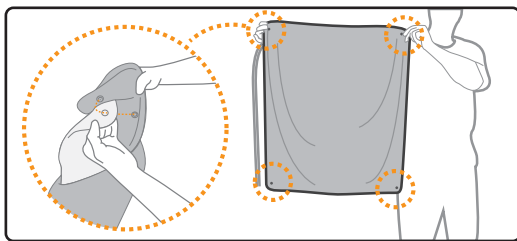

3. Connect the bottoms at four corners.

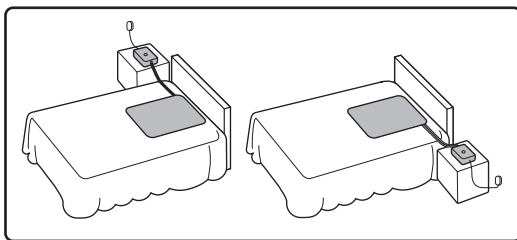

4. Both side can be use.

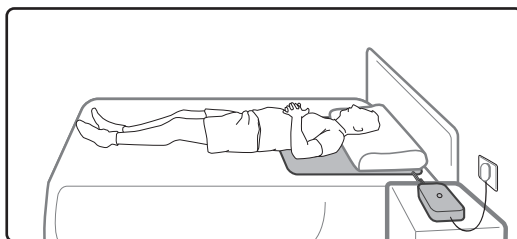

5. When the mat wears the cloth cover, it can be put on top of the bedsheet. No need to place it under the sheet.

Step 2. Set the Control Case

1. insert the silica gel tube into the air mouth of the control case.

2. Connect the power adapter.

3. When turning on (hold the bottom for 2s), the case will “beep” twice. When shutting down, the case will “beep” once.

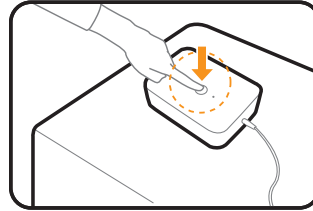
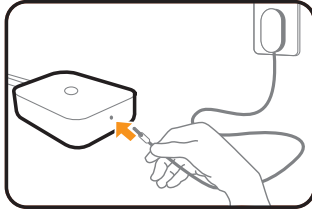
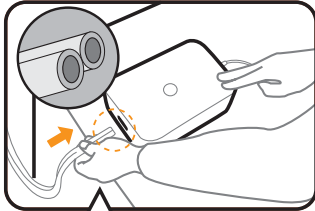

Recording Mic Air Mouths

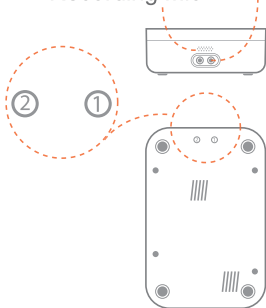

Individualization Setting

Note: Number 1 and 2 at the bottom of the control case match the air mouths above respectively. The mat consists of two independent airbags. If you want to give the priority of inflation to one airbag, you can connect the corresponding air tube of this airbag to the corresponding air tube of this air mouth of number 1. Then this airbag will be inflated first.

For example: Mr. A is more accustomed to sleep on the right side, so he just needs to connect corresponding air tube of the left airbag under his back to the corresponding air mouth of number 1. Then when using the product, the left independent air bag will be inflated with priority, Mr. A's body will then turn to the right side.

Note: The indicator light is in a breathing status during normal use, with alternating change from light to dark.

Notifications

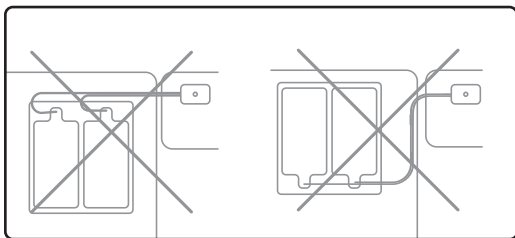

1. Do not set up as the left picture did.

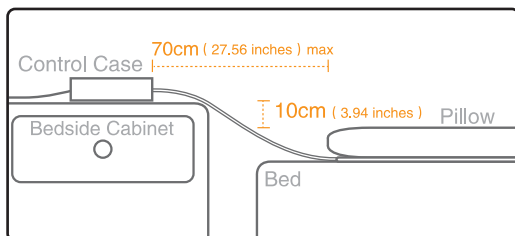

2. Turn the recording mic toward your pillow to ensure its normal operation. The control case should be placed about 10cm higher than the pillow.

How to Make a Test

The product is preset the factory default configuration and there will be a short quiescence time for the recording mic after you turn on the control case. This means the machine will not detect snoring and inflate the mat at once after you turn it on. But you can use the Test Mode of SOMNOVA app to check if the machine can work normally.

App for IOS & Android

Free download “SOMNOVA” app in [Google play](#) or [App Store](#).

Available for devices with IOS 8.0+ or Android 4.4+ , which also support Bluetooth 4.0

Bind the SOMNOVA Device in App

When using App for the first time, please turn on the Bluetooth, search and connect to SOMNOVA device starting with a name of “SN” .

The machine is prest factory default configuration. In order to achieve the best experience, you can adjust the corresbonding paraments by app according to personal prederence.

Product Parameters
SOMIOTECH

Model	N1
Size	Control case: 200*145*59mm (7.87*5.71*2.33 inches) Inflatable Mat: 719mm*618mm (28.31*24.33 inches) Air Tube: 1000mm (39.37 inches)
Weight	Control case: 530g (18.7oz) Air Tube: 90g (3.2oz) Inflatable Mat: 580g (19.7oz) Cloth Cover: 195g (6.9oz) Power Adapter: 150g (5.3oz) Whole Set: 1525g (53.8oz)
Materials	Control case (case): ABS Power Adapter (case): ABS Inflatable Mat: PVC Air Tube: Silica Gel Cloth Cover: 50% Cotton, 50% Polyester Fibre Denoising Pad: Polyurethane Handbag: Polyester Fiber
Power Adapter Input	AC100–240V~50/60Hz 0.6A
Power Adapter Output	12V=2A
Power Adapter Standards	UL, FCC
Working Voltage	12V
Standby Power	0.2W
Operating Power	6.5W
Working sound	35dB (Measurement Distance 30cm (1ft.))
Communication Mode	4.0 Low Power Bluetooth 4.0
Communication distance	Indoor 6m (19.7ft. reach indoors)
App Application System	IOS 8.0+, Android 4.4+
Product Standard	Part 15 of the FCC Rules

All standard data is based on actual product specification. If there is any change, no further notice will be informed. Our company reserves the right of final explanation within the legal scope.

Trouble Elimination

SOMNOVA

Problems	Reasons	Solutions
Cannot turn on	No plugged in	Make sure the connection works and have electricity
	Too short pressing	Make sure press the button for 2 seconds
Air stuck in the airbag	Outlet of the airbag is blocked	Pull out the tube to manually deflate the airbag or use the Test Mode in app
	Machine is still on working	Wait until it stops working
No inflation	Airbag inlet is blocked or tube connection is not correct	Make sure set up and connect according to the manual; Make sure no hard or heavy object press or block the tube to stop its inflation or deflation.
	No detection of snoring	Make sure the set up is correct or adjust detection sensitivity by app
	Not yet sleeping time	Adjust the length of sleep by app
Inflation before falling asleep	App version is too old	Download the latest app version
	Too short sleeping time	Adjust the time of falling asleep by app
	Erroneous detection	Adjust detection sensitivity by app
Wake up by the full mat	Not adaptable to over-inflated mat	Adjust improvement intensity by app
Too noisy	The head is too close to the machine	Make sure the set up is correct
Can not register	No internet connection	Make sure the internet works
No product found when the app is searching	The product is off	Make sure turn on the product
	The product is too far from cellphone	Make sure the distance between cellphone and mat is within 6m.
	Operating system is not compatible	Make sure the cellphone system is IOS 8.0+ , android 4.4+
	Cellphone Bluetooth is not compatible	Make sure cellphone supports BLE 4.0
	Product has connected to other app	Connect again after restarting
App notices that "No device found around"	The product is off	Make sure turn on the product
	Software or firmware version is too old	Download the latest app version and upgrade the firmware
	Bind with another anti-snoring mat before	Unbind and use after rebinding
Firmware update failure	App version is too old	Download the latest app version and upgrade the firmware
	Connection is instable during upgrading	Make sure that app is working and close to the mat while upgrading

12 If the above methods can not solve problems, please contact the SOMNOVA after-sale service center.

Product Features Notices

- Please keep in mind that this product is not a medical device. SOMNOVA mainly aims at non-pathological snorers. If you are a pathological patient with severe snoring, please take medical treatments.
- It needs several days to adapt to SOMNOVA. Please do not give up using easily. Obvious effect can only be seen after long time using.
- There is some difference between simulated snoring and true snoring. Sometimes, your simulated snoring cannot be detected as true snoring to start up inflation of the mat.
- During the summer, it is not recommended to cover the product with the summer sleeping mat. Over weighted cover will affect the product's performance.
- Do not use hard pillow, which may press or block the tube.
- Please try to avoid a noisy surrounding. Using this product under complex conditions with noise may result in an erroneous detection.
- Product under high or low air pressure may not work properly. Please try to avoid it.
- Please use this product indoor.
- This product uses 12V safe voltage. Meanwhile the inflatable mat has no electricity supply, please feel assured to use it.

Warnings

To prevent the occurrence of dangerous situations and to ensure your safety and prolong the life of equipment, please read following safety information carefully before installing and cleaning the product.

- Do not place an exposed flame source on this product, such as a lighted candle.
- This product shall not be exposed to water droplets, water splashing, and flooding. Items with full liquid, such as vases, should not be placed on the product.
- AC power plug should be fully inserted into the AC outlet, while the other end of the power line should be fully inserted into the control case. If loose, it may cause a spark and even a fire.
- Power disconnection devices such as power grid, power supply plug, and appliance couplers and so on should not be stacked around the debris etc., in order to keep the plug operating easily.
- Do not over pinch, bend or reverse the AC power cord, otherwise the cord may be exposed to the outside or broken.
- Please stop using and contact the after-sale service center when the inflated mat is in an unusual shape or expands anomaly.
- Do not use with electric heating blankets and other similar equipments.
- Do not block cooling holes to ensure product ventilation.
- To ensure that the inflatable mat intake is not blocked by any heavy objects, otherwise it cannot be inflated.
- Please remove any sharp objects around the inflatable mat. Avoid piercing by sharp objects when inflated, which may lead to failure of inflation or rupture.
- Do not wash the inflatable mat, but wipe with cloth; do not pull or pinch inflatable mat.
- Ensure the direction of inflatable mat before using, and empty the air inside the inflatable mat.
- If not use for a long time, please turn it off; disconnect the power adapter, put it into the box, and keep it at room temperature.
- In order to ensure safety, children should be guided by their parents when they intend to connect the plugs.

Incorrect use may cause electric shock or fire accidents.

Environmental Notices

Name and content of toxic substances or elements

Components	Toxic Substances or Elements					
	Pb	Hg	Cd	Cr(VI))	PBB	PBDE
Control Case	○	○	○	○	○	○
Power Adapter	○	○	○	○	○	○
Inflatable Mat	○	○	○	○	○	○
Air Tube	○	○	○	○	○	○
Cloth Cover	○	○	○	○	○	○

○ It indicates that the content of the toxic and hazardous substances in **all** homogeneous materials of this part is below the limit set by RoHS Directive RoHS (2011/65/EU).

× It is shown that the content of the toxic and hazardous substances at **least** in a homogeneous material of this part is above the limit set by RoHS Directive RoHS (2011/65/EU).

In order to better protect and care for the earth, when users no longer need this product or product life terminates, please comply with related laws and regulations about wasted electrical and electronic products recycling, and hand it over to the authorized manufacturers for recycling.

Warranty

Dear Customers,

Thank you for choosing SOMNOVA. In order to provide you a better service, please read the following terms carefully:

1. After-Sales Service

- SOMNOVA after-sale team is responsible for product after-sale service work.
- Please keep the warranty certificate and the purchase invoice, which will be your warranty proof.
- Product warranty period is according to the consumer purchase invoice or receipt on the actual date, whichever is the earliest start date.

2. Service in Warranty Period

- Product warranty period is 12 months. If any performance failure without human damage appears, after the service center determines and confirms, you can choose a free repair service.
- When the product displays performance failure, please contact and report to customer service. After customer service verifies the failure, you can send back the product to us.
- Our commitment to free repair only contains hour charge, not including the material costs and transportation costs. And we do not provide door-to-door service.

3. Performance Failure Table

Components	Performance Failure
Control Case	Cannot turn on
	Cannot be found by app
	Outermost shell damage caused by structure or material
Power Adapter	Unable to connect to power or work improperly

Note: App related issues do not belong to the performance failure

The following circumstances (but not limited to the following), are not within the scope of the warranty service. SOMNOVA after-sale service center will charge reasonable maintenance fees:

- No warranty certificate or not within the product warranty period.
- Damage or functional abnormality caused by failure to use, upgrade, and maintenance without disobeying rules in Manuel.
- Damage caused by such force majeure as fire, flood, lightning, etc.
- Product model or code on the warranty certificate does not match physical commodity.
- Repair damage caused by non SOMNOVA designated after sale service centre.
- Decolor, abrase and consume during the normal use of the product.
- Damage caused by use of non-original components.

Contact Us

E-mail: service@somnova.com

Website: www.somnova.com

If you have any questions or suggestions, please feel free to contact us.

