

USER MANUAL



True Wireless Earbuds

Packing List:

1. Bluetooth Earbuds	x2PCS
2. Charging Case	x1PC
3. Micro USB Cable	x1PC
4. Original Ear Caps(M)	x1Pair
5. Extra Ear Caps(S/L)	x2Pairs
6. User Manual	x1PC

Functional Diagram:

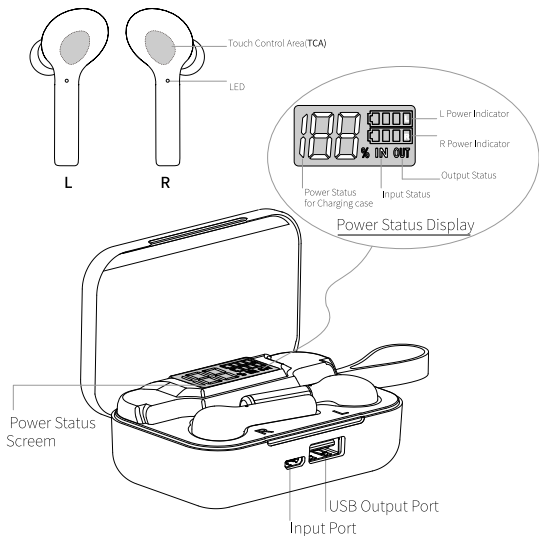

How to Pair Twins Earbuds with your phone?

Note to first use:Please fully charge the earbuds and charging case with the supplied usb cable.

1. Open the lid of the charging box and take out the twins earbuds, they will be connected with each other automatically.
2. Open the bluetooth of your device, search and click the model "K18", the twins earbuds will connect with your device successfully.

How to Switch On/Off the Earbuds?

Turn on: Open the lid of the charging case, take out the twins earbuds from the charging case, the twins earbuds will turn on and connect with each other automatically(The First way).

Or when the twins earbuds are being turn off status, touch and hold down the twins earbuds TCA for 3 seconds(The Second way).

Turn off: Put the earbud back the charging case , it will be shutdown and charging(The First way).

Or when the earbuds are being stand-by status(Be non-play state and non-call mode), touch and hold down the earbud TCA for 15 seconds to shutdown(The Second way).

Other Functions

For music:

1. Play or Pause a song: Tap once of any earbud TCA .

2. Adjust the volume:

Volume Up: Hold down the TCA of Right Earbud

Volume Down : Hold down the TCA of Left Earbud

3. Play the previous song & play the next song :

To Play the next song: Quickly Tap the Right Earbud TCA twice

To Play the previous song: Quickly Tap the Left Earbud TCA twice



Tap the TCA

Note: If you just use left earbud only, you can use left earbud to volume down and play the previous song, you need turn up the volume and play the next song by your phone;

If you just use the right earbud individual, you can turn volume up and play the next song by right earbud, you need to turn volume down and play the previous song by your phone.

For calling:

1. Answer or End a call: Touch the TCA once of any earbud .
2. Reject incoming call: Hold down the TCA of any earbud for 2 sec.

Activate Siri/Voice Assistant:

Quickly Tap the Left Earbud TCA thrice of any earbud.

How to Charge?

• Charging the Charging Case and Earbuds

1. Make sure the Earbuds are in the correct slots in the Charging Case.
2. Use the USB-Micro Cable to connect the Charging Case Input port and the charger or your PC.
3. From the Power Status Screen, you will see the block of the Bar L & R flashing blue, the Panel %, **IN&OUT** all be lit that means the earbuds and case are being charging. (Check Photo 1)

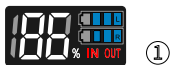

4. When you see all the blocks of bar L&R are Blue, it shows the twins earbuds are fully charged(Check Photo 2), when Panel **100%** and **IN** lit means the Case be charging finished (Check photo 3).

Please disconnect the charger in time after the charging box is fully charged.

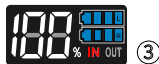
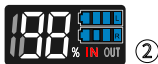

- **Use the Charging Case to Charge the Earbuds:**

Charging Case can charge the Earbuds without the cable.

1. Make sure the Earbuds are in the correct slots inside the Case.
2. The block of the Bar L & R flashing blue one by one, the Panel %, OUT all be lit that means the earbuds being charging(Check photo A).

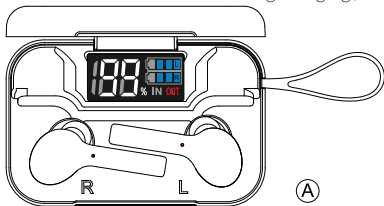

3. When you see the bar L&R full filled with Blue blocks, it shows the earbuds are charged well by the charging case(Check photo B), the screen goes off automatically later.



■Note: If you do not use the headset for a long time, please charge the twins earbuds and the charging box at least once every 3 months.

To Charge your Phone

The Charging case supports to charging your phone as soon as it out of batteries, connect the case to your phone with its' original cable.

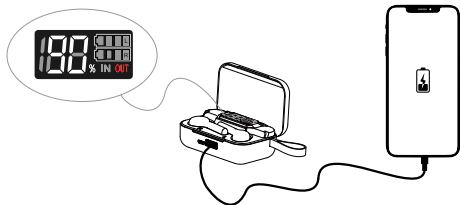

Specification:

1. Bluetooth Version: BT5.0+EDR
2. Support: HSP/HFP/A2DP/AVRCP
3. Transmission Range: 10m/33 feet (If there are no obstructions the range could be as far as 33 feet)
4. Earbuds Working Time: About 4.5 hours
(High quality music and volume will accelerate battery consumption);
5. Input/Output Port: Micro/USB
6. Charging Time: 1-1.5 hours to charge Earbuds; 2 hours to charge the Charging Case
7. Earbud Size:42*18*26mm; Charging Case Size: 81*52*30mm
8. Earbud Weight: 4.5g/PC
9. Battery Capacity: (Li-Poly battery inside) Earbuds: 3.7V/50mAh; Charging Case: 3.7V/2600mAh
10. Charging Case Input/Output Specifications: 5V/1A(TYP)

FAQ

Q: Why is there only one earbud with sound after connecting, or my earbuds can't be turned on ?

A: Before using, please make sure the Earbuds are fully charged. Then forget all bluetooth devices from your phone. Take out the earbuds, then open the bluetooth of your phone to connect.

Q: Why is Bluetooth Earbuds signal direct distance better than the curve ?

A: Because this is a kind of radio wave, it has low transmission power. However, if there is an obstruction, the signal is not good.

Q: When calling, why is my phone volume and sound clarity different from my friends phone ?

A: This just depends on each person's individual phone, we have done our best to ensure the sound clarity and volume on many different phones.

Q: What if my Bluetooth earbuds doesn't work in twins mode?

A: Please restart the twins earbuds firstly, if still not make it. Then please try to restore headset factory settings, the steps follow:

When the twins earbuds are being charging. Hold down the twins earbuds TCA for 3 seconds until you see the twins earbuds led light flashing a hasty red&blue light.

Take out and boot on the both earbuds, and **QUICK double-tap the TCA of Left & Right earbud simultaneously**, after 3-5 seconds there is only one Earbud flashes red and blue light nonstop.

Then open the bluetooth of your device, search and click the model "K18" to pair with your phone.

Safety Precautions:

The Earbuds are excellent quality, in order to increase service life, please make sure of the following instructions :

1. Please keep the device away from extreme heat, humidity, or corrosive environments.
2. Please prevent the device from being struck or dropping, warping, soaking, etc.
3. Please don't dismantle the Earbuds or Charging Case.
4. Please don't overcharge the device for a long time, as that will decrease the battery service life.
5. Please stop using the device immediately if it causes discomfort or pain.
6. Use DC-5V 1A chargers/adapters certified by a regulated manufacturer. Recharging and discharging the headphones repeatedly will lead to decrease in battery performance over time, which is normal for all rechargeable batteries. (Don't press the elastic pin contact point, so as not to cause them to be used properly.)

FCC Warning Statement

Changes or modifications not expressly approved by the party responsible for compliance could void the user's authority to operate the equipment. This equipment has been tested and found to comply with the limits for a Class B digital device, pursuant to Part 15 of the FCC Rules. These limits are designed to provide reasonable protection against harmful interference in a residential installation. This equipment generates uses and can radiate radio frequency energy and, if not installed and used in accordance with the instructions, may cause harmful interference to radio communications. However, there is no guarantee that interference will not occur in a particular installation. If this equipment does cause harmful interference to radio or television reception, which can be determined by turning the equipment off and on, the user is encouraged to try to correct the interference by one or more of the following measures:

- - Reorient or relocate the receiving antenna.
- - Increase the separation between the equipment and receiver.
- - Connect the equipment into an outlet on a circuit different from that to which the receiver is connected.
- - Consult the dealer or an experienced radio/TV technician for help.

This device complies with part 15 of the FCC Rules. Operation is subject to the following two conditions: (1) This device may not cause harmful interference, and (2) this device must accept any interference received, including interference that may cause undesired operation.