

Technical Specs

Items	Specification
Operating System	Android 11.0 go
CPU	Quad-core@1.5Ghz
Memory	2GB RAM + 16GB ROM (LPDDR3)
Display	4.0" IPS, 480*480
Camera	2M front camera
Scanner	N/A
Cellular Network	Support 2g/3g/4g
WIFI	IEEE 802.11 a/b/g/n (2.4G&5G)
Bluetooth	Version 4.2, support BLE
Payment	Support IC/NFC Card
Interface	Connector 20PIN
Audio	Buzzer
Battery	220mAh/3.8V (Rated capacity)

The product is suitable for indoor, outdoor and unattended scenarios, such as restaurants, supermarkets, tourist attractions, vending machines, coffee machine, parking, laundry, EV charges, car wash, vacuum cleaner, chair massage, gaming, unattended toilet booth, unattended lockers, kiddie ride, etc.

VPOSMS is installed in the machines, such as vending machines, coffee machine, etc.

ATTENTION

Warning

- Read all instructions and safety information before use to avoid injury.
- The limit operating ambient temperature of the device declared by the manufacturer is -10~55°C.

Battery safety

- Dispose of used batteries according to manufacturer's instructions.
- Danger of explosion if battery is incorrectly replaced. Replace only with the same or equivalent type of battery recommended by the manufacturer.

Statement

- The equipment damage caused by natural disasters, falling, self disassembly and non-compliance with the operation specifications is not covered by the free warranty.
- Some details of this document may be inconsistent with the real object due to the update iteration of the product. Please take the real object as the standard, and our company reserves the right to interpret this document.

VPOSMS

Quick Guide

Product Diagram

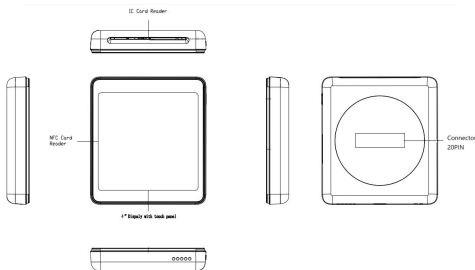

NFC Card Reader

NFC antenna locates at the bottom of the screen. It's used to sense chip and acquire data through contactless way.

IC Card Reader

Used for inserting the bank chip card and getting information securely.

Display

Set for merchants to complete business settlement and for customers to input the password to finish the payment .

Connector 20PIN

Used for device charging and plugging in peripheral device which supports OTG.

FCC Regulations:

This device complies with part 15 of the FCC Rules. Operation is subject to the following two conditions: (1) This device may not cause harmful interference, and (2) this device must accept any interference received, including interference that may cause undesired operation.

This equipment has been tested and found to comply with the limits for a Class B digital device, pursuant to part 15 of the FCC Rules. These limits are designed to provide reasonable protection against harmful interference in a residential installation. This equipment generates, uses and can radiate radio frequency energy and, if not installed and used in accordance with the instructions, may cause harmful interference to radio communications. However, there is no guarantee that interference will not occur in a particular installation. If this equipment does cause harmful interference to radio or television reception, which can be determined by turning the equipment off and on, the user is encouraged to try to correct the interference by one or more of the following measures:

- Reorient or relocate the receiving antenna.
- Increase the separation between the equipment and receiver.
- Connect the equipment into an outlet on a circuit different from that to which the receiver is connected.
- Consult the dealer or an experienced radio/ TV technician for help.

Changes or modifications not expressly approved by the manufacturer could void the user's authority to operate the equipment.

FCC RF Radiation Exposure Statement

This equipment complies with FCC radiation exposure limits set forth for an uncontrolled environment. To comply with FCC RF Exposure compliance requirements, this grant is applicable to only Mobile Configurations. The antennas used for the transmitter must be installed to provide a separation distance of at least 20cm from all persons and must not be co - located or operating in conjunction with any other antenna or transmitter.

RF exposure statement

RF exposure information: The Maximum Permissible Exposure (MPE) level has been calculated based on a distance of d=20 cm between the device and the human body. To maintain compliance with RF exposure requirement, use product that maintain a 20cm distance between the device and human body.

Declaration of Conformity

Hereby, [NAYAX Ltd.] declares that the radio equipment type [POSPaymentDevice,VPOSMS] is in compliance with Directive 2014/53/EU.

The full text of the EU declaration of conformity is available at the following internet
Address: www.nayax.com

CAUTION RISK OF EXPLOSION IF BATTERY IS REPLACED BY AN
INCORRECT TYPE.
DISPOSE OF USED BATTERIES ACCORDING TO THE
INSTRUCTIONS

GSM900	33.06 dBm
GSM1800	31.93 dBm
FDD I	24.27 dBm
FDD VIII	23.76 dBm
Band 1	24.19 dBm
Band 3	24.16 dBm
Band 8	22.28 dBm
Band 20	21.9 dBm
Band 38	23.59 dBm
Band 40	21.99 dBm

Package List

NO.	Items list	Description
1	Device	POS Payment Device