

LATCH

Leak Lasso

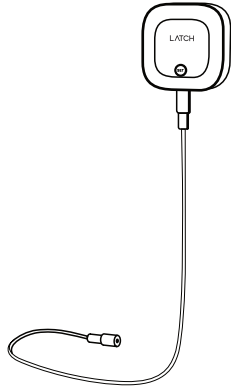

Quick Start Guide
January 16, 2024

A Welcome!

To install and configure devices **download:**

LATCH Manager



Please note: this Quick Start Guide is intended to get you started on the installation of your LATCH product.

For additional support & help articles follow the QR code below.



B Before You Begin

Please note the following user guide icons:

- Very important information, please read carefully
- Good to know, helpful tips for installation



This device connects to the internet via a **LATCH Field Station** hub, and it does not connect directly to your WiFi or local network. In order for remote access to the device from the app, and for full functionality, a hub is required.

This guide assumes the **LATCH Manager** app has been installed on your smartphone, and a **LATCH Field Station** hub is installed and online.

Please confirm the status of your LATCH Field Station hub and LATCH Manager app before proceeding.

C In the Kit

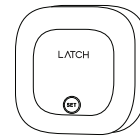

LATCH Leak Lasso

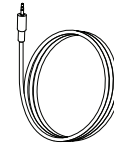

Sensor Cable

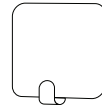

Mounting Hook

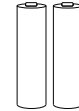

2 x AAA Batteries
(Installed)

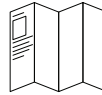

Quick Start Guide

D Required Items

The following items may be required:



Double-Sided
Mounting Tape



Rubbing
Alcohol Pads

E Get to Know Your Device

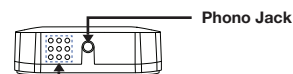
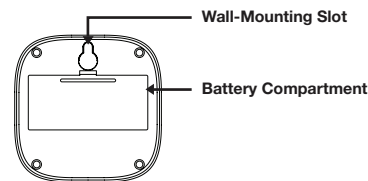

Alarm Tones

- One Beep**
Device power-up/button pressed
- Two Beeps**
Water Alert
(Two beeps every 2 seconds for the first minute. Two beeps every 5 seconds for the next 12 hours. Sustaining two beeps once a minute after 12 hours)

E Get to Know Your Device

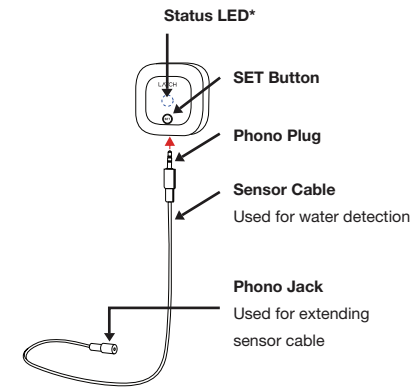

***Note:** LED light not visible while there is no operation with the SET button or while device is in normal monitoring status.

LED Behaviors

- Blinking Red Once**
Water Alert
Water Detected or Water Not Detected (Depending on Mode)
- Blinking Green**
Connecting to Cloud
- Fast Blinking Green**
Control-D2D Pairing in Progress
- Slow Blinking Green**
Updating
- Fast Blinking Green**
Control-D2D Unpairing in Progress
- Blinking Red And Green Alternately**
Restoring to Factory Defaults

F Add Device To LATCH

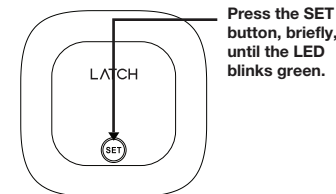

G Add Device To LATCH

If you are new to LATCH, **please install the LATCH Manager app on your phone**, if you have not already. Otherwise, please proceed to the next section.

LATCH Manager



Open the app and tap **Sign up** for an account. You will be required to provide a username and a password. Follow the instructions to set up a new account. Allow notifications, when prompted. Log in to the app using your new username and password.

1. Tap **Add Device** (if shown) or tap the scanner icon:

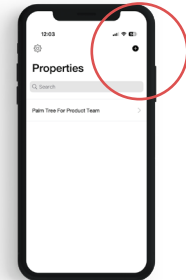

2. Approve access to your phone's camera, if requested. A viewfinder will be shown on the app.

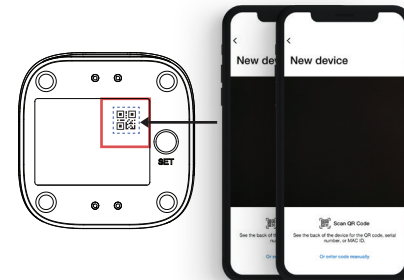

3. Hold the phone over the QR code so that the code appears in the viewfinder. If successful, the **next steps** will be displayed.

4. Follow the instructions to add your device to LATCH.

Sensor location considerations:

Before placing and setting up your LATCH Leak Detector, consider the following important factors:

1. The LATCH Leak Lasso is intended for indoor use, only. The sensor body should not be installed where it will normally get wet or be submerged.
2. Additional cables can be added to extend the length of the water detection cable and/or to expand the detection region (to cover a larger area). The total length of the final arrangement of cables must not exceed 30 feet or 9 meters.
3. The LATCH Leak Lasso has an integral sounder alarm. Its use is optional, as it can be enabled or disabled, in the app settings.
4. The LATCH Leak Lasso is typically mounted on the wall or on a stable vertical surface, near the floor.
5. While the sensing cable(s) can be placed in a confined space, such as behind a refrigerator, the sensor should be placed in an accessible location (for example, to allow for easy battery replacement later).

Determine the sensor location and approximate cable placement:

1. Connect the cable to the sensor, by plugging the male end of the cable into the sensor. If you are using additional cables, connect them at this time.

5. Applications for the LATCH Leak Lasso are many, and they can not be covered in detail in this quick start guide. If you are unsure where to place your LATCH Leak Lasso, please contact us. But the sensing cable(s) will typically be placed so that they encircle the region where a water leak may occur. Some common examples are placing the cable around the base of a toilet, or around the inside perimeter of a bathroom vanity with sink, around a laundry washing machine or water heater. In addition to placing the cable to surround an area, snaking the cable back and forth across a region may provide better coverage, resulting in a faster response time.

6. If you still are unsure how to place the cable, or whether or not you need additional cables, you can test the location by simulating a water leak. For example, pour a small amount of water on the area where you expect a water leak may occur. Observe how the water pools or expands over the area. Consider the slope of the floor, which may be prominent in basement or mechanical spaces that have a floor drain (generally, all points on the floor will slope down to the drain). Try to place the cable so that it is in the path of pooling or moving water.

7. Lay the cable on the floor, as required for your application, temporarily, at this time, so that you can determine the appropriate location for the sensor.

Install the mounting hook:

1. After the location and placement of the cable(s) has been determined, define the location of the sensor. The mounting hook should be installed at this location. (If you intend to mount the LATCH Leak Lasso using another method, such as double-sided mounting tape or Velco, do so at this time, per the manufacturer's instructions.)

2. Clean the surface where the mounting hook will be placed, using rubbing alcohol (recommended) or a degreaser that does not leave a residue on the surface. In order for the pre-installed mounting tape to adhere to the surface, the surface must be clean, dry and free of dirt, oils, grease, or other cleaning agent residue.

3. Remove the plastic backing from the mounting tape on the mounting hook.

4. With the hook facing up, as shown, press it firmly against the mounting surface and maintain pressure for at least 5 seconds.

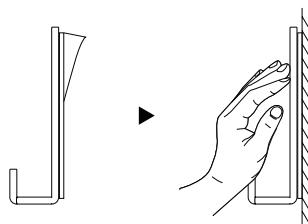

Install and test the LATCH Leak Lasso:

1. Hang the sensor on the mounting hook, using the slot on the back of the sensor. Ensure it is secure, by gently tugging on it.
2. It is important that you test each sensor, to ensure it will work properly when needed! Please note, before testing, if the sensing cable is emersed in water, it can take an extended period to dry. You can perform a "functional test" of the LATCH Leak Lasso by pouring water in the detection area, but we are aware of the extended drying time. One testing method is to use a paper towel or cloth that is slightly damp with water. Place this gently on the sensing cable, allowing it several seconds to respond. The sounder should activate and the LED should flash red.

3. Unplug the sensing cable and allow it time to dry, or actively dry it with a heat source like a hairdryer. Reinsert the cable until it no longer causes a leak alert response.

Refer to the full Installation & User Guide, to complete the installation and set-up of your device.

I

FCC Statement

This device complies with part 15 of the FCC Rules. Operation is subject to the following two conditions: (1) This device may not cause harmful interference, and (2) this device must accept any interference received, including interference that may cause undesired operation. Any Changes or modifications not expressly approved by the party responsible for compliance could void the user's authority to operate the equipment.

Note: This equipment has been tested and found to comply with the limits for a Class B digital device, pursuant to part 15 of the FCC Rules. These limits are designed to provide reasonable protection against harmful interference in a residential installation. This equipment generates uses and can radiate radio frequency energy and, if not installed and used in accordance with the instructions, may cause harmful interference to radio communications. However, there is no guarantee that interference will not occur in a particular installation. If this equipment does cause harmful interference to radio or television reception, which can be determined by turning the equipment off and on, the user is encouraged to try to correct the interference by one or more of the following measures:

- Reorient or relocate the receiving antenna.
- Increase the separation between the equipment and receiver.
- Connect the equipment into an outlet on a circuit different from that to which the receiver is connected.
- Consult the dealer or an experienced radio/TV technician for help.

The device has been evaluated to meet general RF exposure requirement. The device can be used in portable exposure condition without restriction.

LATCH[®]

Support

support@latch.com
(888) 808-0670

LATCH, Inc.

www.latch.com
1220 N Price Rd
STE 2
Olivette, MO 63132

Copyright © 2023 LATCH, Inc.
All rights reserved.

To install and configure devices
download:

LATCH Manager

