

# LATCH®

Latch Systems, Inc.  
508 West 26<sup>th</sup> Street  
Suite 6G  
New York, NY 10001  
United States

Tel: (314) 368-1611  
[www.latch.com](http://www.latch.com)

Date: 2021-11-09

**FCC ID: 2AK5B-HB2**  
**IC: 22143-HB2**

To the attention of  
**Federal Communications Commission**  
Authorization and Evaluation Division

## Declaration letter for label requirement

The Hub complete assembly included Brain module, Outer cover, and Mounting plate. The label is permanent affixed on Brain module (Blue circle), User must disassemble Outer cover, Bracket and Battery cover to turn on power switch (Red circle) before use like below process. User can see label after remove Battery cover.

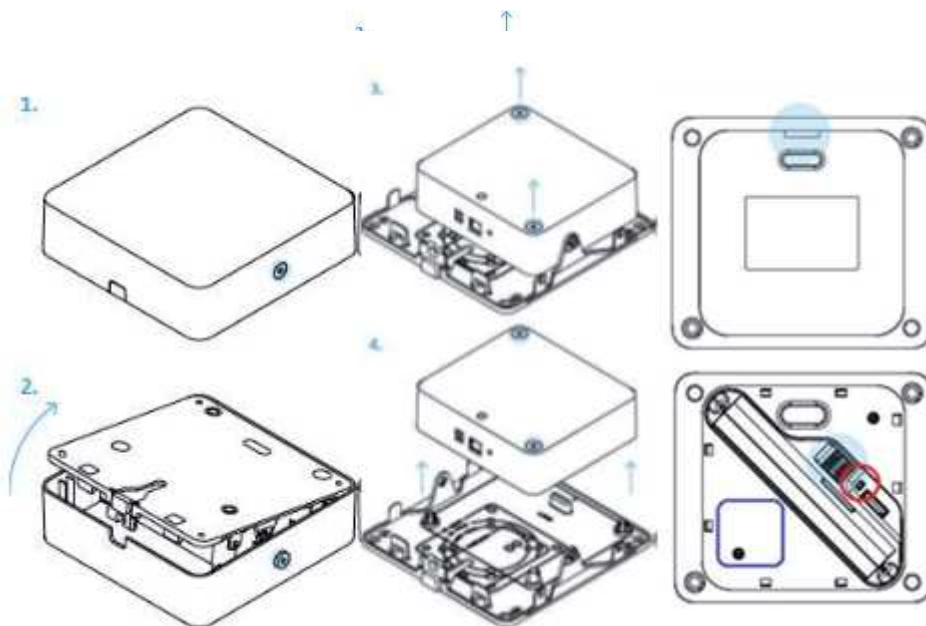

# LATCH®

Latch Systems, Inc.  
508 West 26<sup>th</sup> Street  
Suite 6G  
New York, NY 10001  
United States

Tel: (314) 368-1611  
[www.latch.com](http://www.latch.com)

Sincerely yours,

DocuSigned by:  
*Andre Suttles*  
58351708720A4E3...

---

Andre Suttles / Director of Quality and Compliance  
[andre.suttles@latch.com](mailto:andre.suttles@latch.com)  
508 West 26th Street Suite 6G New York, NY 10001