

Deako Smart Switch

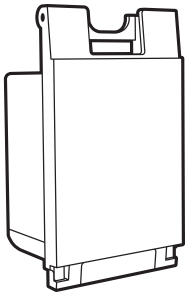

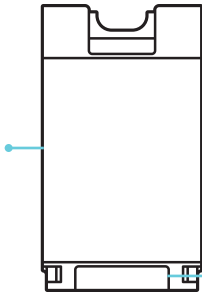



Get to know your Deako Switch

Main button



Configure button

LED key

LED COLOR	WHAT IT MEANS
 Blinking green	Powering up
 Blinking purple	Linking mode
 Blinking blue	Pairing mode
 Blinking white	Pairing or Linking

LED COLOR	WHAT IT MEANS
○ Solid white	Pairing or Linking successful
● Blinking red	Error occurred, try again
● Solid red	Factory resetting

**How many switches
control this light?**



1 switch

If one switch controls this light,

CONTINUE TO PAGE 8

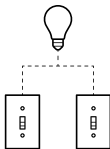

2+ switches

If two or more switches control
this light, **TURN TO PAGE 12**

Insert switch

- 1 Align the **blue tab** on the backplate with the top of the switch

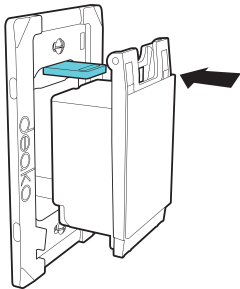

- 2** While pressing the switch inwards, push in the **blue tab**

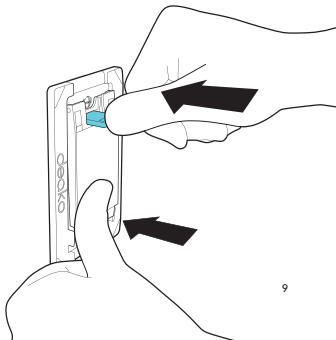

Installation complete!
Now let's get smart.

Pairing

Control your new smart switch by
downloading the **Deako App**.



Remove existing switch

- 1 If there is a switch installed in the backplate you want to upgrade, start by **pulling the corner** of the faceplate

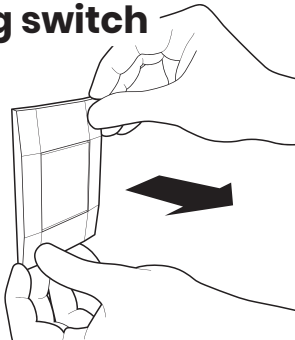

- 2** Pull the **blue tab** outwards to release the switch

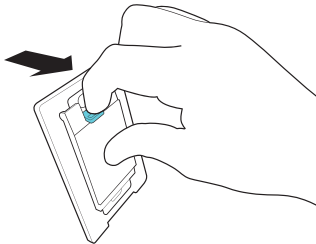

Insert a smart switch

- 3** Locate the **powered backplate** in the circuit by inserting a smart switch into a backplate in the circuit

Align the **blue tab** on the backplate with the top of the switch

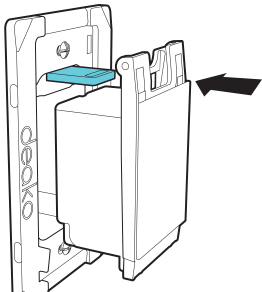

4 While pressing the switch inwards, push in the **blue tab**

If the backplate is powered, the switch will flash ● **green**

If switch does not flash green, move to the next location & repeat step 1

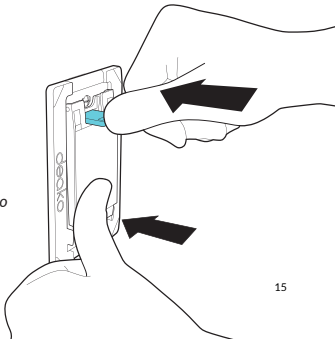

- 5** Wait until the switch stops flashing green, then **press & hold** the configure button until it flashes ● **purple**

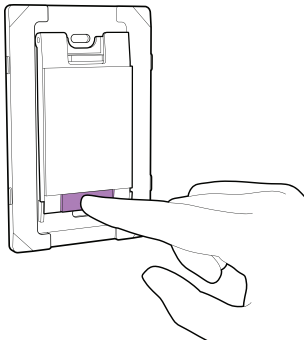

- 6** Move to the next powered backplate, then repeat steps 1-5 for each switch in the circuit

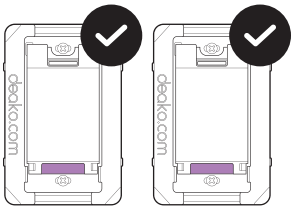

- 7** Once all switches in the circuit are flashing purple, **press & hold** the configure button on any switch until it flashes **white**

Once the switches show solid white and turn off, linking is complete

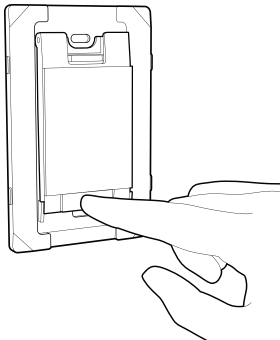

- 8** To test if they've been successfully linked, **press each switch** to confirm that they control the light

To pair your linked switches, see page 11

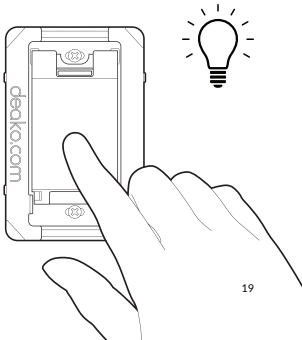

Troubleshooting

- Linking is **only required for 3-way and 4-way** wiring configurations
- If at any point a switch blinks red, **factory reset** it and try again
- To exit linking mode at any point, **press & hold the configure button for 10 seconds** to factory reset each switch before retrying
- If you have dead-end or other nontraditional wiring in your home, you can find wiring and setup instructions at **deako.com/wiring**

Factory reset

Press & hold the configure button for 10 seconds (the LED will be appear solid ● red).

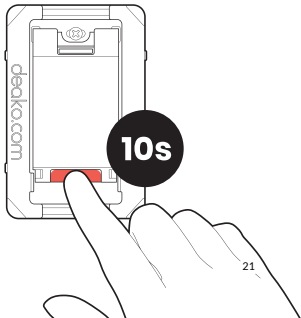

Boring legal stuff

NOTE: This equipment has been tested and found to comply with the limits for a Class B digital device, pursuant to Part 15 of the FCC Rules. These limits are designed to provide reasonable protection against harmful interference in a residential installation. This equipment generates, uses and can radiate radio frequency energy and, if not installed and used in accordance with the instructions, may cause harmful interference to radio communications.

However, there is no guarantee that interference will not occur in a particular installation. If this equipment does cause harmful interference to radio or television reception, which can be determined by turning the equipment off and on, the user is encouraged to try to correct the interference by one or more of the following measures:

Reorient or relocate the receiving antenna.

Increase the separation between the equipment and receiver.

Connect the equipment into an outlet on a circuit different from that to which the receiver is connected.

Consult the dealer or an experienced radio/TV technician for help.

This device complies with Part 15 of the FCC Rules. Operation is subject to the following two conditions:

(1) this device may not cause harmful interference, and

(2) this device must accept any interference received, including interference that may cause undesired operation.

FCC RF Radiation Exposure Statement Caution: To maintain compliance with the FCC's RF exposure guidelines, place the product at least 20cm from nearby persons.

This device contains licence-exempt transmitter(s)/receiver(s) that comply with Innovation, Science and Economic Development Canada's licence-exempt RSS(s). Operation is subject to the following two conditions:

This device may not cause interference.

This device must accept any interference, including interference that may cause undesired operation of the device.

L'émetteur/récepteur exempt de licence contenu dans le présent appareil est conforme aux CNR d'Innovation, Sciences et

Développement économique Canada applicables aux appareils radio exempts de licence. L'exploitation est autorisée aux deux conditions suivantes:

1. L'appareil ne doit pas produire de brouillage;
2. L'appareil doit accepter tout brouillage radioélectrique subi, même si le brouillage est susceptible d'en compromettre le fonctionnement.

To maintain compliance with the RF exposure guidelines, place the product at least 20cm from nearby persons.

Pour rester en conformité avec les consignes d'exposition aux RF, placez le produit à au moins 20 cm des personnes proches.

CAN ICES-3 (B)/NMB-3(B)

NON-MODIFICATION WARNING:

WARNING: Changes or modifications to this device not expressly approved by the manufacturer could void the user's authority to operate the equipment.

Google Play and the Google Play logo are trademarks of Google LLC.

App Store® is a trademark of Apple Inc., registered in the U.S. and other countries.

© 2020 Deako

1-Year Limited Warranty

Patents: deako.com/pat

4201 Roosevelt Way NE #100 Seattle, WA 98105, USA

Need help?

support.deako.com

1-844-673-3256

deako®