



Excellence in Compliance Testing

Certification Exhibit

FCC ID: 2AJXXCP16E0060

IC: 22151-CP16E0060

FCC Rule Part: 15.231

ISED Canada Radio Standards Specification: RSS-210

ACS Project: 16-2062

Manufacturer: Current Products Corp.

Model: CP16E0060

User Manual



CURRENT

SMART WAND™

**USER GUIDE
AND
INSTALLATION MANUAL**

SMART WAND™

USER GUIDE & INSTALLATION MANUAL

Please be sure to carefully and fully read the following user guide. Without proper installation and programming, your SMART WAND™ will not perform as designed.

For assistance, please contact our customer service department at 850-435-4994.

Instructional videos can be viewed by going to www.currentproductscorp.com/support or by scanning the QR Code with your smart phone that will take you to our YouTube Channel.



TABLE OF CONTENTS

Package Contents and Parts Identifier.....	4
Meet Your SMART WAND™.....	5
Horizontal Blinds.....	6
Vertical Blinds.....	7
Assembly and Mounting the SMART WAND™.....	8
Power Up.....	8
Horizontal Blinds Installation Guide.....	9
Vertical Blinds Installation Guide.....	11
Programming your SMART WAND™.....	13
Programming Slat Positions.....	13
Creating a Twist Group.....	17
Making Sense of the Sensors.....	18
Sensor Positions.....	18
Sensor Features.....	18
Optional Steps.....	19
Removing Your SMART WAND™ from a Group.....	19
Master Reset.....	19
Changing Batteries.....	20
Attaching a SMART WAND™ Extension Handle.....	20
Converting a Corded Tilt Blind.....	21
Quick User Guide.....	24
Operation of a Single SMART WAND™.....	24
Controlling a Group of Blinds.....	24
Light Sensor Automation.....	24
Temperature Sensor Automation.....	25
Remote Control User Guide.....	26
Button Labels.....	26
Button Descriptions.....	27
Setting Up the Remote (optional).....	28
Pairing and Unpairing.....	28
Setting the Favorite Button.....	29
Safety Information and RF Statements.....	30
Warranty Information.....	34

PACKAGE CONTENTS AND PARTS IDENTIFIER

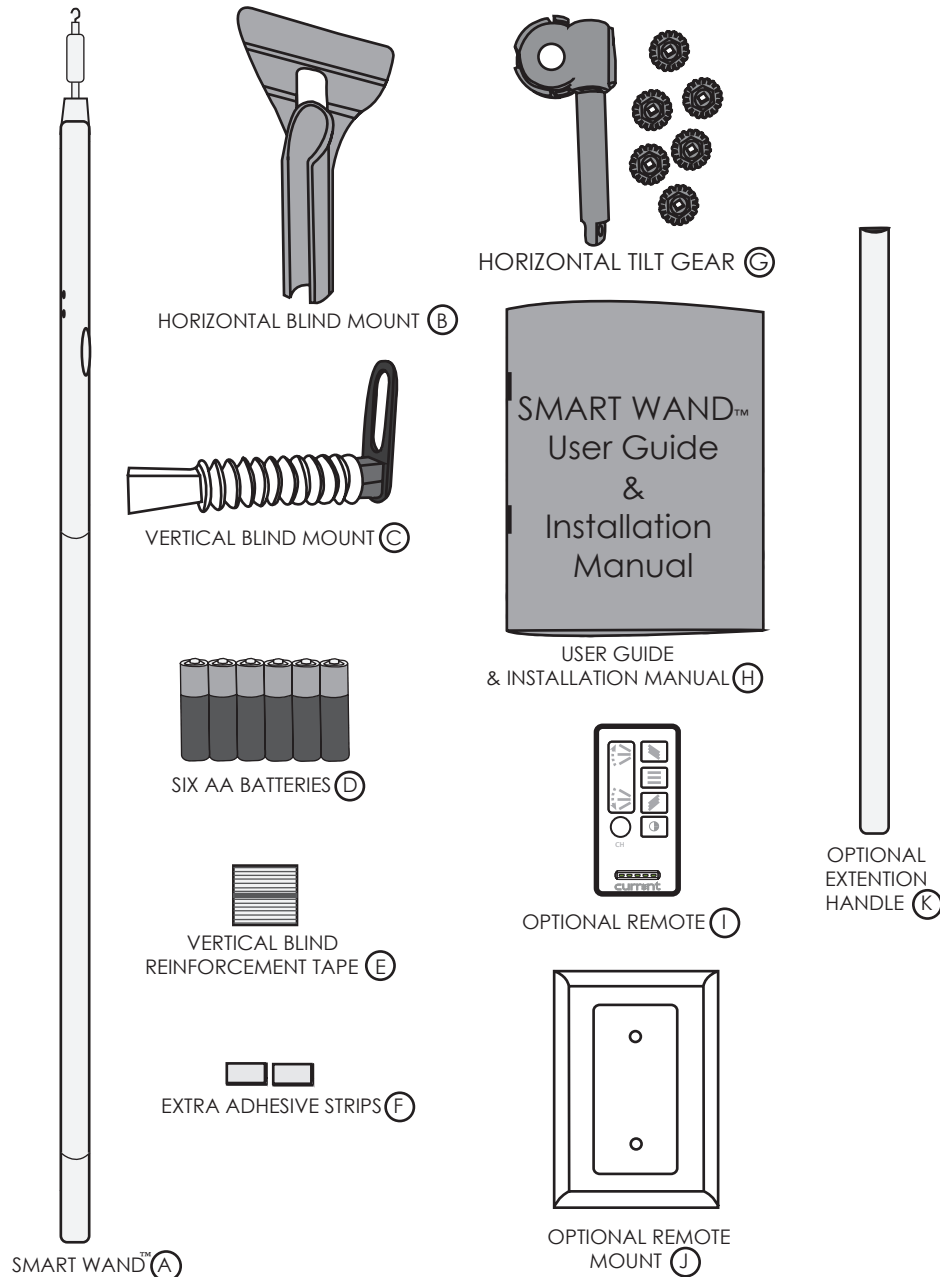

MEET YOUR SMART WAND™

Congratulations on your recent purchase of the SMART WAND™!

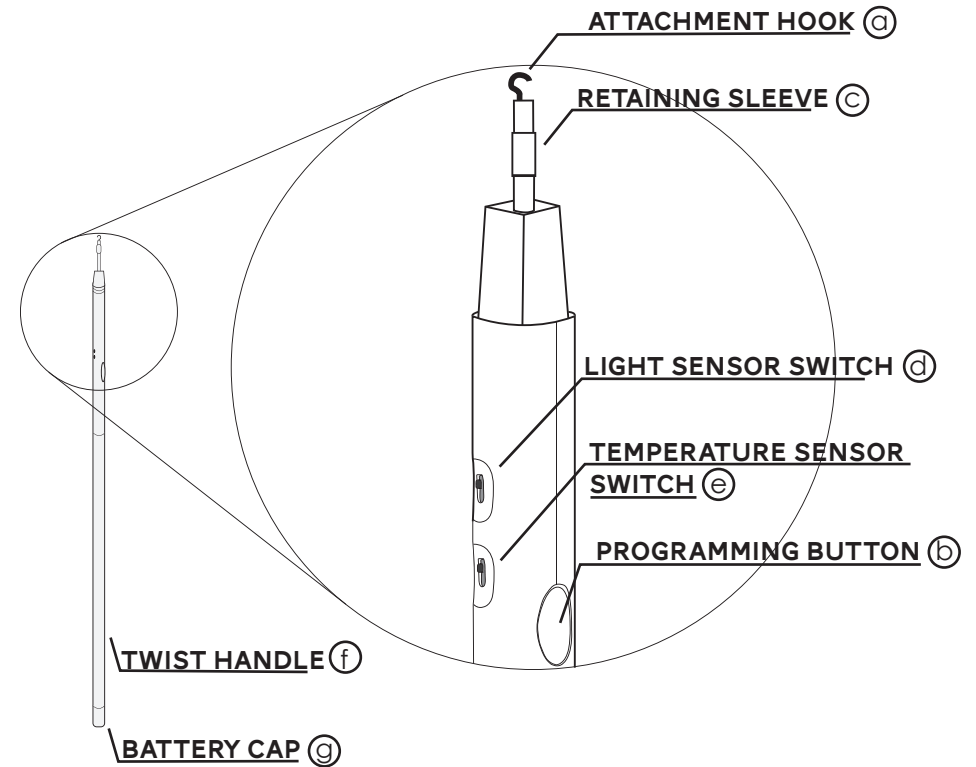

The SMART WAND™ allows the user to automate the movement for both horizontal and vertical window blinds. With an easy twist of the SMART WAND™, or with the optional remote control, the user can fully control the opening and closing of an individual blind's slats or a defined group of blind's slats.

Additionally, your SMART WAND™ contains both light and temperature sensors to automate the opening and closing of the slats. This automatic movement helps provide privacy at night and can be set to open and close the slats to assist with maintaining a comfortable room temperature and help you save energy.

Lastly, the SMART WAND™ requires six (6) 1.5v Alkaline AA sized batteries (provided) which are easy to replace and will provide, in most cases, multiple years between battery changes.

HORIZONTAL BLINDS

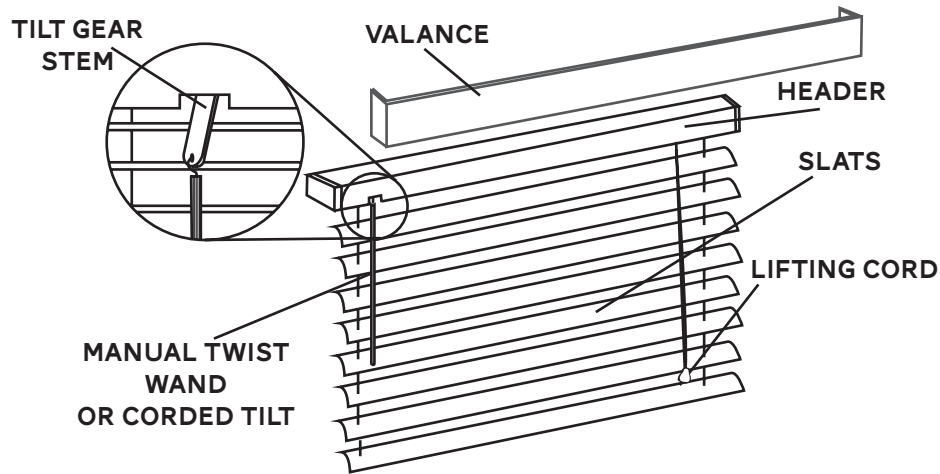

NOTE: Some blinds use a corded tilt mechanism to tilt the slats instead of a wand. If your blinds have a corded tilt mechanism, you will need to convert it to a wand tilt mechanism using the provided horizontal tilt gear. Instructions for converting to a wand tilt mechanism can be found on page 21.

HORIZONTAL BLIND- SLAT POSITIONS

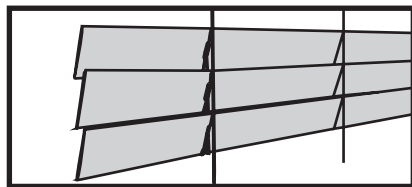

Fully Up Blind Slats- Horizontal

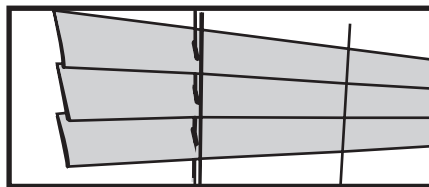

Fully Down Blind Slats- Horizontal

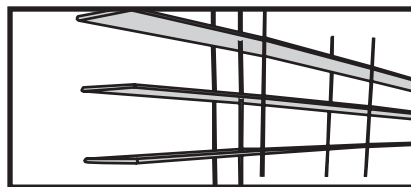

Fully Open Blind Slats- Horizontal

VERTICAL BLINDS

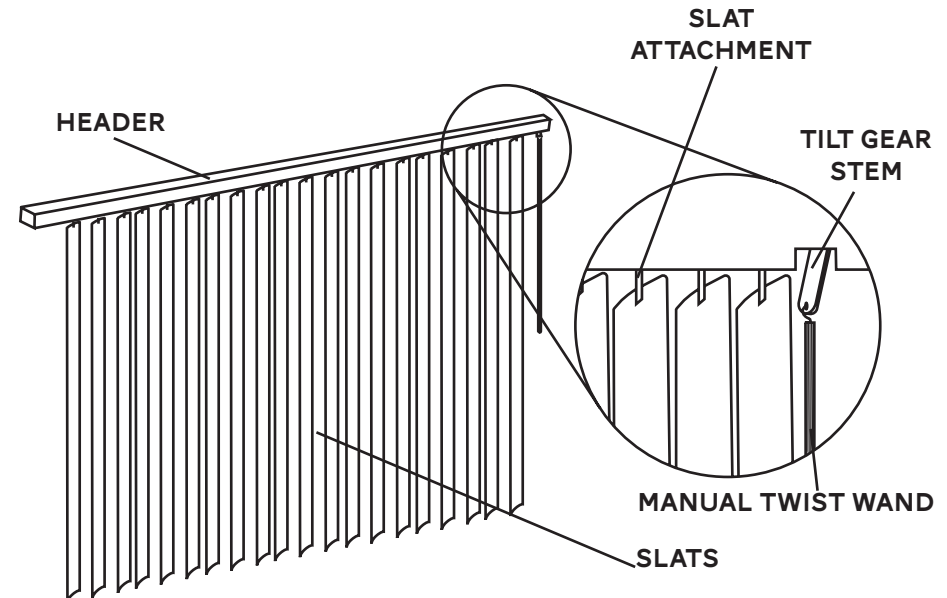

NOTE: The SMART WAND is not compatible with vertical blinds that use a rope or chain to open and close the slats.

VERTICAL BLIND- SLAT POSITIONS

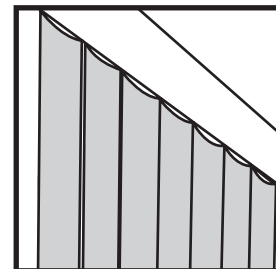

Fully Left Blind Slats- Vertical

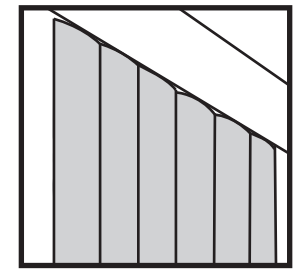

Fully Right Blind Slats - Vertical

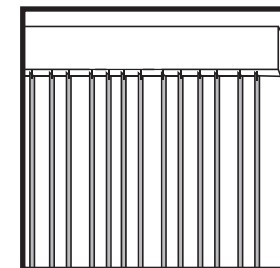

Fully Open Blind Slats- Vertical

ASSEMBLY AND MOUNTING

THE SMART WAND™

For further assistance during the assembly and mounting process, please view our online instructional videos.

POWER UP

Included in your package are six (6) 1.5v Alkaline AA BATTERIES (D). To install the batteries, unscrew the BATTERY CAP (g) located at the bottom of the SMART WAND™ TWIST HANDLE (f) [Fig. 1].

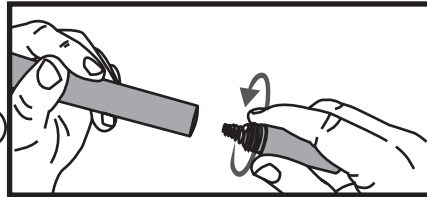

Figure 1; Unscrew Battery Cap

Insert the batteries one after the other with the positive (+) side in first [Fig. 2]. Once the batteries have been inserted, screw the BATTERY CAP (g) back on to secure.

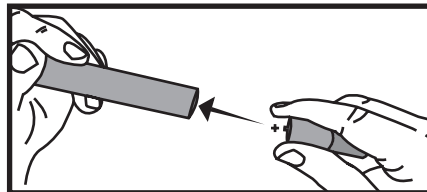

Figure 2, Insert Batteries

If batteries are properly installed, the SMART WAND™ will play a confirmation tune.

HORIZONTAL BLINDS INSTALLATION GUIDE

Before installing the SMART WAND™, make sure you are able to freely tilt your blinds in both directions by turning the twist wand which came with your blinds. If there is significant resistance, you may need to contact your blind manufacturer. **If your blinds utilize a cord to tilt the slats, first proceed to the “Converting a Corded Tilt Blind” section in the User Guide & Installation Manual [Pg. 21].**

Make sure the blind slats are in the horizontal or fully opened position and the header is free of dirt, grime, and grease. If not, use a household cleaner to clean the header before installation.

Detach the original manual tilt wand and attach the SMART WAND™ to the blind’s wand hook.

Mount your SMART WAND™ (A) [Fig. 3] by connecting or inserting the SMART WAND’S™ slat ATTACHMENT HOOK (a) to your blind’s tilt gear stem. Carefully push up the plastic RETAINING SLEEVE (c), [Fig. 3.1] to secure the connection. Now rotate the SMART WAND™ (A) until the two SENSOR SWITCHES (d) & (e) are in front or facing into the room.

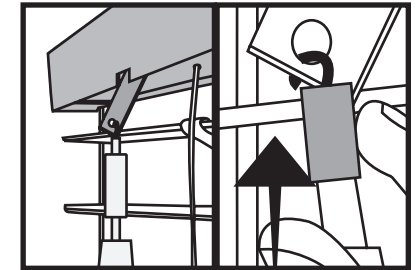

Figure 3; Hook Wand onto Tilt Stem Figure 3.1; Push up Retaining Sleeve

Attach the HORIZONTAL BLIND MOUNT (B) perpendicular to the blind’s header.

Perform a test fit of the HORIZONTAL BLIND MOUNT (B) by snapping the mount onto the SMART WAND™. Slide the mount up or down along the SMART WAND™ until your blind’s tilt gear stem and the SMART WAND™’s ATTACHMENT HOOK (a) are adjacent to the cutout in the blind mount. Be sure the bottom of the horizontal blind mount is resting above the two sensor switches.

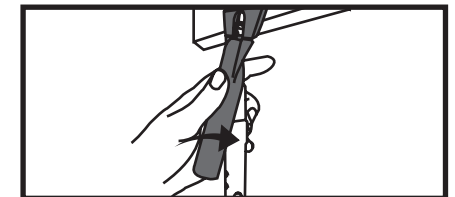

Figure 4; Snap on Blind Mount

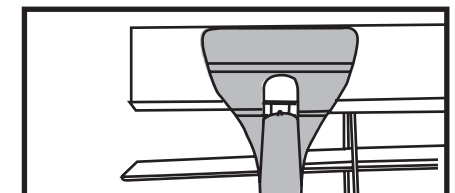

Figure 5; Proper Positioning

VERTICAL BLINDS INSTALLATION GUIDE

During this test fit you are looking to verify that the blind mount can rest completely flush to the header AND that the blind slats resting in the fully open position are not touching the SMART WAND™.

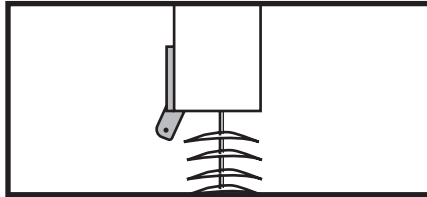

Figure 6; Tilt Stem Protrudes from Headrail

It is important for the blind mount to have a secure connection to the header. Based on the construction of your blinds and the results of the two tests [Fig. 6 and Fig. 7], it may be necessary to add the supplied EXTRA ADHESIVE STRIPS (F) to your blind's header to build the mounting attachment outward [Fig. 8].

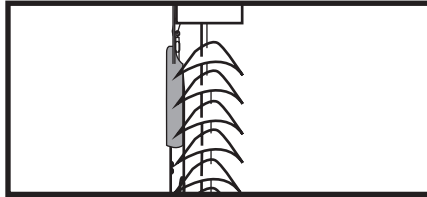
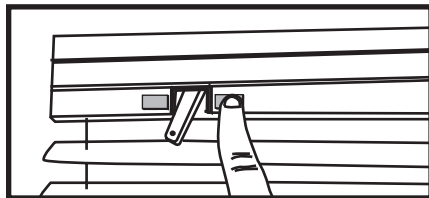

Figure 7; Blind Slats Touch SMART WAND™

NOTE: If the HORIZONTAL BLIND MOUNT (B) extends beyond the top or the side of the blind's header, trim the HORIZONTAL BLIND MOUNT (B) to fit [Fig. 9]. Additionally, if you have a valance installed on the blinds, make sure the top of the neck of the HORIZONTAL BLIND MOUNT (B) is even with or slightly below the bottom of the valance.



(Optional) Figure 8; Build Out Headrail

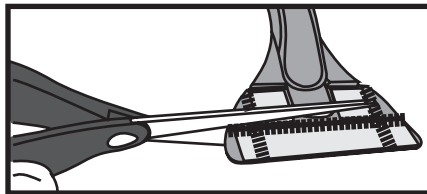

Figure 9; Trim the Blind Mount

Now that you have determined the final position of the HORIZONTAL BLIND MOUNT (B) verify the header is dry from pre-cleaning, then remove the backing on the adhesive strip [Fig. 10] and firmly press to attach it to the blind's header.

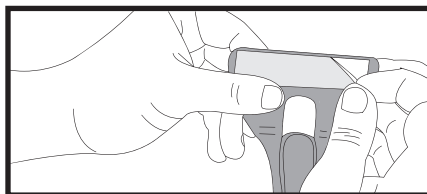

Figure 10; Remove Adhesive

You have now completed installing your SMART WAND™. You may now proceed to Programming the SMART WAND™ [Pg. 13].

Before installing the SMART WAND™, make sure you are able to freely tilt your blinds in both directions by turning the twist wand which came with your blinds. If there is significant resistance you may need to contact your blind manufacturer. **The SMART WAND™ is not compatible with vertical blinds that use a rope or chain to tilt the slats.**

Make sure the blind slats are uniformly opened in the tilted fully opened position, then remove the original manual tilt wand.

Remove the adjacent vertical slat and the original twist wand.

Remove the adjacent vertical slat by carefully pushing the slat upward and then sideways [Fig. 11] to allow for proper positioning of the vertical blind mount.

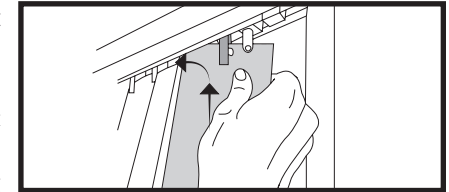

Figure 11; Detach Slat

Install the VERTICAL BLIND MOUNT (C) onto the SMART WAND™.

Install the VERTICAL BLIND MOUNT (C) on the SMART WAND™ by sliding the clear plastic bellows over the ATTACHMENT HOOK (a) until it fits snugly on the SMART WAND™ frame [Fig. 12].

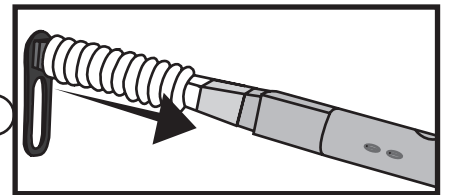

Figure 12; Attach Vertical Blind Mount

Attach the SMART WAND™ to the Vertical Blind.

Pull down on the VERTICAL BLIND MOUNT'S (C) bellows to expose the SMART WAND'S™ ATTACHMENT HOOK (a). Hook the SMART WAND'S™ ATTACHMENT HOOK (a) onto the existing blind's twist gear stem [Fig. 13]. Release the blind mount to allow the bellows to extend upwards toward the header, covering the attachment hook. Be sure the slat attachment is inserted through the slot in the blind mount [Fig. 13.1].

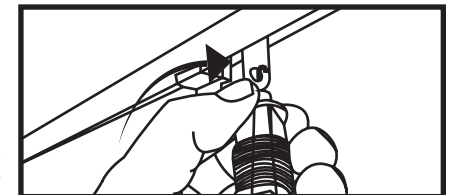

Figure 13; Attach to Vertical Blinds

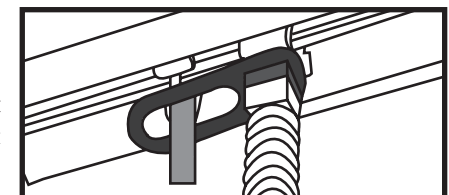

Figure 13.1; Proper Positioning

PROGRAMMING THE SMART WAND™

For further assistance during programming, please view our online instructional videos.

PROGRAMMING SLAT POSITIONS

When programming the SMART WAND™, you will be listening for audible beeps to assist you through the programming steps. It is important to understand that each beep, or series of beeps, are for a specific function in a programming stage. We recommend you minimize the noise within the room while programming the SMART WAND™(s) to best hear these beeps.

NOTE: Be careful to not sum up the number of beeps you have heard, for example, a SINGLE BEEP (1) and then a DOUBLE BEEP (2) is not a TRIPLE BEEP (3).

During the programming phase, if an error is made, the SMART WAND™ will play a short tune. This means that you must restart the programming steps for that SMART WAND™.

Reinforce Adjacent Vertical Slat.

Use the VERTICAL BLIND REINFORCEMENT TAPE (E) to reinforce the top of the first vertical slat before reinstallation [Fig. 14].

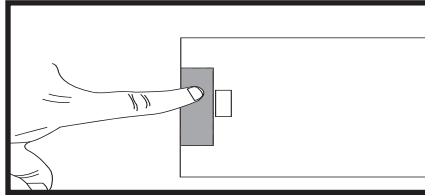

Figure 14, Reinforce Vertical Slat

Reattach Adjacent Vertical Slat.

Carefully replace the slat back onto the header hook by reversing the steps to remove the slat [Fig. 15].

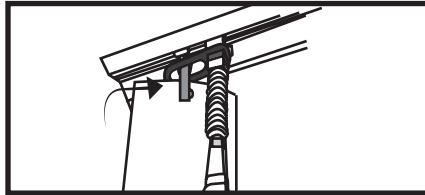

Figure 15, Reattach Vertical Blind

You have now completed installing your SMART WAND™. You may now proceed to Programming the SMART WAND™ [Pg. 13].

I. PLACING THE SMART WAND INTO PROGRAMMING MODE

To place the SMART WAND™ into Programming Mode, press and hold the PROGRAMMING BUTTON (b) until you hear a DOUBLE BEEP (2), then release [Fig. 16].

Prior to hearing a DOUBLE BEEP (2), you will hear a SINGLE BEEP (1), then a DOUBLE BEEP (2). After hearing THE DOUBLE BEEP (2), release. The SMART WAND™ is now in Programming Mode.



Figure 16, Press and Hold Programming Button

I. SETTING THE 1ST POSITION; FULL CLOSED- DOWN/ RIGHT

Twist the SMART WAND™ TWIST HANDLE (f) [Fig. 17] to move the slats of the blind to the FULL DOWN OR LEFT position [Fig. 17.2 or 17.3] then release the TWIST HANDLE (f); be careful not to overtighten slats.

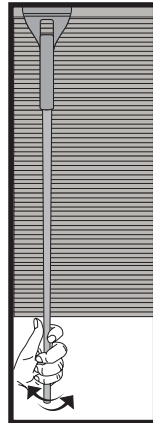

Figure 17; Twist Blinds to Full Closed



Figure 17.1; Push and Hold Programming Button

Press and hold the PROGRAMMING BUTTON (b) until you hear a SINGLE BEEP (1) [Fig. 17.1].

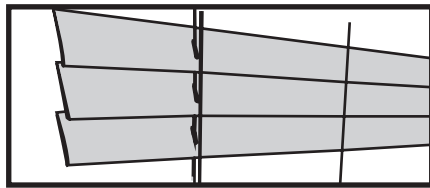

Figure 17.2; Fully Down Blind Slats- Horizontal

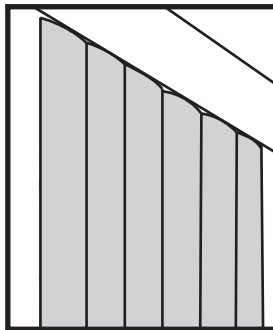

Figure 17.3; Fully Right Blind Slats - Vertical

2. SETTING THE 2ND POSITION; FULL OPEN

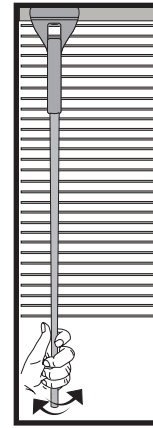

Figure 18; Twist Blinds to Full Open



Figure 18.1; Push and Hold Programming Button

Twist the SMART WAND™ TWIST HANDLE (f) [Fig. 18] in the OPPOSITE direction than the first phase of programming to move slats of the shade to the FULL OPEN position [Fig. 18.2 or 18.3], then release the TWIST HANDLE (f).

Press and hold the PROGRAMMING BUTTON (b) . You will hear a DOUBLE BEEP (2) [Fig. 18.1].

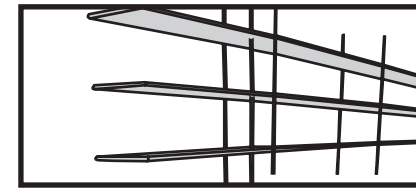

Figure 18.2; Fully Open Blind Slats- Horizontal

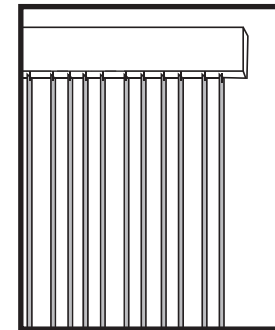

Figure 18.3; Fully Open Blind Slats- Vertical

3. SETTING THE 3RD POSITION; FULL CLOSED- UP/ LEFT

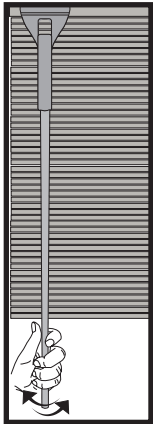

Figure 19; Twist Blinds to Full Up



Figure 19.1; Push and Hold Programming Button

Twist the SMART WAND™ TWIST HANDLE (f) again in the SAME direction [Fig. 19] so the slats reach the FULL UP OR RIGHT position [Fig. 19.2 or 19.3]. Be careful not to overtighten the slats.

Press and hold the PROGRAMMING BUTTON (b). You will hear a TRIPLE BEEP (3) [Fig. 19.1].

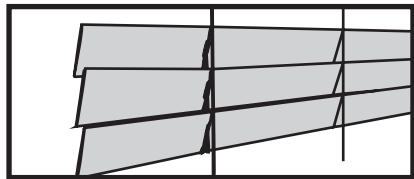

Figure 19.2; Fully Up Blind Slats- Horizontal

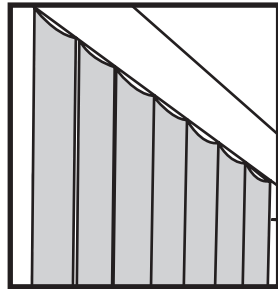

Figure 19.3; Fully Left Blind Slats- Vertical

4. FINISHING UP PROGRAMMING

Twist the SMART WAND™ TWIST HANDLE (f) in the OPPOSITE direction [Fig. 20] to move the slats back to the FULL OPEN position. Press and hold the PROGRAMMING BUTTON (b) until the slats begin to move [Fig. 20.1].

The slats will automatically move to the FULL DOWN OR LEFT and back to the FULL OPEN positions to verify that the positions have been set properly and that you have completed programming the slat positions.

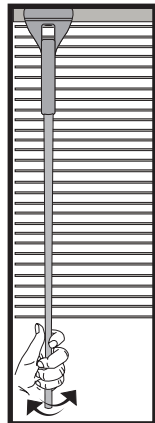

Figure 20; Twist Blinds to Full Open



Figure 20.1; Push and Hold Programming Button

CREATING A TWIST GROUP (OPTIONAL PROGRAMMING)

You may create a twist group prior to or after installation and programming. We recommend linking SMART WAND™s prior to installation on challenging to reach windows.

This SMART WAND™ feature allows you to group multiple SMART WAND™s together so each will respond to the manual twist movement given to any other SMART WAND™s you have placed in the group.

On all of the SMART WAND™s you wish to group, press and hold the PROGRAMMING BUTTON (b) until you hear a SINGLE BEEP (1), then release [Fig. 21].

Once you have initiated the linking sequence on all SMART WAND™s, choose one centrally located SMART WAND™ from the group you wish to designate as the “master”. Press and hold this SMART WAND™s PROGRAMMING BUTTON (b) again until you hear a SINGLE BEEP (1). You have now completed linking your SMART WAND™s and have created a twist group.



Figure 21; Push and Hold Programming Button

To confirm the group has been properly created, all SMART WAND™s in the group will jog [Fig. 22].

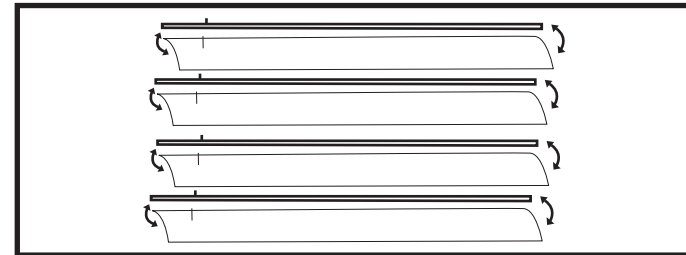
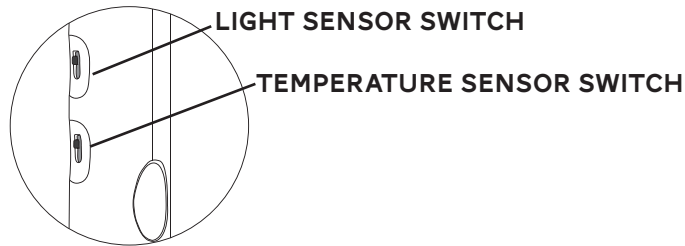

Figure 22; Jog

You DO NOT have to interact with SMART WAND™(s) that you wish to omit from the group. The ability to create a twist group will time out after FIVE (5) minutes of inactivity. You may also remove a SMART WAND™ from programming mode by simply twisting the TWIST HANDLE (f) on the SMART WAND™ you wish to exclude.

MAKING SENSE OF THE SENSORS



SENSOR SWITCH POSITIONS



Off

Light and Temperature Sensors are off.



Fully Automatic

Light Sensor closes at sunset and opens at sunrise.

Temperature sensor opens the slats at 69 degrees and closes the slats at 82 degrees.



Semi-Automatic

Light sensor only closes the blind at sunset.

Temperature sensor only closes the blinds at 82 degrees.

SENSOR FEATURES

Once the LIGHT SENSOR makes an automatic movement, the slats will not automatically open for another eight (8) hours.

Once the TEMPERATURE SENSOR makes an automatic movement, the slats will not automatically open for another eight (8) hours.

The LIGHT SENSOR will prevent the temperature sensor from opening your blinds at night to maintain your privacy.

A manual movement of a SMART WAND™ via the TWIST HANDLE (f) or remote will deactivate the automatic features for three (3) hours.

When blinds are grouped, one sensor triggered movement will move all blinds within that group.

OPTIONAL STEPS

REMOVING A SMART WAND™ FROM A TWIST GROUP

Press and hold the PROGRAMMING BUTTON (b) on the SMART WAND™ you wish to remove from the group until you hear a SINGLE BEEP (1).

Repeat this step to remove additional SMART WAND™s from the group.

ADDING A SMART WAND™ TO A TWIST GROUP

If you need to add an additional SMART WAND™ to the group after ending programming, press and hold the PROGRAMMING BUTTON b on the master SMART WAND™ until you hear a SINGLE BEEP (1), then release. On any SMART WAND™ you wish to add to the group, press and hold the PROGRAMMING BUTTON until you hear a SINGLE BEEP (1), then release.

After all additional SMART WAND™s have been initialized, return to the master to press and hold its PROGRAMMING BUTTON again until you hear a SINGLE BEEP (1). All blinds in that group will jog to confirm the group has been successfully reformed.

MASTER RESET YOUR SMART WAND™

Master reset is performed to return a SMART WAND™ to its factory default settings. All twist groups, paired remotes, and positional settings will be removed from the memory of the SMART WAND™.

Press and hold the PROGRAMMING BUTTON (2) until you hear a QUINTUPLE BEEP (5).

If you miss the signal for your desired set of beeps, listen for a SEXTUPLE BEEP (6). This will reset the menu and prevent accidental master resets.

CONVERTING A HORIZONTAL CORDED TILT BLIND

CHANGING BATTERIES

Using two hands, carefully and slowly unscrew the BATTERY CAP (g) [Fig. 23]. Batteries will naturally fall out of the battery tube.

Replace bad batteries with six (6) new 1.5v Alkaline AA batteries. Always replace all batteries. NEVER mix old and new batteries. Also, NEVER use damaged or dropped batteries.

Replace the BATTERY CAP (g).

The SMART WAND™ will play a short tune to confirm the batteries have been installed correctly.

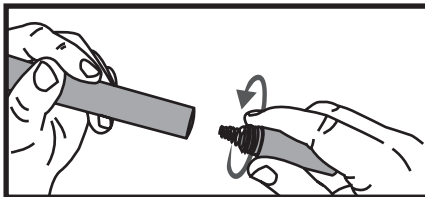

Figure 23; Unscrew Battery Cap

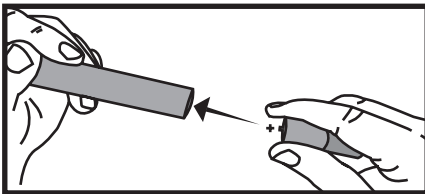

Figure 23.1, Insert Batteries

ATTACHING A SMART WAND™ HANDLE EXTENSION

Carefully remove the BATTERY CAP (g) from the SMART WAND™ [Fig. 24]. Be sure not to remove the batteries.

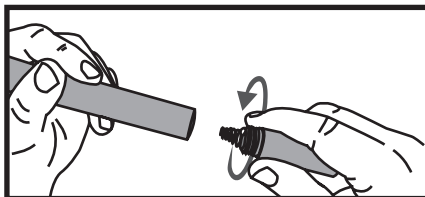

Figure 24; Unscrew Battery Cap

Attach EXTENSION HANDLE (K) onto the end of the SMART WAND™. Screw into place [Fig. 24.1].

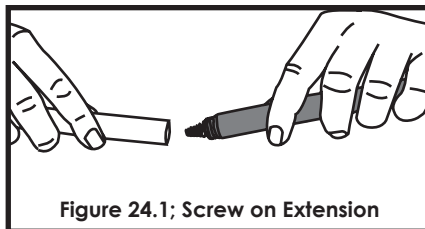

Figure 24.1; Screw on Extension

Reattach BATTERY CAP (g) onto the end of the EXTENSION HANDLE (K). Screw into place.

For further assistance with converting a corded tilt blind, please view our online instructional videos.

Many venetian blinds use a cord to tilt the slats instead of a wand. To install the SMART WAND™ to these types of blinds, you must first replace the corded tilt gear installed on your blind with the UNIVERSAL TILT GEAR (G) included with your SMART WAND™ purchase.

We suggest removing your blinds from the window and performing the next steps on a table or other flat surface.

First, remove the existing corded tilt gear from the blinds header. The standard tilt gear assembly is shown in [Fig. 25].

Remove the tassels by either cutting the cord or removing the knots at the end of the cord [Fig. 26].

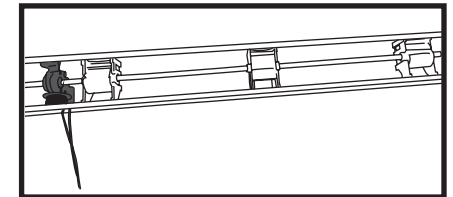

Figure 25; Full Assembly

Typically, the tilt gear is removed by sliding the rod out of the tilt gear, slightly bending the header and lifting the tilt gear out [Fig. 32]. Sometimes the rods are retained in place through either a rod pin, crimps or the end brackets. While each manufacturer installs these tilt gears differently, they are relatively easy to remove. If you find it difficult to determine how to remove the corded tilt gear, view our instructional video located at www.currentproductscorp.com/support.

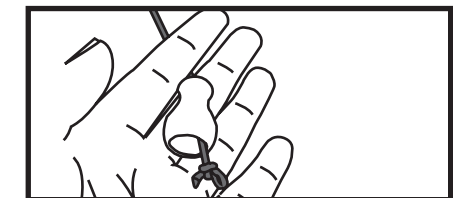

Figure 26; Cut or Untie the knots

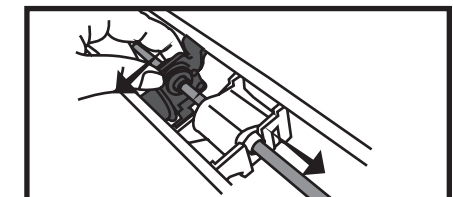

Figure 27; Remove Existing Gear by Sliding Rod Out

Next, install the UNIVERSAL TILT GEAR (G).

Determine the size and shape of the rod located in your header. Locate the ADAPTER from the selection supplied which matches your rod shape and size and snap into the UNIVERSAL TILT GEAR (G) [Fig. 28].

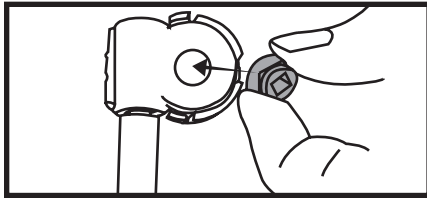

Figure 28; Snap in Attachment

Place the gear's stem through the opening in the header and slide the rod through the gear to its original position [Fig.]. If a rod pin or the end brackets were removed while removing the corded tilt gear, replace back into their original position.

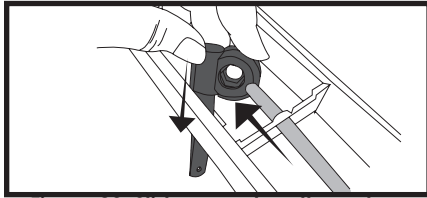

Figure 29; Slide gear stem through header

You are now ready to reinstall your blinds and install the SMART WAND. Please proceed to the Horizontal Blinds Installation Guide [Pg. 9].

QUICK USER GUIDE

OPERATION OF A SINGLE SMART WAND™

After the initial programming, simply twist the TWIST HANDLE (f) of the ungrouped SMART WAND™ to move your blind to the desired slat position and release.

CONTROLLING A GROUP OF BLINDS

Once a group is created, you can twist any SMART WAND™ in the group and release at the desired position. All other blinds in the group will automatically move to the selected position.

OPERATION OF A SINGLE SMART WAND™ WITHIN A GROUP

Once a group has been set, twisting any SMART WAND™'s TWIST HANDLE (f) will control the entire group. To operate a single SMART WAND within a group, quickly twist the TWIST HANDLE (f), then quickly twist the TWIST HANDLE (f) again in the opposite direction. After these two short twists, you should hear a confirmation beep, signaling that the SMART WAND will now control only that single blind. This mode will time out without activity, so after the confirmation beep, proceed to twisting the TWIST HANDLE to the position where you would like the single blind to remain.

LIGHT SENSOR AUTOMATION

The SMART WAND™ has an internal light sensor providing the capability to automatically close your slats at night to provide full privacy in the room, and open your slats in the morning to allow in natural light.

The LIGHT SENSOR SWITCH (d) allows the user to control the light sensor and has three positions.

Top: Sensor is turned off.

Middle: Sensor will open the slats around sunrise and close the slats around sunset.

Bottom: Sensor will only close the blind around sunset.

TEMPERATURE SENSOR AUTOMATION

The SMART WAND™ contains an internal temperature sensor providing the capability to automatically close your slats when the temperature near the window is 82°F and open your slats when the temperature is 69°F. This function is designed to help with energy savings and provide comfort in the room.

The TEMPERATURE SENSOR SWITCH (e) allows the user to control the temperature sensor and has three positions.

Top: Sensor is turned off.

Middle: Sensor will open the slats at 69°F and close the slats at 82°F.

Bottom: Sensor will only close the slats at 82°F.

REMOTE CONTROL USER GUIDE

The optional remote control provides the user with added functionality for controlling their blinds. Your SMART WAND™(s) must be programmed before they can be paired to a remote. The remote control contains single push ability to move the slats open, closed, or to your favorite position. The remote also allows the user to set up separate channels to control specified blinds for customized control.

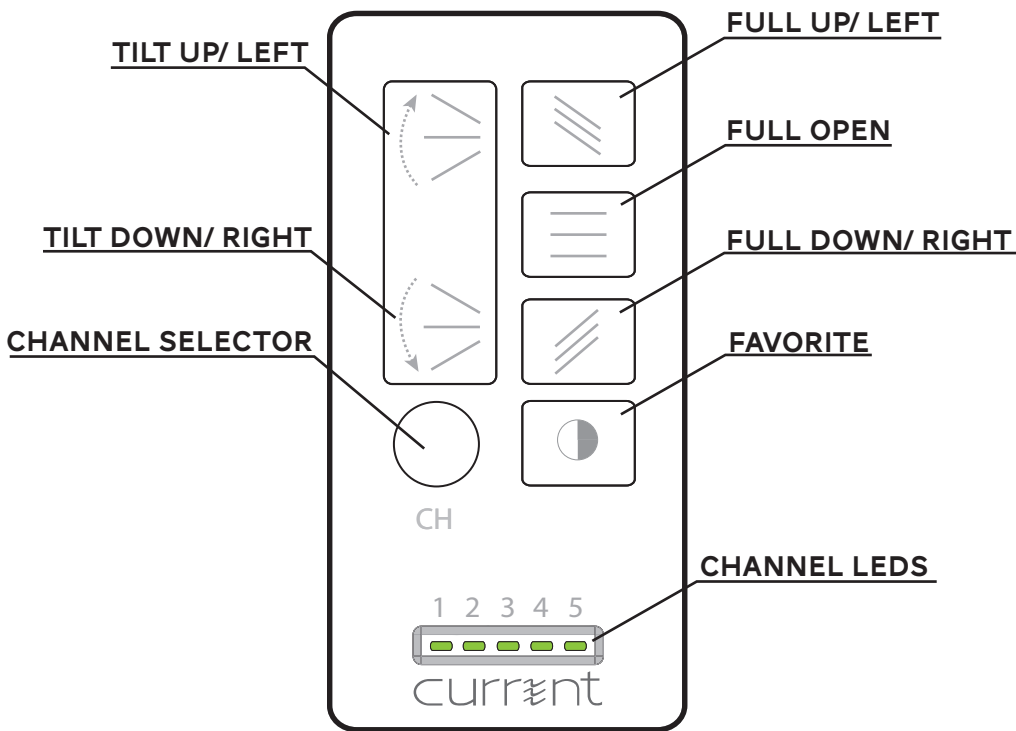

REMOTE BUTTON DESCRIPTIONS

TILT TOGGLE

Briefly press and release to move the slats in the open or closed direction and will stop at the next position setting. There are seven (7) position settings from the full up to the full down position. The user may also press and hold the toggle button until the slats get to the desired position, then release the toggle.

FULL UP/ LEFT

Moves the slats to the full up position for horizontal blinds or full right position for vertical blinds.

FULL OPEN

Moves all slats to the full open position.

FULL DOWN/ RIGHT

Moves all slats to the full down position for horizontal blinds, or full left position for vertical blinds.

FAVORITE

The user can program this button to any position they choose to be their most preferred position; however, if left unchanged it will move the slats to approximately half way between the full open and the full down/ left position.

CHANNEL SELECTOR

Used to customize control of multiple blinds on a single remote. The currently selected channel is indicated by the Channel LEDs. Pressing the CHANNEL Button once will display the current channel. Pressing it again will switch to the next channel. When all LEDs are lit, the remote is selected to broadcast on all channels.

SETTING UP THE REMOTE

(OPTIONAL PROGRAMMING)

PAIRING THE REMOTE

Determine which blind(s) you wish to pair to the handheld remote.

Press the PROGRAMMING BUTTON (b) on each of the SMART WAND™(s) you wish to pair to the remote until you hear a SINGLE BEEP (1) [Fig. 30], then release.

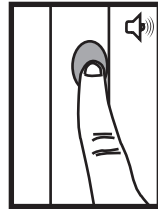

Figure 30;
Push and Hold

Press the CHANNEL button until the LEDs reflect the desired channel you wish to set [Fig. 31].

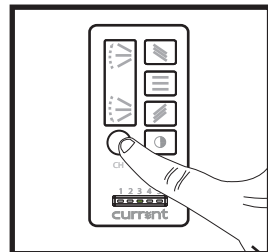

Figure 31; Push Channel
Button

Use a tack or pen to press and release the PAIRING button on the back of the remote [Fig. 32] When this button has been pressed, the LED's on the front of the remote will scroll to confirm.

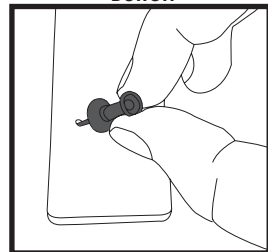

Figure 32; Press in Tack

To PAIR, press the top left button on the tilt toggle [Fig. 33]. The blind(s) will jog down and up showing that it has received the command and completed the process. If you ever need to unpair, you can repeat the same steps and press the bottom button on the tilt toggle to unpair [Fig. 33.1].

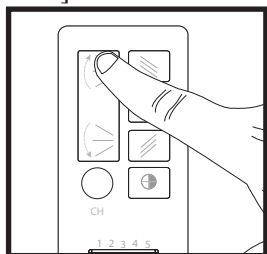

Figure 33; Push To Pair

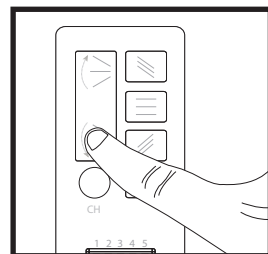

Figure 33.1; Push to Unpair

SETTING THE FAVORITE BUTTON

The FAVORITE Button allows the user to program a slat position unique to the user which moves all slats included on that channel to the user's favorite position.

To program the FAVORITE Button, twist the SMART WAND™ until the desired position is reached.

Next, press and hold the PROGRAMMING BUTTON (b) on the SMART WAND™ until you hear a TRIPLE BEEP (3), then release. [Fig. 34].

Your FAVORITE Button is now programmed to move that blind to your favorite position. Each SMART WAND™ can be set to have different favorite positions.

After all SMART WAND™ (s) are set, test by moving your blinds, then pressing the FAVORITE Button. All blinds on that channel should move to their programmed favorite position.



Figure 34;
Push and Hold
Programming
Button

SAFETY INFORMATION



WARNING

Read all warnings and instructions prior to installing the SMART WAND™. Failure to follow these instructions may result in property damage or serious personal injury.



CAUTION

Do not use the SMART WAND™ for anything other than its intended use. Any usage of the part of this kit outside of its intended purposes is not covered under the warranty.



CAUTION

Existing blinds may have sharp edges. Use gloves to prevent cuts or abrasions whenever removing or reinstalling blinds.

FCC: 2AJXXCP16E0060

Model:

IC: 22151-CP16E0060

FCC STATEMENT

This device complies with Part 15 of the FCC Rules. Operation is subject to the following two conditions:

1. This device may not cause harmful interference, and
2. This device must accept any interference received, including interference that may cause undesired operation.

Warning: Changes or modifications not expressly approved by Current Products Corp. could void the user's authority to operate the equipment.

NOTE: This equipment has been tested and found to comply with the limits for a Class B digital device, pursuant to Part 15 of the FCC Rules. These limits are designed to provide reasonable protection against harmful interference in a residential installation. This equipment generates, uses, and can radiate radio frequency energy and, if not installed and used in accordance with the instructions, may cause harmful interference to radio communications. However, there is no guarantee that interference will not occur in a particular installation. If this equipment does cause harmful interference to radio or television reception, which can be determined by turning the equipment off and on, the user is encouraged to try to correct the interference by one or more of the following measures:

- Reorient or relocate the receiving antenna.
- Increase the separation between the equipment and receiver.
- Connect the equipment into an outlet on a circuit different from that to which the receiver is connected.
- Consult the dealer or an experienced radio/TV technician for help.

RF WARNING STATEMENT

The device has been evaluated to meet general RF exposure requirements. The device can be used in portable exposure condition without restriction.

IC STATEMENT

This device complies with Industry Canada license-exempt RSS standard(s). Operation is subject to the following two conditions: (1) this device may not cause interference, and (2) this device must accept any interference, including interference that may cause undesired operation of the device.

Le présent appareil est conforme aux CNR d'Industrie Canada applicables aux appareils radio exempts de licence. L'exploitation est autorisée aux deux conditions suivantes: (1) l'appareil ne doit pas produire de brouillage, et (2) l'utilisateur de l'appareil doit accepter tout brouillage radioélectrique subi, même si le brouillage est susceptible d'en compromettre le fonctionnement.

This equipment complies with the radiation exposure limits in an uncontrolled environment. This equipment is in direct contact with the user's body under certain operating conditions. This transmitter must not be co-located or operating in conjunction with any other antenna or transmitter.

Cet équipement est conforme aux limites d'exposition aux radiations dans un environnement non contrôlé. Cet équipement est en contact direct avec le corps de l'utilisateur dans des conditions de fonctionnement normales. Cet émetteur ne doit pas être co-localisées ou opérant en conjonction avec toute autre antenne ou transmetteur.

WARRANTY INFORMATION

LIMITED WARRANTY

Current Products Corp. (the “Manufacturer”) hereby warrants to Customer that the Smart Wand™ (the “Product”) is and will remain for a period of one (1) year from the date of delivery to Customer as evidenced by Customer’s proof of purchase (the “Warranty Period”), free of defects in materials and workmanship, provided that the Product used for its intended purpose and is properly serviced in accordance with the User’s Manual provided to Customer. Subject to the foregoing, if at any time during the Warranty Period the Product fails to conform to the foregoing warranty by reason of defects in materials or workmanship, Customer shall promptly notify Manufacturer in writing, and Manufacturer at its option shall repair or replace the defective Product or component part without charge to Customer, except for: (A) costs incurred in transporting the Products or component parts to and from Manufacturer’s designated dealer or its manufacturing plant; and (B) charges for labor or other costs incidental to the removal or remounting of component parts repaired or replaced under this Warranty, both of which shall be borne by Customer. Notwithstanding any provision herein to the contrary, this Warranty shall not extend or obligate Manufacturer to take any action with respect to: (i) Products which have been modified, altered, installed, used or operated in a manner which is not recommended by Manufacturer, including any Products in which parts not manufactured or approved by Manufacturer have been installed; (ii) Products which have not been regularly and properly serviced in accordance with the User’s Manual or which have otherwise been neglected; and (iii) ordinary wear and tear, service and maintenance and replacement items; (iv) the Product has been used, or attempted to be used, for other than the customary usage or for other than the Product’s intended use; (v) the Product has been subject to mishandling, misuse, or abuse; (vi) the product has suffered damage resulting from lightning, power surges, vandalism, fire, earthquake, acts of nature, or any other cause which the product was not designed to withstand; or (vii) damage to the Product cause by battery decay or corrosion.

This Limited Warranty extends only to the original owner. This Limited Warranty is not transferable. This Limited Warranty does not cover normal wear or tear or deterioration which occurs with the passage of time. Batteries originally provided with a new product, if any, are produced by a third party and are not warranted by Manufacturer. No employee, distributor, dealer, agent or representative is authorized to change the terms of this Limited Warranty in any way, to extend the warranty time periods, or to grant additional warranties, and no attempt to do any of the foregoing will be binding upon Manufacturer.

LIMITATION OF LIABILITY

EXCEPT AS SPECIFICALLY STATED IN THE PARAGRAPHS IMMEDIATELY ABOVE, MANUFACTURER MAKES NO WARRANTY OR REPRESENTATION, EXPRESS OR IMPLIED, INCLUDING, WITHOUT LIMITATION, ANY WARRANTY OF MERCHANTABILITY OR FITNESS FOR A PARTICULAR PURPOSE. THE WARRANTY SET FORTH ABOVE AND THE OBLIGATIONS AND LIABILITIES OF MANUFACTURER THEREUNDER REPRESENT CUSTOMER’S SOLE AND EXCLUSIVE REMEDIES AND ARE EXPRESSLY MADE IN LIEU OF ANY AND ALL OTHER REMEDIES, WARRANTIES, GUARANTIES OR LIABILITIES, EXPRESS OR IMPLIED, ALL OF WHICH ARE HEREBY EXPRESSLY WAIVED BY CUSTOMER. THERE ARE NO WARRANTIES WHICH EXTEND BEYOND THE DESCRIPTION ON THE FACE HEREOF. IN NO EVENT SHALL MANUFACTURER’S LIABILITY HEREUNDER EXCEED THE PURCHASE PRICE FOR THE PRODUCTS, NOR SHALL MANUFACTURER BE LIABLE FOR ANY SPECIAL, INDIRECT, INCIDENTAL OR CONSEQUENTIAL DAMAGES OF ANY NATURE WHATSOEVER.

OTHER LEGAL RIGHTS

This warranty gives you specific legal rights, and you may also have other rights, which vary from state to state.

CURRENT



Current Products Corp.
1995 Hollywood Ave.
Pensacola, FL 32505

www.currentproductscorp.com

850-435-4994