

SAFETY NOTE

1. This appliance can be used by children aged from 8 years and above and persons with reduced physical, sensory or mental capabilities or lack of experience and knowledge if they have been given supervision or instruction concerning use of the appliance in a safe way and understand the hazards involved.
2. Children shall not play with the appliance.
3. Cleaning and user maintenance shall not be made by children without supervision.
4. If the supply cord is damaged, it must be replaced by the manufacturer, its service agent or similarly qualified persons in order to avoid a hazard.
5. **WARNING:** the drive shall be disconnected from its power source during cleaning, maintenance and when replacing parts.
6. The instructions shall status that the A-weighted emission sound pressure level of the drive is equal to or less than 70 dB(A), e.g. by writing $LpA \leq 70 \text{ dB(A)}$.
7. The mass and the dimension of the driven part shall be compatible with the rated torque and rated operating time.
8. The type of driven part the drive is intended for.
9. **WARNING:** Important safety instructions. It is important for the safety of persons to follow these instructions. Save these instructions.
10. Do not allow children to play with fixed controls. Keep remote controls away from children.
11. Frequently examine the installation for imbalance and signs of wear or damage to cables and springs. Do not use if repair or adjustment is necessary.
12. Watch the moving shutter and keep people away until the shutter is completely closed.
13. **WARNING:** Important safety instructions. Follow all instructions, since incorrect installation can lead to severe injury.
14. Before installing the drive, remove any unnecessary cords and disable any equipment not needed for powered operation.



DM35LE, DM45LEQ

Instruction | A-03



Features

- Built-in Receiver
- Jog & Tilt
- Adjust Limits
- Reset To Factory Mode
- Switch Direction
- Stall Protection
- Radio Lock
- Electronic Limit
- Preferred Stop Position
- Low Power Standby

Fields of Application

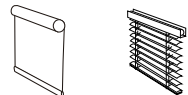

The motor is suitable for roller blinds and venetian blinds.

Specifications

Working Temperature: -10°C ~ +50°C	Radio Frequency: 433.925MHz
Input voltage: DC 12V	Maximum running time: 6 minutes

Following data for reference

Model	Rated Torque (N.m)	Rated Speed (rpm)
DM35LE - 3/28	3	28
DM35LE - 10/9	10	9
DM35LE - 6/24	6	24
DM35LE - 13/13	13	13
DM45LEQ - 3/28	3	28
DM45LEQ - 10/9	10	9

* For reference only.

Attention

Never drop, knock, drill or submerge the motor. Keep the power cable in right position as following. Important safety instructions to be read before installation. Incorrect installation can lead to serious injury and will void manufacturer's liability and warranty.

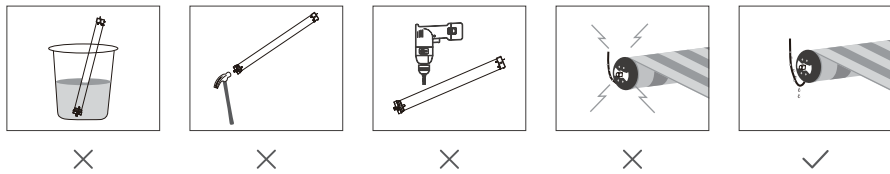

Charging Instructions

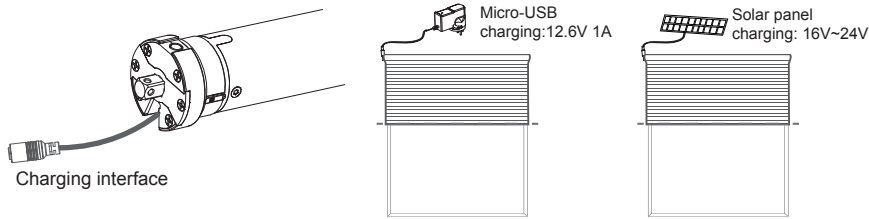

1. This motor has a 12V built in Li-ion battery pack with integrated charge management.
2. Max power input for recharging: 12.6V 1A.
3. Before first use please charge motor for 6 hours.
4. During operation, motor will stop running when the voltage is lower than 8.5V and it will resume again when the voltage is greater than 10.0V.
5. During the continuous operation of the motor, when the voltage is lower than 10.5V, the buzzer will beep 10 times.

Motor Installation

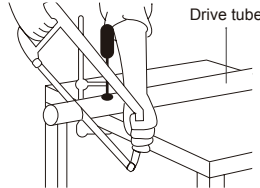

Step 1 Cut drive tube to required length.

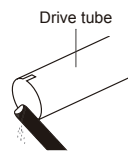

Step 2 Ensure tube edge is clean and burr-free.

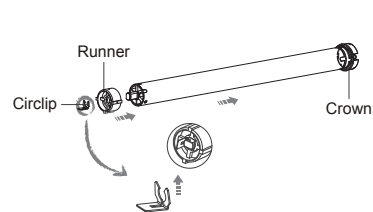

Step 3 Mount correct crown & drive adapter on the motor. Make sure drive adapter fits firmly and crown rotates freely.

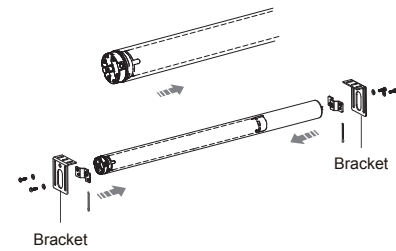

Step 4 Align the notches on the crown and drive adapter with the drive tube, slide and fit the motor into drive tube. Mount idler and bracket on both ends.

Caution

1. Do not expose motor to humid or extreme temperature conditions.
2. Do not drill into motor.
3. Do not cut the antenna and keep it clear from metal objects.
4. Do not allow children to play with this device.
5. If power cable or connector is damaged, do not use.
6. Ensure correct crown and drive adaptor are used.
7. Ensure power cable and aerial are clear and protected from moving parts.
8. Cable routed through walls shall be properly isolated.
9. Motor is to be mounted in horizontal position only.
10. Before installation, remove unnecessary cords and disable equipment not needed for powered operation.
11. Installation and programming to be performed by a qualified professional, use or modification outside the scope of this instruction may void warranty.



Important Safety Instructions To Be Read Prior To Operation.

Setting Notice

Please read following points of attention carefully before setting.

1. Don't operate motors when low voltage alarm.
2. Operation:
 - ①The valid interval time of the buttons is within 10S, if there is no operation within 10S, the emitter will exit the present setting.
 - ②The motor will jog and beep as hint, pls operate after the prompt.
3. Set limit position:
 - ①After the upper/lower limit setting, and the upper/lower limit position can't at the same position.
 - ②After limit setting, with power off and memory function.
 - ③Limit delete will clear all limit memory.
 - ④It will exit limit setting when program there is no operation for 2 minutes.
4. If the emitter lost, please pairing again with new emitter.
5. One motor can store maximum 20 channels; after fully stored, if pair new channels, only the last one will be covered circularly.

Button Instructions

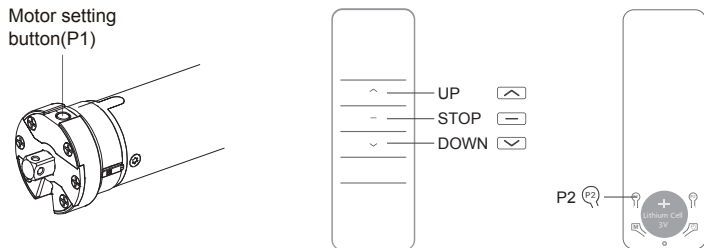

Functions of P1 button

1. Cycle Operation: After setting the limit position, press P1 button once and every press the motor will run upward → stop → downwardcircularly.
2. Pairing: Press P1 button for 2S, motor jog once, release button and make a long noise, motor is ready for pairing.
3. Radio Lock: Press and hold P1 button for 6S, the motor will jog twice, release button and beep twice, the motor enters radio lock status, the motor won't receive any signal; press P1 button once to disable Radio Lock.
4. Switch Direction: Press and hold P1 button for 10S, the motor will jog 3 times, release button and beep 3 times, the running direction of the motor has been changed and the original limit setting is saved.
5. Reset to Factory Mode: Press and hold P1 button for 14S, the motor will jog 4 times, release button and beep 4 times, release button, the motor has been reset to factory mode.



Essential Settings

Step 1 to 3 must be completed to ensure proper operation.

1 Pairing

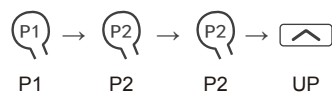

Repower the motor (1 jog and make a long noise) or press P1 button for 2S (1 jog), release button and make a long noise, motor is ready for pairing. Press P2 (1 jog and 1 beep), press P2 again (1 beep), press UP (1 jog and 6 beeps), the motor has been paired successfully, and UP button can control the motor to jog forward.

* If within 10S, the motor doesn't receive signal from the any emitter, it will exit the pairing mode automatically.

2 Switch Rotating Direction (Optional)

If press UP, the motor runs downward, try below to switch direction

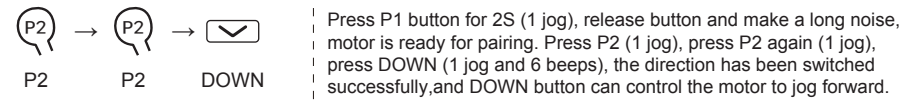

Press P1 button for 2S (1 jog), release button and make a long noise, motor is ready for pairing. Press P2 (1 jog), press P2 again (1 jog), press DOWN (1 jog and 6 beeps), the direction has been switched successfully, and DOWN button can control the motor to jog forward.

* Method 2 of Switch Rotating Direction: "Button Instructions - Functions of P1 button - 4. Switch Direction".

3 Upper and Lower Limits Setting

1 Enter the limit position setting status

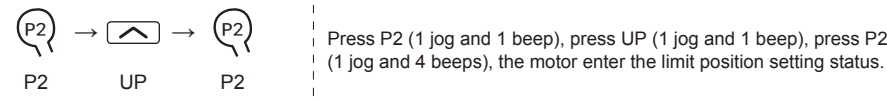

Press P2 (1 jog and 1 beep), press UP (1 jog and 1 beep), press P2 (1 jog and 4 beeps), the motor enters the limit position setting status.

* When the motor is running status, press P2 button of the emitter, the motor enters the stepping status, you can set the limit position accurately, and press P2 button again to exit the stepping status.

2 Set upper limit position



Press UP or DOWN to operate the motor to desired upper limit position, press STOP button to stop the motor, and then continuously short press STOP button 5 times or press and hold STOP button for 3S (5 beeps), the motor jogs once, and the upper limit position is set successfully.

3 Set lower limit position



Press UP or DOWN to operate the motor to desired lower limit position, press STOP button to stop the motor, and then continuously short press STOP button 5 times or press and hold STOP button for 3S (5 beeps), the motor jogs once, and the lower limit position is set successfully.

* The upper and lower limit positions cannot be set at the same position. After entering the limit setting mode, if there is no button operation within 2 minutes, the motor will automatically exit the limit setting mode. If the motor is powered off and then powered on, it will exit the limit setting mode. To reset the limit position, you must first cancel limit or restore factory settings. In setting the limit status, press P1 button to perform the switch direction operation, and the limit setting status will be automatically exited after the direction has been switched successfully.

4 Add A Preferred Position

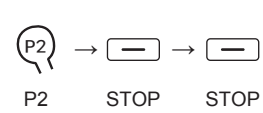

Check both upper and lower limits are set. Operate the product to desired preferred position. Press P2 (1 jog and 1 beep), press STOP (1 jog and 1 beep), STOP again (1 jog and 3 beeps), the preferred position is set.

• Repeat same procedure will delete the preferred position.

* After the preferred position is set, if the motor is not at the preferred position, press STOP button for 2S, the motor will automatically run to the preferred position.
Roller systems: When the motor is in continuous operation mode, long press STOP button, the motor will run directly from the current position to the preferred position.
Venetian blind system: When the motor is in the jog mode, long press STOP button, the motor will first run from the current position to the lower limit position, and then from the lower limit position to the preferred position.

5 Jog Mode & Running Mode Switch

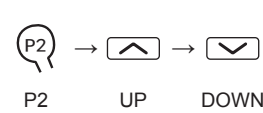

Press P2 (1 jog and 1 beep), press UP (1 jog and 1 beep), press DOWN (1 jog and 2 beeps), jog mode & running mode switch successfully.

* When in jog mode, press UP or DOWN once, the motor will be jog running, if press more than 2S, the motor will be continuously running.

6 Adjust Limits

1 Adjusting the upper limit position

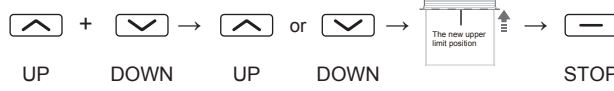

The motor run to the upper limit position, press and hold UP and DOWN buttons for 5S (1 jog and 4 beeps), operate the product to desired new upper limit position, continuously short press STOP button 5 times or press and hold STOP button for 3S (5 beeps), the motor jogs once, the new upper limit position is programmed successfully.

2 Adjusting the lower limit position

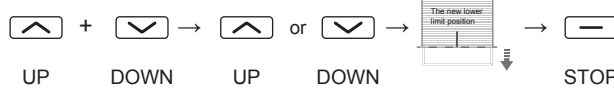

The motor run to the lower limit position, press and hold UP and DOWN buttons for 5S (1 jog and 4 beeps), operate the product to desired new lower limit position, continuously short press STOP button 5 times or press and hold STOP button for 3S (5 beeps), the motor jogs once, the new lower limit position is programmed successfully.

* After the new limit position are adjusted successfully, the original preferred position will be automatically deleted. If there is no button operation within 2 minutes, the motor will jog to prompt, and automatically exit the adjustment mode. To reset the limit position, you must first cancel limit or restore factory settings.

7 Pairing One Additional Emitter

1 Ordinary pairing method

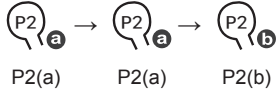

Press P2 (1 jog and 1 beep) and P2 (1 jog and 1 beep) on existing emitter, press P2 on new emitter to add (1 jog and 7 beeps), new emitter is paired to the motor.

2 Quick pairing method

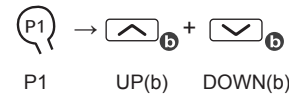

Check both upper and lower limits are set. Press P1 button for 2S (1 jog), release button and make a long noise, press UP and DOWN buttons on new emitter to add (1 jog and 7 beeps), new emitter is paired to the motor.

* (a) as existing emitter, (b) as new emitter to pair.

8 Delete Additional Emitter

1 Delete one additional emitter

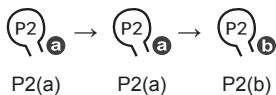

Press P2 (1 jog and 1 beep) and P2 (1 jog and 1 beep) on existing emitter, press the P2 on the emitter you want to delete (1 jog and 5 beeps), the emitter (b) is deleted.

* (a) and (b) as existing emitter, (b) as the emitter to delete.

2 Delete all additional emitters

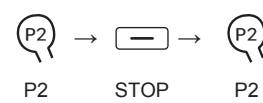

Press P2 (1 jog and 1 beep), press STOP (1 jog and 1 beep), press P2 (1 jog and 5 beeps), all emitters are deleted.

* Keep all the original settings of the motor after deleting all emitters.

9 Cancel All Limits

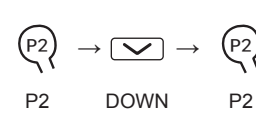

Press P2 (1 jog and 1 beep), press DOWN (1 jog and 1 beep), press P2 (1 jog and 4 beeps), the limits are canceled, and the preferred position is also deleted.

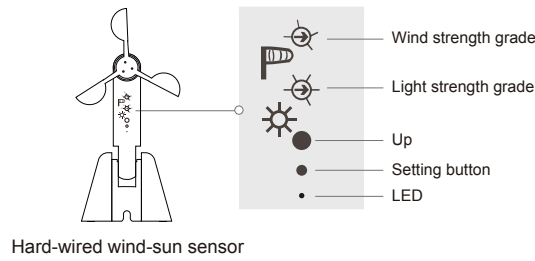
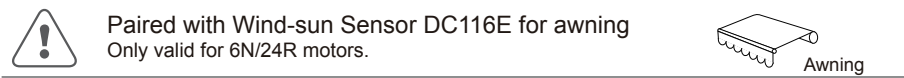

Hard-wired wind-sun sensor

10 Adding / Deleting Wind-sun Sensor

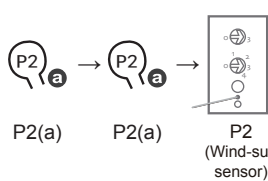

Press P2 (1 jog and 1 beep) and P2 (1 jog and 1 beep) on existing emitter, press P2 on the wind-sun sensor (1 jog and 3 beeps), wind-sun sensor is paired to the motor.

• Repeat same procedure will delete sensor.

* (a) as existing emitter, (b) as new wind-sun sensor to pair.

11 Enable / Disable Sun Detection

1 Enable sun detection

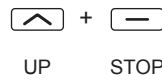

At the upper limit position, short press UP and STOP buttons simultaneously (3 jogs and 3 beeps), Sun detection is enabled.

2 Disable sun detection



At the lower limit position, short press DOWN and STOP buttons simultaneously (1 jog and make a long noise), Sun detection is disabled.

12 Failure Detection Function

If the motor doesn't receive the failure detection signal within 30 minutes, the motor will retract the awning; after retraction, the motor will be under jog mode.
If the motor receive the failure detection signal again, the motor will be under continuous running mode (Or operate "jog mode and running mode switch" function to switch)

* After the power is turned on again, within 30 minutes, if the self-check command of the wind-sun sensor is not received, it will not start to retract the awning for 30 minutes.

13 Auto Retraction Function Against Strong Wind

When the wind is stronger than the set value, the sensor will send signal to the motor to retract the awning and the motor won't work within 8 mins; If the motor receives the strong wind command again during the 8 mins, the motor will retime another 8 mins; if the motor keeps receiving the strong wind command, the motor won't work all the time.

Quick Index

	Settings	Steps
1	Pairing	P1(hold down 2s) → P2 → P2 → Up
2	Switch Rotating Direction	P2 → P2 → Down
3	Upper and Lower Limits Setting	1 Enter the limit position setting status P2 → Up → P2
		2 Set upper limit position Up / Down → Stop → Stop(press 5 times or hold down 3s)
		3 Set lower limit position Up / Down → Stop → Stop(press 5 times or hold down 3s)
4	Add / Delete Preferred Position	P2 → Stop → Stop
5	Jog Mode & Running Mode Switch	P2 → Up → Down
6	Adjust Limits	Up + Down(hold down 5s) → Up / Down → Stop(press 5 times or hold down 3s)
7	Pairing One Additional Emitter	1 Ordinary pairing method P2(a) → P2 (a) → P2(b)
		2 Quick pairing method P1(hold down 2s) → Up(b) + Down(b)
8	Delete Additional Emitter	1 Delete one additional emitter P2(a) → P2 (a) → P2(b)
		2 Delete all additional emitters P2 → Stop → P2
9	Cancel All Limits	P2 → Down → P2
10	Adding / Deleting Wind-sun Sensor	P2(a) → P2(a) → P2(Wind-sun sensor)
11	Enable / Disable Sun Detection	1 Enable sun detection Up + Stop
		2 Disable sun detection Down + Stop

Troubleshooting

Issues	Possible causes	Solution
The motor doesn't run	The motor enters the thermal protection status	Wait for the motor to cool down
	Emitter is not pairing	Perform pairing operation
	If there is no response after long pressing P1 button, the power supply is short-circuited, the circuit board is broken or the motor is broken	Contact after-sales service

Warning : This device complies with Part 15 of the FCC Rules. Operation is subject to the following two conditions:
(1) This device may not cause harmful interference, and (2) this device must accept any interference received, including interference that may cause undesired operation.

NOTE 1: This equipment has been tested and found to comply with the limits for a Class B digital device, pursuant to part 15 of the FCC Rules. These limits are designed to provide reasonable protection against harmful interference in a residential installation. This equipment generates uses and can radiate radio frequency energy and, if not installed and used in accordance with the instructions, may cause harmful interference to radio communications. However, there is no guarantee that interference will not occur in a particular installation. If this equipment does cause harmful interference to radio or television reception, which can be determined by turning the equipment off and on, the user is encouraged to try to correct the interference by one or more of the following measures:
- Reorient or relocate the receiving antenna.
- Increase the separation between the equipment and receiver.
- Connect the equipment into an outlet on a circuit different from that to which the receiver is connected.
- Consult the dealer or an experienced radio/TV technician for help.

NOTE 2: Any changes or modifications to this unit not expressly approved by the party responsible for compliance could void the user's authority to operate the equipment.