

**YÖK**

**Media Remote with  
key board XB1S**

**USER MANUAL**

## Package Content:

- Media Remote x 1
- USB Dongle x 1
- AAA battery x 2
- User Manual x 1

## Specification:

- Easily control your music, movies and more on your XBOX ONE
- Quickly input text with the integrated keyboard, and enjoy ease of use with no special buttons to push, as the remote enters keyboard control mode automatically when it's flipped over
- Find the buttons for which you're looking in low-light conditions with the backlighting
- Enjoy comfortable wireless use from up to 10 metres away with the USB dongle that plugs right into your Xbox One console
- Powered by x2 AAA batteries

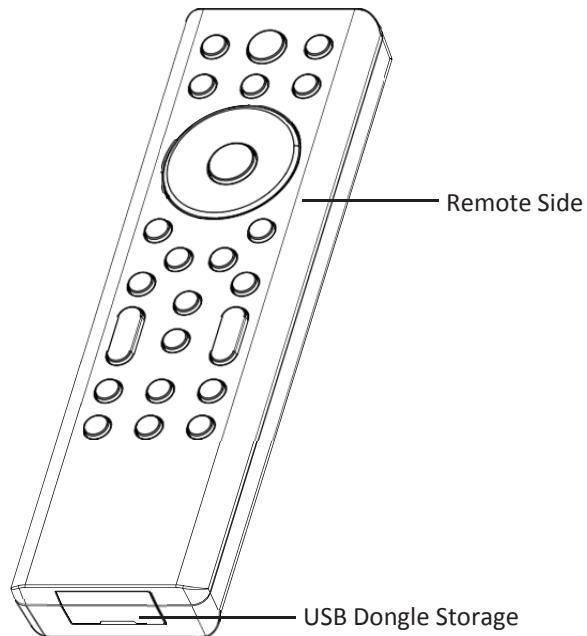

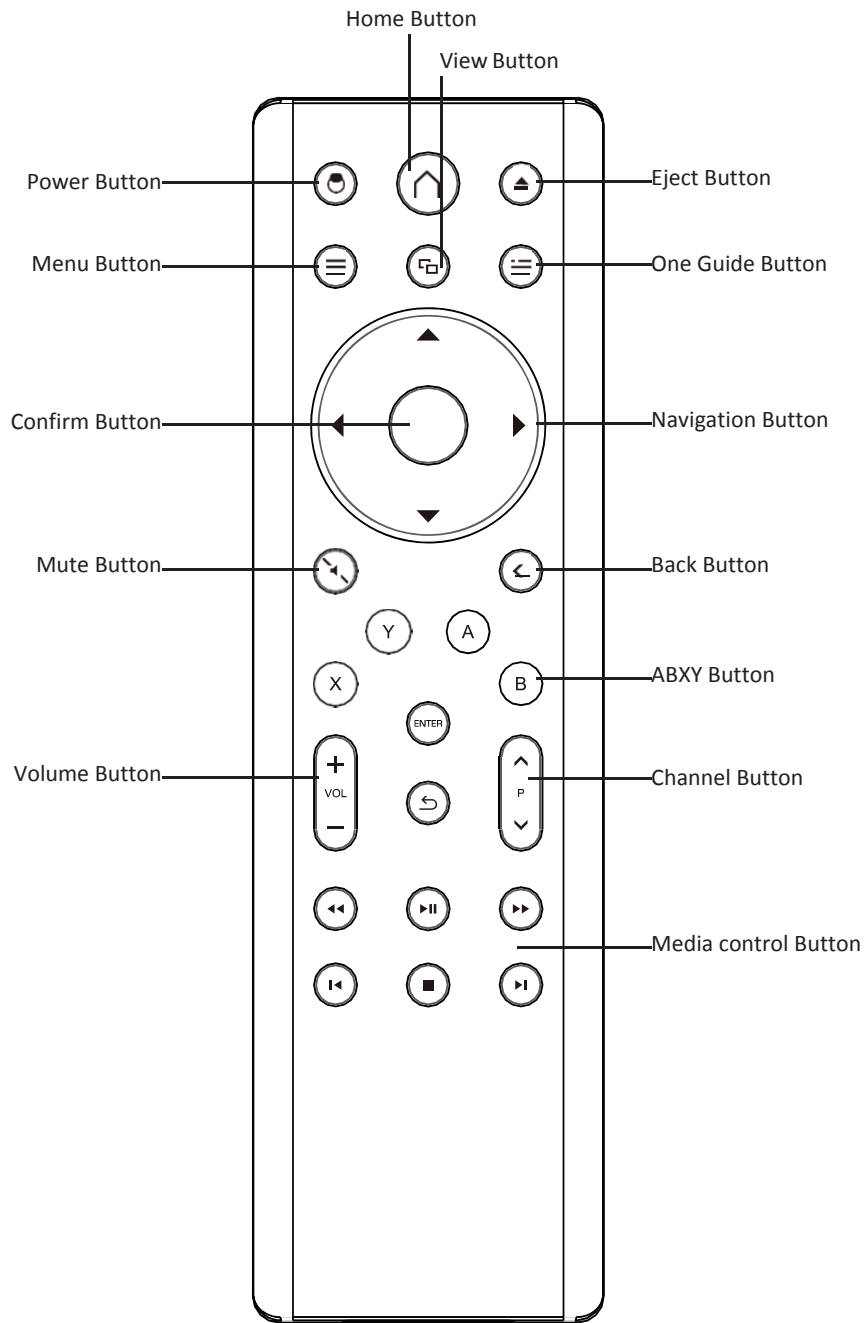

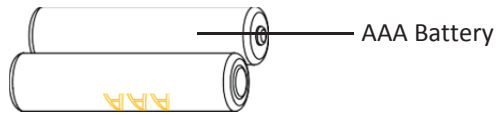
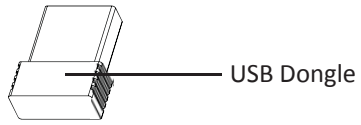
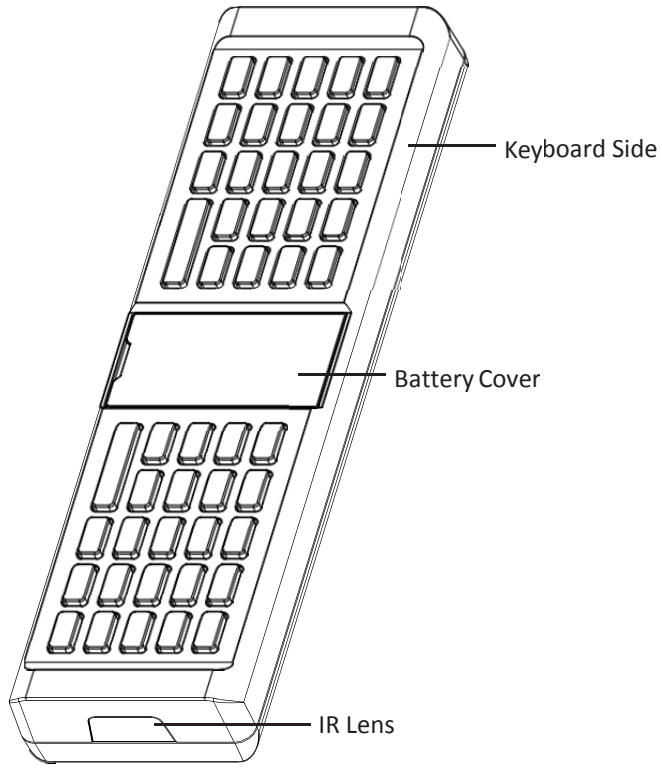

## Operation Instruction:

1. Open the Battery cover at the Keyboard side.
2. Follow the battery mark to install two AAA battery.

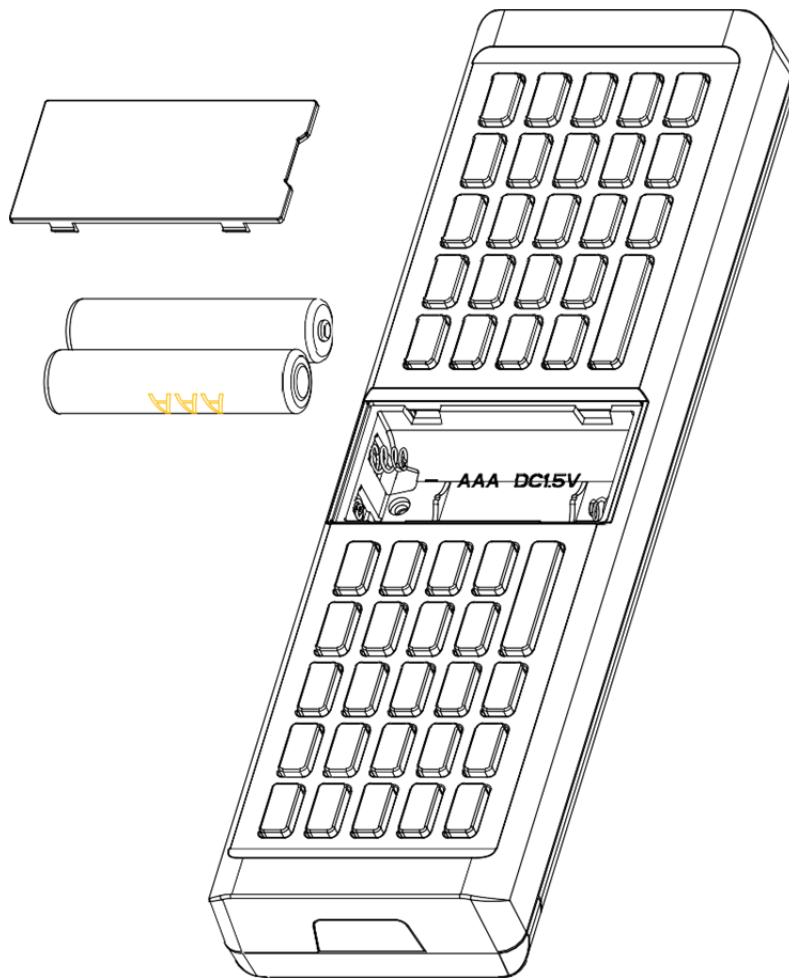

## Keyboard Instruction:

1. Open the USB dongle storage cover, take out the USB dongle.

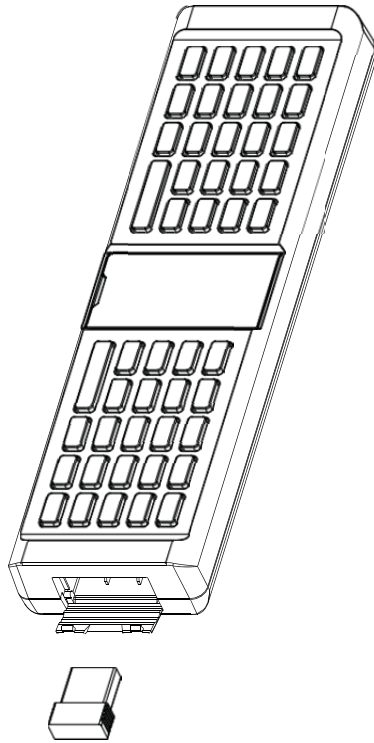

2. Connect the USB dongle to the USB port of Xbox One console.
3. Keeping press “Shift” and “Space” button at the same time, the keyboard backlight will start quick flash to try to connect the USB dongle. The backlight will turn off when success connect to the console.
4. Start type.

## Media Remote Instruction:

1. Turn the media remote to the remote side. Make the IR lens point to the Xbox One console.
2. Press button to start media control.

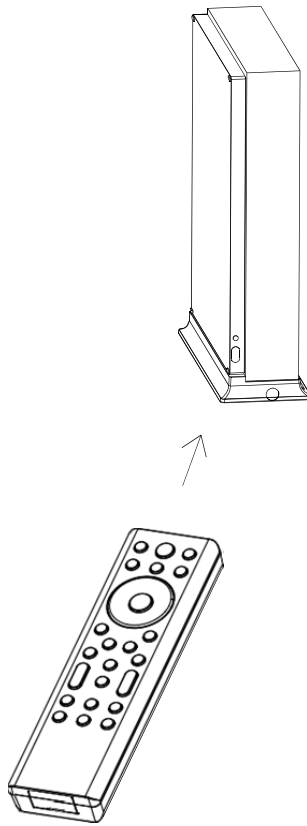

## Power Save Mode:

1. The keyboard will turn to sleep mode if no button been pressed in 5 mins.
2. Press any button to wake up the keyboard.

## Light Indication:

1. When using the keyboard, backlight will light up for 10s when move of press any button.
2. Backlight flash every 2s indicate the battery is low.
3. Backlight flash every 1s indicate the keyboard is trying connect to the USB dongle.
4. Backlight quick flash indicate the keyboard is in pairing mode.

## PRECAUTION AND MAINTENANCE

1. Please make sure there is no extreme pressure put on this product.
2. Don't dismantle this product without permission.
3. This product should be situated away from heat sources such as radiators and heaters.
4. Keep this product dry and avoid any contact with damp or wet areas.



Xbox One™ is registered trademark or trademarks of Microsoft Inc. All Rights reserved; All other trademarks are property of their respective owners. Photos and illustrations not binding. Contents, designs and specifications are subject to change without notice and may vary from one country to another. This product is not distributed under official license from or approved, sponsored or endorsed by Microsoft Inc. This product is not manufactured for Microsoft Inc.



## **FCC Caution.**

This device complies with part 15 of the FCC Rules. Operation is subject to the following two conditions: (1) This device may not cause harmful interference, and (2) this device must accept any interference received, including interference that may cause undesired operation.

Any Changes or modifications not expressly approved by the party responsible for compliance could void the user's authority to operate the equipment.

**Note:** This equipment has been tested and found to comply with the limits for a Class B digital device, pursuant to part 15 of the FCC Rules. These limits are designed to provide reasonable protection against harmful interference in a residential installation. This equipment generates uses and can radiate radio frequency energy and, if not installed and used in accordance with the instructions, may cause harmful interference to radio communications. However, there is no guarantee that interference will not occur in a particular installation. If this equipment does cause harmful interference to radio or television reception, which can be determined by turning the equipment off and on, the user is encouraged to try to correct the interference by one or more of the following measures:

- Reorient or relocate the receiving antenna.
- Increase the separation between the equipment and receiver.
- Connect the equipment into an outlet on a circuit different from that to which the receiver is connected.
- Consult the dealer or an experienced radio/TV technician for help.

The device has been evaluated to meet general RF exposure requirement. The device can be used in portable exposure condition without restriction.