

User Manual

Item No.: X05-1 Bluetooth Speaker

1. What's in the box

X05-1 Bluetooth speaker, USB charging cable, Line in cable, user manual

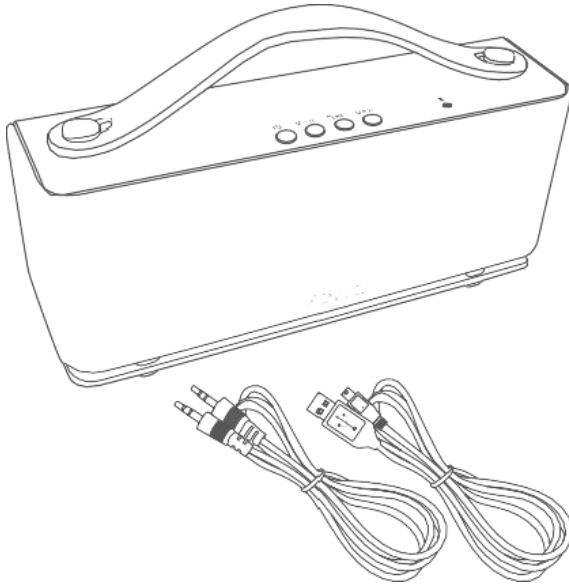

2. Charging the speaker

To charge your speaker connect the USB charging cable to the micro USB port on the speaker and connect the other end to power. Whilst charging the LED indicator will turn red. When fully charged the red LED indicator will turn off. The speaker will take 3 hours to fully charge.

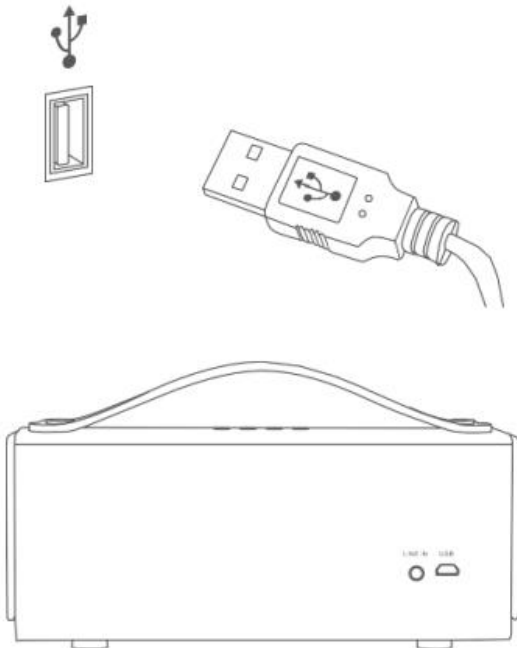

3. Low battery indicator

When the charge on the speaker becomes low, the red LED will flash twice every four seconds and the speaker will beep.

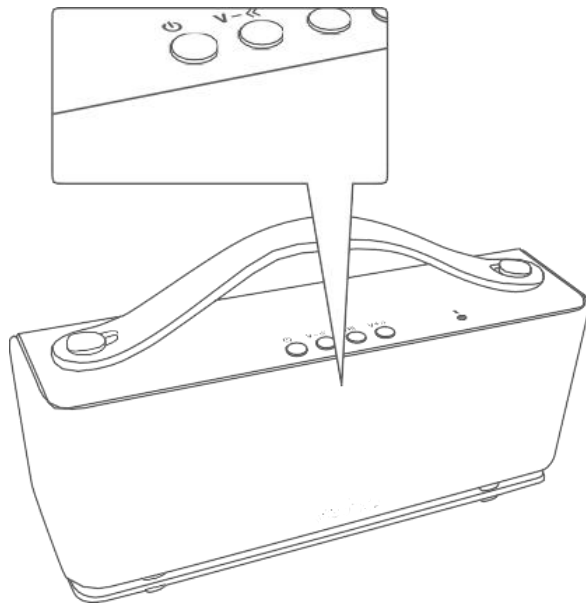

4. Turning the speaker on/off

To turn the speaker on, press the power button once. The speaker will beep and the blue and red LEDs will flash.

To turn the speaker off, press the power button once. The speaker will beep and the blue LED will turn on and then turn off.

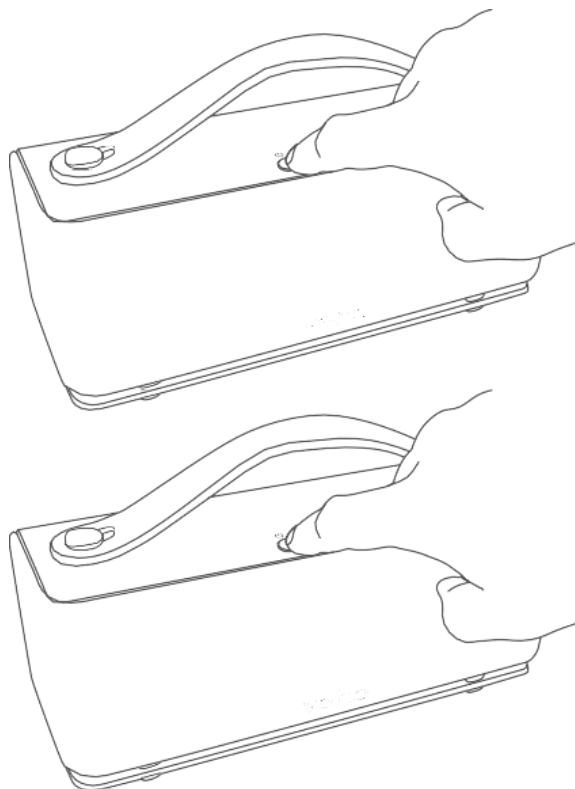

5. Play via Bluetooth

Turn the speaker on. Locate the speaker in your device's Bluetooth settings and connect. If the Bluetooth device asks for a connection code use 0000 or 1234. Once connected the speaker will beep and blue LED will flash.

If you already have a Bluetooth connection, the speaker will automatically search for it and connect when you turn the speaker on.

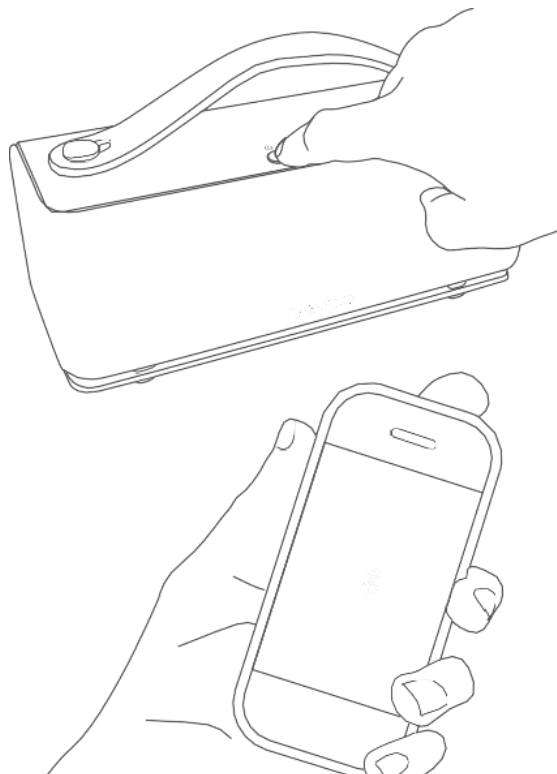

6. Play via line in cable

Turn the speaker on. Connect the line in cable to the speaker and to audio source. Please note only the volume controls work when connected via line in, you cannot skip or pause tracks.

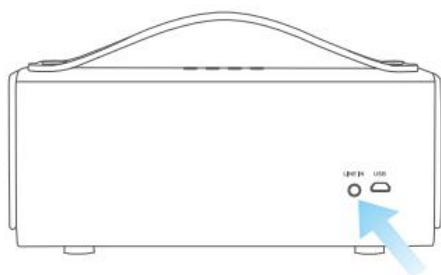

7. Guide to the controls

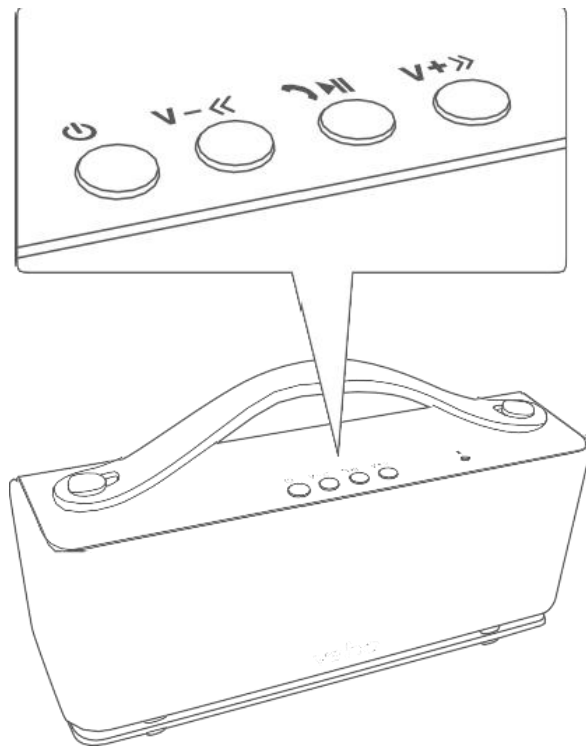

V-◀◀ Press once to skip to the previous track

Press and hold to reduce the volume

V+▶▶ Press once to skip to the next track

Press and hold to increase the volume

▶|| Press once to play

Press once to pause

8. Answering a phone call

To answer a phone call press the **▶||** button. The music will automatically pause. Press the **▶||** button again to end the phone call. The music will automatically restart.

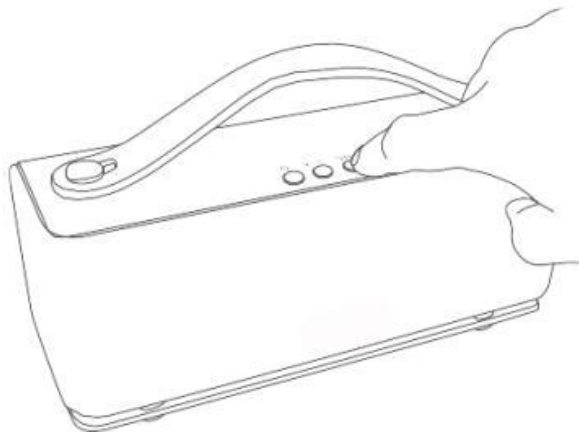

FCC Warning

This device complies with part 15 of the FCC Rules. Operation is subject to the following two conditions:

(1) This device may not cause harmful interference, and (2) this device must accept any interference received, including interference that may cause undesired operation.

Any Changes or modifications not expressly approved by the party responsible for compliance could void the user's authority to operate the equipment.

Note: This equipment has been tested and found to comply with the limits for a Class B digital device, pursuant to part 15 of the FCC Rules. These limits are designed to provide reasonable protection against harmful interference in a residential installation. This equipment generates uses and can radiate radio frequency energy and, if not installed and used in accordance with the instructions, may cause harmful interference to radio communications. However, there is no guarantee that interference will not occur in a particular installation. If this equipment does cause harmful interference to radio or television reception, which can be determined by turning the equipment off and on, the user is encouraged to try to correct the interference by one or more of the following measures:

- ▶ -Reorient or relocate the receiving antenna.
- ▶ -Increase the separation between the equipment and receiver.
- ▶ -Connect the equipment into an outlet on a circuit different from that to which the receiver is connected.
- ▶ -Consult the dealer or an experienced radio/TV technician for help.

The device has been evaluated to meet general RF exposure requirement. The device can be used in portable exposure condition without restriction.