

Product Outline

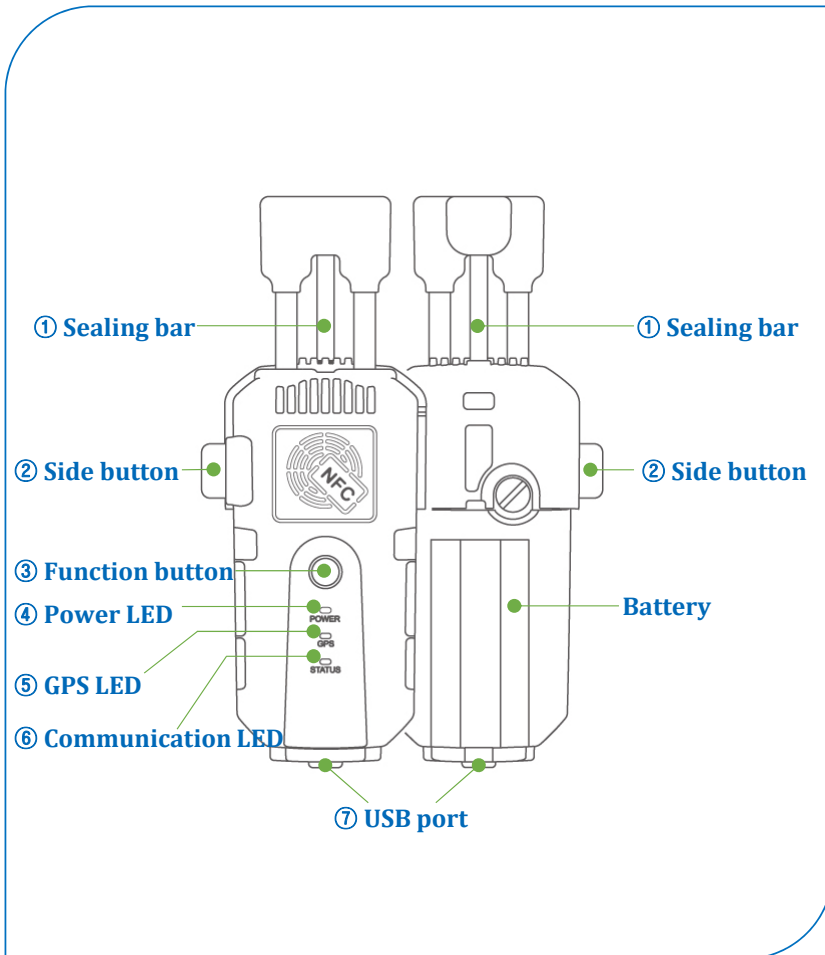

- ① Sealing bar that put into the hole(joint part) of the container door
- ② Button to be pressed before raising ①
- ③ Button to be pressed before pressing ② (or to check battery status)
- ④ Red light is temporarily on when device is communicating (⑤~⑥)
- ⑤ Blue light is blinking → Device is receiving GPS signal
- ⑥ Yellow light is blinking → Device is receiving WCDMA/GSM signal
- ⑦ USB port to be connected with cable for the batter charging

USIM Activation

- 👉 Please contact us to activate USIM for the sample device.
- 👉 We recommend not to turn the device on before USIM is activated.
- 👉 We are going to notice you when USIM is activated.

1. Battery Check

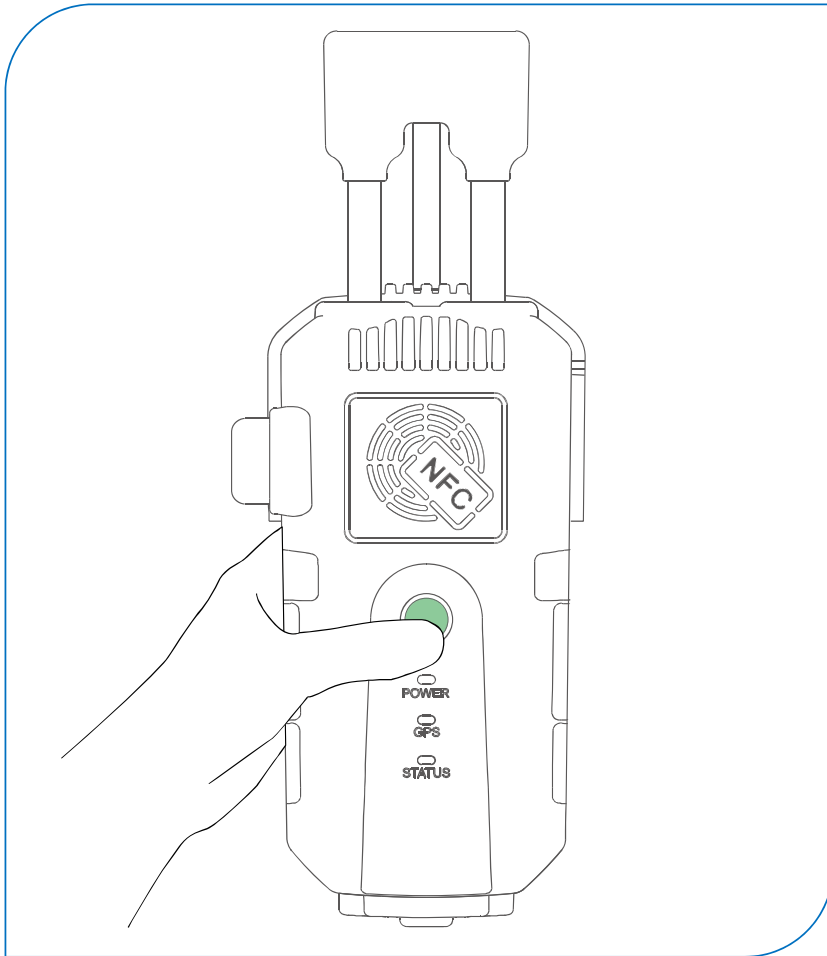

 **Perfect**

 **Good**

 **Need to Charge**

 **Almost Dead**

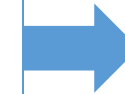

Let's go to next page

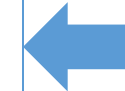

Let me get charged

CAUTION

☞ Device could be operated when the battery status is **Green** or **Blue**.

☞ Please charge the device when the battery status is **Yellow** or **Red**.

2. Device Registration

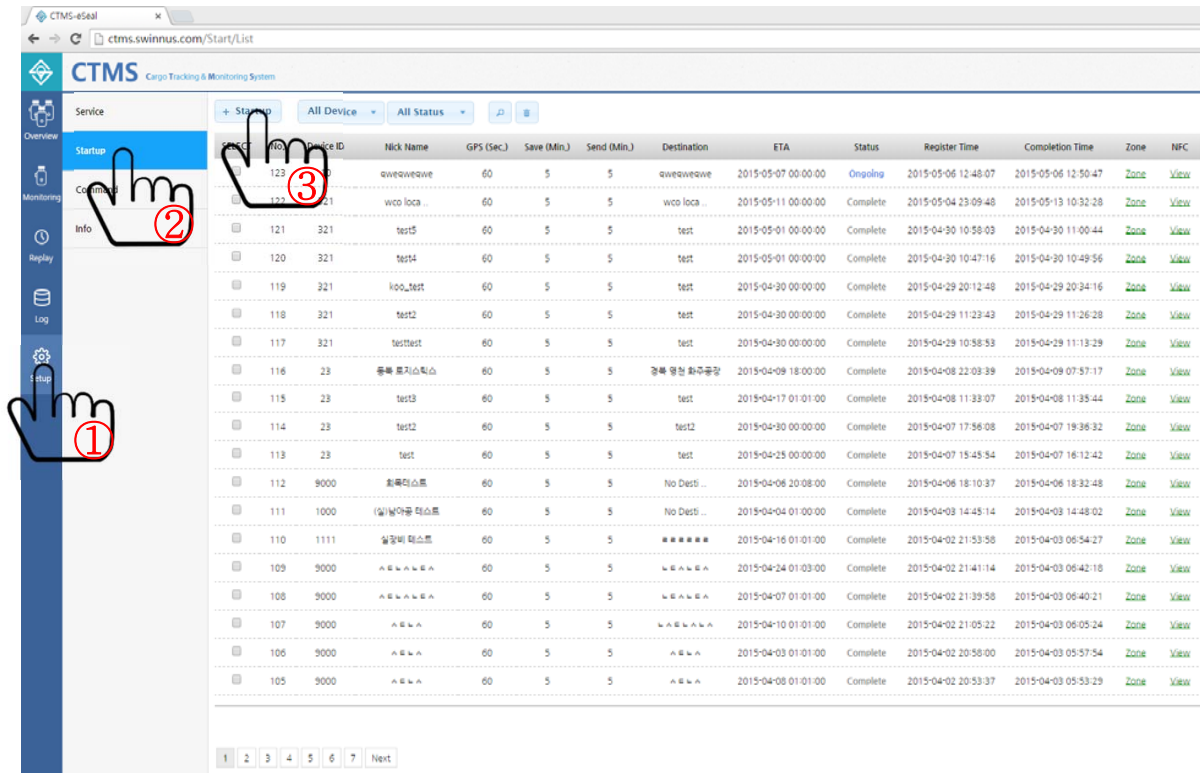

CTMS Cargo Tracking & Monitoring System

Service

Startup

All Device All Status

Device ID	Nick Name	GPS (Sec.)	Save (Min.)	Send (Min.)	Destination	ETA	Status	Register Time	Completion Time	Zone	NFC
123	qweeeweave	60	5	5	qweeeweave	2015-05-07 00:00:00	Ongoing	2015-05-06 12:48:07	2015-05-06 12:50:47	Zone	View
121	wco loca...	60	5	5	wco loca...	2015-05-11 00:00:00	Complete	2015-05-04 23:09:48	2015-05-13 10:32:28	Zone	View
121	test5	60	5	5	test	2015-05-01 00:00:00	Complete	2015-04-30 10:58:03	2015-04-30 11:00:44	Zone	View
120	test4	60	5	5	test	2015-05-01 00:00:00	Complete	2015-04-30 10:47:16	2015-04-30 10:49:56	Zone	View
119	koo_test	60	5	5	test	2015-04-30 00:00:00	Complete	2015-04-29 20:12:48	2015-04-29 20:34:16	Zone	View
118	test2	60	5	5	test	2015-04-30 00:00:00	Complete	2015-04-29 11:23:43	2015-04-29 11:26:28	Zone	View
117	testtest	60	5	5	test	2015-04-30 00:00:00	Complete	2015-04-29 10:58:53	2015-04-29 11:13:29	Zone	View
116	동북 동지스마트	60	5	5	경북 영천 화주중앙	2015-04-08 18:00:00	Complete	2015-04-08 22:03:39	2015-04-09 07:57:17	Zone	View
115	test3	60	5	5	test	2015-04-17 01:01:00	Complete	2015-04-08 11:33:07	2015-04-08 11:35:44	Zone	View
114	test2	60	5	5	test2	2015-04-30 00:00:00	Complete	2015-04-07 17:56:08	2015-04-07 19:36:32	Zone	View
113	test	60	5	5	test	2015-04-25 00:00:00	Complete	2015-04-07 15:45:54	2015-04-07 16:12:42	Zone	View
112	동북 동지스마트	60	5	5	No Dest...	2015-04-06 20:08:00	Complete	2015-04-06 18:10:37	2015-04-06 18:32:48	Zone	View
111	(일)남아동 테스트	60	5	5	No Dest...	2015-04-04 01:00:00	Complete	2015-04-03 14:45:14	2015-04-03 14:48:02	Zone	View
110	실경비 테스트	60	5	5	*****	2015-04-16 01:01:00	Complete	2015-04-02 21:53:58	2015-04-03 06:54:27	Zone	View
109	ABALALA	60	5	5	ABALALA	2015-04-24 01:03:00	Complete	2015-04-02 21:41:14	2015-04-03 06:42:18	Zone	View
108	ABALALA	60	5	5	ABALALA	2015-04-07 01:01:00	Complete	2015-04-02 21:39:58	2015-04-03 06:40:21	Zone	View
107	ABALALA	60	5	5	ABALALA	2015-04-10 01:01:00	Complete	2015-04-02 21:05:22	2015-04-03 06:05:24	Zone	View
106	ABALALA	60	5	5	ABALALA	2015-04-03 01:01:00	Complete	2015-04-02 20:58:00	2015-04-03 05:57:54	Zone	View
105	ABALALA	60	5	5	ABALALA	2015-04-08 01:01:00	Complete	2015-04-02 20:53:37	2015-04-03 05:53:29	Zone	View

1 2 3 4 5 6 7 Next

Startup ④

Device ID
1000 **Select device to use**

Nick Name
Test **Input device name**

GPS (Sec.) Save (Min.) Send (Min.)
60 5 5 **Select cycle time**

Destination
Airport **Input destination**

Estimated Time of Arrival (ETA)
2015-06-24 17 Hour 05 Min. **Select ETA**

NFC
☐ 테스트
☐ 오재성
☐ 이진욱
☒ Authorized NFC 01
☐ Authorized NFC 02 **Select person authorized**

REGISTER ⑤

CAUTION

- Device registration(set-up of startup information) should be added before turning on the device.
- Please refer to application manual for details.

3. Turn On

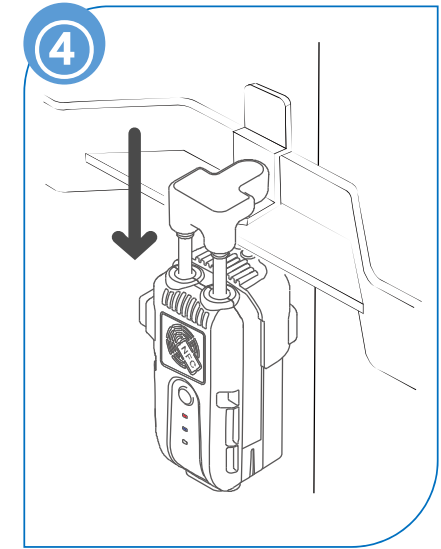
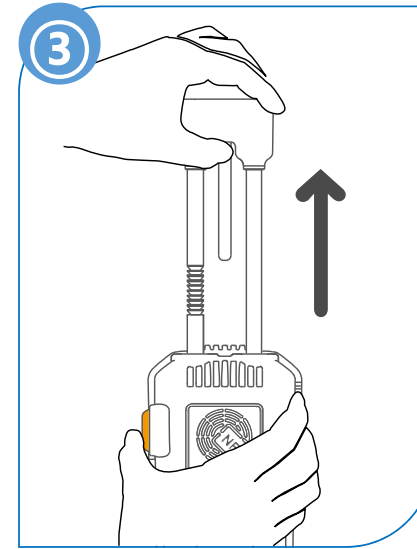
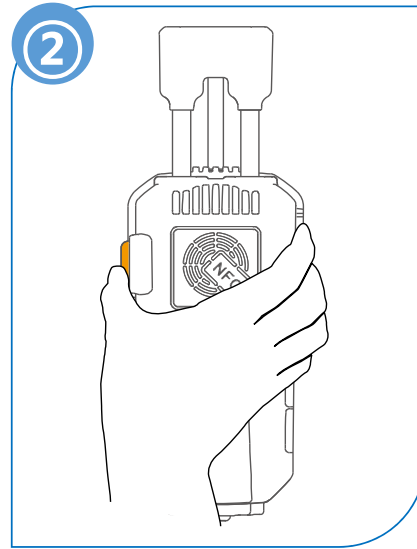
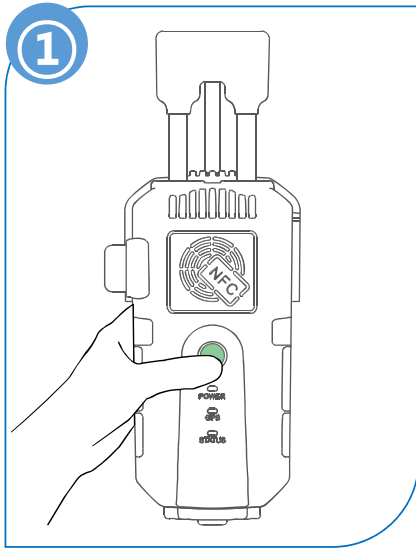

- ① Press the “Function Button”.
- ② Press the “Side Button” before the light of function button is off.
- ③ Keep pressing “Side Button” and Raise the “Sealing Bar”.
- ④ Put the “Sealing Bar” into the hole(joint part) of the container door and Press it all the way to the down.

4. Turn Off

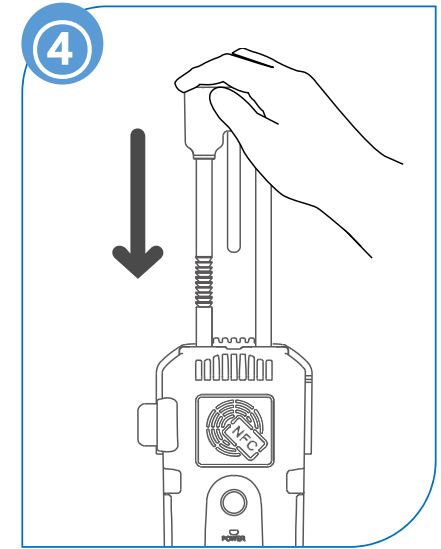
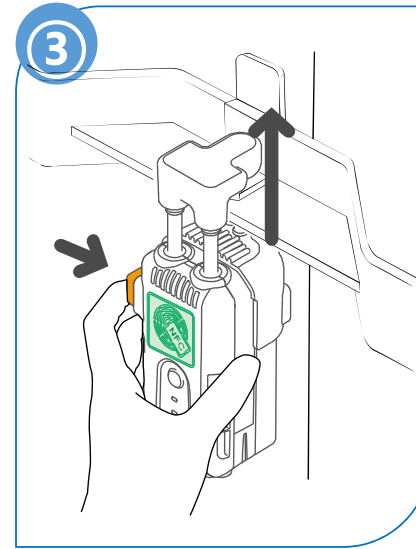
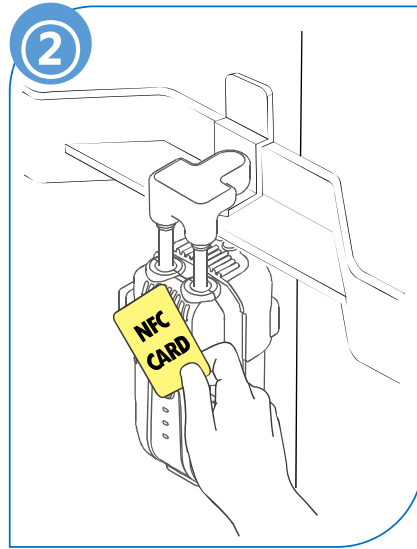
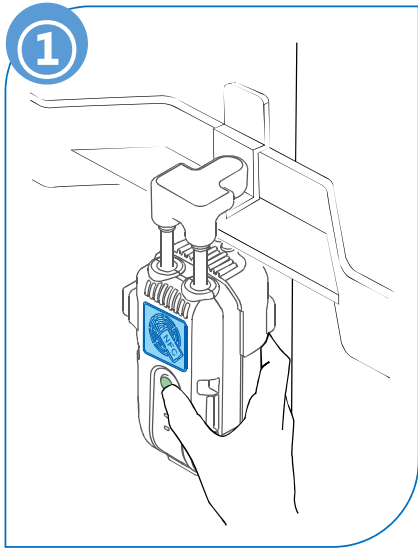

- ① Press the “Function Button”, then “NFC Reader” part would be activated with the blue light.
- ② Touch the “Authorized NFC card” to the NFC reader while the light lasts.
- ③ Pressing “Side Button” and Raise the “Sealing Bar” **within 5 seconds after applying NFC card.**
- ④ Put the “Sealing Bar” into the hole(joint part) of the container door and Press it **all the way to the down.**



Operational Tips

1. When the eSeal is attached to another container by mistake

- Please press function button 5 times in a row within 20 seconds after the mounting.
- Then the device will be turned off.
- And user can attach device to the right container without set-up of startup information.
- If user opens the device through the NFC card, the startup information should be registered for the reusing.

2. In regard to the NFC card

- When user have lost NFC card, please open the device via central unlocking function on the Web/Mobile.
- Device keep being operated if user does not raising the sealing bar after applying NFC card on the device.



Operational Tips

3. In regard to the communication

- Device may need time to connect to local communications network for the first time. (First Connection)
- As telecommunication spectrum band of WCDMA/GSM in each country is different, the first connection test is essential before the first operation in the field.

4. In regard to the battery

- When user charges the battery, device must be turned off for the rapid full charge.
- If the battery has been dead while the container is transporting, please connect the device with the electronic device (cellphone, tablet PC etc.) via USB cable for one minute.
- If user get the low battery alarm, please change communication frequency on the web/mobile.

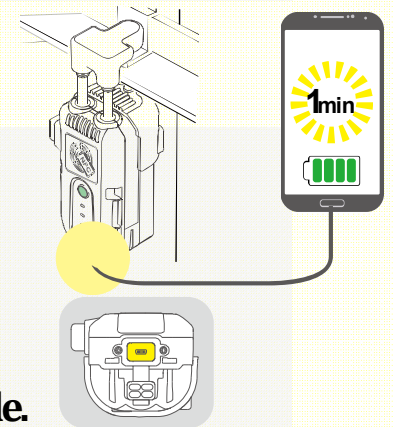

WARNING & SAFETY INFORMATION

Safety Symbols



Warning

- When encountering this symbol in the manual, you must follow these recommendations to avoid irreparable damage to your car, system or connected devices or to avoid accidents with injuries or death.

IC Information

This device complies with Industry Canada licence-exempt RSS standard(s). Operation is subject to the following two conditions:

- (1) this device may not cause interference, and
- (2) this device must accept any interference, including interference

Le présent appareil est conforme aux CNR d'Industrie Canada applicables aux appareils radio exempts de licence.

L'exploitation est autorisée aux deux conditions suivantes :

- (1) l'appareil ne doit pas produire de brouillage, et
- (2) l'utilisateur de l'appareil doit accepter tout brouillage radioélectrique subi, même si le brouillage est susceptible d'en compromettre le fonctionnement.

The antenna(s) used for this device must be installed to provide a separation distance of at least 20 cm from all persons and must not be co-located or operating in conjunction with any other antenna or transmitter.

Cet équipement doit être installé et utilisé avec un minimum de 20 cm de distance entre la source de rayonnement et votre corps.

FCC Information

This device complies with part 15 of the FCC Rules. Operation is subject to the following two conditions:

1. This device may not cause harmful interference, and
2. This device must accept any interference received, including interference that may cause undesired operation.

FCC notification to users

This equipment has been tested and found to comply with the limits for a CLASS B digital device, pursuant to Part 15 of the FCC Rules. These limits are designed to provide reasonable protection against harmful interference when the equipment is operated in a commercial environment. This equipment generates, uses, and can radiate radio frequency energy and, if not installed and used in accordance with the instructions, may cause harmful interference to radio communications. However, there is no guarantee that interference will not occur in a particular installation. If this equipment does cause harmful interference, the user is encouraged to try to correct the interference by consulting with a dealer or an experienced technician for technical assistance.

Any changes or modifications to the equipment not expressly approved by the party responsible for compliance could void user's authority to operate the equipment.