

## Before installation

### 1. Safety instruction

**WARNING!** This is an electrical shock hazard. Incorrect installation could be dangerous or illegal. Multiple breakers may need to be de-energized for safe installation. Please call a professional electrician if you are unfamiliar or uncomfortable with electrical work.



### 2. Check Compatibility

Koogeek Smart Switch replaces single pole switch only. Not compatible with 3-way(multi location control) switches.

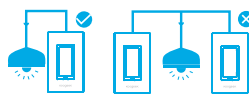

### 3. Wi-Fi signal strength

Hold your iPhone / iPad / iPod touch close to the Smart Switch which you just installed. Make sure you have at least 2 bars of Wi-Fi signal there.



### 4. Wi-Fi signal type

Make sure your router is configured to 2.4G, and your iPhone / iPad / iPod touch is connected to this 2.4G network. Your router must be connected to the Internet, or you might fail to use the timer function.

► 1

## Installation Guide

1. Turn off the power  
Shut off power at circuit breaker for the switch you are replacing. Don't forget to flip your light switch a few times to ensure the power is off.
2. Remove the old switch  
Disconnect the wires and remove your old switch. You can take a picture for later reference.

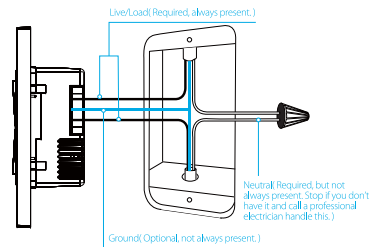

► 2

3. Install the Koogeek Smart Switch  
Notice: Koogeek Smart Switch DOES NOT have the ground wire.

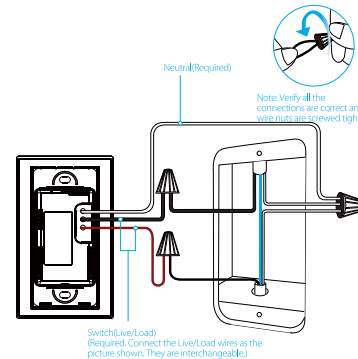

4. Screw in the Koogeek Switch and attach the faceplate.
5. Turn on the power.

► 3

User manual

Model:KH02

## Koogeek Home app configuration guide

1. Before you configure Koogeek Home app, please make sure the LED light flashes in green slowly. Otherwise, please reset the device.
2. Download and open the free Koogeek Home app from the App Store. (Make sure the system of your iPhone / iPad / iPod touch is iOS 8.1 or later.)
3. Sign up for or log in with a Koogeek account. (You can also tap "Skip" to enter the app directly.)
4. Create your "Home" and "Room" and enter a home and room name.  
Note: If you have used this kind of app before, please ignore this step.
5. Tap "Add Accessory" and follow the on-screen directions to complete network setup.  
Note: To add more switches (or repeat the switch setup process), please tap "Add Accessory" again on the "Accessories" screen.
6. When prompted, please scan the Setup Code or enter the Setup Code manually, and follow on-screen steps to add the device to the "Room" which you edited before.



7. You can name your device and use this name when speaking to Siri. For example, you can name your device "Switch", then launch Siri and speak "Turn on the Switch". Then the device will be turned on.
8. Set up customized Scenes to control multiple devices with a single command. For example, if you assign the "Good Morning" command to the Scene of turning off night light and turning on washroom light, when you speak "Good Morning" to Siri, everything will be done!
9. Please visit [www.koogeek.com](http://www.koogeek.com) for more troubleshooting.

► 4

## Switch Overview

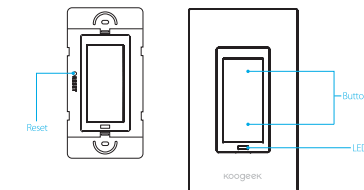

### Button

Press once to manually control the switch (Turning switch "On" or "Off").

### Reset

Press and hold the RESET button with a small thing for about 10 seconds. When the green LED light flashes slowly, it indicates that you have restored the device to factory settings.

Power / Wi-Fi Status Indicator (after setting up)

Green LED flashes slowly: Smart Switch is waiting for a Wi-Fi network configuration.

Green LED flashes quickly: Smart Switch is disconnected from a Wi-Fi network.

Green LED stays lit: Smart Switch is "On".

Green LED is off: Smart Switch is "Off".

► 5

## Electrical Ratings

Input: 90-250VAC  
50/60Hz

Output: 25W

For Indoor Dry Location Use Only

## Safety Warnings

- DO NOT use as 3-way(multi location control) switches
- Turn off power before inspection, installation and removal
- For indoor use only
- Keep children away from Smart Switch before installation
- DO NOT clean with liquid
- DO NOT use in wet or damp areas
- DO NOT exceed the recommended electrical ratings
- DO NOT use in precision timing applications where inaccurate timing could be dangerous (sunlamps, saunas, etc.)
- DO NOT use with devices that should not be operated unattended

► 6

Use of the HomeKit logo means that an electronic accessory has been designed to connect specifically to iPod, iPhone, or iPad, respectively, and has been certified by the developer to meet Apple performance standards. Apple is not responsible for the operation of this device or its compliance with safety and regulatory standards. Please note that the use of this accessory with iPod, iPhone, or iPad may affect wireless performance.

Controlling HomeKit-enabled accessories away from Home requires an Apple TV (3rd generation or later) with Apple TV software 7.0 or later and an iPhone, iPad or iPod touch with iOS 8.1 or later.

## **FCC Caution**

This device complies with part 15 of the FCC Rules. Operation is subject to the following two conditions: (1) This device may not cause harmful interference, and (2) this device must accept any interference received, including interference that may cause undesired operation.

Any Changes or modifications not expressly approved by the party responsible for compliance could void the user's authority to operate the equipment.

Note: This equipment has been tested and found to comply with the limits for a Class B digital device, pursuant to part 15 of the FCC Rules. These limits are designed to provide reasonable protection against harmful interference in a residential installation. This equipment generates uses and can radiate radio frequency energy and, if not installed and used in accordance with the instructions, may cause harmful interference to radio communications. However, there is no guarantee that interference will not occur in a particular installation. If this equipment does cause harmful interference to radio or television reception, which can be determined by turning the equipment off and on, the user is encouraged to try to correct the interference by one or more of the following measures:

- Reorient or relocate the receiving antenna.
- Increase the separation between the equipment and receiver.
- Connect the equipment into an outlet on a circuit different from that to which the receiver is connected.
- Consult the dealer or an experienced radio/TV technician for help.

This equipment complies with FCC radiation exposure limits set forth for an uncontrolled environment. This equipment should be installed and operated with minimum distance 20cm between the radiator & your body.