

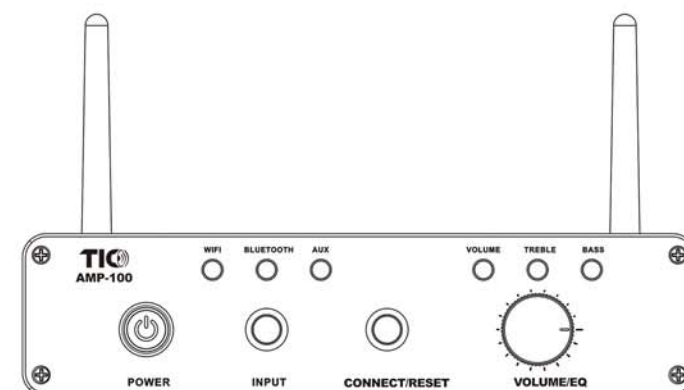

Outdoor Wifi & Bluetooth  
4 x 50W Receiver-Amplifier

AMP100  
Instruction Manual



## Table of Content

Front Panel .....	3
Rear Panel .....	4
Wiring Diagram .....	5
Operation .....	6
WifiStream Operation .....	7
Main Screen .....	8
Device List Screen .....	9
Troubleshooting .....	10
Specifications .....	11
Warnings & Notes .....	12

## Front Panel

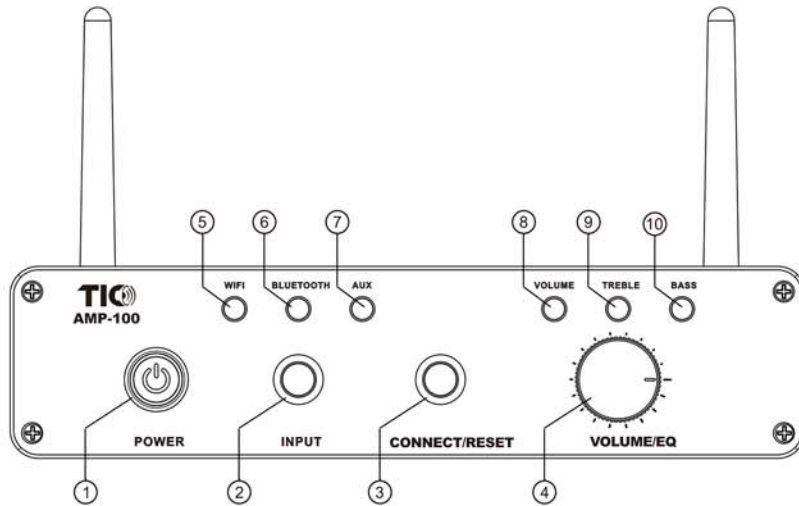

- ① power button
- ② input button
- ③ wifi/bluetooth reset/connect button
- ④ volume/EQ dial
- ⑤ wifi mode indicator
- ⑥ bluetooth mode indicator
- ⑦ AUX mode indicator
- ⑧ volume indicator
- ⑨ treble EQ indicator
- ⑩ bass EQ indicator

## Rear Panel

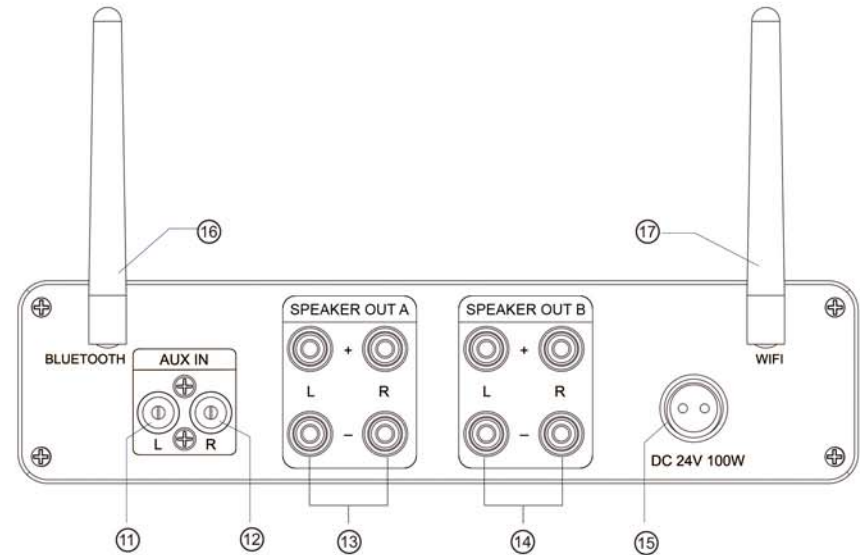

- ① left AUX input (white RCA)
- ② right AUX input (red RCA)
- ③ Speaker zone A output terminals
- ④ Speaker zone B output terminals
- ⑤ power adapter connection
- ⑥ bluetooth antenna
- ⑦ wifi antenna

## Wiring Diagram

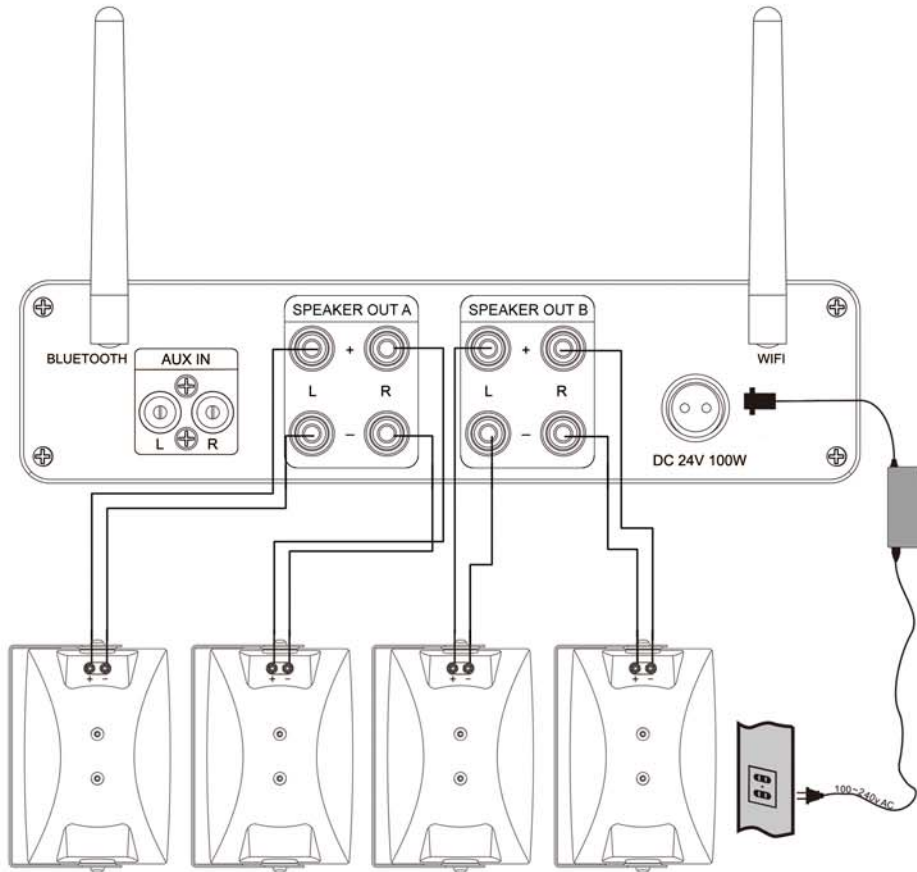

**NOTE:**

1. Please ensure that wire polarity (+ & -) matches between amplifier and speakers.
2. AMP-100 does not support bridged output.

## Operation

### Input Modes

AMP-100 has 3 different mode: Wifi, Bluetooth, and AUX line in. Clicking on the input button will toggle among the 3 modes, as indicated by the LED above the button. When a mode is not in use, the connection is shut off and has to be reconnected when selected again. Both Wifi and Bluetooth connection will reconnect automatically when within range.

### Power Supply

The power supply provided is rated for outdoor use. However, please ensure that the electrical outlet where the power adapter is plugged into is covered during use in wet weather. Please unplug the adapter from the outlet when not in use or there is a possibility for rain or snow. In addition, the transformer should not be left in a location where it can be submerged in water.

### Antenna

The two provided antennas should be installed before first use. There is no difference between the two antennas. Each antenna can be screwed into either Wifi or Bluetooth slot.

### Volume/EQ adjustment

The dial adjusts the volume, treble, and bass level of the output. Pressing the dial will switch among adjusting volume, treble, and bass, as indicated by the LED above the dial. Turning it clockwise/counter-clockwise will increase/decrease the level respectively. The LED will blink once at the minimum level, twice in the middle, and three times at the maximum level.

### Bluetooth connection

First select Bluetooth as input. While the LED is flashing, go to the your device's Bluetooth setting menu and look for "TIC AMP-100 Amplifier". Once the device is connected, the LED will remain solid. You can hold the reset button for 2 seconds to disconnect any connected device. The LED will start blinking again. You can initiate a full reset and delete all stored BT devices by holding the reset button for over 5 seconds.



## WifiStream Operation

### Wifi Setup

In order to use this amplifier, you must download the TIC WifiStream app on the Apple App Store or Google Play. Search for "TIC WifiStream" in the respective store. Alternatively, follow this QR code (or go to [www.ticcorp.com/wifistream](http://www.ticcorp.com/wifistream)) for download links and additional help for installation and operation.



The TIC WifiStream app contains step-by-step instruction on how to connect your amplifier to your Wifi network. The supplemental instruction below is provided for your convenience.

In order to connect the amplifier to your wifi network, your smartphone or tablet device must be connected to the same network. This amplifier is only compatible with 2.4G band, not 5.8G band. Please ensure you are using the 2.4G signal for any multi-band router.

During the initial set up, we recommend that you move the amplifier close to the router. While not required, it will provide the fastest and most seamless set up. However, it is required that the amplifier is close to the phone/tablet you are using during the setup.

Please note it will take 10-20 seconds to boot up the Wifi system. You will hear a musical phrase once the amplifier is ready to connect and operate. In order to minimize wireless interference and maximize energy efficiency, the Wifi signal is shut off when in Bluetooth or AUX mode. The Wifi system has to boot up each time the mode is selected. The amplifier is not optimized for constant switching among different input modes but for maximum performance and efficiency.

### App Overview

The TIC WifiStream app is required to set up the amplifier and maintain AirPlay capability. Music can be streamed to any WifiStream device via the app or AirPlay. The app must be installed on each device that uses the amplifier via AirPlay.

Streaming via AirPlay provides the most seamless experience and the widest range of compatibility. On Apple devices, you can directly choose the amplifier as the output device in most native media apps/services (ie. Pandora, Apple Music, Amazon Music, Spotify, YouTube, Tuneln Radio etc.) under the AirPlay icon.

Android devices may take advantage of AirPlay capability via third-party apps/services. Additional cost may be applied and service is not guaranteed.



## Main Screen

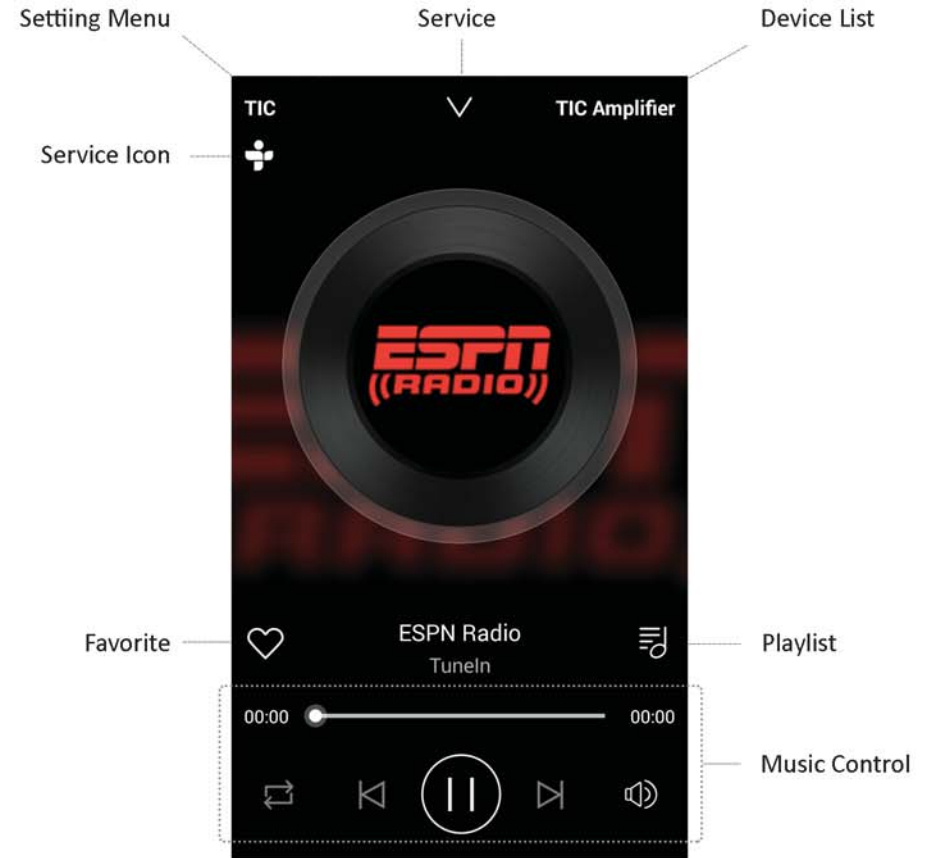

- Setting Menu – access music services, favorite, and playlists
- Service – access service-specific menu & control
- Device List – multi-room and device control
- Service Icon – icon to denote current service (non-clickable)
- Favorite – add/delete favorite (local or service-specific if applicable)
- Playlist – view playlist (local or service-specific if applicable)
- Music Control – repeat, back, play/pause, forward/scan, volume control



## Device List Screen

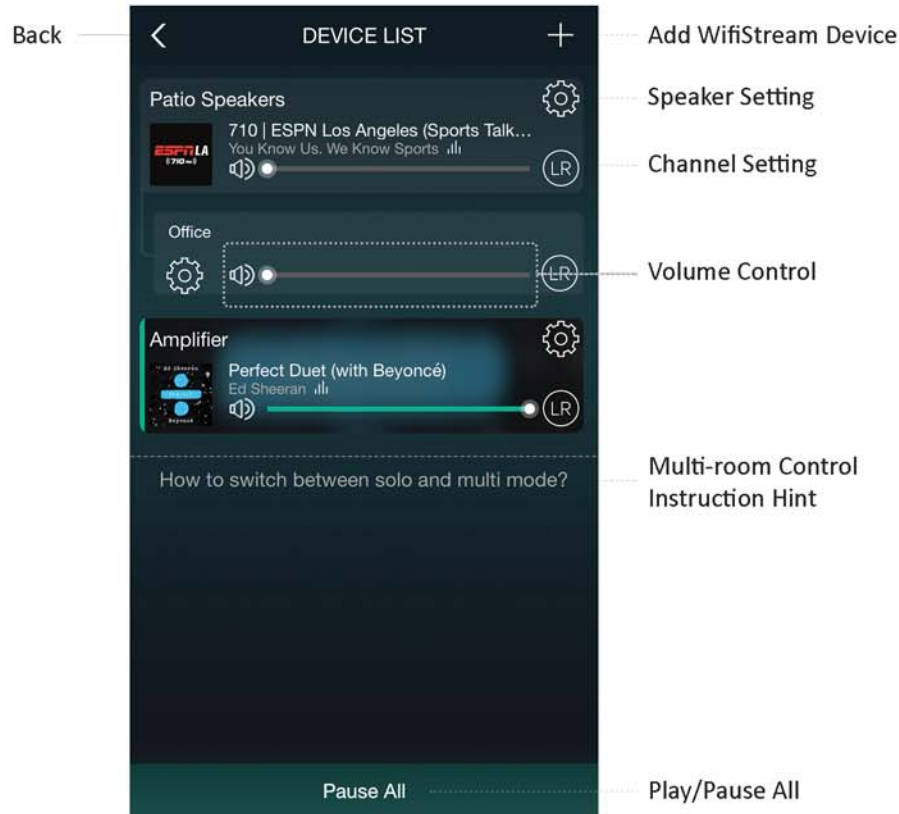

- Add WifiStream Device – access wifi setup wizard to add more speakers
- Speaker Setting – rename speaker & misc speaker setting
- Channel Setting – switch output channel (stereo, left-only, or right-only)
- Instruction Hint – click to see how to set up multi-room groups\*

\* You can group speakers by dragging a “grouped” speaker into a “main” speaker. Ungroup by dragging a “grouped” speaker to the bottom half. Once a group is formed, only the “main” speaker can be selected in any AirPlay menu. While volume can be customized individually, speakers in the same group will play content in sync.

## Troubleshooting

### Issue: Amplifier not connecting to wifi network

- Check that wifi mode is selected and the wifi system is ready (may take ~20 seconds to boot up).
- Check if the wifi network SSID & password is correct and the network you are using is 2.4G, not 5.8G.
- Make sure phone/tablet and amplifier are close to each other during set up.
- Amplifier may be out of wifi range of router. Try moving it closer to router.
- Check if the router’s internet connection is active.
- Hold the wifi reset button until factory default setting is restored and rerun wifi setup wizard.

### Issue: Amplifier not connecting to Bluetooth

- Check that Bluetooth mode is selected.
- Bring Bluetooth device closer to amplifier.
- Hold the Bluetooth reset button for 5+ seconds and try reconnecting the Bluetooth device.

### Issue: Audio does not play

- Check power is turned on.
- Check that the correct input mode is selected and the input device is connected and playing music.
- Unmute or turn up volume on amplifier, app and phone/tablet.
- Check wire connection to loudspeakers is not interrupted and polarity is correct.
- If music stops suddenly and the power button LED is off while an input mode LED is lit, protection mode is triggered. Simply turn off amplifier for 5 minutes and restart amplifier. Frequent protection mode triggers may indicate an impedance mismatch in your loudspeaker system.
- (For wifi mode via WifiStream app) In device list screen, make sure multi-room group setting is correct. The wrong speaker may be chosen.

For additional help, please visit the support & contact us section of our website at [www.ticcorp.com](http://www.ticcorp.com).



## Specifications

Output Power:	4 x 50W RMS@8Ω
Impedance Range:	4-16Ω
Inputs:	Wifi, Bluetooth, AUX line-in
Bluetooth Version:	4.2
Wifi Band:	2.4G
Frequency Response:	20Hz - 20kHz
Input Power:	DC24V 100W
Cabinetry Material:	Aluminum
Ingress Protection Rating:	IP64



## Warnings & Notes

### IMPORTANT SAFETY INSTRUCTIONS

1. Read these instructions.
2. Keep and follow all instructions.
3. Heed all warnings.
4. For indoor products, do not use this apparatus near water. For outdoor products, please do not expose apparatus to water longer than its intended time and level.
5. Clean only with a dry cloth.
6. Do not install this apparatus near any heat sources such as radiators, heat registers, stoves or other apparatus (including amplifiers) that produce heat.
7. Do not block any ventilation openings. Install this apparatus in accordance with the manufacturer's instructions.
8. Do not defeat the safety purpose of the polarized or grounding-type plug. A polarized plug has two blades with one wider than the other. A ground-type plug has two blades and a third grounding prong. The wide blade or the third prong is provided for your safety. If the provided plug does not fit into your outlet, consult an electrician for replacement of the obsolete outlet.
9. Protect the power cord from being walked on or pinched, particularly at plugs, convenience receptacles and the point where they exit from the apparatus.
10. Use only attachments and accessories specified by the manufacturer.
11. Unplug this apparatus during lightning storms or when unused for long periods of time.
12. Refer all servicing to qualified service personnel. Servicing is required when the apparatus has been damaged in any way, such as when the power supply cord or plug is damaged, liquid has been spilled or objects have fallen into the apparatus, or the apparatus had been exposed to rain or moisture, does not operate normally or has been dropped.
13. Do not expose this apparatus to dripping or splashing, and ensure that no objects filled with liquids, such as vases, are placed on the apparatus.
14. To disconnect this apparatus from the AC mains completely, disconnect the power supply cord plug from the AC receptacle.
15. The mains plug of the power supply cord shall remain readily operable.
16. Do not expose batteries to excessive heat such as sunshine, fire, or the like.
17. This is not a children's product and is not intended for use by children under 14 years old.

### SOUND WARNING

Avoid hearing damage by establishing safe listening volumes. Listening to this product at high volumes or for extended time periods may cause permanent hearing loss. Protect your hearing by establishing safe volumes. Start with the volume setting control at its lowest setting. Slowly increase the volume until you can hear it comfortably and clearly without distortion. Reduce the volume or stop listening if you experience ringing in your ears or any discomfort. Consult with a physician if needed.



#### FCC WARNING

This device complies with Part 15 of the FCC Rules. Operation is subject to the following two conditions:

- (1) this device may not cause harmful interference, and
- (2) this device must accept any interference received, including interference that may cause undesired operation. Changes or modifications not expressly approved by the party responsible for compliance could void the user's authority to operate the equipment.

#### Note 1:

This equipment has been tested and found to comply with the limits for a Class B digital device, pursuant to part 15 of the FCC Rules. These limits are designed to provide reasonable protection against harmful interference in a residential installation. This equipment generates, uses and can radiate radio frequency energy and, if not installed and used in accordance with the instructions, may cause harmful interference to radio communications. However, there is no guarantee that interference will not occur in a particular installation. If this equipment does cause harmful interference to radio or television reception, which can be determined by turning the equipment off and on, the user is encouraged to try to correct the interference by one or more of the following measures:

- Reorient or relocate the receiving antenna.
- Increase the separation between the equipment and receiver.
- Connect the equipment into an outlet on a circuit different from that to which the receiver is connected.
- Consult the dealer or an experienced radio/TV technician for help.

#### Note 2:

1. Changes or modifications to this unit not expressly approved by the party responsible for compliance could void the user's authority to operate the equipment.
2. This equipment should be installed and operated with a minimum distance of 20 cm between the device and your body.



#### WARRANTY

TIC offers a limited one-year full parts and labor warranty for all of our new products.

Please visit TIC's warranty page (<http://www.ticcorp.com/warranty/>) for detail to our latest warranty policy.

#### TRADEMARK

Apple and the Apple logo are trademarks of Apple Inc., registered in the U.S. and other countries. App Store is a service mark of Apple Inc., registered in the U.S. and other countries.

Google Play and the Google Play logo are trademarks of Google LLC.

The Bluetooth® word mark and logos are registered trademarks owned by the Bluetooth SIG, Inc. and any use of such marks by [licensee name] is under license. Other trademarks and trade names are those of their respective owners.

TIC Audio Inc. All rights reserved. The TIC logo is a trademark of TIC Audio Inc, registered in the United States. Features, specifications, and appearance are subject to change without notice.

For more information, please visit our website: [www.ticcorp.com](http://www.ticcorp.com).