

**Nokta**  
DETECTION TECHNOLOGIES

**AccuPOINT**  
PINPOINT SMARTER & FASTER



**USER MANUAL**

## WARNINGS

AccuPOINT is an electronic device manufactured with advanced technology. Do not use your device without reading the user manual.

Do not leave the device in extremely cold or hot environments for long periods of time. (Storage Temperature: -20°C to 50°C).

The device is designed to be waterproof to IP68 standards up to 3 meters. However, you must pay attention to the warnings below:

1. Do not wash or immerse in water without the back cover attached to the device!
2. Make sure that the o-ring on the back cover is fully fitted and that the cover is fully tightened before using or washing the device under water.
3. To prevent damage to the filter on the back cover, do not insert any sharp objects into the holes for cleaning purposes, etc. Do not clean it with pressurized water or compressed air. Cleaning it with tap water is sufficient. Be careful to prevent excessive dirt buildup and blockage.
4. Make sure to replace the worn-out o-ring on the back cover with the spare one. Damaged o-ring may cause the device to leak.

Never use chemical cleaners during cleaning, especially after using the device in salt water, or at any other time.

Protect the device from impacts during transportation.

AccuPOINT can only be opened and repaired by authorized service centers. Opening the device for any reason will void the warranty.

## INTRODUCTION TO THE DEVICE



## BATTERY & CHARGING INFORMATION

You can charge your AccuPOINT device with a USB charger that provides an output between 0.8A/5V and 3A/6.6V.

The charging time is approximately 2.5-3 hours.

In order to charge the device, you need to remove the audio booster piece after opening the back cover. After charging is complete, do not forget to put this piece back in its place!

While AccuPOINT is charging, a lightning bolt symbol appears inside the battery icon. When charging is complete, the battery icon displays 3 bars indicating a full charge.



When the battery is almost depleted, the device emits intermittent beep sounds as a warning. When the battery is completely depleted, after emitting 2 beeps and a long beep it shuts down.

## OPERATION OF THE DEVICE

### Turning on the Device



Press and release the Power On/Off & Settings button once. After the beep sound, AccuPOINT will be ready for use. AccuPOINT automatically resets itself when turned on. Therefore, make sure to keep the device away from metals when turning it on.

### Turning off the Device



To turn off AccuPOINT, press and hold the Power On/Off & Settings button for approximately 2

seconds and release the button once the indicator bar at the bottom hits the red part. AccuPOINT will shut down after 2 beeps. When the device is turned off and then back on, it will start in the last set configuration.

### Reset



If you plan to use AccuPOINT on wet beach sand or highly mineralized terrain, it is recommended to either turn on the device with the search tip placed on the ground you intend to use it on or reset it on the same ground. This may cause some loss of depth but ensures stable operation of the device. You can also reset the device if it receives erroneous signals during use. To do this, press the Power On/Off & Settings button once while the device is on. Do not perform the reset on metal, as it may result in some loss of depth.

## Metal Detection

The device provides audible and/or vibrating alerts when it detects metal. The frequency of sound or vibrations increases as the device gets closer to the metal and decreases as it moves away. If the target is directly under the search coil, it produces a steady sound.

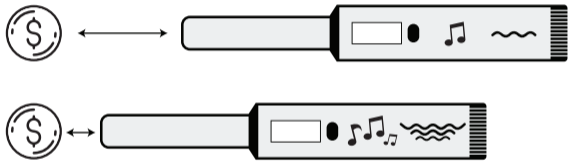

## SETTINGS

To access the settings, press and hold the Power On/Off & Settings button while the device is on and wait until the indicator reaches the settings icon. Release the button when you hover over the settings icon and hear 1 beep.



The first setting that will appear on the screen is the sensitivity. Each time you press the button, you move to the next setting. If you want to access a setting and change its value, you need to press and hold the button for about 2 seconds.



While in any of the settings, the device will revert back to the settings menu 2 seconds after you adjust the setting or 5 seconds after if you didn't adjust the setting. To return to the main screen from the settings menu, wait for 5 seconds without pressing the button.



## Sensitivity

The sensitivity level consists of nine (9) steps. The device starts at the factory default level of seven (7). To increase sensitivity, press the Power On/Off & Settings button once. Each press will increase the sensitivity value by one step. The sensitivity level is displayed both as a number and a graphic.



## Sound and Vibration

While using AccuPOINT, you can choose to enable only sound, only vibration, or both sound and vibration simultaneously. Use the Power On/Off & Settings button to view and enable/disable sound and vibration symbols on the LCD screen separately or together.

NOTE: When the device is in vibration mode, the option to hear the audio from the speaker in the Bluetooth setting cannot be selected. Similarly, when both headphones and speaker sound are selected in the Bluetooth setting, vibration feature cannot be used.

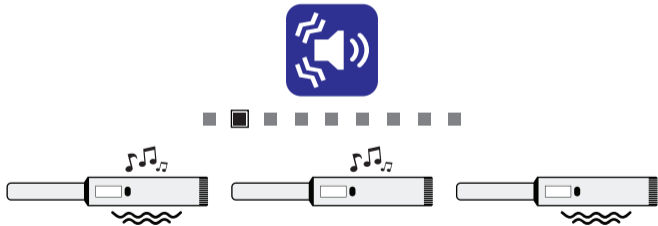

## Modes and Discrimination

AccuPOINT has 3 different search modes:



1-Tone: In this mode, the device does not discriminate between metals and produces the same sound alert for all metals.



Iron Off: Provides alerts only for non-ferrous metals and not for ferrous metals. This mode is especially recommended for use on wet beach sand or highly mineralized terrains.



**2-Tone:** In this mode, the device discriminates between iron and non-ferrous metals. When AccuPOINT detects metal for the first time, it produces the same sound alert for all metals regardless of whether the metal is iron or non-ferrous. As you get closer to the metal or when the device begins to discriminate, it continues to produce the same tone if the metal is non-ferrous. If the metal is ferrous though, it starts producing an interrupted alert. If vibration is enabled, the vibration pattern matches the sound pattern.

You can switch between modes and control your settings from the LCD screen using the Power On/Off & Settings button.

### **Bluetooth®**

After turning on your Bluetooth®-enabled headphones, go to the Bluetooth® setting and activate the wireless headphones icon with the Power On/Off & Settings button. AccuPOINT will automatically detect and connect to your headphones. This process may take more than a few minutes for the initial pairing!

**IMPORTANT!** Before pairing your Bluetooth® headphones with AccuPOINT, if there is another device already paired with the headphones, make sure that the Bluetooth® feature of that device and/or the device itself is turned off. Otherwise the headphones will not pair with AccuPOINT.

In the Bluetooth® setting, you can configure to hear the audio through the Bluetooth® headphones only or both through the Bluetooth® headphones and speaker simultaneously. AccuPOINT will automatically detect and connect to your headphones every time it is powered on.

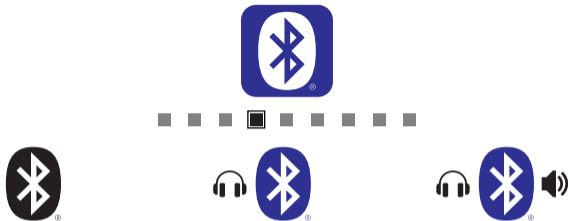

**IMPORTANT!** It may take 10-15 seconds for the audio to switch from AccuPOINT to the detector once you turn the AccuPOINT off.

Once the AccuPOINT is paired with your headphones, if you want to pair it with a different set of headphones this process may take more than a few minutes.

## Frequency Shift

This setting is used to prevent interference with other detectors operating nearby. AccuPOINT has 3 different frequency shifts. To change the frequency value, press the Power On/Off & Settings button sequentially.

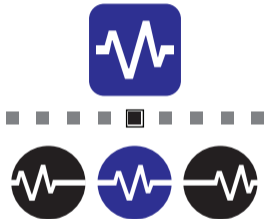

## LED Flashlight

It is the headlight used for lighting the area you are scanning while detecting at night or in dark locations. The LED Flashlight does not work when the device is off. It is recommended to turn it on when needed as keeping it on all the time can reduce battery life. To turn on the LED flashlight, you can set it on the LCD screen by pressing the On/Off and Settings buttons alternately.

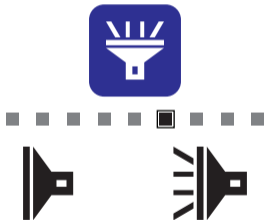

## Volume

AccuPOINT has two different volume levels: Low and High. You can adjust the volume level by pressing the Power On/Off & Settings button and monitoring it on the LCD screen.

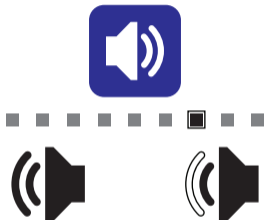



## Backlight

AccuPOINT has two different backlight levels: Bright and Low. You can adjust the backlight by pressing the Power On/Off & Settings button. AccuPOINT will automatically turn off the backlight if the button is not pressed for 20 seconds. When the Power On/Off & Settings button is pressed again, the backlight will be activated.

NOTE: The backlight level will remain the same during charging.

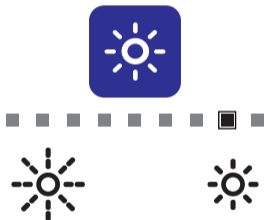

## Factory Defaults

AccuPOINT saves all the changes you make in its memory. If you want to restore the device to factory defaults, go to settings, select the 'Factory Defaults' icon, and press and hold the Power On/Off & Settings button for 2 seconds (until the hourglass icon appears). It will return to the main screen after approximately 5 seconds.



## **Lost Alarm**

AccuPOINT has an alarm feature for loss prevention. If the device is not used and the button is not pressed for five (5) minutes, the device will provide an audible alert and the LED Flashlight will start flashing. The device will continue to provide the sound alert until the button is pressed or the battery dies.

## **Detection Tip**

AccuPOINT's detection area extends from the tip to the hand grip and provides 360° detection. This allows you to easily locate metals inside dug holes and quickly scan a wider area to find your target.

## **Battery Indicator**

You can check your device's battery status monitoring the battery icon on the LCD screen.

## **Replaceable Tip Protector**

AccuPOINT comes with two replaceable tip protectors.

## TECHNICAL SPECIFICATIONS

Operating Frequency: 20kHz

Operating Principle: VLF

Waterproofness: IP68 (up to 3 m./10 ft)

Sensitivity: 9 levels adjustable

Metal Detection: Audio, Vibration and  
Audio&Vibration Alert

Discrimination: Yes

Bluetooth: Yes

Frequency Shift: Yes

LED Flashlight: Yes

Volume Control: Yes

Backlight: Yes

Screen: Color LCD

Lost Alarm: Yes

Detection Tip: 9 cm. ( 3.5")

Battery: 1650mAh Lithium Polymer  
rechargeable

Charging Cable: USB Type-C

Battery Life: Up to 25 hours

Dimensions: 24,7cmx3,8cmx3,8cm  
(9.7"x1.5"x1.5")

Weight: 217gr (7.65oz)

Working Temperature: -20°C/+50°C  
(-4°F/+122°F)

Warranty: 2 years

**Nokta Detectors** reserves the right to change the design, specifications or accessories without notice and without any obligation or liability whatsoever.



For Consumers within the European Union: Do not dispose of this equipment in general household waste. The crossed wheeled bin symbol on this equipment indicates this unit should not be disposed of in general household waste, but recycled in compliance with local government regulations and environmental requirements.



#### FCC STATEMENT

This device complies with Part 15 of the FCC Rules. Operation is subject to the following two conditions: (1)

this device may not cause harmful interference, and (2) this device must accept any interference received, including interference that may cause undesired operation.

**Nokta**  
DETECTION TECHNOLOGIES

[www.noktadetectors.com](http://www.noktadetectors.com)

## **FCC Warning:**

This equipment has been tested and found to comply with the limits for a Class B digital device, pursuant to part 15 of the FCC Rules. These limits are designed to provide reasonable protection against harmful interference in a residential installation. This equipment generates, uses and can radiate radio frequency energy and, if not installed and used in accordance with the instructions, may cause harmful interference to radio communications.

However, there is no guarantee that interference will not occur in a particular installation. If this equipment does cause harmful interference to radio or television reception, which can be determined by turning the equipment off and on, the user is encouraged to try to correct the interference by one or more of the following measures:

- Reorient or relocate the receiving antenna.
- Increase the separation between the equipment and receiver.
- Connect the equipment into an outlet on a circuit different from that to which the receiver is connected.
- Consult the dealer or an experienced radio/TV technician for help.

Caution: Any changes or modifications to this device not explicitly approved by manufacturer could void your authority to operate this equipment.

This device complies with part 15 of the FCC Rules. Operation is subject to the following two conditions: (1) This device may not cause harmful interference, and (2) this device must accept any interference received, including interference that may cause undesired operation.

The device has been evaluated to meet general RF exposure requirement. The device can be used in portable exposure condition without restriction.