

M005 2.4GHz Cordless Mouse



Note:
German and French language user manuals can be downloaded from our website: www.tecknet.co.uk.

Welcome

Thank you for purchasing this TeckNet product. To ensure optimum performance and safety, please read these instructions carefully before operating the product. It is strongly recommended you keep this manual for future reference.

Product Layout

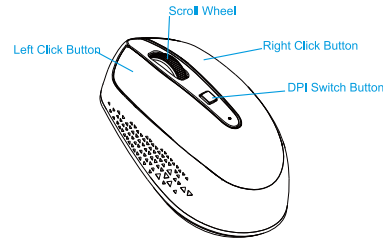

Package Contents

- 1 x M005 Cordless Mouse
 - 1 x USB Nano Receiver
 - 1 x User Manual
 - 1 x Warranty Card
- Note: Battery NOT included

01

Technical Specifications

Button Count:	4 buttons
Operating Frequency:	2.4GHz
Resolution:	1000/1500/2000DPI
Receiver Interface:	USB version 2.0
Operating Voltage:	1.5V
Operating Current:	15mA
Distance:	upto 10m
Dimension:	102 x 62 x 36mm
Weight:	67.5g

System Requirements

To use this mouse, your computer must meet the following hardware requirements and run one of the operating systems listed below.

Hardware

- PC with a Pentium processor or equivalent AMD processors
- USB 2.0

Operating System

- Windows 2000, 2003, XP, Vista, Win7, Win8, Win8.1, Win10
- Note: The scroll wheel only works under the operating systems listed above. If you use the mouse under a different operating system, the mouse may either not work or lose its enhanced features.

Instructions

Battery Installation

The M005 optical mouse uses a single AA battery (not included).

1. Install the battery into the compartment, and make sure the polarity of the battery is correct. The positive (+) and negative (-) ends of each battery must match the positive (+) and negative (-) markings in the battery housing. The red power indicator LED (the scroll wheel LED) will flash.
2. Replace the battery. Open the battery compartment cover, tap the mouse slightly and the battery will drop out, ready to load new battery, make sure it corresponds with the polarity markings.

02

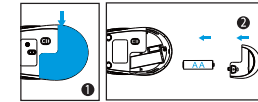

18-Month Battery Life

The mouse consumes very little power and enables a long battery life of up to 18 months without changing the battery. However please note that the actual battery life may vary based on user and computing conditions.

Receiver Connection

Remove the USB Nano receiver and plug it into a free USB port in your computer. The Plug & Play function of your system will detect that a new device has been connected and install it automatically.



Note: The receiver can be removed and stored next to the battery compartment while not in use.

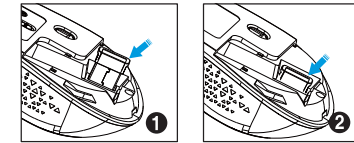

03

Intelligent Power Saving (IPS)

The mouse is equipped with Intelligent Power Saving (IPS) function.

- When the USB Nano receiver is disconnected or the PC is switched off, the mouse will automatically switch off to conserve power.
- If the mouse is not used for 3 seconds, it will automatically drop to the first level of IPS. To wake the mouse, click any button.
- If the mouse is not operated for 10 seconds, it will automatically drop to the second level of IPS. To wake the mouse, click any button.
- If the mouse is not operated for 8 minutes, it will automatically drop to the third level of IPS, e.g. sleep model. To wake the mouse, click any button.

DPI Switch

The mouse supports 2000, 1500 and 1000 DPI. To switch to either setting,

- The default setting is 1500 DPI.
- Click the DPI button on the top of the mouse once to switch from 2000 DPI to 1000 DPI, the scroll wheel LED will flash one time.
- Click the DPI button on the top of the mouse once again to switch from 1000 DPI to 1500 DPI, the scroll wheel LED will flash twice.
- Click the DPI button on the top of the mouse once again to switch from 1500 DPI to 2000 DPI the scroll wheel LED will flash three times.



Low Battery Power Indicator

The mouse is equipped with low power indicator. When the battery power gets low during the period of use, the Indicator under the Scroll Wheel will flash. Please replace the battery.
Note: We recommend you use a AA alkaline dry cell battery, press the DPI button.



Reconnection

There is a wireless signal connection code for this mouse. High temperatures, electro-magnetic fields or vibration may influence the code signal and occasionally the mouse may need to be reconnected. Both the mouse and Nano Receiver have a built-in code and one mouse can be connected to one receiver, or several mice to one Nano Receiver.

04

1. Unplug the Nano receiver from USB port, and plug it back in.
2. Move the mouse within 50cm of the Nano receiver, re-install the battery or press any key to reconnect, the above process must be completed within 15 seconds.
3. The mouse will be ready for use after reconnection.

Attention

1. To maximize battery life, it is recommended to use the mouse on a white or light color surface.
2. If not used, the mouse will drop into auto-sleeping mode within 3 seconds. Press any key or scroll wheel to activate the mouse.
3. Do not use the mouse on a glass or mirrored surface, as these surfaces will cause the mouse to fail temporarily.
4. The mouse might not work smoothly on some special surfaces, such as smooth, dark or black, reflecting and 3D mouse pads surfaces.
5. Avoid using the mouse on a metal surface. Metals, such as iron, aluminum or copper, shield the radio frequency transmission and may slow down the mouse presenter's response time or cause the mouse to fail temporarily.
6. If your PC has a metal case that contains aluminum or magnesium, use the mouse to the side. The display panel may interfere with the radio frequency signal if you use the mouse directly in front of the PC.

FAQ

1. What should I do if the mouse does not work?
 - Make sure that the polarity of the batteries is correct. The positive (+) and negative (-) ends of each battery must match the positive (+) and negative (-) markings in the battery housing.
 - Make sure the batteries are not discharged. Try to remove the batteries, and reinstall them again.
 - Verify that your computer's power management features are turned off.
 - Check the Nano receiver's USB connector is firmly attached to the USB port of your computer.
 - Still not working? Please try "Reconnection".
2. The USB Nano receiver is recognized by Windows (XP, Vista, Win 7, 2000, 2003, 2007, Win8) but the cursor does not move?
 - Check whether the low power indicator on the top of the mouse lights up. If the sensor lights up, it is likely that the batteries are discharged. Please replace the batteries.
 - If replacing the batteries does not help, it is likely that the mouse is not connected to the receiver. Please try "Reconnection".

05

3. When I use the mouse, other 2.4G Cordless devices work more slowly or fail temporarily – what should I do?
 - The mouse has 34 channels to prevent interference. However, the mouse may cause interference with any cordless, radio-based device that operates at 2402MHz – 2480MHz. To reduce interference, move the mouse's receiver and the base unit of the affected device as far away from each other as possible; alternatively try to change the 2.4G frequency of the affected devices.

4. What should I do if the mouse responses slow or intermittently stops working?
 - Ensure that the mouse is within the operational working distance (1.5m) from the USB Nano receiver and restart your PC.
 - Increase the distance between the Nano receiver and the base units of other cordless devices.
 - Turn off any cordless device and their base units that are near the mouse Nano receiver.
 - If you are using the mouse on a metal surface, move the mouse and the receiver to a non-metallic surface. Metals, such as iron, aluminum or copper, shield the radio frequency transmission and may slow down the mouse presenter's response time or cause the mouse to fail temporarily.

5. I cannot use the mouse while another cordless mouse is in use – what should I do?
 - Please try "Reconnection".

06

Warning

Please read all instructions and warnings prior to using this product for the first time. Failure to read and follow these safety and usage instructions could result in fire, explosion, electric shock or other hazard that could potentially cause property damage or even fatal injury.

- Keep the mouse and batteries out of the reach of children.
- Replace old or weak batteries promptly.
- Remove the batteries if the mouse is not going to be used for a long period of time.
- Don not disassemble, adjust or repair the mouse which may result in exposure or safety hazards.

Disclaimer

Every effort has been made to ensure that the information and procedures in this guide are accurate and complete, no liability can be accepted for any errors or omissions and we reserve the right to make any changes without further notice to any products mentioned herein.

Warranty

We warrant that products purchased from authorized distributors will meet the applicable product specifications and be free from all defects in design, assembly, materials and workmanship. Please contact retailers or visit our website www.tecknet.co.uk for more information.

07

FCC Warning

This device complies with part 15 of the FCC Rules. Operation is subject to the following two conditions:

(1) This device may not cause harmful interference, and (2) this device must accept any interference received, including interference that may cause undesired operation.

Any Changes or modifications not expressly approved by the party responsible for compliance could void the user's authority to operate the equipment.

Note: This equipment has been tested and found to comply with the limits for a Class B digital device, pursuant to part 15 of the FCC Rules. These limits are designed to provide reasonable protection against harmful interference in a residential installation. This equipment generates uses and can radiate radio frequency energy and, if not installed and used in accordance with the instructions, may cause harmful interference to radio communications. However, there is no guarantee that interference will not occur in a particular installation. If this equipment does cause harmful interference to radio or television reception, which can be determined by turning the equipment off and on, the user is encouraged to try to correct the interference by one or more of the following measures:

- ▶ -Reorient or relocate the receiving antenna.
- ▶ -Increase the separation between the equipment and receiver.
- ▶ -Connect the equipment into an outlet on a circuit different from that to which the receiver is connected.
- ▶ -Consult the dealer or an experienced radio/TV technician for help.