

FLY THE BEST

INSTRUCTION MANUAL

SWIFT STREAM™ Z-32CV

INDOOR / OUTDOOR CAMERA DRONE



Manual Contents

- FAA registration is not required
- Packing list
- Battery installation
- Charging instructions
- Ready to fly and how to hover
- 360° flips
- Calibration trim control
- Flight environment
- Troubleshooting
- Parts list (by name and number)

Packing List

- (1) Z-32CV Camera Drone
- (1) 3.7V 300 mAh Li-Poly battery
- (1) 2.4GHz remote controller
- (1) 4 GB Memory card
- (1) 4 GB Memory card reader
- (1) USB charge-wire
- (1) Set of spare blades
- (1) Warranty card

PARTS - SERVICE - REPAIR

Tel: 248.809.2129 Toll Free: 866.296.2700
E-mail: Service@SwiftStreamRC.com
Website: www.SwiftStreamRC.com

QR CODE --- TO OUR SERVICE DEPARTMENT



OPEN Mon - Fri 9am to 6pm / Sat 10am to 3pm (EST)

Imported and Distributed by:
Abrim Enterprises, Inc.
Woodside, NY 11377

PACKING LIST

■ Z-32 CV Camera Drone



■ 2.4 GHz Remote Control

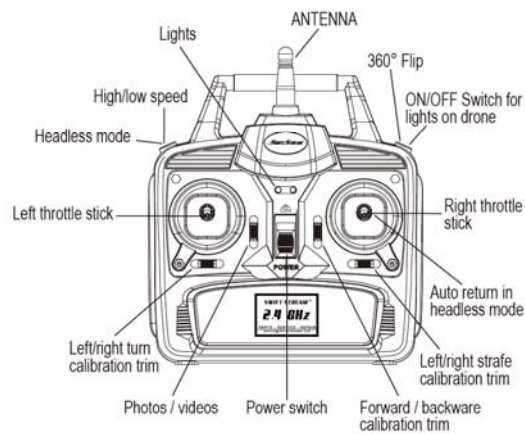

■ Parts Included

- Phillips Screwdriver
- USB Charge-wire
- Spare Blades
- Memory card reader
- 4 GB memory card



BATTERY INSTALLATION

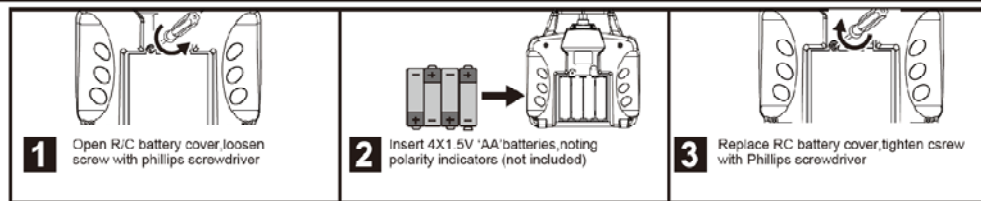

(FRESH ALKALINE BATTERIES STRONGLY RECOMMENDED)

CHARGING INSTRUCTIONS



1. Unplug battery

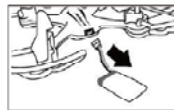

2. Gently pull out battery

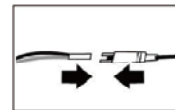

3. Connect the battery-wire to the USB charge-wire

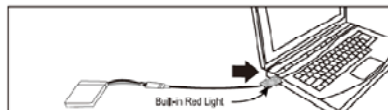

4. Plug the USB charge-wire into USB computer charge port, or other USB power source

- A. USB charge-wire red light will stay on until charging is completed. A full charge can take up to 60 minutes.
- B. Put USB charge-wire away for safe keeping.

Safety Precautions when charging Li-Poly battery

- Charge the battery on a dry flat, non-flammable hard surface, never charge on carpet, rugs, cloth or a soft material
- Do not leave a charging battery unattended
- Never use a swollen battery or a leaky battery, or one which is damaged or giving off an unusual odor
- Gently insert the Drone battery plug into the Drone charging port, without using force
- Do not over-charge the battery – doing so may shorten battery life
- Do not use or leave the battery near any heat source, this may cause battery damage, or even risking an explosion
- Do not strike, slam, attempt to puncture, or otherwise attempt to damage the battery
- Do not submerge the battery in water or any other liquid
- Store battery in a cool dry place
- Do not attempt to disassemble the battery
- Use only the included charger for charging the battery
- Do not use the included charger to charge any other battery
- Remove and store the battery, when not in use for 30 days or more

STOP

CHARGE BATTERY
ON A FLAT - NON FLAMMABLE SURFACE
NEVER CHARGE ON CARPET, RUGS OR
SOFT MATERIAL

READY TO FLY

Diagram 1



RC power light

- Plug the battery wire into the Drone power port (diagram 1), lights on drone will blink from fast to slow
- Set the drone down on flat surface in a horizontal position
- The Drone will not properly lift off unless it is on a flat surface
- Point antenna of RC towards the back of the drone
- Step back behind the Drone to a safe distance of 6' to 8' (1.8 to 2.4 meters)
- Turn ON remote control, the green light on RC will start blinking. Move left throttle stick up and down once and the green light will become solid. Lights on drone will stop blinking and it is now ready to fly.

When power light is blinking, it is locating the Drone signal, we refer this as "synchronization sync".

Once synced - the Power and Drone light will turn solid

LEARN HOW TO HOVER

- Once you have mastered this operation, flying is easy!
- Once you can hover try moving the Drone up and down with the left throttle stick
- Gradually move the right throttle stick up and down to go forward and backward

SPEED SETTINGS

2 SPEED SETTINGS HIGH / LOW SPEED



Press the RC top left shoulder button.
Each press will change the speed.
1 short beep is the Low Speed, 2 short beeps is the High speed.

HEADLESS FUNCTION SETTINGS TO GO INTO HEADLESS MODE

4-Sided Front / Nose ... All sides become the Front / Nose
Easy to Fly ... Ideal for Beginners

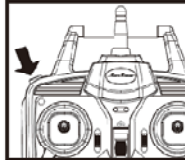

1. Settings to go into Headless mode

- Follow Ready to Fly instruction
- Press the RC top left shoulder button for 4-5 seconds to activate the Headless mode.
- You will hear a beeping sound from the RC, indicating that you are now in Headless mode
- The LED lights will blink once every second.
- To deactivate, press the RC top left shoulder button for 4-5 seconds until you hear 3 short beeps. The lights on drone will stop blinking.

Auto Return In Headless Mode

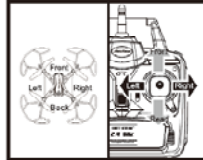

2. In Headless mode

- Once in Headless mode, all sides become the front / nose, making it easy to fly.
- Push the directional throttle forward, and the Drone moves away from you, no matter where the "nose" is pointing north
- Any side facing north becomes the front / nose of drone.

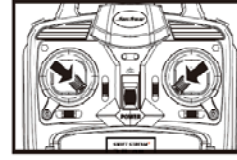

3. Crash or straying

- If the Drone begins to drift while in Headless mode, reset by doing the following:
 - Simultaneously push both left and right throttles in the direction shown in diagram
 - Drone LED lights will blink quickly until reset mode has completed (this may take up to 3 seconds)
 - When the reset has completed the fast blinking of the Drone LED lights will stop and they will slowly start blinking



In Headless Mode the Drone will fly back towards you

Hold top right shoulder button down for 3 seconds, then Press the right throttle stick down from top once and you should feel a click. The Drone will fly back to you. To deactivate, push the right throttle stick all the way up once.

FLYING INSTRUCTIONS

| | | | |
|--------------|--|--|---|
| ■ Ascending | | | Gently push the left throttle up, Drone will fly upward |
| ■ Descending | | | Gently push the left throttle down, Drone will fly downward |
| ■ Forward | | | Gently push the right throttle up. the front of the Drone will tilt forward as the Drone moves forward |
| ■ Backward | | | Gently push the right throttle down. the back of the Drone will tilt backward as the Drone moves backward |
| ■ Turning | | | Gently push the left throttle left, the Drone will turn left. Push the left throttle right, Drone will turn right |
| ■ Strafe | | | Gently push the right throttle left, Drone will strafe to the left. |
| | | | Gently push the right throttle right, Drone will strafe to the right. |

360° FLIPS IN ALL DIRECTIONS



Anytime you wish to flip your Drone while in flight- Just push the button at the upper right hand corner on the RC (Diagram 2)

You will hear beeping sound. Drone will go into a 360° flip mode.

The 360 Flip mode will be deactivated after 3 seconds

■ Forward 360° Flips



While the Drone is flying forward, push right throttle up. Drone will flip forward; Drone must be flying forward to go into a forward 360° flip.

■ Backward 360° Flips



While the Drone is flying backward, push right throttle down. Drone will flip backward; Drone must be flying backward to go into a backward 360° flip.

■ Right Side 360° Flips



While the Drone is flying to the right push right throttle to right position. Drone will flip to the right; Drone must be flying to the right to go into a strafe right 360° flip.

■ Left Side 360° Flips



While the Drone is flying to the left, push right throttle to left position. Drone will flip to the left; Drone must be flying to the left to go into a strafe left 360° flip.

LIFT OFF CORRECTION / FACTORY RESET

Place the Drone on a flat surface.

Turn on drone and RC (follow Ready to fly instructions).

Push both left and right throttle to the direction show in diagram(1) and hold for 3-5 seconds, the lights on drone will quickly blink.

Once the blinking stop, the Drone should properly lift off.

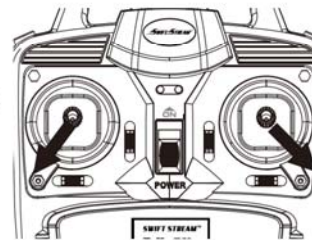

CAMERA INSTRUCTIONS

■ Camera

Camera / Video
Camera Indicator
LED Lights

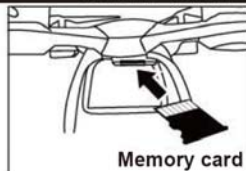

Memory card

Insert micro Memory card

* Gently push the memory card in, with the gold tips facing up. It is spring activated and will lock into place

■ Taking photos

Push Photo / Video button on RC upward. RC will beep once for each photo taken.

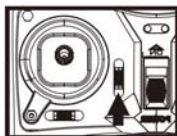

■ Taking Video

Push Photo/Video button on RC downward. 2 short beeps from RC when it start recording. Push button downward again to end recording.

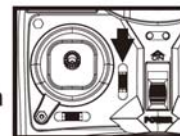

■ Downloading Photos or Videos

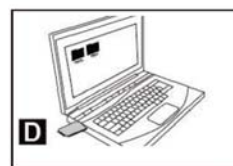
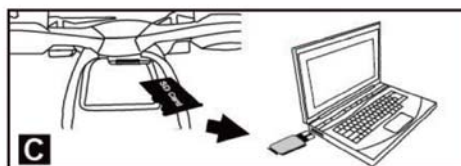

- Take out the memory card. The memory card holder is spring activated. Gently push it in and the memory card will come out
- Insert the memory card into the tail end of the card reader (diagram C)
- Insert the USB metal end of the card reader into your computer or other USB power supply (diagram D)
- Follow the menu instructions on your computer screen (diagram D)

CALIBRATION TRIM CONTROL

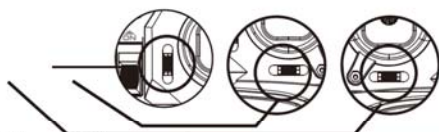

Calibration trim controls are used to stop excessive drifting while in flight. An example would be: while your Drone is in flight - the wind is blowing it to the right. To stop the drifting to the right, you would use the appointed calibration trim control button and throttle.

| | | | |
|-----------------------------|---|--|--|
| ■ Trim Control Forward | <div>Trim control button</div> <div>Before</div> <div>After</div> | | Drone is drifting forward, press the trim control button to a downward position until drifting stops |
| ■ Trim Control Backward | <div>Before</div> <div>After</div> | | Drone is drifting backward, press the trim control button to an upward position until drifting stops |
| ■ Trim Control Strafe Right | <div>Before</div> <div>After</div> | | Drone is drifting to the right, press the trim control button to the left position until drifting stops |
| ■ Trim Control Strafe Left | <div>Before</div> <div>After</div> | | Drone is drifting to the left, press the trim control button position to the right position until drifting stops |

FACTORY RESET TRIM CONTROL

Unplug the Drone battery for 15 seconds, plug back in. This feature takes your Drone back to the original factory settings

TROUBLESHOOTING AND REPLACEMENT PARTS

| PROBLEMS | SOLUTIONS |
|---|---|
| Transmitter / RC is not turning on | <ul style="list-style-type: none"> - Replace the batteries |
| Drone is not flying stable | <ul style="list-style-type: none"> - Recharge Drone battery - Re-sync transmitter / RC - Place the Drone on a flat surface and turn in ON. Turn on RC and push both left and right throttle to the direction show on page 4 (diagram 1) Hold in this position for 3-5 seconds, you will see the Drone LED lights quickly blink 3 times, Once the Drone LED lights blinking stop, the Drone should properly lift off. |
| Drone is not lifting off | <ul style="list-style-type: none"> - Check and make sure the blades are turning freely - Be sure the blade guards are not obstructing the blades - Re-charge Drone battery - Check all propellers, 'A' propellers must be placed on motor 'A' 'B' propellers must be placed on motor 'B' |
| Transmitter RC light will not turn on | <ul style="list-style-type: none"> - Replace batteries - Be sure the Drone battery power plug is correctly into the Drone |
| You will find most problems are because: the Drone battery needs to be recharged or the blades are not turning freely | |

FLIGHT ENVIORNMENT INDOOR / OUTDOOR

INDOOR

- Recommended flying area: 12' x 12' x 10'H (3.65 meters x 3.65 meters x 3.04 H meters)
- Avoid drafts, forced air, water, fans, heat and air condition vents

OUTDOOR

- Fly in moderate temperatures 50 to 80°F, 10-27° C
- Recommended flying area: 20' x 20' feet (6.09 meters x 6.09 meters)
- Avoid strong winds, which could blow away or damage Drone
- Do not fly near people, animals, moving methods of transportation, homes, buildings water and structures.
- Do not fly near overhead wires or cables
- Keep flying Drone away from pets, young children, crowds of people, the elderly and the disabled

WHEN NOT IN USE

- Be sure USB charge-wire is unplugged from power supply
- Turn Drone power switch OFF
- Turn transmitter RC power switch OFF
- When not in use for 30-Days or more, remove transmitter 'AA' batteries, batteries may leak and cause damage

WARNING

- Do not place stickers, weight, or anything else on the Drone. This may cause the unit to crash or malfunction voiding the warranty
- Avoid flying under low ceilings. Crashing into ceilings may cause damage to the Drone
- To avoid injury, do not touch the blades or any other moving parts
- Allow 10 minutes for the battery to cool down before touching the battery
- Keep flying Drone away from pets, pedestains, young children, crowds of people, the elderly and the disabled

USE GOOD COMMON SENSE WHEN FLYING!

SPARE PARTS LIST: AVAILABLE AT WWW.SWIFTSTREAMRC.COM

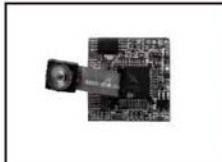

#1 Circuit board
(Receiver)



#2 Main Blades



#3 3.7 V 300mAh
Li-Poly Battery



#4 Motor A with Red and blue
wires (clockwise rotation)



#5 Motor B with Black and
white wires
(counter-clockwise rotation)



#6 Landing Gears

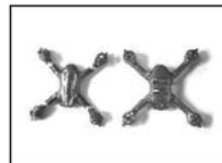

#7 Canopy (red or black)

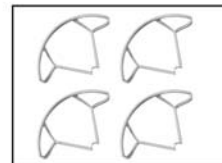

#8 Blade Guards



#9 USB charge-wire



#10 2.4GHz
Remote Controller



#11 Memory card
reader



#12 4 GB Memory card



For exciting new products...
Check Out Our Website!
www.SwiftStreamRC.com

PARTS - SERVICE - REPAIR
Tel: 248.809.2129 Toll Free: 866.296.2700
E-mail: Service@SwiftStreamRC.com
Website: www.SwiftStreamRC.com

QR CODE --- TO OUR
SERVICE DEPARTMENT



OPEN Mon - Fri 9am to 6pm / Sat 10am to 3pm (EST)

Imported and Distributed by:
Abrim Enterprises, Inc.
Woodside, NY 11377

FCC Statement

This device complies with Part 15 of the FCC rules. Operation is subject to the following two conditions: 1) this device may not cause harmful interference, and 2) this device must accept any interference received, including interference that may cause undesired operation.

Note: This equipment has been tested and found to comply with the limits for a Class B digital device, pursuant to part 15 of the FCC Rules. These limits are designed to provide reasonable protection against harmful interference in a residential installation. This equipment generates uses and can radiate radio frequency energy and, if not installed and used in accordance with the instructions, may cause harmful interference to radio communications. However, there is no guarantee that interference will not occur in particular installation. If this equipment does cause harmful interference to radio or television reception, which can be determined by turning the equipment off and on, the user is encouraged to try to correct the interference by one or more of the following measures:

- Reorient or relocate the receiving antenna.
- Increase the separation between the equipment and receiver.
- Connect the equipment into an outlet on a circuit different from that to which the receiver is connected.
- Consult the dealer or an experienced radio/TV technician for help.

Changes or modifications not expressly approved by the party responsible for compliance could void the user's authority to operate the equipment.

This device is measured RF output power is less than the SAR exclusion threshold value for human head and body. Therefore, SAR test is not necessary.