

Wireless Audio Transceiver

Support optical

Low latency

ZF-380

User manual

Dear friends, thanks for choosing our products.
In order to better use the functions of this product,
please read this user manual before use.

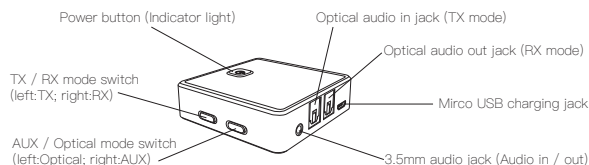

Receiver Mode

1, Turn on / off

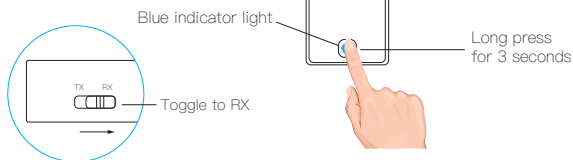

If there is no device access after turning on, the transceiver will automatically shut down in 5 minutes.

2, Pairing with your Bluetooth device

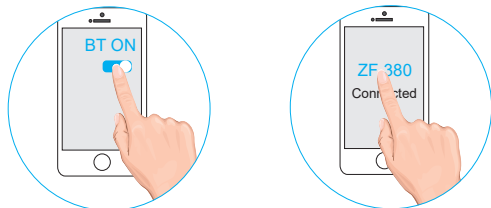

Transmitter Mode

1, Turn on / off

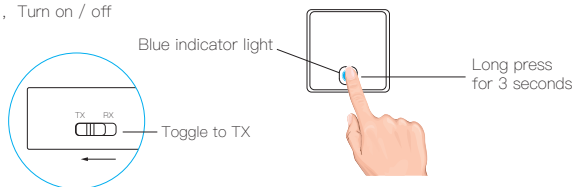

If there is no device access after turning on, the transceiver will automatically shut down in 5 minutes.

2, Pairing with your Bluetooth device

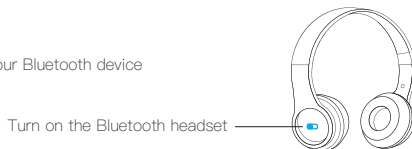

For wireless headsets: Make sure that the headset is waiting for pairing (refer to the manual of the headset for details).

* For AirPods: Put AirPods in the charging compartment. Open the cover, then press and hold the button on the back of the charging compartment until the indicator light flashes white.

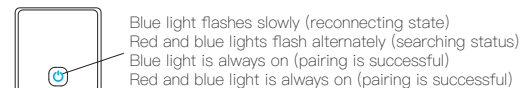

After power on, the transceiver will automatically connect to the last connected device. If the connection is unsuccessful, it will enter the searching status. The product will automatically pair and connect with the Bluetooth device. The first Bluetooth device is successfully connected. Double click the power button to continue searching for pairing, and the second BT device is successfully connected.

3, Connect with audio source devices

1) With the fiber optic cable

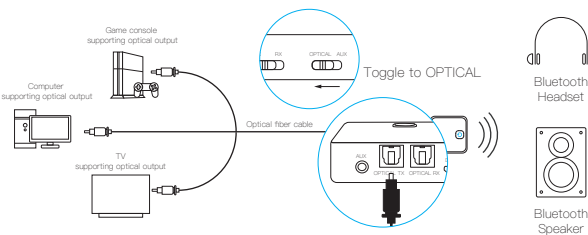

Plug one end of the optical fiber cable into the optical TX interface of the transceiver, the other end into PC, TV, game console and other devices that support optical audio output.

2) With the 3.5mm audio cable

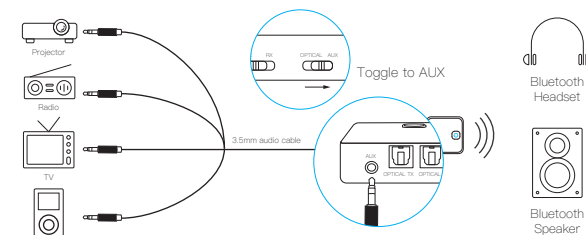

Plug one end of the 3.5mm audio cable into the audio interface (marked AUX) on the transceiver, and the other end into the AUX interface on the TV or other equipment.

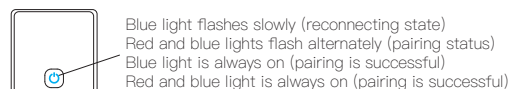

After power on, the transceiver will automatically connect to the last connected device. If the connection is unsuccessful, it will enter the pairing status. Turn on the bluetooth function of bluetooth device (mobile phone or tablet computer, etc.), find "zf-380" in the bluetooth search list, select connection to successfully connect to the first mobile phone, double-click the power button to continue pairing, you can use another mobile phone to search for "zf-380" and connect, and successfully connect to the second mobile phone.

3, Connect audio playback device

1) With the fiber optic cable

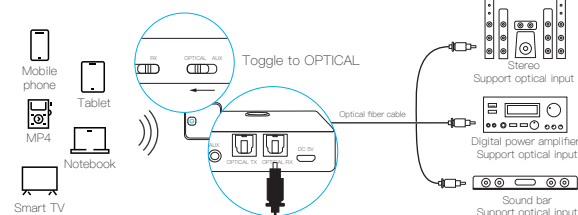

Plug one end of the optical fiber cable into the optical RX interface of the transceiver, the other end into Sound bar, Stereo and other devices that support optical audio input.

2) With the 3.5mm audio cable

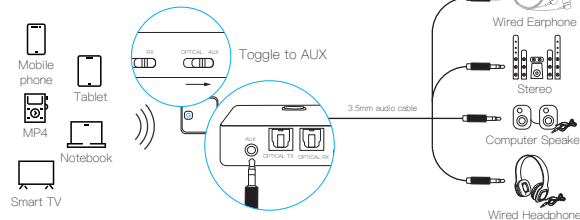

Plug the 3.5mm audio cable of the wired headset or wired speaker into the audio interface (marked AUX) on the Bluetooth transceiver.

What's Included

- 1x Bluetooth Transceiver
- 1x Micro USB Charging Cable
- 1x 3.5mm Audio Cable
- 1x RCA Audio Cable
- 1x Optical Fiber Line
- 1x User Manual

Notice

1. If you cannot turn on the product for the first time, may be because the battery is low. Please try again after fully charged.
2. Please keep the products shut down after use. It helps to increase the battery service life.
3. It is recommendable to fully charge the battery for the first time.
4. Make sure the battery is fully charged if not regularly used.
5. Do not place the products in high temperature that is above 45°C or exposed to sunshine, as it will result in an explosion.
6. Do not attempt to dismount;
7. If the red light does not work for a long time, please press and hold the power key until you restart.
8. Low battery shall cause auto turn off the product. Charge the battery to fix the problem.
9. The operational range of the products may be influenced by obstructions, such as walls, pillars, etc. To ensure a stable connection, we recommend avoiding such obstructions whenever possible and/or shortening the distance during use.

FCC WARNING

This device complies with part 15 of the FCC Rules. Operation is subject to the following two conditions: (1) this device may not cause harmful interference, and (2) this device must accept any interference received, including interference that may cause undesired operation.

Any changes or modifications not expressly approved by the party responsible for compliance could void the user's authority to operate the equipment.

NOTE: This equipment has been tested and found to comply with the limits for a Class B digital device, pursuant to Part 15 of the FCC Rules. These limits are designed to provide reasonable protection against harmful interference in a residential installation. This equipment generates, uses and can radiate radio frequency energy and, if not installed and used in accordance with the instructions, may cause harmful interference to radio communications. However, there is no guarantee that interference will not occur in a particular installation.

If this equipment does cause harmful interference to radio or television reception, which can be determined by turning the equipment off and on, the user is encouraged to try to correct the interference by one or more of the following measures:

- Reorient or relocate the receiving antenna.
- Increase the separation between the equipment and receiver.
- Connect the equipment into an outlet on a circuit different from that to which the receiver is connected.
- Consult the dealer or an experienced radio/TV technician for help.