

# Q9 Use manual

## Accessories Lis

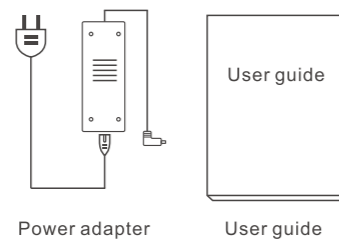

## Method of installation

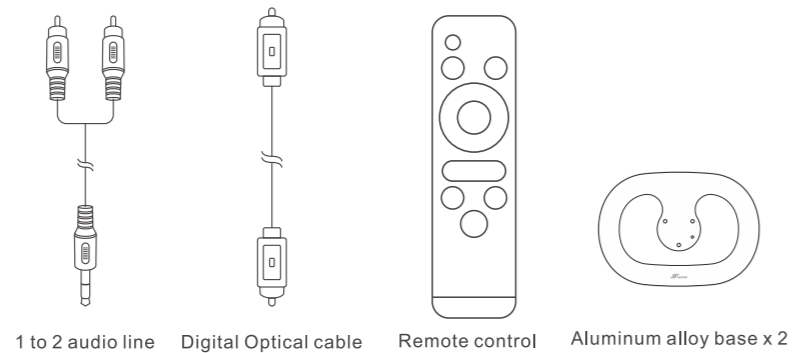
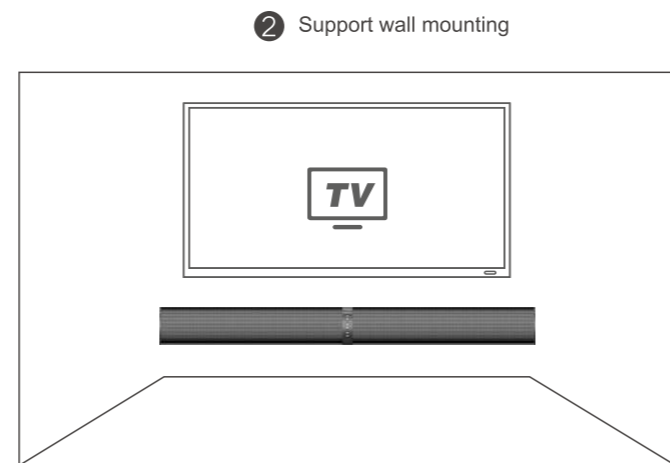
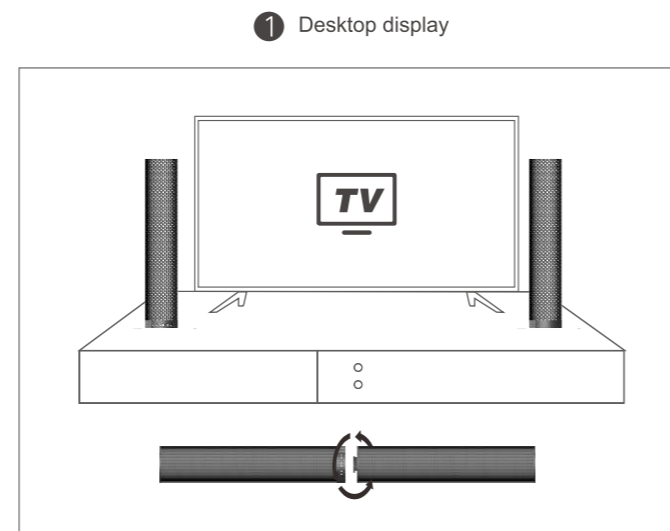

## Q9 front button, back panel jacks display

### Q9 front button



	Power	ON / OF
	Set up	Function Set up <small>Press this button to press the power on button to turn off / off the voice prompt. After booting, press this button to switch between Chinese and English.</small>
	Input	Mode switch
	Enter	Play/Pause/On
	VOL-	PRE / VOL -
	VOL+	NEXT / VOL +

### Q9 back panel jacks

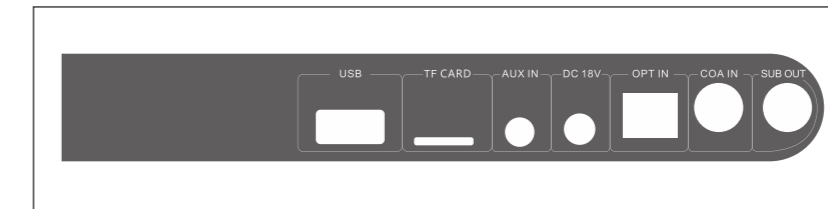

### Connect the following audio source equipment



## Connect Method of Speaker

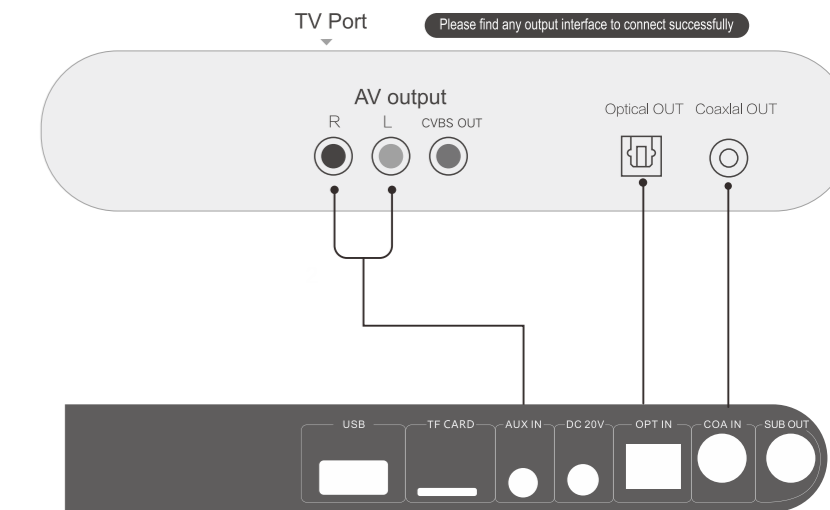

## Remote control instructions

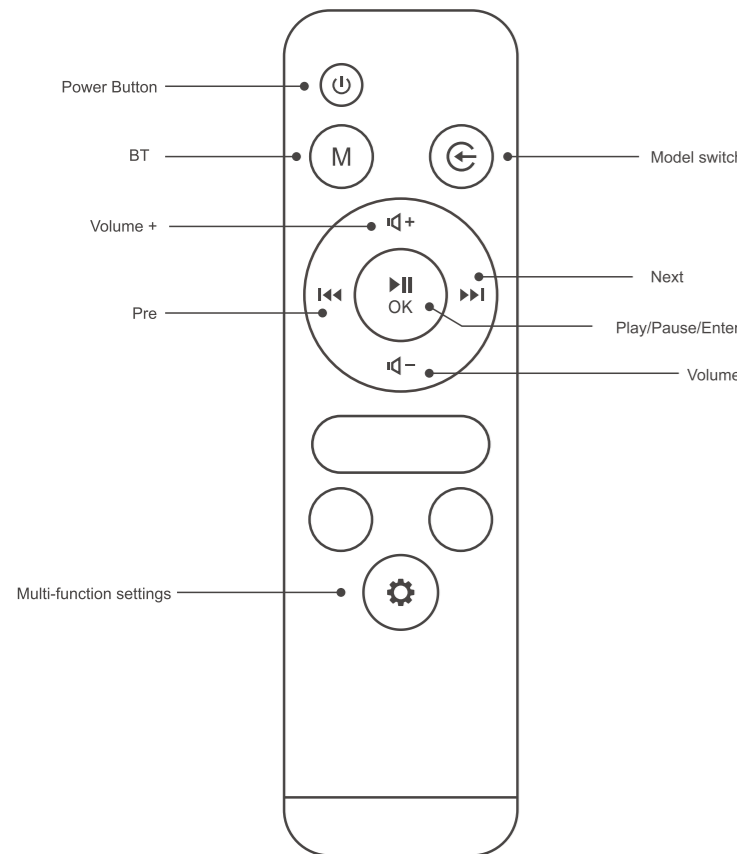

## M

- When using native Bluetooth devices for mobile phones for the first time, press short "INPUT" to repeat the short press until it is displayed
- Bluetooth appears on the screen, and then automatically enters the pairing, while the screen shows "0000"
- Turn on the bluetooth device in your phone, find "JY AUDIO" and connect it
- After matching with the products, you can play music, and the product or remote control can control the music of your mobile phone
- The bluetooth device of this machine comes with voice prompt

## Multi-function Settings

Cycle times	Microphone Off	Microphone On
Press 1 time	Treble adjustment mode	Microphone volume adjustment
Press 2 times	Bass adjustment mode	Microphone ECHO adjustment
Press 3 times	EQ mode	Delay adjustment

## Trouble shooting

- Under any situation, you should not try to repair this device by yourself, which will invalidate the warranty. Please do not open the device so as to avoid electric shock
- If something goes wrong, please check the 5 points listed below, and then repair the equipment
- If you are unable to solve the problem as per the following instructions, please contact your distributor or our company for assistance

### 1 No electricity

- The power switch on the device in open condition
- Press the remote standby button to turn on the power switch
- Making your AC power line is plugged in

### 2 No sound or distortion of sound

- Adjust volume
- Ensure that the audio cable has been connected, then press the INPUT button to select the audio input sound source(for example BLUE or AUX), so that you can select the device sounds that you want to listen to through the device

### 3 The remote control can not work normaly

- Please select the audio input source before pressing the remote function button
- Shorten the distance between the remote control and the device
- The battery capacity is not enough. Please replace the battery

### 4 U disk and TF card is not playing

- Insert U disk or TF card into the computer, check whether the internal is MP3, WAV and other music files or not .
- Check U disk or TF card is damaged or not
- Check whether U disk and TF card capacity is more than 32G or not

### 5 Bluetooth cannot play

- Turn on the power, press "INPUT" to switch to Bluetooth mode, and check if there is a beep or not
- Press the play button in the machine or in remote control to allow Bluetooth to enter into matching state
- Turn on the Bluetooth switch and search for the JY AUDIO device. Click on to connect it
- If the JY AUDIO device is connected successfully, you need to turn on your mobile music player and press the play button

## Specification parameter

Mode: Q9

Power: 80W

Frequency response: 20Hz-20KHz

Distortion: ≤0.1% (1KHz 1W 8Ω)

Signal-to-noise ratio: ≥75db

Separation degree: ≥65db

Input sensitivity: 680mV RMS

Stand by power: ≤0.5W

Power supply: DC 18V/3A

Host machines size: 956 × 58 × 95mm

## Sound Warranty Card

- Within 7 days from the date of purchase, audio quality problems arise, consumers can choose to refund the purchase price at a one-time price or change the same model with the specifications of the product
- Since the purchase date of 30 days of audio products quality problems, consumers can choose to replace the same model specifications products
- Sound three Guarantee Card for one year
- This card shall not be altered, otherwise it shall be deemed to be invalid
- Thirty days replacement, audio warranty for a year, accessories are not within the scope of warranty
- Because of the requirement to ensure the safe transportation of the packing box used sound in the process of transportation, for your customer service service convenient days after the date of receipt of your advice from at least 30 days of packing box

## Non warranty policy

- It has exceeded the warranty period
- Quality problems caused by unauthorized maintenance, misuse, collision, omission, misuse, entry, accident, alteration, dis-assembly, incorrect use of non local parts, or installation of software systems
- Tear up, alter the label, the machine serial number, the anti-counterfeit mark
- Not in accordance with the requirements of the product manual, practical maintenance, storage lead to damage
- Damage due to force majeure
- Warranty card model and repair product model does not match or change

# Product Warranty card

Products Brand	
Products Model	
User Name	
User Tel	
User Address	
Reason	

## FCC Warning

- This equipment has been tested and found to comply with the limits for a Class B digital device, pursuant to part 15 of the FCC Rules. These limits are designed to provide reasonable protection against harmful interference in a residential installation. This equipment generates, uses and can radiate radio frequency energy and, if not installed and used in accordance with the instructions, may cause harmful interference to radio communications. However, there is no guarantee that interference will not occur in a particular installation. If this equipment does cause harmful interference to radio or television reception, which can be determined by turning the equipment off and on, the user is encouraged to try to correct the interference by one or more of the following measures:
- Reorient or relocate the receiving antenna.
  - Increase the separation between the equipment and receiver.
  - Connect the equipment into an outlet on a circuit different from that to which the receiver is connected.
  - Consult the dealer or an experienced radio/TV technician for help.

Caution: Any changes or modifications to this device not explicitly approved by manufacturer could void your authority to operate this equipment.

This device complies with part 15 of the FCC Rules. Operation is subject to the following two conditions:  
 (1) This device may not cause harmful interference, and  
 (2) this device must accept any interference received, including interference that may cause undesired operation.

The device has been evaluated to meet general RF exposure requirement. The device can be used in portable exposure condition without restriction.