



3.7V Rechargeable Lithium Battery
 Frequency Range: FRS
 Narrow Band:12.5KHz
 Output power:1W
 50 Groups CTCSS, 105 Groups DCS
 Up to 99 Channels(1-99)
 Time-out timer(TOT)
 VOX Level: OFF/1/2/3/4/5
 Busy Channel Lockout (BCLO)
 Carrier mode scan for channel
 Squelch Level:0-9
 Monitoring Function
 Chinese/English Language

Use's Manual BF-T9



USB Charging long distance sound quality clear high capability Li-ion battery Fashion and mini



To users

Thank you for your favor with our products. We are dedicated to providing high performance and high stability radio communication products. This two-way radio is no exception. This product is a small and exquisite walkie-talkie developed and produced by the professional team for the popularization of civil consumer market. In order to make you fully understand the various advantages of the radio performance and use and maintenance methods, please read this manual carefully.

Function Introduction

- 1、3.7V Rechargeable Lithium Battery
- 2、Frequency Range: FRS
- 3、Narrow Band Selection: 12.5KHz
- 4、Stepped frequency:5K/6.25K/12.5K/25K
- 5、Output power: ≤ 1W
- 6、50 Groups CTCSS, 105 Groups DCS
- 7、Up to 99 Channels(1-99)
- 8、Time-out timer(TOT)
- 9、VOX Level: OFF/1/2/3/4/5
- 10、Busy Channel Lockout (BCLO)
- 11、Carrier mode scan for channel
- 12、Squelch Level:0-9
- 13、Battery Saving Function
- 14、Monitoring Function
- 15、Low Battery Voltage Warning/Indication
- 16、Chinese/English Language

Safety Information

Please read the following information in order to use this two-way radio safely and efficiently.

1. The maintenance work of the two-way radio can only be carried out by professional technical personnel; assembly/dis assembly without permission is prohibited;
2. To avoid problems caused by electromagnetic interference and/or electromagnetic compatibility, please turn off the two-way radio in places with the sign "Please turn off two-way radio", such as hospitals and other health care facilities.
3. When taking airplane, please turn off the two-way radio when the crew request.
4. In automobile with airbags, do not place the two-way radio in the inflation area of the airbags.
5. Turn off the two-way radio before entering the flammable and explosive environment;
6. Do not replace or charge the battery in flammable and explosive environments;
7. Turn off the two-way radio before approaching the blasting area and detonator area;
8. Do not use the two-way radio if the antenna is damaged, or else it may cause minor skin burns;
9. Do not expose the two-way radio to direct sunlight or near the heating device.

Familiar with the machine

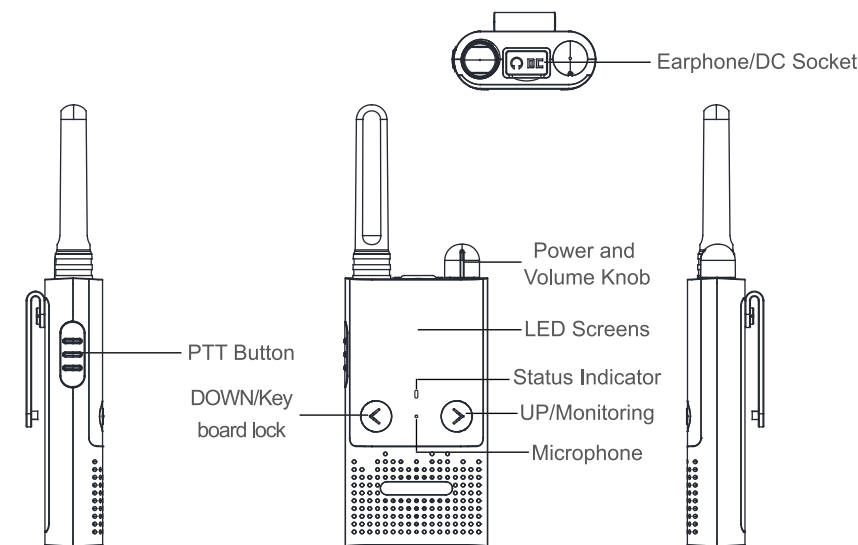

RECYCLED PACKAGING

Familiar with the machine

Description of the Buttons

[PTT]: When transmitting, press this button and speak to the microphone; release the button to receive.

[<] DOWN Button: Long press this button to turn on/off keypad lock, Short press for Channel of diminishing.

[>] UP Button: Long press this button to turn on/off Monitoring Function, Short press for Channel of Increasing.

Note:

1."<" and ">" are press for more than 2 seconds to enter channel scanning.

2. Press and hold the PTT+ "<" button and turn on radio. Switch between Chinese and English.

3. Press and hold PTT+ ">" button to transmit DTMF(1750HZ, 1450HZ, 2100HZ) by default to 1750HZ, It can be set by the write frequency software (edit → optional function → DTMF).

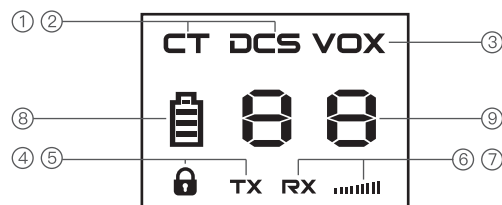

02

Familiar with the machine

1.CT (CTCSS): When the screen displays this symbol, it represents the current channel for CTCSS receive and transmit.

2.DCS (CDCSS): When the screen displays this symbol, it represents the current channel for CDCSS receive and transmit.

3.VOX: When the screen displays this symbol, it represents the VOX function of the turn on.

4. (Key lock): When the screen displays this symbol, it represents the keyboard is locked and cannot be switched up and down; except for PTT key and MONI key.

5.TX: When the screen displays this symbol, it represents is in the transmitting state, and the signal strength icon is display same time.

6. RX: When the screen displays this symbol, it represents is in the receiving state, and the signal strength icon is display same time.

7. Signal strength icon.

8. (Battery level and Charging indicator): The icon represents the current battery level. When charging, the battery level jumps back and forth from 1 grid to 3 grids. (No display when power off and charging)

9. Channel number: Display current channel.

Note: The radio will enter power-saving mode after 10 seconds of standby, then the screen will be turned off, this moment, the green is flicker.

03

Function Operation

CTCSS / CDCSS encode and decode

50 groups of CTCSS and 105 groups of CDCSS encode and decode functions can be set to prevent unrelated calls received on the same channel.

Busy Channel Lockout(BCLO)

To activate this function, when the channel is being used by other users, press "PTT" key, the radio will cannot transmit and "beep, beep" prompt sound.

When the channel is idle, press the "PTT" key again and it can be transmitted.

04

Function Operation

Time-out timer(TOT)

The function of the time-out timer is to prevent the any calling party from using a channel too long and continuously.

You can set this function through the programmable (time:30 seconds, 60 seconds, 90 seconds, 120 seconds, 150 seconds, 180 seconds, 210 seconds, 240 seconds, 270 seconds, 300 seconds). If you continue to transmit beyond the set time, the radio will stop transmitting and beep. Release the [PTT] button and press the [PTT] button again to resume transmit.

Monitor

Turn on the radio, press the "UP" button for a long time to compulsively open the receiver and listen to whether there is any voice on the current channel.

7Squelch Level

The frequency of squelch is 0 (on) -9 (deep), steps: 1, Level 0 is normally open SQL.

Automatic Battery Saving Function

This function starts when the machine does not receive a signal or does not perform an

05

Function Operation

operation for more than 10 seconds. The machine automatically stops this function when it receives a signal or performs an operation.

Chinese/English voice prompts

Press and hold the PTT+ "<" button and turn on radio. Switch between Chinese and English.

Low Battery Voltage Warning

When the battery voltage is 3.3v, the radio voice prompts: "charge battery". When the battery voltage is 3.1v, the radio is forbidden to transmit.

Scan

In standby mode, Press and hold the **[UP]** and **[DOWN]** keys for 2s to start scanning, and press any key to stop scanning.

Transmit DTMF

Press and hold the **[PTT]** + ">" key to transmit the corresponding DTMF number. (1750HZ、1450HZ、 2100HZ)

06

Technical Specification

General		Transmitter	
Frequency range	FRS	RF Power	≤ 1W
Memory channels	99	Modulation	FM
Operation voltage	DC3.7V (Li-ion Battery)	Max frequency deviation	≤±5KHz
Frequency stability	±2.5ppm	Stray Radiation	≤-60dB
Operation temperature	-20℃~+50℃	Transmit current	≤1000mA
Mode of operation	Simplex	Preemphasis Character	6dB/per octave
Antenna impedance	50Ω		
Ground connection	Negative electrode		
Volume	53.5x22x165MM		
Receiver			
Sensitivity	<0.16uV (12dB SINAD)	Audio distortion	<10%
Squelch Sensitivity	<0.2uV	Intermodulation	≥65dB
Audio power	≥380mW	Receive current	≤380mA
Note: The above specifications/technical instructions are for reference only because of the continuous improvement of the technology. Please refer to the physical object.			

07

Safety Information

FCC Warning

Operation is subject to the following two conditions:

- (1) This device may not cause interference, and
- (2) This device must accept any interference, including interference that may cause undesired operation of the device.

RF Exposure complianceStatement and operating instructions

The device has been tested against the SAR limit (1.6W/kg). The highest SAR value reported under this standard during product certification for use at the Face up is 0.549W/kg and when properly worn on the body is 1.504W/kg. This device was tested for typical operations.

The device only supports simplex-mode and transmitting is no more than the rated duty cycle factor of 50% of the time. For hand-held operation, the radio should be held at least 25mm from the user's face. The use of belt clips, holsters and similar accessories should not contain metallic components in its assembly. The use of accessories that do not satisfy these requirements may not comply with RF exposure requirements, and should be avoided. Use only the supplied or an approved antenna.

Safety Information

FCC Channel List

Channel	Frequency	Model	Channel	Frequency	Model
1	462.5625	FRS	12	467.6625	FRS
2	462.5875	FRS	13	467.6875	FRS
3	462.6125	FRS	14	467.7125	FRS
4	462.6375	FRS	15	462.5500	FRS
5	462.6625	FRS	16	462.5750	FRS
6	462.6875	FRS	17	462.6000	FRS
7	462.7125	FRS	18	462.6250	FRS
8	467.5625	FRS	19	462.6500	FRS
9	467.5875	FRS	20	462.6750	FRS
10	467.6125	FRS	21	462.7000	FRS
11	467.6375	FRS	22	462.7250	FRS