

4-AXIS AEROCRAFT INSTRUCTION MANUAL

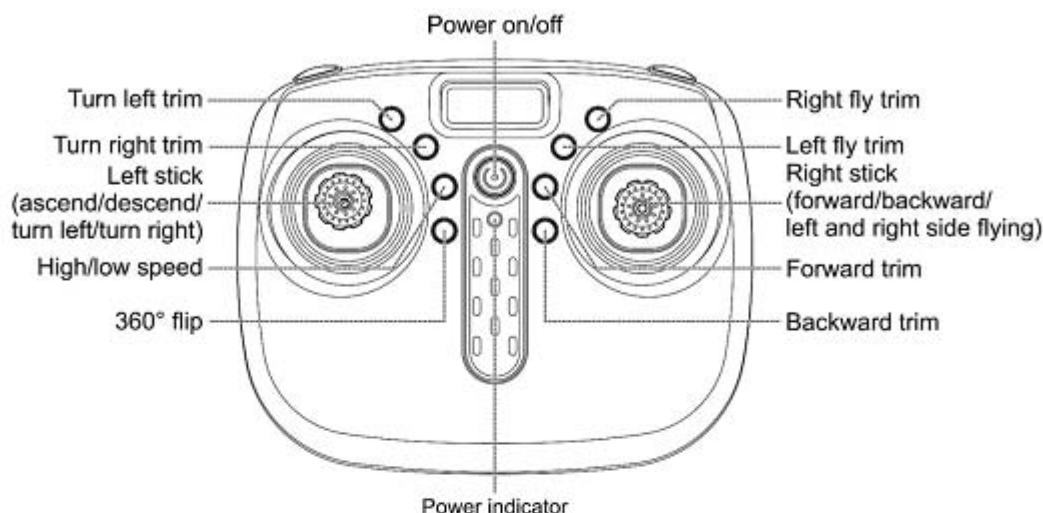

REMOTE CONTROL BATTERY INSTALLATION

1. Remove the battery cover from the back of controller (Fig. A)
2. Install 4 "AA" batteries into the controller, make sure to install batteries to their correct polarity. (Fig. B)
Do not mix old and new batteries or battery types.
3. Replace the battery cover



Fig.A

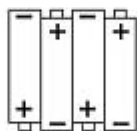

4"AA"Batteries(Not Included)

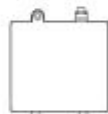

Fig.B

THE INSTRUCTION OF LITHIUM BATTERY CHARGING

1. Open the aircraft battery cover and remove the aircraft's lithium battery from the aircraft battery compartment. (Figure 1)
2. Connect the lithium battery to the USB charger socket and plug the other end of the USB charger into the power port.
When charging, the LED will light up. When the charging is completed, the LED will automatically turn off, indicating that charging is complete. The charging time is about 30 minutes. (Figure 2)
3. After charging is completed, install the lithium battery into the battery slot and connect it to the connector on the circuit board, taking care not to reverse the positive and negative poles. (Figure 3)
4. Cover the aircraft battery cover.



Figure 1

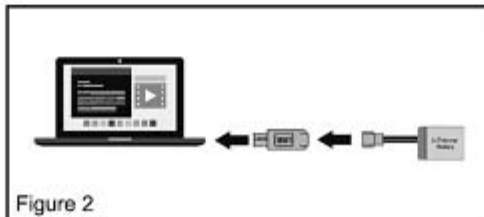

Figure 2



Figure 3

FCC statement

This device complies with Part 15 of the FCC Rules. Operation is subject to the following two conditions: (1) This device may not cause harmful interference, and (2) this device must accept any interference received, including interference that may cause undesired operation.

Caution: Changes or modifications not expressly approved by the party responsible for compliance could void the user's authority to operate the equipment.

NOTE: This equipment has been tested and found to comply with the limits for a Class B digital device, pursuant to part 15 of the FCC Rules. These limits are designed to provide reasonable protection against harmful interference in a residential installation. This equipment generates, uses and can radiate radio frequency energy and, if not installed and used in accordance with the instructions, may cause harmful interference to radio communications. However, there is no guarantee that interference will not occur in a particular installation. If this equipment does cause harmful interference to radio or television reception, which can be determined by turning the equipment off and on, the user is encouraged to try to correct the interference by one or more of the following measures:

- Reorient or relocate the receiving antenna.
- Increase the separation between the equipment and receiver.
- Connect the equipment into an outlet on a circuit different from that to which the receiver is connected.
- Consult the dealer or an experienced radio/TV technician for help.