

4-AXIS AEROCRAFT INSTRUCTION MANUAL

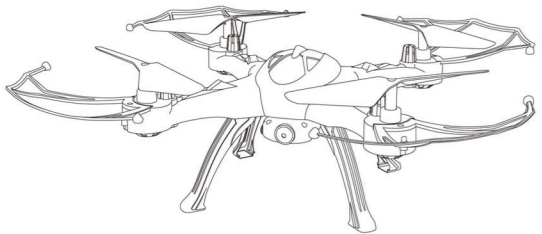

This device complies with Part 15 of the FCC Rules. Operation is subject to the following two conditions: (1) this device may not cause harmful interference, and (2) this device must accept any interference received, including interference that may cause undesired operation.

All parts included

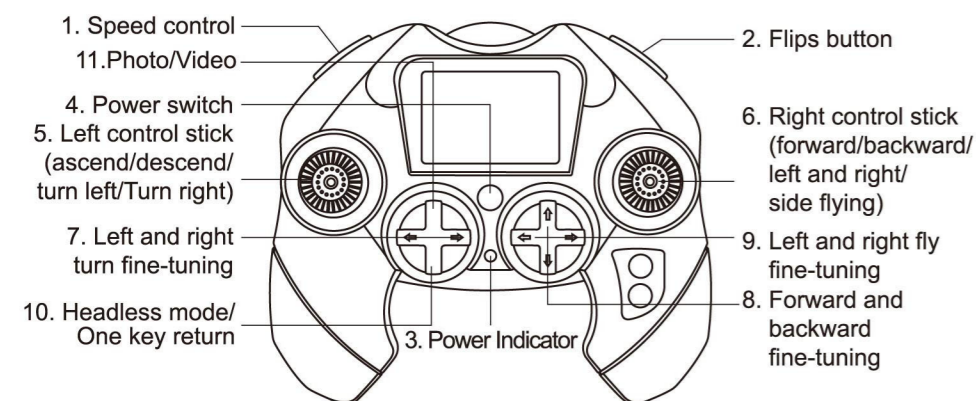
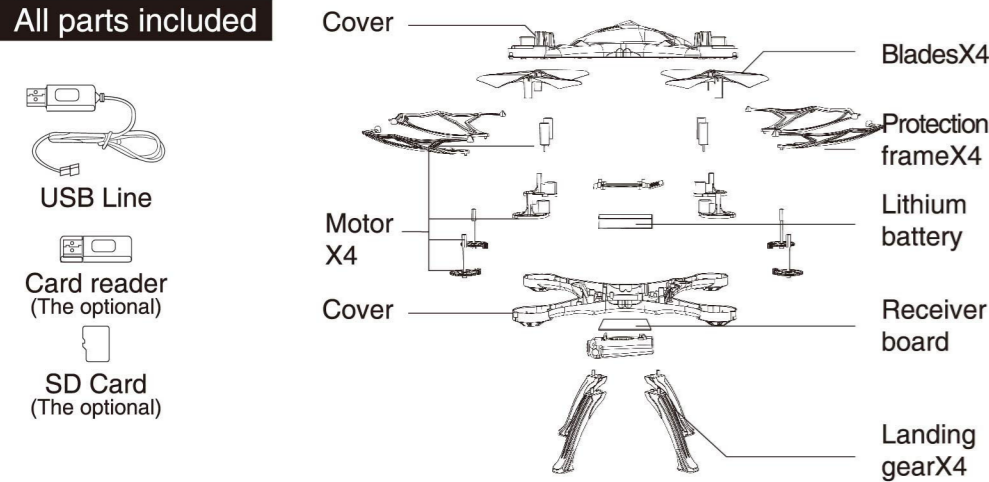

Serial Number	Function keys / Names	Function / Effect
1	Speed control key	Adjust the aircraft left / right / forward / backward / left / right side fly speed.
2	Flip key	The key to turning the function key, control aircraft implement flip operation.
3	Power Indicator	1) Indicating lamp intermittent flicker: said remote controller has not started, to the throttle stick to push to the top end, and then drag the low-end before they can start remote controller. 2) Indicating lamp kept fast flash: said remote controller in on code state, with the receiver for code. 3) Indicator light: remote controller in flight control state.
4	Power switch	Remote controls power, press the remote control power supply is turned on, press off the power.
5	Left joystick	Up/down, left/right turn.
6	Right joystick	Forward/backward, left/right.
7	Left/right turn trimming key	In the vehicle to the left (right) rotation, to the right (left) light press this key can make the vehicle stable.
8	For ward and back left and right direction joy stick	Forward / backward, left / right turn.
9	Left / right sideways trimming key	In the vehicle to the left (right) moves to the right (left) light, press this key can make the vehicle stable.
10	Headless mode/ One key return	Tap into the headless mode, press 3 seconds to enter a return key, and then touch Cancel function.
11	Photo/Video	Tap into the photo mode, press 3 seconds to enter video, and then touch Cancel function.

Aircraft battery change

Put down the lithium battery as shown direction of the aircraft, and then cover computer cover, USB charger plug into the power brain USB jack, after charging plug of the charger lithium battery plug is connected, the LED lights off when charging, charging is completed when the LED is on, the charging time of approximately 45 minutes.

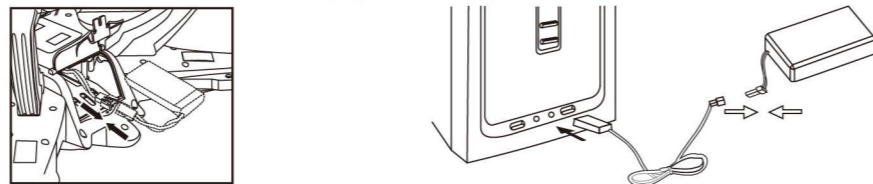

The related notes about lithium battery's usage

- In the case of misuse, the batteries' charging may cause fire, body hurt and property loss. players must be aware of the risks of using this product. Manufacturers,retailers and dealers do not bear any responsibility once accidents occur, so please carefully read the safety guidelines and charging instructions before operating.
- Once the batteries' electrolyte come into your eyes, do not rub, but wash them with clean water and seek medical care immediately.
- Please remove the plug immediately if you find out the peculiar smell, noise and smog.
- Please comply with the following requirements strictly, or it may cause fire, electric shock or explosion.

Charge

- Please use the charger from original factory to ensure your safety using.
- Do not charge the dilatant / outworn batteries.

- Do not overcharge the battery. please pull out the charger once the battery is fully charged.
- Do not charge it next to the inflammables or in the surface of electro-conductive objects. you should observe the battery at all times.
- Do not charge the batteries which are still not cool on the surface. Otherwise, it would cause expansion and even fire accident.
- The charging temperature should be between 0°C and 40°C.

Recycle

- Do not deal with the related equipment as daily rubbish. The damaged/unusable batteries should be put into the designated container.
- This equipment is composed of electronic elements and batteries. for the electronics garbage, please dispose them according to the special requirements.
- Please familiarize yourself with the local garbage disposal method.

How to control

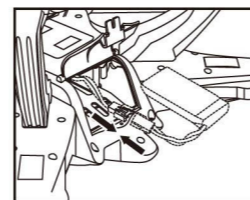

- The aircraft power cord with battery power cord by the method shown correctly connected, the aircraft set flat on the ground, board LED do not move the body flashing.
- About 6 seconds, the operation of the throttle stick to the bottom, and then the power switch to the "ON" position, Lights flash into often by aircraft bright so that the remote control and flight on completion of the frequency, the aircraft can be operated.
- Aircraft on the open space before and after the flight before direction of and behind the vehicle on himself.

WARNING

If the aerocraft hasn't been used for a long time, please disconnect the battery wire from the circuit board.

Important: Aircraft color blades end to the forward direction, the aircraft white blades end for the backward direction.

Ascending Descending	Push up the throttle stick, and the spinning speed of the main blades will increase. the aerocraft begins to ascend. Pull down the throttle stick, and the spinning speed of the main blades will decrease. the aerocraft begins to descend.	
Turn right Turn left	Push the rudder stick to the left, and the aerocraft will turn to left. Push the rudder stick to the right, and the aerocraft will turn to right.	
Forward Backward	When the rudder stick is pushed upward, the aerocraft swashplate will downtilt and it advances. When the rudder stick is pushed downward, the aerocraft will uptilt and it recedes.	
Left sideward fly Right sideward fly	When push the right lever (steering rudder) to the right, the aerocraft will fly to the right. When push the right lever (steering rudder) to the left, the aerocraft will fly to the left.	

If the aircraft take-off can not be vertical rise of aircraft correction, press the throttle lever and direction of operation joystick hit the bottom right corner of the vehicle indicator flashes quickly loosen all the remote control button until the indicator light, the calibration is complete.



Flying environment:

- Indoor flying: choose a wide place without barriers, pets and people.
- Outdoor flying: choose the warm, sunny or windless weather.

Notice: ① Do not fly in extreme temperatures. flying in extreme temperatures may affect the performance and damage the product.
② Do not fly in windy days. the performance and the control of the aerocraft will be affected by winds. windy condition may cause the missing and damage of the aerocraft.

Problems and solutions

Problems	Causes	Solutions
Transmitter not working	1. The transmitter switch is on "OFF"	1. Turn on the transmitter
	2. Install the batteries improperly	2. Check with the pole indications and reinstall the batteries again
	3. Batteries are completely consumed	3. Replace with new batteries
Control failure	1. The transmitter switch is on "OFF"	1. Turn on the transmitter
	2. The aerocraft battery no connection	2. The aerocraft battery in the correct orientation connection
	3. Too strong wind force	3. Do not fly under the environment of windy as too strong wind may cause flying limitation to the aerocraft or it may hamper your controlling or flying.
Ascending failure	1. The rotation of main blades is too slow 2. The fuselage battery is well consumed	1. Push up the throttle stick 2. Recharge the-fuselage battery
Landing too soon	The throttle stick is pulled down too fast	Pull down the throttle stick slowly to perform a smooth landing
Out of control	Beyond the effective controlling distance	Make sure there is no transmitter with the same frequency is used with in the radius of 30 meters.

Precautions

- The remote controlled distance will be shorten when the power (aerocraft or transmitter) is insufficient.
- It is difficult to take off or fly not high whe aerocraft's power is insufficient.
- When the aerocraft is damaged, please repair it in time and stop operating, or it may lead to injury.
- If you do not use the transmitter for a long time, please remove the batteries to avoid the batteries' leakage.
- Do not drop the transmitter from the high altitude or crash it badly, otherwise, it will shorten the transmitter's using life.

Caution: The user is cautioned that changes or modifications not expressly approved by the party responsible for compliance could void the user's authority to operate the equipment.

This device complies with Part 15 of the FCC Rules. Operation is subject to the following two conditions: (1) this device may not cause harmful interference, and (2) this device must accept any interference received, including interference that may cause undesired operation.

NOTE: This equipment has been tested and found to comply with the limits for a Class B digital device, pursuant to Part 15 of the FCC Rules. These limits are designed to provide reasonable protection against harmful interference in a residential installation. This equipment generates, uses and can radiate radio frequency energy and, if not installed and used in accordance with the instructions, may cause harmful interference to radio communications. However, there is no guarantee that interference will not occur in a particular installation.

If this equipment does cause harmful interference to radio or television reception, which can be determined by turning the equipment off and on, the user is encouraged to try to correct the interference by one or more of the following measures:

- Reorient or relocate the receiving antenna.
- Increase the separation between the equipment and receiver.
- Connect the equipment into an outlet on a circuit different from that to which the receiver is connected.
- Consult the dealer or an experienced radio/TV technician for help.

FCC Radiation Exposure Statement:

This equipment complies with FCC radiation exposure limits set forth for an uncontrolled environment.

This transmitter must not be co-located or operating in conjunction with any other antenna or transmitter.