

# Baby Delight® Snuggle Nest 5" Video, Movement & Positioning Monitor

Please read the following instructions and warnings carefully.  
Keep this instruction manual for future reference.  
Tools required: Screwdriver and Drill (not included)  
**For technical support see back page.**  
Adult use only.

 **WARNING:** Adult assembly required. Keep small parts away from children when assembling.

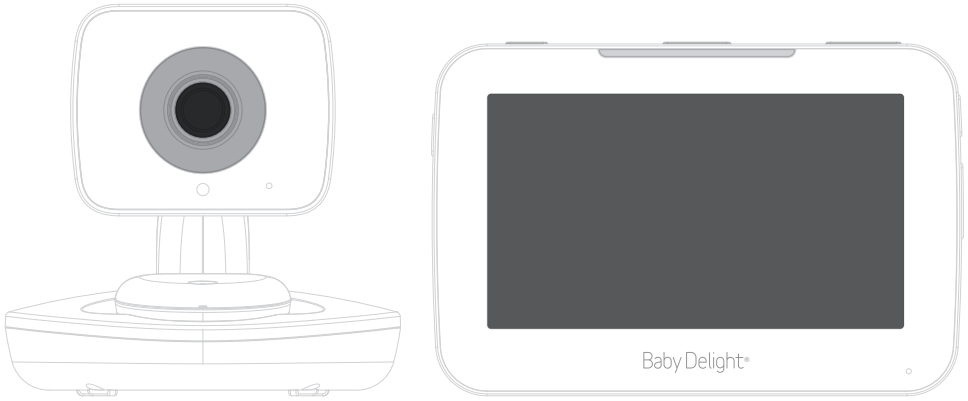

## Mom Applauded Features:

- 5" video monitor screen
- Wireless camera with night vision
- Movement and position monitor with an alert for inactivity
- User friendly interface

## INSTRUCTION MANUAL

---

### Warnings & Guidelines:

---

 **WARNING:** STRANGULATION HAZARD - Keep cord out of baby's reach. NEVER place camera or cords within 3 feet of the crib. Use enclosed Security Clips to help secure cord away from baby's reach. Never use extension cords with AC Adapters. Only use the AC adapters provided.

### **WARNING:**

THIS PRODUCT CANNOT REPLACE RESPONSIBLE ADULT SUPERVISION.

- **STRANGULATION HAZARD** - Keep cord out of baby's reach. NEVER place camera or cords within 3 feet of the crib. Use enclosed Security Clips to help secure cord away from baby's reach. Never use extension cords with AC adapters. Only use the AC adapters provided.
- When an AC adapter is plugged into an electrical outlet, do not touch the exposed end.
- Test monitor before first use, periodically, and when changing location of the Camera.
- Do not use monitor near water (such as bathtub, sink, etc.)
- Keep monitor away from heat sources (such as stoves, radiators, etc.).
- Make sure there is proper ventilation around all monitor components. Do not place on sofas, cushions, beds, etc. which may block ventilation.
- Nursery monitors use public airwaves to transmit signals. This monitor may pick up signals from other monitors or similar devices and signals broadcast by this monitor may be picked up by other receivers.
- This product is not a toy. Do not allow children to play with it.
- This product contains small parts. Adult assembly required. Exercise care when unpacking and assembling the product.

### **BATTERY WARNING:**

- Use only the original rechargeable batteries provided. Please contact Summer Infant, Inc. for replacement batteries. Contact information can be found on bottom of these instructions or on the battery itself.
- Do not mix old and new batteries.
- Do not mix alkaline, standard, or rechargeable batteries.
- Batteries are to be inserted with correct polarity.
- Clean battery and product contacts prior to battery installation.
- Do not short-circuit supply terminals.
- Only the recommended batteries or equivalent are to be used, volts and size.
- Remove the batteries when product is stored for long periods of time or when batteries are exhausted.
- Dispose of exhausted batteries properly.
- Do not recharge non-rechargeable batteries.
- Rechargeable batteries are only to be charged under adult supervision.
- Keep all batteries away from children.

# All Components

- 1 camera, 1 monitor, 1 movement unit
- 2 AC Adaptors
- 6 Cable Clips
- 1 Actor and Wall Mount Screw

**Camera**

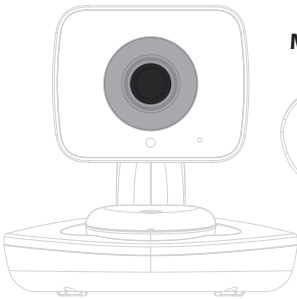

**Movement Unit**

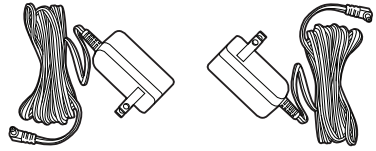

**AC Adaptors**



**Monitor**

## Hardware



X1



X1

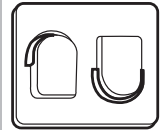

X6

## Features • Camera

**Microphone**

**Lens**

**Power On LED**

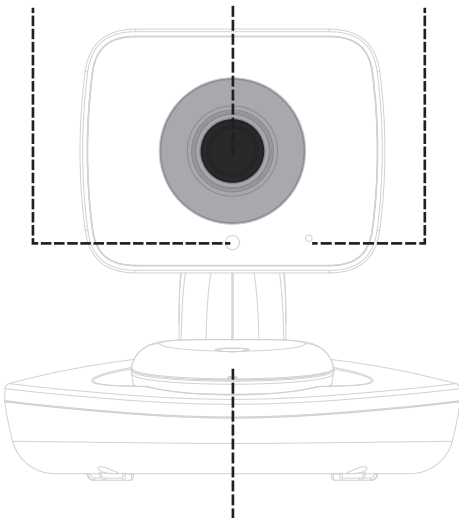

**Movement Unit Charging Station**

**Power On/Off**

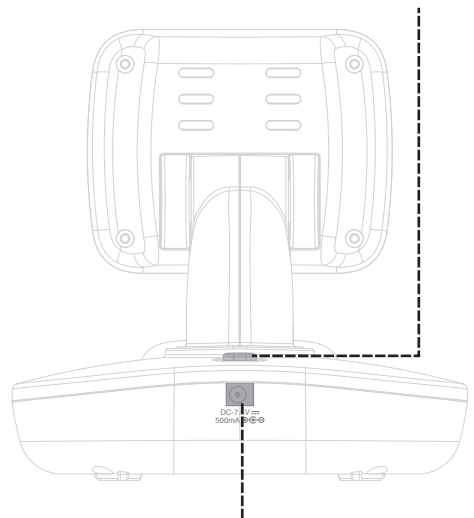

**AC Adapter Jack**

# Features • Monitor

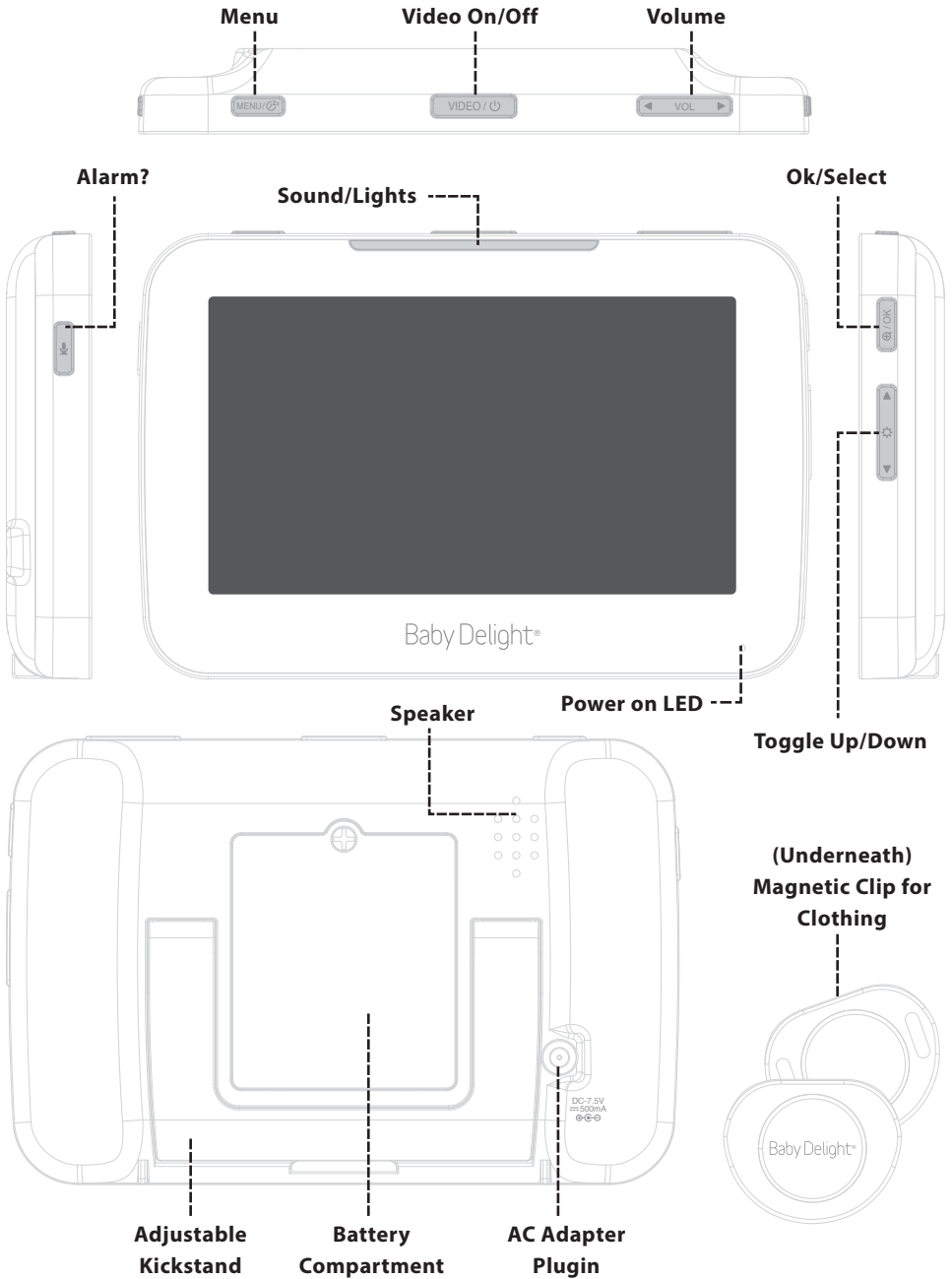

**NOTE:** There is no need to pair any of the components. The Camera, Monitor and Movement Unit have all been synched at the factory.

# Camera Setup • Adult Assembly Required

There is no need to pair any of the components. The Camera, Monitor and Movement Unit have all been synched at the factory.

## 1 WALL MOUNT: Place camera in desired location

Determine a location for the Camera that will provide the best view of your baby in the crib. Place the Camera on a flat surface, such as a dresser, bureau or shelf. **NEVER** place Camera or cords within **3 feet** of the crib

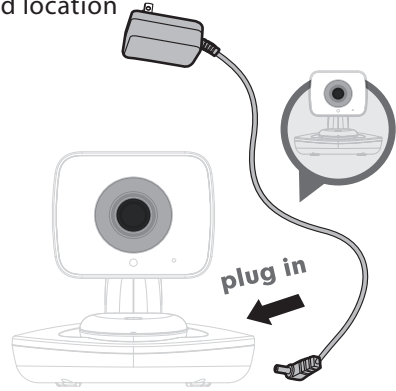

## 2 Place camera in desired location

**IMPORTANT**

mount  
at least  
3ft. from  
crib



Pre-drill a hole in the wall using 3/16", 4.8mm, drill bit. (drill bit and drill not included)

## 3

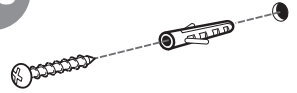

## 4

Tighten screw until only 1/4" (6.3mm) of the screw is exposed.

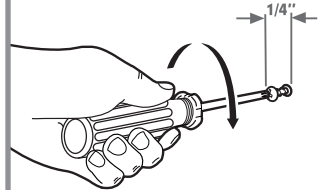

(screwdriver not included)

## 5

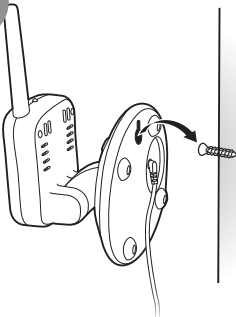

## WARNING:

**STRANGULATION HAZARD** - Children have **STRANGL**ED in cords. Keep this cord out of reach of children (more than 3 feet (0.9 m) away from the crib). Never use extension cords with AC adapters. Only use the AC adapters provided.



- 6** Secure the cord to the wall using the 6 Security Clips included to keep cord away from baby's reach.

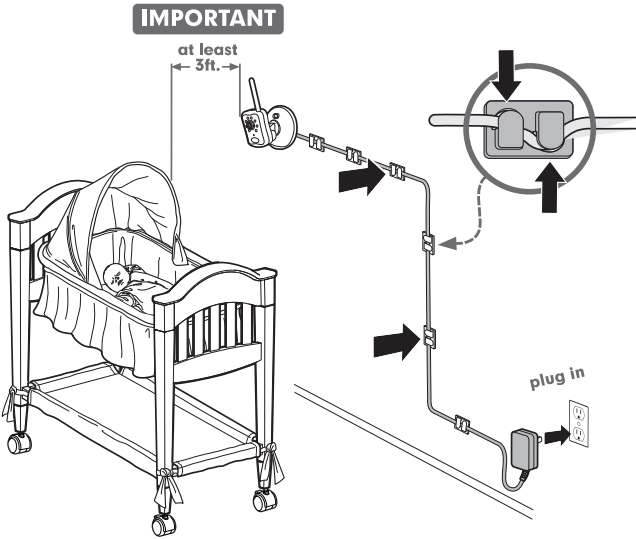

**7**

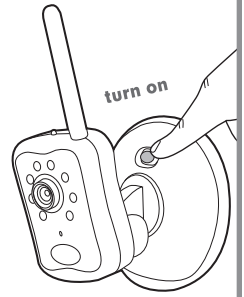

Be sure to test reception and Camera positioning

- 6** TABLE TOP: Place camera in desired location, secure cord, and turn on.

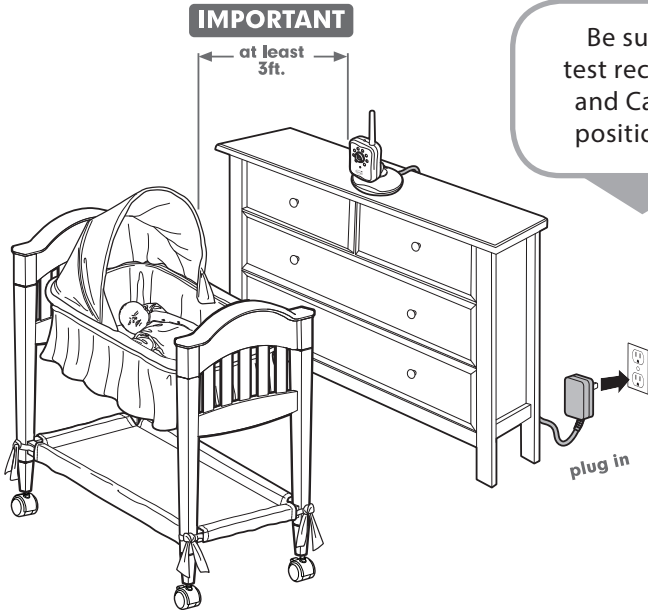

Be sure to test reception and Camera positioning.

Be sure to test your Monitor's reception before initial use. We also recommend testing your Monitor's reception periodically.

**PLEASE KEEP IN MIND THAT THE 5" AUDIO, VIDEO, & MOVEMENT MONITOR WILL NOT PROVIDE THE SAME LEVEL OF PICTURE QUALITY AS YOUR TELEVISION WITH CABLE, SATELLITE DISH, OR DIGITAL SERVICE.**

## Movement Unit Setup • Adult Assembly Required

The Movement Unit will transmit movement info and baby's orientation (side, stomach and back) to the Camera. The Camera will transit this information to the Monitor and display that information on the screen. For best results, make sure the Movement Unit is within 30 feet of the Camera.

- 1 ATTACHING MOVEMENT UNIT:** Place the top of The Movement Unit with logo facing UP and slip the magnetic bottom unit behind the clothing with the magnets away from baby.

The two pieces should connect together with the clothing in the middle.

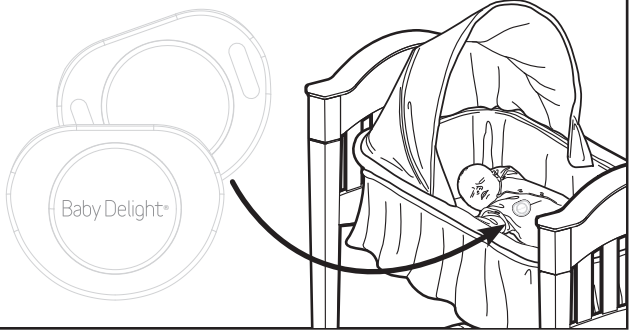

- 2** Press the power button on the front of the Movement Unit for 3 seconds to power on. You should see movement info and orientation of the baby (side, back, stomach) on the screen.

Research shows that sleeping on their back is the safest position for babies.

SIDE



STOMACH



BACK



## Movement Unit Icon Status

LoBatt Movement Icon – This means the Movement Unit needs to be charged. The Movement Unit will flash an amber light and you will hear a single beep on the Monitor. The Movement Unit can be re-charged on the camera (takes approximately 3 hours) in the dock. The Movement Unit has a battery life of approximately 24 hours of continuous use.



Low  
Battery

Charging Icon – This means the Movement Unit is currently in the recharging dock in the Camera and is charging.



No signal icon – This means the Movement Unit is out of range or powered off while not charging in the dock. Please locate the movement unit and place it in the charging dock on the Camera or move the Movement unit closer to the Camera. You will hear a single beep on the Monitor as well.



Disabled Icon – This means the user has disabled the Movement unit. You can choose NOT to show the movement info and position info on the Monitor screen. This also disables all alarms on the Monitor. The Movement Unit will still alarm if no movement is detected for 15 seconds.



## To Disable the Movement & Orientation Information

To disable the movement and orientation information from being displayed on the screen, use the following steps. PLEASE NOTE: This also disables all alarms on the Monitor.

Press the Menu button on the Monitor. Locate the Monitor icon and use the Up button to move to the DISPLAY ICON and press OK.

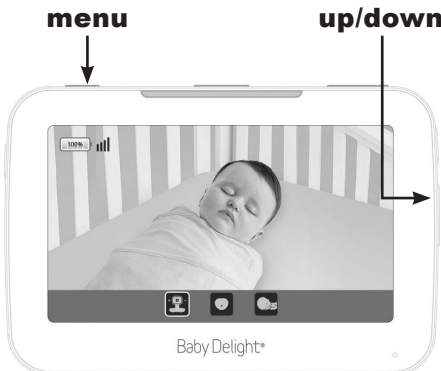

Screen will display (show screen) TURN MOVEMENT INFO AND ALARM OFF (YES OR NO). Use the side button to move to YES or NO and hit OK.





**Alarm Icon** – After no movement has been detected for 15 seconds, the Monitor will begin to beep. After 20 seconds of no movement detected, the Alarm icon will appear on the Monitor screen and the Monitor will beep rapidly.



**Pause Icon** – Pressing the Pause button on the Monitor when the Alarm Icon is on the screen and the Monitor is alarming will silence the Alarm for 15 seconds. After 15 seconds, if there is still no movement detected, the alarm will resume.

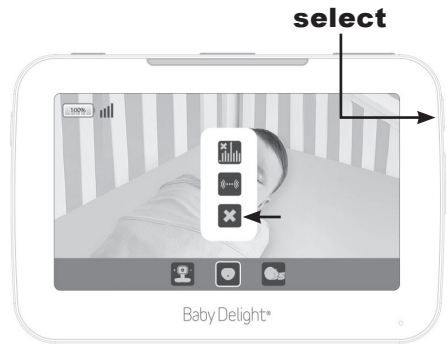

## Trouble Shooting

The Camera, Monitor and Movement Unit have all been paired. If any of the components need to be paired, please see below:

### To Pair the Camera and Monitor:

- 1 Place the Monitor and Camera within 3 feet of each other.

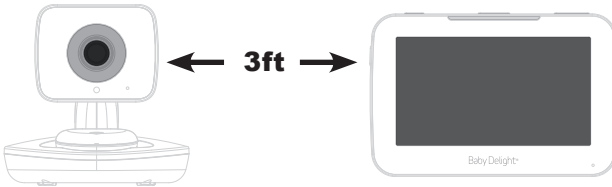

- 2 Power off the Camera and power on the Monitor.

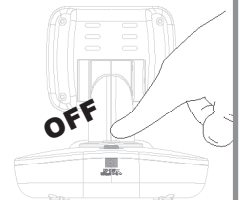

- 3 Press the Menu button on the Monitor and use the side button to move to the CAMERA icon.

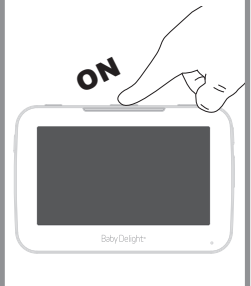
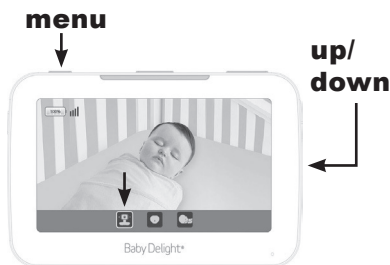

- 4** Use the Up button to move to the PAIRING button and press the OK button.

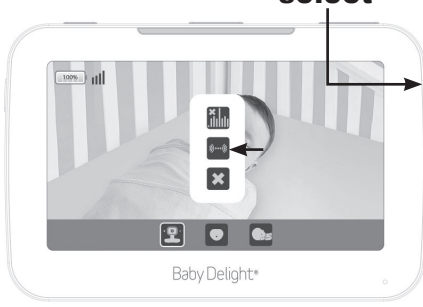

- 5** You should see the PAIRING SCREEN.



- 6** Power the Camera on.

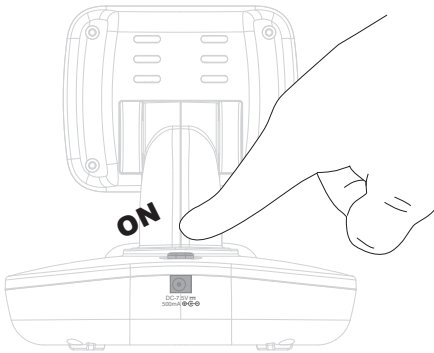

- 7** You should see live video on the Monitor.

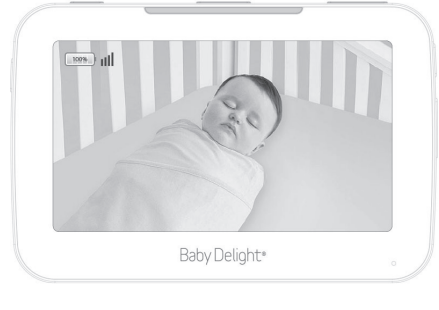

### To Pair the Movement Unit and Camera:

- 1** Place Monitor and Movement Unit within 3 feet of each other. Power off the Movement Unit (hold the power button for 3 seconds) and power on the Camera.



- 2** Press the Menu button on the Monitor and use the side button to move to the Movement Unit icon.



- 3** Use the Up button to move to the PAIRING button and press the OK button. You should see the PAIRING SCREEN.



- 4** Power the Movement Unit on (hold the power button for 3 seconds). You should see movement and orientation information on the Monitor.



---

# Cleaning Information

---

## Care & Cleaning

Caring for your new 5" Audio, Video, Monitor is very easy...

- Simply use a mild soap and damp cloth to wipe down the chair. You may also rinse off the chair outside with a garden hose and allow to air dry. The tray may be rinsed off in the sink and dried prior to use.
- Do not allow the chair to remain outside and exposed to the elements of the sun, wind, and rain for long periods of time. Do not fold up a damp chair or put the chair back into the bag until it is completely dry.

---

## Limited Warranty

---

At Baby Delight, Inc. we make innovative and high quality products for babies, children and their parents. We warrant this product to be free from defects in material and workmanship existing at the time of manufacture for a period of 90-days from the date of initial purchase (sales receipt is required for proof of purchase). If such a defect is discovered during the limited warranty period, we will, at our sole option, repair or replace your product at no cost to you.

This limited warranty does not cover claims resulting from misuse, failure to follow the instructions on installation, maintenance and use, abuse, alteration, involvement in an accident, and normal wear and tear.

For warranty service or replacement part information:

USA: Please call 1-401-597-6868, or write to Consumer Services, 30 Martin St. Cumberland, RI 02864

Some replacement parts may be available for purchase after this limited warranty expires. Please visit us at [www.babydelight.com](http://www.babydelight.com) or call us at 1-401-597-6868 for details.



[www.babydelight.com](http://www.babydelight.com)  
[info@babydelight.com](mailto:info@babydelight.com)

Macari Baby, Inc. 401-333-6800  
30 Martin Street, Cumberland, RI 02864

MADE IN CHINA  
BD04020, BD04010

## **FCC Caution:**

Any Changes or modifications not expressly approved by the party responsible for compliance could void the user's authority to operate the equipment.

This device complies with part 15 of the FCC Rules. Operation is subject to the following two conditions: (1) This device may not cause harmful interference, and (2) this device must accept any interference received, including interference that may cause undesired operation.

## **FCC Radiation Exposure Statement:**

This equipment complies with FCC radiation exposure limits set forth for an uncontrolled environment .This equipment should be installed and operated with minimum distance 20cm between the radiator& your body.

This transmitter must not be co-located or operating in conjunction with any other antenna or transmitter.

## **IC Warning**

(1) this device may not cause interference, and

(2) this device must accept any interference, including interference that may cause undesired operation of the device.

Le présent appareil est conforme aux CNR d'Industrie Canada applicables aux appareils radio exempts de licence. L'exploitation est autorisée aux deux conditions suivantes : (1) l'appareil ne doit pas produire de brouillage, et (2) l'utilisateur de l'appareil doit accepter tout brouillage radioélectrique subi, même si le brouillage est susceptible d'en compromettre le fonctionnement

The device is compliance with RF exposure guidelines, users can obtain Canadian information on RF exposure and compliance.The minimum distance from body to use the device is 20cm.

Le présent appareil est conforme

Après examen de ce matériel aux conformité ou aux limites d'intensité de champ RF, les utilisateurs peuvent sur l'exposition aux radiofréquences et la conformité and compliance d'acquérir les informations correspondantes. La distance minimale du corps à utiliser le dispositif est de 20cm.