

**For FCC statement:**

This equipment has been tested and found to comply with the limits for a Class B digital device, pursuant to part 15 of the FCC Rules. These limits are designed to provide reasonable protection against harmful interference in a residential installation. This equipment generates, uses and can radiate radio frequency energy and, if not installed and used in accordance with the instructions, may cause harmful interference to radio communications. However, there is no guarantee that interference will not occur in a particular installation. If this equipment does cause harmful interference to radio or television reception, which can be determined by turning the equipment off and on, the user is encouraged to try to correct the interference by one or more of the following measures:

- Reorient or relocate the receiving antenna.
- Increase the separation between the equipment and receiver.
- Connect the equipment into an outlet on a circuit different from that to which the receiver is connected.
- Consult the dealer or an experienced radio/TV technician for help.

The FCC requires the user to be notified that any changes or modifications made to this device that are not expressly approved by Company Name may void the user's authority to operate the equipment.

**RF Exposure warning statements:**

This equipment complies with FCC radiation exposure limits set forth for an uncontrolled environment. End users must follow the specific operating instructions for satisfying RF exposure compliance. This transmitter must be at least 20 cm from the user and must not be co-located or operating in conjunction with any other antenna or transmitter.

**For ISEDC statement:**

This device complies with Innovation, Science and Economic Development Canada's licence-exempt RSSs. Operation is subject to the following two conditions:

- (1) This device may not cause interference; and
- (2) This device must accept any interference, including interference that may cause undesired operation of the device.

Cet appareil est conforme aux flux RSS exemptés de licence d'Innovation, Science et Développement économique Canada. L'opération est soumise aux deux conditions suivantes:

- (1) Cet appareil ne doit pas provoquer d'interférence; et
- (2) Cet appareil doit accepter toute interférence, y compris les interférences susceptibles de provoquer un fonctionnement indésirable de l'appareil.

**ISEDC Radiation Exposure Statement:**

Radiation Exposure Statement: This equipment complies with the IC RSS-102 radiation exposure limits set forth for an uncontrolled environment. This equipment should be installed and operated with a minimum distance of 20 cm between the radiator and your body.

Énoncé d'exposition aux rayonnements: Cet équipement est conforme aux limites d'exposition aux rayonnements ioniques RSS-102 Pour un environnement incontrôlé. Cet équipement doit être installé et utilisé avec un Distance minimale de 20 cm entre le radiateur et votre corps.



www.babydelight.com  
info@babydelight.com

Macari Baby, Inc. 401-333-6800  
30 Martin Street, Cumberland, RI 02864

MADE IN CHINA  
BD04020A, BD04010A  
732-BD40200-0700

# Baby Delight® Snuggle Nest Movement & Positioning Video Monitor

Please read the following instructions and warnings carefully.

Keep this instruction manual for future reference.

Tools required (for wall mounting Camera only): Screwdriver and Drill (not included)

**For technical support see back page.**

Adult use only.

**⚠ WARNING:** Adult assembly required. Keep small parts away from children when assembling.

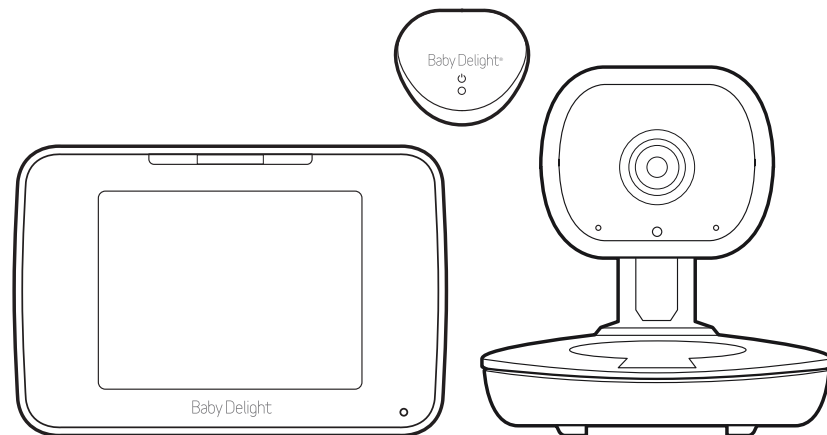

## INSTRUCTION MANUAL

### Warnings & Guidelines:

**⚠ WARNING:** STRANGULATION HAZARD - Keep cord out of baby's reach. NEVER place Camera or cords within 3 feet of the crib. Use enclosed Security Clips to help secure cord away from baby's reach. Never use extension cords with AC Adapters. Only use the AC Adapters provided. Do not remove this tag.

### **WARNING:**

THIS PRODUCT CANNOT REPLACE RESPONSIBLE ADULT SUPERVISION.

- STRANGULATION HAZARD - Keep cord out of baby's reach. NEVER place camera or cords within 3 feet of the crib. Use enclosed Security Clips to help secure cord away from baby's reach. Never use extension cords with AC adapters. Only use the AC adapters provided.
- When an AC adapter is plugged into an electrical outlet, do not touch the exposed end.
- Test monitor before first use, periodically, and when changing location of the Camera.
- Do not use monitor near water (such as bathtub, sink, etc.).
- Keep monitor away from heat sources (such as stoves, radiators, etc.).
- Make sure there is proper ventilation around all monitor components. Do not place on sofas, cushions, beds, etc. which may block ventilation.
- Nursery monitors use public airwaves to transmit signals. This monitor may pick up signals from other monitors or similar devices and signals broadcast by this monitor may be picked up by other receivers.
- This product is not a toy. Do not allow children to play with it.
- This product contains small parts. Adult assembly required. Exercise care when unpacking and assembling the product.

### **BATTERY WARNING:**

- Use only the original rechargeable batteries provided. Please contact Baby Delight, Inc. for replacement batteries. Contact information can be found on bottom of these instructions or on the battery itself.
- Do not mix old and new batteries.
- Do not mix alkaline, standard, or rechargeable batteries.
- Batteries are to be inserted with correct polarity.
- Clean battery and product contacts prior to battery installation.
- Do not short-circuit supply terminals.
- Only the recommended batteries or equivalent are to be used, volts and size.
- Remove the batteries when product is stored for long periods of time or when batteries are exhausted.
- Dispose of exhausted batteries properly.
- Do not recharge non-rechargeable batteries.
- Rechargeable batteries are only to be charged under adult supervision.
- Keep all batteries away from children.

## Limited Warranty

At Baby Delight, Inc. we make innovative and high quality products for babies, children and their parents. We warrant this product to be free from defects in material and workmanship existing at the time of manufacture for a period of 90-days from the date of initial purchase (sales receipt is required for proof of purchase). If such a defect is discovered during the limited warranty period, we will, at our sole option, repair or replace your product at no cost to you.

This limited warranty does not cover claims resulting from misuse, failure to follow the instructions on installation, maintenance and use, abuse, alteration, involvement in an accident, and normal wear and tear.

For warranty service or replacement part information:

USA: Please call 1-401-333-6800, or write to Consumer Services, 30 Martin St. Cumberland, RI 02864

Some replacement parts may be available for purchase after this limited warranty expires. Please visit us at [www.babydelight.com](http://www.babydelight.com) or call us at 1-401-333-6800 for details.

- 4** With the camera powered ON, press the CODE button on the bottom of the Camera.

**code button**

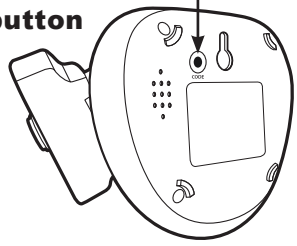

- 5** You should see live video on the Monitor.

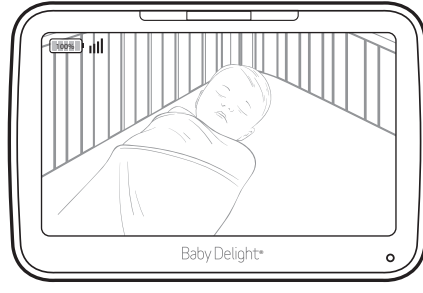

**To Re-Pair the Movement Unit and Camera:**

- 1** Place Monitor and Movement Unit within 3 feet of each other. Power off the Movement Unit (hold the POWER button for 4 seconds) and power on the Camera.

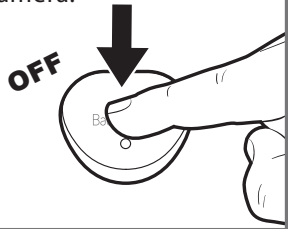

- 2** Press the MENU button on the Monitor and use the RIGHT ► or LEFT ◀ button to move to the Movement Unit icon.

**menu left/right**

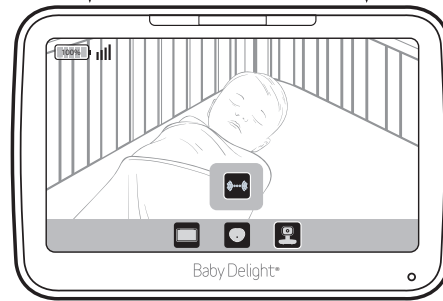

- 3** Press the OK button and you should see the PAIRING SCREEN that will appear for 20 seconds.

**ok**

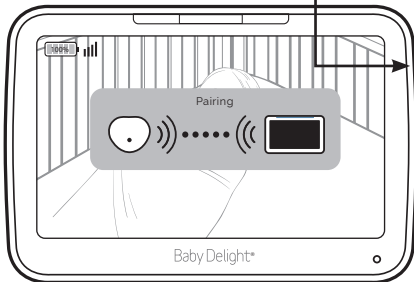

- 4** Power the Movement Unit on (hold the POWER button for 4 seconds). You should see movement and orientation information on the Monitor.

**ON**

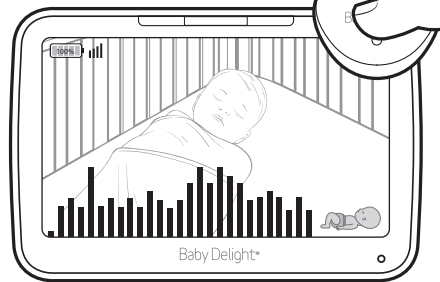

**All Components**

- 1 Camera, 1 Monitor, 1 Movement Unit
- 2 AC Adapters
- 6 Cable Clips
- 1 Anchor and Wall Mount Screw

**Camera**

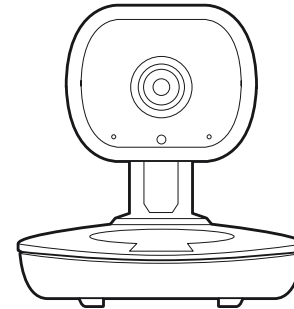

**Movement Unit**

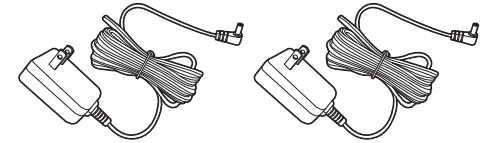

**AC Adapters**

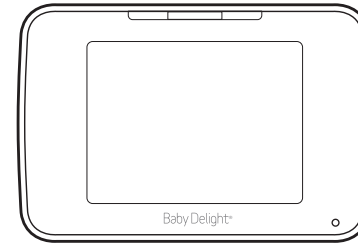

**Monitor**

**Hardware**



**X1**



**X1**

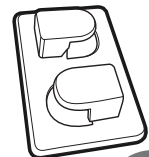

**X6**

**Features • Camera**

**Power On LED**

**Lens**

**Microphone**

**Power On/Off**

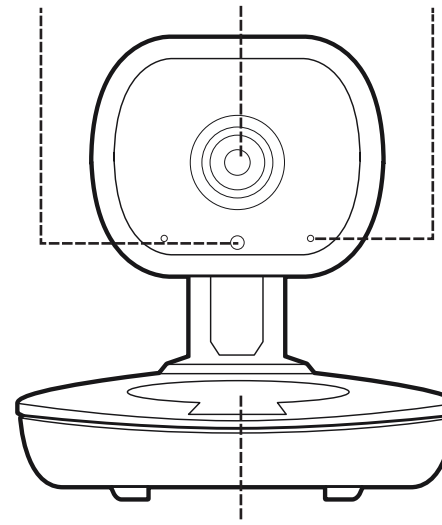

**Movement Unit Charging Station**  
(Place Movement Unit in this to charge)

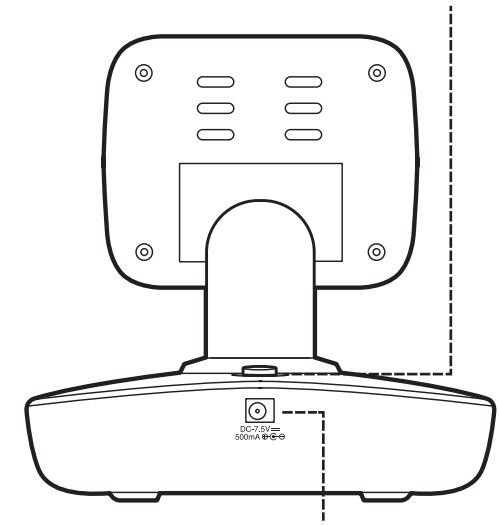

**AC Adapter Jack**

## Features • Monitor

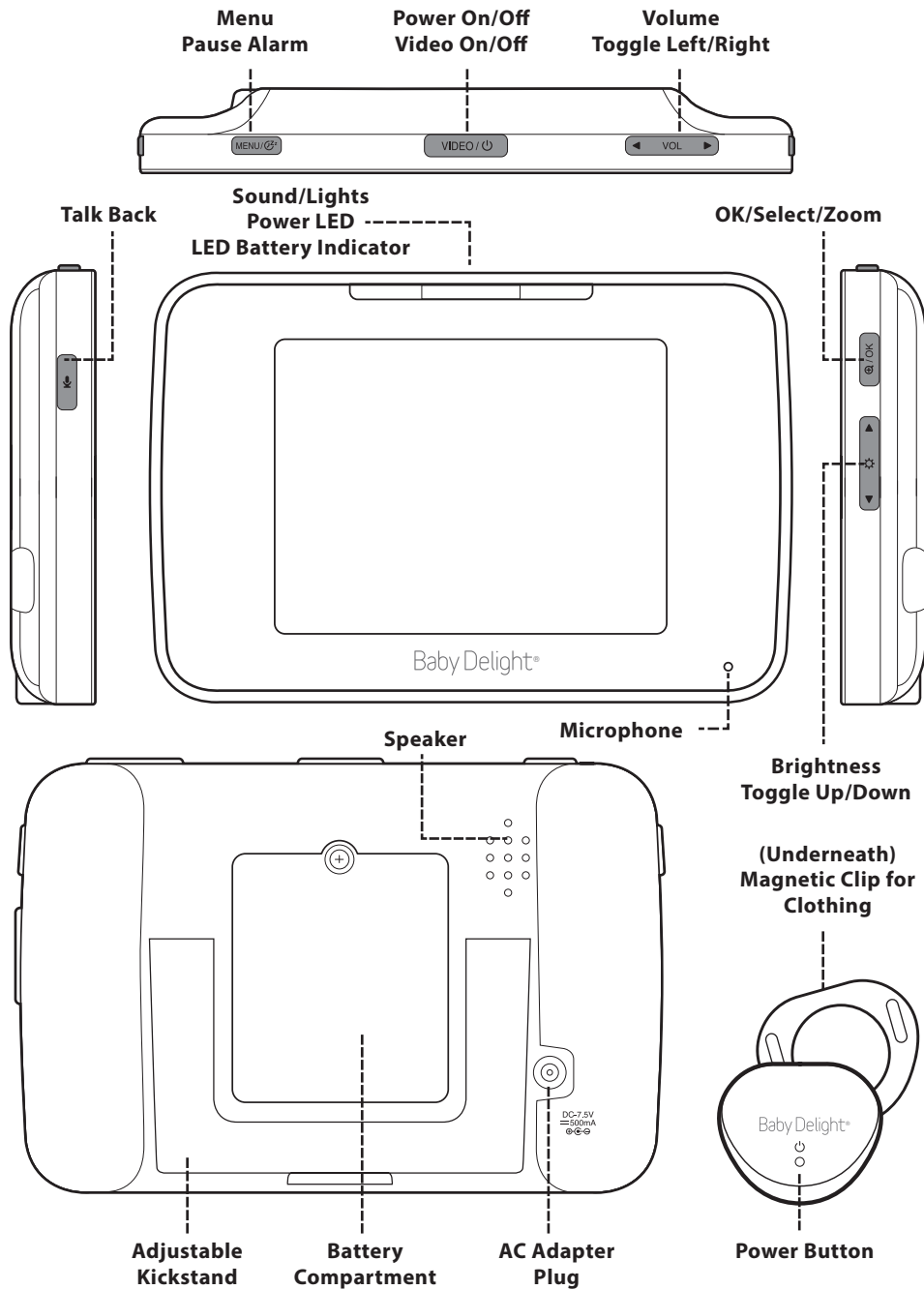

**Alarm Icon** – After no movement has been detected for 15 seconds, the Monitor will begin to beep. After 20 seconds of no movement detected, the Alarm icon will appear on the Monitor screen and the Monitor will beep rapidly.

**Pause Icon** – Pressing the Pause button on the Monitor when the Alarm Icon is on the screen and the Monitor is alarming will silence the Alarm for 15 seconds. After 15 seconds, if there is still no movement detected, the alarm will resume.

### pause alarm

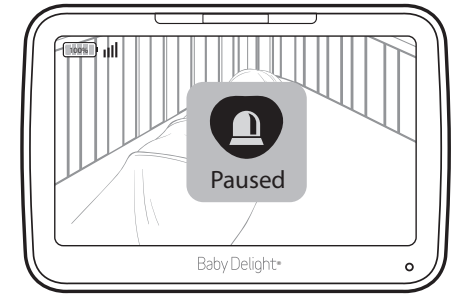
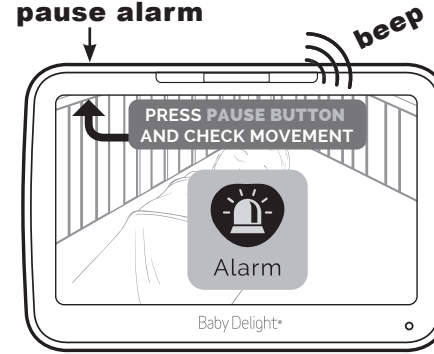

## Trouble Shooting

The Camera, Monitor and Movement Unit have all been paired at the factory. If any of the components need to be re-paired, please see below:

### To Re-Pair the Camera and Monitor:

- 1 Place the Monitor and Camera within 3 feet of each other and power on both units.

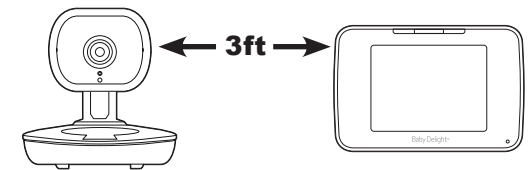

- 2 Press the MENU button on the Monitor and use the RIGHT ► or LEFT ◀ button to move to the CAMERA icon. Press the OK button to start pairing.

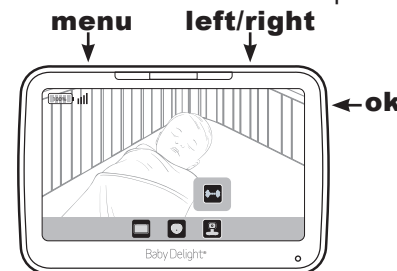

- 3 You should see the PAIRING SCREEN that will appear for 20 seconds.

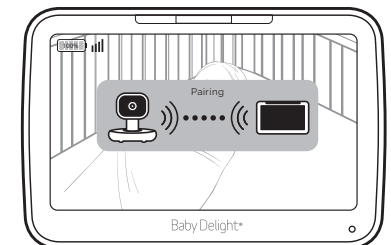

## Movement Unit Icon Status • On Monitor Screen

**Charging Icon** – This means the Movement Unit is currently in the recharging dock in the Camera and is charging. Movement & orientation information is disabled. The Movement Unit will flash an amber or red light every 4 seconds while charging. When fully charged the light will turn green.



**Low Battery Icon** – This means the Movement Unit needs to be charged. The Movement Unit will flash a red light. The Movement Unit can be re-charged on the Camera (takes approximately 6 hours) in the dock. The Movement Unit has a battery life of approximately 96 hours of continuous use.



**No Signal Icon** – This means the Movement Unit is out of range or powered off while not charging in the dock. Please locate the Movement Unit and place it in the charging dock on the Camera or move the Movement Unit closer to the Camera.



**Disabled Icon** – This means the user has disabled the Movement Unit. You can choose NOT to show the movement info and position info on the Monitor screen. This also disables all alarms on the Monitor. The Movement Unit will still alarm if no movement is detected for 15 seconds.



## To Disable the Movement & Orientation Information

To disable the movement and orientation information from being displayed on the screen, use the following steps. PLEASE NOTE: This also disables all alarms on the Monitor.

Press the Menu button on the Monitor. Locate the Monitor icon and use the RIGHT ► or LEFT ◀ button to move to the DISPLAY ICON and press OK.

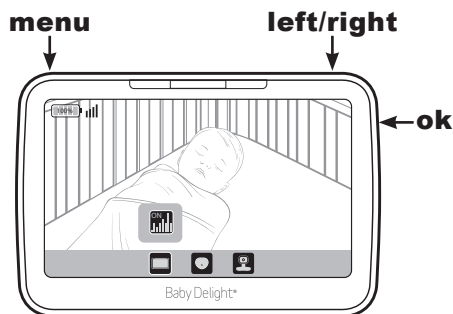

Screen will display TURN MOVEMENT INFO AND ALARM OFF. Use the RIGHT ► or LEFT ◀ button to select ON or OFF and press OK.

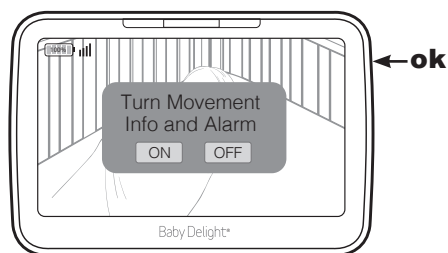

## Camera Setup • Adult Assembly Required

There is no need to pair any of the components. The Camera, Monitor and Movement Unit have all been synched at the factory. If for any reason pairing is lost, please refer to TROUBLESHOOTING section on page 9.

**⚠ WARNING:** **STRANGULATION HAZARD** - Children have STRANGLED in cords. Keep this cord out of reach of children (more than 3 feet (0.9 m) away from the crib). Never use extension cords with AC adapters. Only use the AC adapters provided. Do not remove this tag.

### CAMERA PLACEMENT : ON FLAT SURFACE

- 1** TABLE TOP: Place Camera in desired location, plug in AC Adapter to Camera and turn on.

**⚠ WARNING: 3 FT**

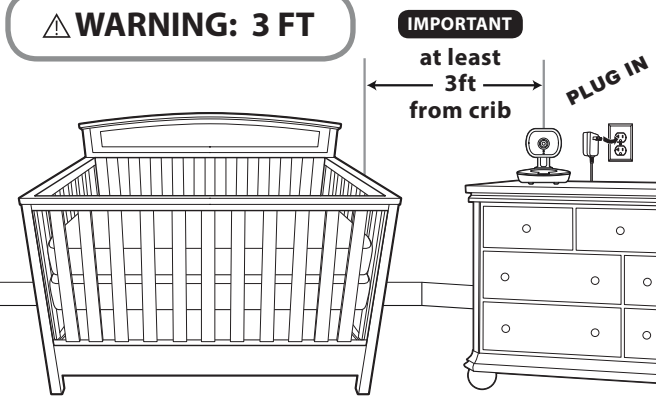

- 2** Plug AC Adapter with Camera Icon into Camera

Be sure to test reception and camera positioning.

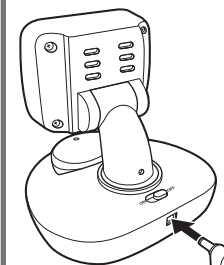

Determine a location for the Camera that will provide the best view of your baby in the crib. Place the Camera on a flat surface, such as a dresser, bureau or shelf. NEVER place Camera or cords within **3 feet** of the crib. Be sure to test reception and Camera positioning.

### CAMERA PLACEMENT: IF WALL MOUNTING

- 1** Place Camera in desired location.

Pre-drill a hole in the wall using 3/16", 4.8mm, drill bit. (Drill bit and drill not included).

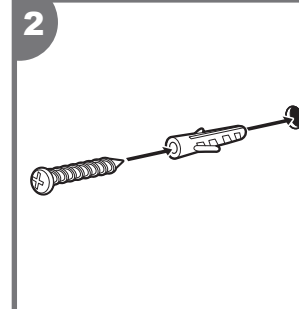
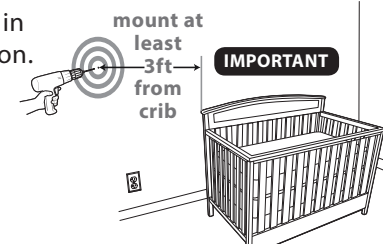

**3** Tighten screw until only 1/4" (6.3mm) of the screw is exposed (screw driver not included).

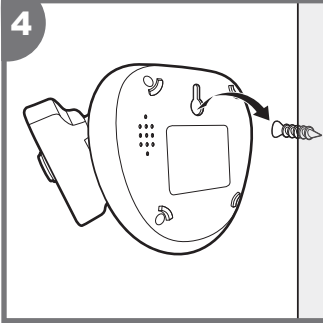
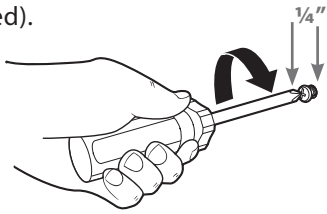

**5** Secure the cord to the wall using the 6 Security Clips included to keep cord away from baby's reach.

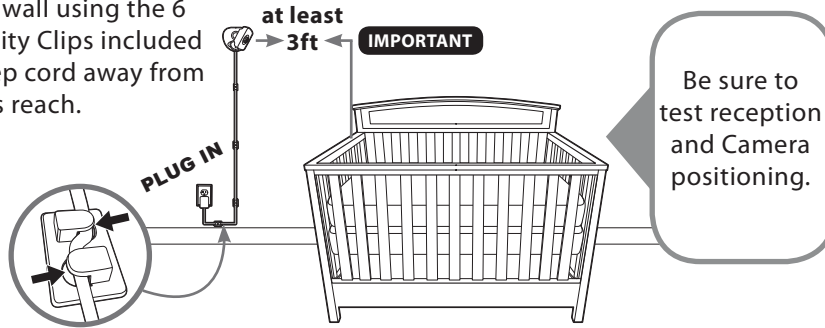

### Monitor Setup • Adult Assembly Required

Plug Monitor AC Adapter into Monitor and hold the power button on top of Monitor for 5 seconds.

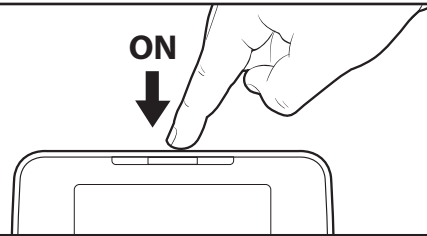

Be sure to test your Monitor's reception before initial use. We also recommend testing your Monitor's reception periodically. **PLEASE KEEP IN MIND THAT THE MOVEMENT & POSITIONING VIDEO MONITOR WILL NOT PROVIDE THE SAME LEVEL OF PICTURE QUALITY AS YOUR TELEVISION WITH CABLE, SATELLITE DISH, OR DIGITAL SERVICE.**

### Movement Unit Setup • Adult Assembly Required

The Movement Unit will transmit movement info and baby's orientation (side, stomach and back) to the Camera. The Camera will transmit this information to the Monitor and display that information on the screen. For best results, make sure the Movement Unit is within 30 feet of the Camera.

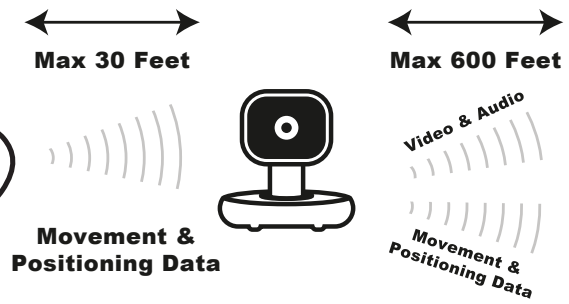

**1** Press the power button on the center top of the Movement Unit for 4 seconds to power on. You should see movement info and orientation of the baby (side, back, stomach) on the monitor screen.

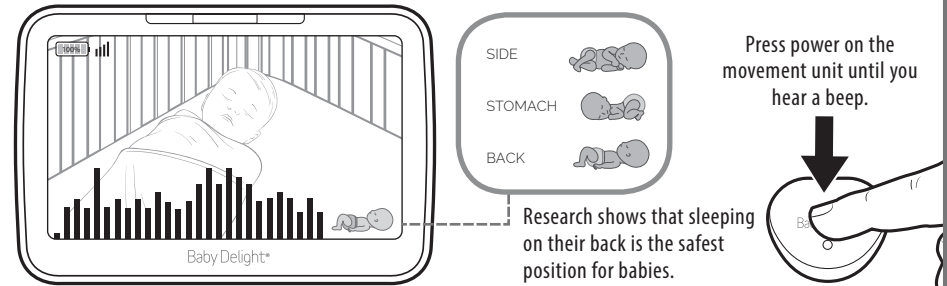

**2** ATTACHING MOVEMENT UNIT: Place the top of the Movement Unit with logo facing UP over baby's clothing and then slip the magnetic bottom unit behind the clothing with the magnets away from baby.

The two pieces should connect together with the clothing in the middle.

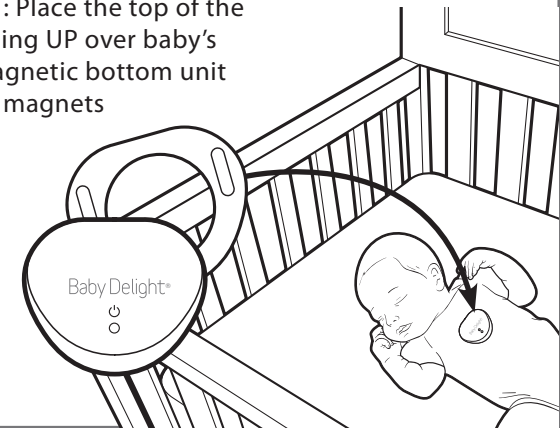

NOTE: FOR BEST RESULTS, THE WEARABLE UNIT SHOULD BE PLACED ON A SNUG-FITTING ONSIE ON THE CENTER OF THE BABY'S CHEST.

The Movement Unit will flash every 10 seconds:  
 Green: Full Battery  
 Amber: Charge Soon  
 Red: Low Battery - Charge Immediately