

WIRELESS DOORBELL INTERCOM

INSTRUCTION MANUAL MODEL:HY767



Hosmart was founded in 2012, the brainchild of a group of friends designed Motola products. Fast forward a few years and we're now the industry leader in home intercom and security products.

Our vision is to create a world global leader in home intercom solutions and products. We design and engineer residential intelligent home solution and intercom systems. Our company philosophy is to direct our efforts based on our client's wishes.

Hope you happiness and enjoy with our products. Any products problem or damage by delivery, we can offer a replacement to you.

If you have more question, you can also
E-mail to us : service@hosmartmall.com
or visit our Hosmart website: www.hosmartmall.com
Or scan the QR scan.



1

Overview

The Intercom has up to a 1500 foot (500 m) range and allows multiple simultaneous conversations, using a 400-470 MHz secure digital radio link. The doorbell intercoms form an exclusive network and respond only to other intercoms in the network.

1. Indoor Bell Intercom system



2. Outdoor Bell Intercom system



2

Operation & Features

1. Indoor Bell intercom

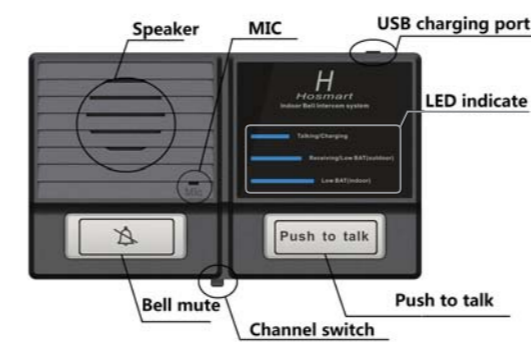

Push to talk Button

To talk, hold down the take button and all the intercoms in the same channel will receive the signal. When you holding down the take button on a different channel. A secure channel is created and the other intercoms in the network don't hear the conversation.

Bell Mute Button

When someone press the Bell Button in outdoor. The indoor bell will ring. Press the Bell Mute button will mute the Bell

3

chime in indoor intercoms.

Channel switch Button

You can select different channel to communicate with different intercoms.
IF YOU WANT TO COMMUNICATE WITH OTHER INTERCOMS. YOU MUST SET ALL THE INTERCOMS IN THE SAME CHANNEL.

USB Charging port (Power DC 5V)

We offer a 5V/1A AC adapter with USB plug in indoor intercom. Our indoor intercoms support both AC adapter and 18650 Li-battery power supply. But only USB AC adapter was included in indoor intercoms.

Talking/Charging LED indicated

When you're talking, the LED will flicker. Or when you charging the indoor intercom, the LED indicated will light.

Receiving/Low BAT(outdoor) LED indicated

When the intercom is receiving. The LED will flicker. Or when the outdoor intercom battery was low. This LED would light.

Low BAT(indoor) LED indicated

The indoor intercom battery was low if you used the 18650 Li-battery as a power supply.

4



Volume control Button

You can use this to adjust the Volume. But only indoor intercoms can support this function.

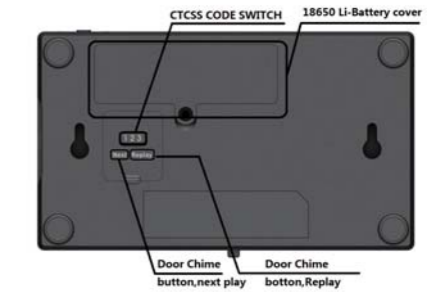

5

Next button

Doorbell chime select, our intercoms can support 20 chimes.

Replay button

Doorbell chime re-play.

CTCSS CODE SWITCH

Unnecessary noises from nearby devices(CTCSS)

1/2/3/ code

If your intercom system setting is at "1" or "3" code and get lot of outside unnecessary voices or noises; you can change your intercom system (all units) to "2" or "3" code to avoid unnecessary noises from nearby devices.

2. Outdoor Bell intercom

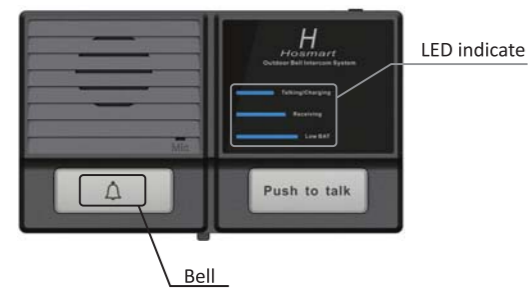

6

A 18650 Li-battery was included in this outdoor intercom. This intercom also can support AC adapter as power supply. Before to mount this outdoor intercom. We need to charge this intercom with 5V/1A AC adapter for 4-5 hours to make sure the Li-battery was full. When it charged, The Talking/charging LED would light. When the Li-battery was full, the Talking/charging LED would turn off.

Push to talk Button

To talk, hold down the take button and all the intercoms in the same channel will receive the signal. When you holding down the take button on a different channel. A secure channel is created and the other intercoms in the network don't hear the conversation.

Bell Button

Push this button, the doorbell Chime will ring in the indoor intercoms.

Channel switch Button

You can select different channel to communicate with different intercoms.
IF YOU WANT TO COMMUNICATE WITH OTHER INTERCOMS. YOU MUST SET ALL THE INTERCOMS IN THE SAME CHANNEL.

USB Charging port (Power DC 5V)

We offer a 5V/1A AC adapter with USB plug in indoor intercom. Our indoor intercoms support both AC adapter and 18650 Li-battery power supply. But only USB AC adapter was included in indoor intercoms.

7

Talking/Charging LED indicated

When you're talking, the LED will flicker. Or when you charging the indoor intercom, the LED indicated will light.

Receiving LED indicated

When this intercom is receiving. The LED will flicker.

Low BAT LED indicated

The outdoor intercom battery was low if you used the 18650 Li-battery as a power supply.

MOUNTING INTERCOMS



Before mounting the outdoor bell, Pls unscrew the battery cover and pick up the piece.

Installation

You can install your intercom almost anywhere with a standard AC outlet. Or you may use 18650 Li-battery if necessary. We have offered the mounting screws in the packages.

8

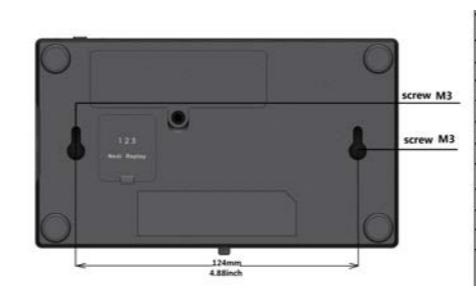

Limited 12 months Warranty

This product is warranted by Seller against manufacturing defects in material and workmanship under normal use for twelve(12) months from the date of purchase from Seller. EXCEPT AS PROVIDED HEREIN,SELLER MAKES NO EXPRESS WARRANTIES AND ANY IMPLIED WARRANTIES,INCLUDING THOSE OF MERCHANTABILITY AND FITNESS FOR A PARTICULAR PURPOSE,ARE LIMITED IN DURATION TO THE DURATION OF THE WRITTEN LIMITED WARRANTIES CONTAINED HEREIN. EXCEPT AS PROVIDED HEREIN,SELLER SHALL HAVE NO LIABILITY OR RESPONSIBILITY TO CUSTOMER OR ANY OTHER PERSON OR ENTITY WITH RESPECT TO ANY LIABILITY,LOSS OR DAMAGE CAUSED DIRECTLY OR INDIRECTLY BY USE OR PERFORMANCE OF THE PRODUCT OR ARISING OUT OF ANY BREACH OF THIS WARRANTY,INCLUDING,BUT NOT LIMITED TO ANY DAMAGES RESULTING FROM INCONVENIENCE,LOSS OF TIME,DATA, PROPERTY,REVENUE,OR PROFIT OR ANY INDIRECT,SPECIAL, INCIDENTAL,OR CONSEQUENTIAL DAMAGES,EVEN IF SELLER

9

HAS BEEN ADVISED OF THE POSSIBILITY OF SUCH DAMAGES.

In the event of a product defect during the warranty period, take the product and the sales receipt as proof of purchase date to Seller.Seller will,at its option:

- (a)correct the defect by product repair without charge for parts and labor;
- (b)Replace the product with one of the same or similar design;
- (c)Or refund the purchase price. All replaced parts and products, and products on which a refund is made,become the property of Seller.

New or reconditioned parts and products may be used in the performance of warranty service.Repaired or replaced parts and products are warranted for the remainder of the original warranty period.You will be charged for repair or contact us: Customer service
E-mail:service@hosmartmall.com
Fax number:(852)2331 6834

In case,if you need to return package to us,please write down the RMB#and returning date outside the mailing box.This will speed up our process to handle your returned package and refund or send replacement to you in a short time.

Thanks a lot.

Replacement of the product made after the expiration of the warranty period.

This warranty does not cover:(a)damage or failure caused by or attributable to acts of God,abuse,accident,misuse, improper abnormal usage,failure to follow instructions, improper installation or maintenance,alteration,lightning or

10

other incidence of excess voltage or current;(b)any repairs other than those provided by a Seller ,(c)consumables such as fuses or batteries;(d)cosmeimeric damage;(e)transportation, shipping or insurance costs;or (f)costs of product removal, installation,set-up service adjustment or reinstallation.

We hope you to have pleasant shipping experience with us. We would be appreciated to receive your comment or any dissatisfaction with your purchase,please contact us prior to leave us feedback.We guarantee your completed satisfaction for this transaction.

Please kindly note that our office hour is:
9:00 a.m.to 5:00 p.m.(GMT+8) Monday to Friday.
Office closes on Saturday,Sunday and public holidays.We apologize for any late reply of your E-mail during holidays.

U.S. Warehouse (return address):
4070 Mission Blvd Montclair CA
91763
United states
Vingoo 1039

This product produced by
Macross Microelectronics (HK) LIMIT
FLAT/RM KY001 UNIT 3 27/F HO KING COMM CENTRE
NO.2-16FA YEEN STREET MONGKOK KL
EMAIL:service@hosmartmall.com
TEL:00852-2331 6833

Scan Here for Customer Service



11

FCC Statement

This device complies with Part 15 of the FCC rules. Operation is subject to the following two conditions: 1) this device may not cause harmful interference, and 2) this device must accept any interference received, including interference that may cause undesired operation.

Note: This equipment has been tested and found to comply with the limits for a Class B digital device, pursuant to part 15 of the FCC Rules. These limits are designed to provide reasonable protection against harmful interference in a residential installation.

This equipment generates uses and can radiate radio frequency energy and, if not installed and used in accordance with the instructions, may cause harmful interference to radio communications. However, there is no guarantee that interference will not occur in particular installation. If this equipment does cause harmful interference to radio or television reception, which can be determined by turning the equipment off and on, the user is encouraged to try to correct the interference by one or more of the following measures:

- Reorient or relocate the receiving antenna.
 - Increase the separation between the equipment and receiver.
 - Connect the equipment into an outlet on a circuit different from that to which the receiver is connected.
 - Consult the dealer or an experienced radio/TV technician for help.
- Changes or modifications not expressly approved by the party responsible for compliance could void the user's authority to operate the equipment.

This equipment complies with FCC radiation exposure limits set forth for an uncontrolled environment. User should avoid un-intended operation of usage when it is collocated with other transmitters or antenna.
The device must be installed to provide a separation distance of at least 20 cm from user's body during normal operations.