

封底

封面

正面

A letter from eMACROS



A letter from eMACROS

Dear customers,
Thank you for choosing eMacros, we provide lifetime warranty and technical support for our customers. If you have any problems, please contact us by navigating to: www.emacros.com, then click **Contact Us**, we will assist you as soon as possible.

You can also email us :
macross.service@outlook.com
Or Search for @emacros to find our page and get a rapid response service.
<https://www.facebook.com/emacrossofficial/>
We guarantee your complete satisfaction for this purchase.

Best regards,
eMACROS Service Team

Are you happy with our product? 😊
Please text: Hi eMacros, I like it, my order number is *** to our email: macross.service@outlook.com or contact us via Facebook page : @emacross, you will enjoy our VIP treatment.
🎁 Free trial on our new products
👑 VIP only coupon an promotions
🎁 Free birthday gift for VIP

Not happy? 😞
Please contact us if you have any concerns about the product, prior to leaving any online feedback, so that we may address your concern as quickly as possible. Our customer service support will work hard to put a smile back in your face.
🔄 Resend one new replacement
💰 100% full refund

FCC Statement

This equipment has been tested and found to comply with the limits for a Class B digital device, pursuant to Part 15 of the FCC Rules. These limits are designed to provide reasonable protection against harmful interference in a residential installation. This equipment generates uses and can radiate radio frequency energy and, if not installed and used in accordance with the instructions, may cause harmful interference to radio communications. However, there is no guarantee that interference will not occur in a particular installation. If this equipment does cause harmful interference to radio or television reception, which can be determined by turning the equipment off and on, the user is encouraged to try to correct the interference by one or more of the following measures:

- Reorient or relocate the receiving antenna.
 - Increase the separation between the equipment and receiver.
 - Connect the equipment into an outlet on a circuit different from that to which the receiver is connected.
 - Consult the dealer or an experienced radio/TV technician for help.
- This device complies with part 15 of the FCC Rules. Operation is subject to the following two conditions:
(1) This device may not cause harmful interference, and (2) this device must accept any interference received, including interference that may cause undesired operation. Changes or modifications not expressly approved by the party responsible for compliance could void the user's authority to operate the equipment.

1/2 Mile Solar Driveway Alarm

INSTRUCTION MANUAL MODEL:BT274



Note: BT274A is the receiving part of BT274 and BT274B is the transmitting part of BT274.

Thank you for choosing us, we provide lifetime warranty and technical support, if you have any problems, please email us at macross.service@outlook.com.
www.emacros.com

背面

Features

Base station

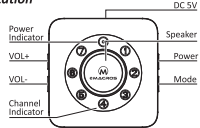

Base Station Functional Description

Power

Press the Power button once to turn on the base station, the red power indicator LED will light up. Press and hold the Power button for 3S to turn off the base station.

Mode(How to change the channel/tone)

Step 1. Press and hold the Mode button for 3S enter the pairing mode.
Step 2. Press the Mode button once to select the channel number during pairing mode.

VOL+/VOL-

Press the VOL+ button to increase the volume level of based station.
Press the VOL- button to decrease the volume level of based station.

Channel Indicators

When motion is detected the corresponding channel LED will flash.

Low Battery prompt

a. When the battery level of Solar Driveway Alarm is low, the base station will prompt the "channel 1 or channel 2/3/4/5/6/7 power low,

please charge".

b. When the battery of base station is low, the red power LED will flash and prompt "base power low".

Note:

a. We recommend using the AC adapter to provide the power supply to Base station and the 4 AA batteries as backup in case of power outage for about 2 weeks.

b. 7 classic melodies optional.

Switch different channels to get a different ringtone

- 1) First, unplugging the power cord or remove a battery from the receiver.
- 2) Plugging in the receiver while long pressing POWER, you will hear 3 beeps, all memory is cleared.
- 3) Holding the "mode" button until a number selection flashes.
- 4) Single pressing the mode button to the desired chime and then activate a sensor to "set" the chime to that device.

First clear the pairing memory

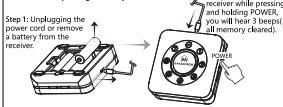

Pair the receiver and sensor

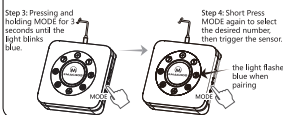

Solar Driveway Sensor

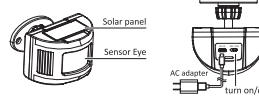

PIR MOTION SENSOR INSTALLATION:

Mount PIR Motion Sensor horizontally on solid surface 3-4 feet(1-1.2 m) off the ground and within 1/2 mile of Base Station (rotate sensor to access screw holes). Unit should be able to swivel as needed.

Note: Keep PIR Motion Sensor away from metal objects. Do not mount PIR Motion Sensor in direct sunlight, near moving tree branches, or in the path of a sprinkler system.



Vehicle Alert Installation: For cars, the best mounting position is about 3-4 feet(1-1.2 m) high and making the sensor within 30 feet from car or people.

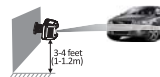

Troubleshooting

1. The base station does not work

Check the AC Adapter of base station if it is ok. Check the Battery might be low and replace it.

2. Short operating range

There might be too many objects between the Base station and the Solar Motion Sensor. Try relocating objects or change the location of the Based station and Sensor.

Check the Battery might be low charge it or contact us to replace with a new sensor.

3. The system is giving false alarms

Check for moving tree branches or insects in the sensor window and remove as necessary. Ensure that sunlight is not shining directly onto the sensor eye.

Technical parameters

- * Wireless Frequency : 433.92MHz FSK
- * Wireless Transmission Range
Driveway Alarm : 1/2Mile
Driveway Alarm detection Range : 30FT (9M)
Driveway Alarm detection Angel : 120°
- * Battery Type
Base Station : 4*1.5V AA Batteries
Solar Driveway Alarm : 3.7V/2200mAh
- * Working Temperature Range
-20°C -- 60°C (-4°F -- 140°F)

展开尺寸 : 360*180mm
成型尺寸 : 90*90mm

