

**ZKT<sub>ECO</sub>**

# User Manual

---

Model: TL300B

Version: 1.0

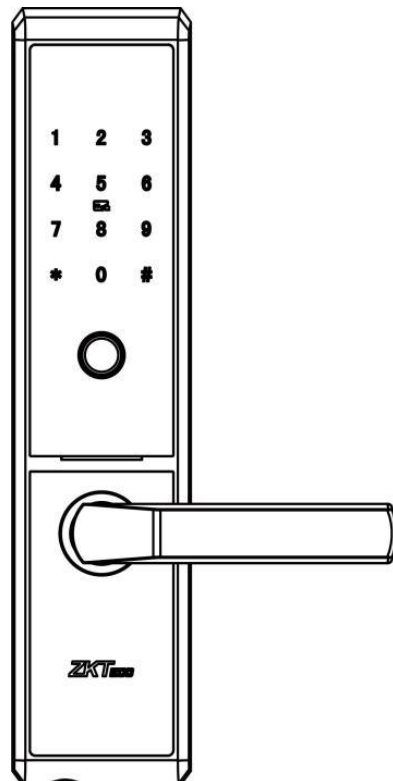

## Table of Contents

<b>Important Notes</b> .....	1
<b>Product Overview</b> .....	1
<b>Definitions</b> .....	2
<b>How to Use</b> .....	3
Resetting the Lock .....	3
Activating the Lock .....	3
Registering the First Administrator .....	3
Programming the Features through Menu Mode .....	3
<b>Quick Start</b> .....	5
Unlocking Door with Fingerprint.....	5
Unlocking Door with Password.....	5
Unlocking Door with Card .....	5

## Important Notes

1. Factory setting of all new locks allows **ANY** verification to unlock them.
2. At least one administrator must be registered prior to any other programming of the lock.
3. The lock is also equipped with mechanical keys for manual unlocking. Please keep the mechanical keys at a safe place.
4. Eight alkaline AA batteries (not included) are required to power on the lock. Non-alkaline and rechargeable batteries **ARE NOT RECOMMENDED**.
5. Do not remove batteries from the lock when it is working.
6. Batteries must be replaced immediately when the lock prompts the "Low Battery" warning.
7. If you want to use your smart phone to unlock and manage the lock, please download the app of the corresponding lock model you purchased. Search "**ZK SmartKey**" for TL300B and "**ZSmart**" for TL300Z in App Store (iOS) or Google Play Store (Android).

## Product Overview

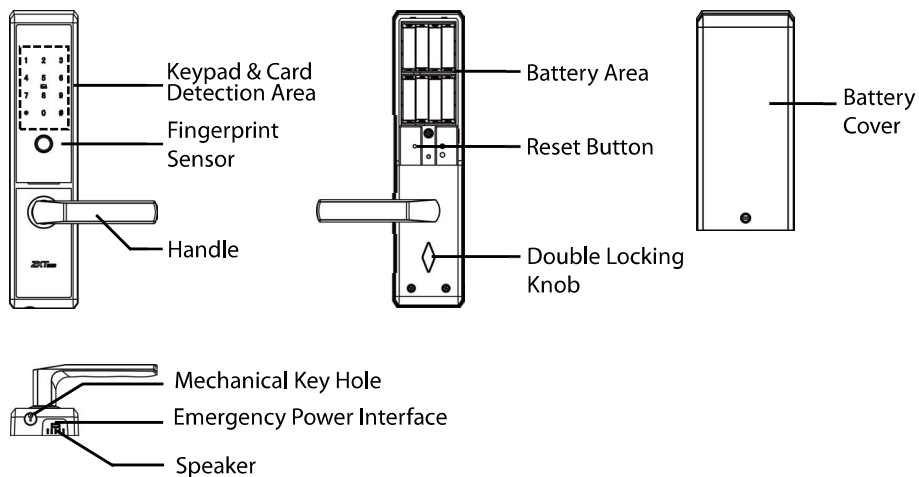

## Definitions

**User Roles:** The lock is designed for two user roles namely Administrator and User. The Administrator group has the permission to enter the menu and open the door, but the User group only has permission to open the door.

**Note:**

- 1) The **maximum capacity** of all the groups is 100. The **maximum capacity of each verification method** (fingerprint/password/card) is 100.
- 2) Each user can register ten fingerprints, one password, and one card.

**Initialization:** All the registered user data will be deleted and restored to the factory setting.

**Random Password:** To protect the password, users may enter their password with random digits before or after the actual password. The maximum number of entered digits must be less than or equal to 32. For example: If the correct password is 123456, then the random password can be 89123456807, 1234562363, 389123456, etc.

**Backup Enrollment:** After the first registration, you can change the registered password and card, or continue to register the remaining fingerprints.

**Volume Setting:** The volume can be set to high/low/silent modes.

**Language Setting:** Select a language from English/Spanish/Portuguese to set the language for voice prompts.

**Always Open Mode:** This function is to keep door always unlocked, which is suitable for the meeting room and other places where there is no restriction in entry and exit.

**Lockout Mode:** When the lockout mode is set, only the administrator can open the door from outside.

**Low Battery Warning:** When the battery power is low, the lock will prompt "Low battery, replace the batteries!" after being started. In this case, you cannot access Main Menu.

**Emergency Charging:** The bottom of the outdoor unit is provided with a Micro-USB interface. Use a power bank to charge the lock when it is out of power.

**Emergency Mechanical Key:** The mechanical key is used to open the door when the lock has electronic malfunction.

**Double Locking:** Double locking prevents the lock from being unlocked from the outside. You can enable it by rotating the double locking knob.

## How to Use

### Resetting the Lock

- 1 Press and hold the **Reset Button**, then touch the keypad, keep holding the **Reset Button** until you hear "Restore to default settings, wait a moment" voice prompt.
- 2 After a few seconds, the lock will prompt "Completed".

### Activating the Lock

Touch the keypad with the back of your hand or fingers to activate the lock.

### Registering the First Administrator

- 1 Touch the keypad to activate the lock.
- 2 Press the **0** and **#** keys to access the menu.
- 3 Enter a new **three-digit** user number e.g. 001.
- 4 Press fingerprint thrice, or enter a **six-digit** password twice, or swipe card.
- 5 Press the **\*** key to complete registration or press the **#** key to continue registering another administrator.

### Programming the Features through Menu Mode

- 1 Touch the keypad to activate the lock.
- 2 Press the **0** and **#** keys to access the menu.
- 3 Verify the administrator using fingerprint, or card, or enter password and press the **#** key to confirm.
- 4 Enter the digit corresponding to the function to be performed by following the voice guide.

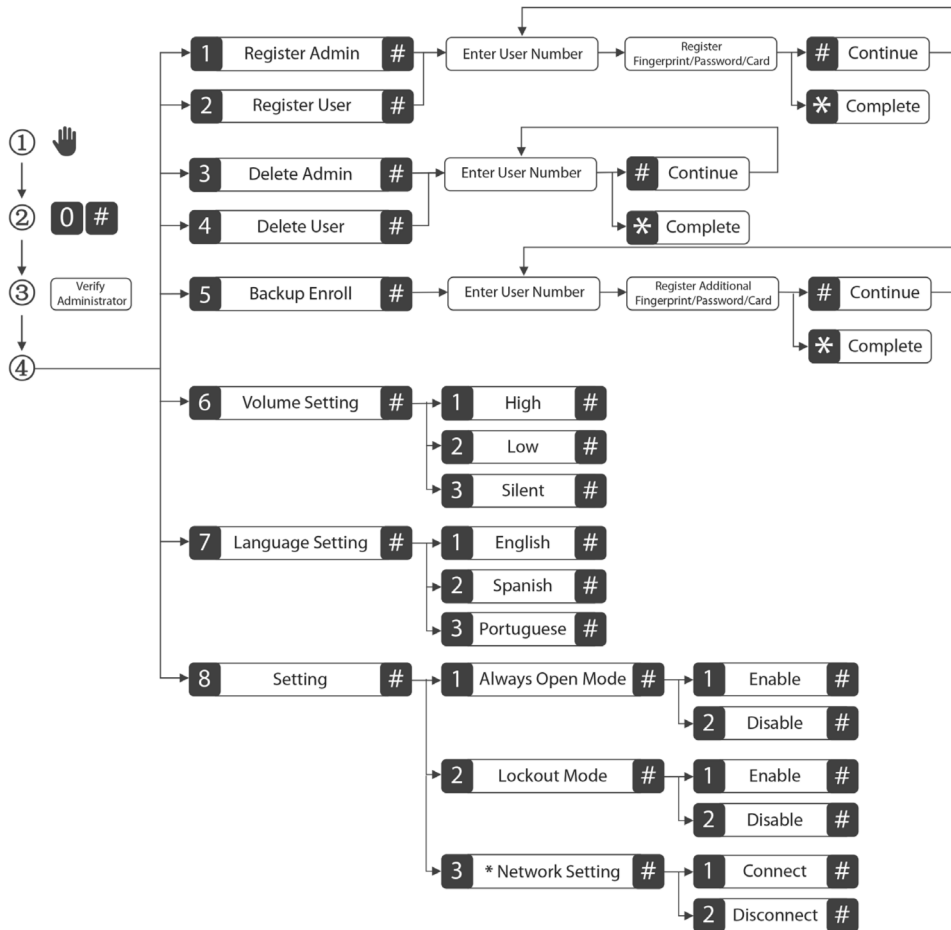

**Note:**

- 1) The registered password must be **six digits**.
- 2) If you try to register the same fingerprint/password/card again, the lock will prompt "Already Used!".
- 3) The currently logged-in administrator cannot delete himself.
- 4) Always Open Mode and Lockout Mode cannot be enabled at the same time. When you enable one of the two modes, the previously enabled mode will be automatically cancelled.

## Quick Start

**⚠ Attention:** If the verification is failed for five times, the lock will generate an alarm.

### Unlocking Door with Fingerprint

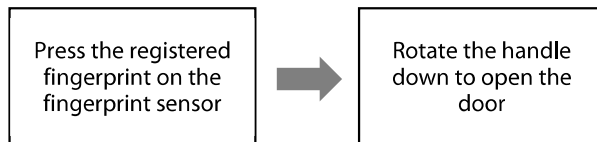

### Unlocking Door with Password

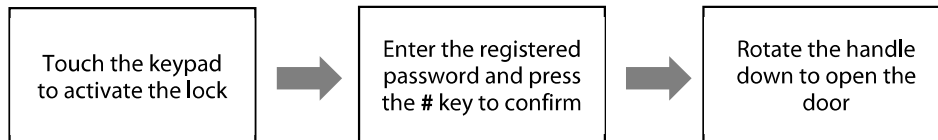

**Note:** Users may enter random password to prevent any person from observing the password. The maximum length of random password is 32 digits.

### Unlocking Door with Card

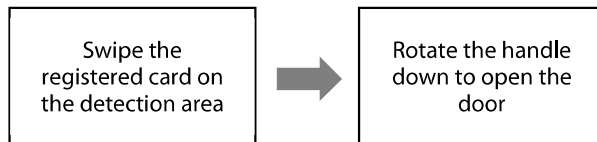

Frequency bands	Maximum output power
BLE(EIRP)2402-2480MHz	3.14dBm
13.56MHz	N/A



**Warning:**

This device complies with Part 15 of the FCC Rules. Operation is subject to the following two conditions: (1) This device may not cause harmful interference, and (2) this device must accept any interference received, including interference that may cause undesired operation.

This equipment has been tested and found to comply with the limits for a Class B digital device, pursuant to Part 15 of the FCC Rules. These limits are designed to provide reasonable protection against harmful interference in a residential installation. This equipment generates, uses, and can radiate radio frequency energy and, if not installed and used in accordance with the instructions, may cause harmful interference to radio communications. However, there is no guarantee that interference will not occur in a particular installation. If this equipment does cause harmful interference to radio or television reception, which can be determined by turning the equipment off and on, the user is encouraged to try to correct the interference by one or more of the following measures:

- Reorient or relocate the receiving antenna.
- Increase the separation between the equipment and receiver.
- Connect the equipment into an outlet on a circuit different from that to which the receiver is connected.
- Consult the dealer or an experienced radio/TV technician for help.

**IMPORTANT!** Any changes or modifications not expressly approved by the party responsible for compliance could void the user's authority to operate the equipment.

**FCC RF Radiation Exposure Statement:**

1. This Transmitter must not be co-located or operating in conjunction with any other antenna or transmitter.
2. This equipment complies with RF radiation exposure limits set forth for an uncontrolled environment.



NO.26,Pingshan 188 Industry zone, Tangxia Town, Dongguan City  
Guangdong Province, China 523728

Tel: +86 755-89602277

Fax: +86 755-89602674

[www.zkteco.com](http://www.zkteco.com)

