

WiFi Smart Devices

User Manual



Ver: 2018-07-26

Setting Jinvio Smart APP

Download or scan the QR code and install the Jinvio smart APP for iOS or Android.

Once download or scan the QR code, the app will ask you to register your device. Enter your phone number or email which ever one makes you feel comfortable and select the country you live in. If phone number selected you will receive a text with a registration code. If you choose email you will then create a password.



Input the Registration Code you received via text if phone method used or create password if email method chosen.

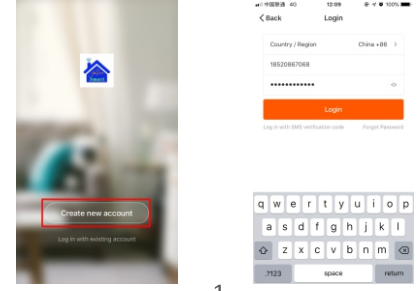

1

How to reset the devices

1. Plug/Outlet Series:

Press the power button keep to 6 seconds to reset the device, the blue indicator light flash is 2 times per second, then it enter Quick Connection Mode.

Under quick connection mode, press the power button keep to 5 seconds to enter AP mode (the blue indicator light flash is 1 times in 2 seconds).

2. LED Bulb Series:
After plug into power, turn on/off the power in 3 times continuously, then bulb will be enter fast flash mode.

Turn on/off the power in 5-6 times continuously till the bulb enter slow flash mode, then you can add devices by AP mode.

3. Wall Switch Series:

Press any one button keep to 6 seconds to reset the device, the blue indicator light flash is 2 times per second, then it enter Quick Connection Mode.

Under quick connection mode, press the power button keep to 5 seconds to enter AP mode (the blue indicator light flash is 1 times in 2 seconds).

4. Curtain Switch Series:

Press any one button keep to 15 seconds to reset the device, the blue indicator light flash is 2 times per second, then it enter Quick Connection Mode.

Under quick connection mode, press the power button keep to 5 seconds to enter AP mode (the blue indicator light flash is 1 times in 2 seconds).

2

Adding a New Device in Quick Connection

* Make sure the Wi-Fi smart device is standby. (the blue indicator light flash is 2 times per seconds) after plug in the socket.

* The smart Wi-Fi devices only supports 2.4GHz Wi-Fi router.

* Open app and click "+" to add device.

* Then click "All devices", choose any a device of them.

* Click "Confirm indicator rapidly blink" (if not, please reset the device).

* Select Wi-Fi network, input Wi-Fi password, connect and click.

* Once connected the app will prompt the connection, and click ok.

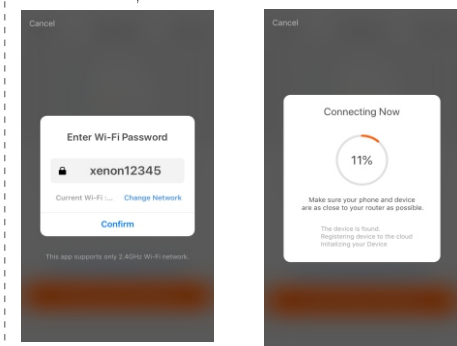

3

Adding a New Device in AP mode

* Make sure the Wi-Fi device is standby (the blue indicator light of Wi-Fi device flashes in 1 times in 2 seconds) after plug in the socket.

* The smart Wi-Fi devices only supports 2.4GHz Wi-Fi router.

* Open app and click "+" to add device.

* Then click "All device", select any a device of them.

* Click "AP Mode", and click "Confirm indicator slowly blink" (If not, please reset the device).

* Click Wi-Fi network, input Wi-Fi password, then "click now" to go to WLAN setting in your smart phone and select the SmartLife xxx for your Wi-Fi.

* on need to input password once you select it.

* Go back to app and app will enter connecting.

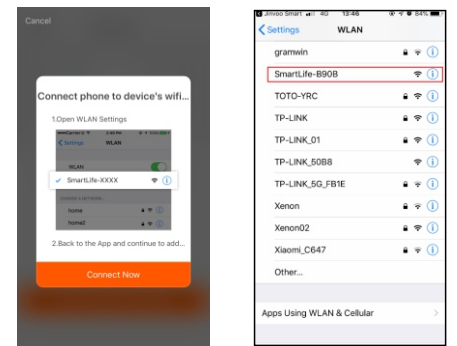

4

FAQ

1. Please check whether device is powered one;

2. Whether phone is connected via Wi-Fi;

3. Whether device is ready for configuration. To get the device ready before configuration, normally you can manually press on the device to get it ready. Please refer to product instructions or Device Reset Instruction for details.

Notice: Each time to add device, reset Wi-Fi to get device ready for configuration and make sure router is working properly.

4. Check routers or related: If router is dual-band router, select 2.4GHz network and add device. you also need to enable router broadcasting function.

Set up wireless router: Set encryption method as WPA2-PSK and authorization type as AES, or set both as auto. Wireless mode cannot be 11n only.

Don't use Chinese to name router Wi-Fi. To stay Strong Wi-Fi signal, please keep device and router within certain distance.

Whether connected devices have reached the Maximum number of router connection. If so, please try by turning off the Wi-Fi connection of some device.

Router wireless MAC filtering function is enabled. Remove the device from the filter list and make sure that router is not prohibiting device from connection.

5. Make sure the password entered in APP is correct when adding new device.

5

Setting Alexa App

1. Open Alexa app and click the button **Home**, then click **Skills** (As below highlighted).

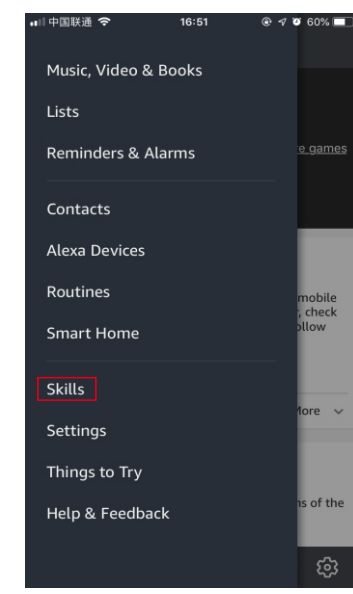

6

2. Input Jinvio Smart to search all column, click search **Q**. (See below highlighted)

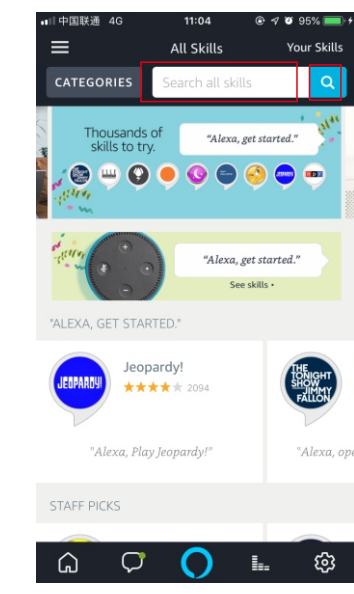

7

3. Click Jinvio Smart **+** and Enter.

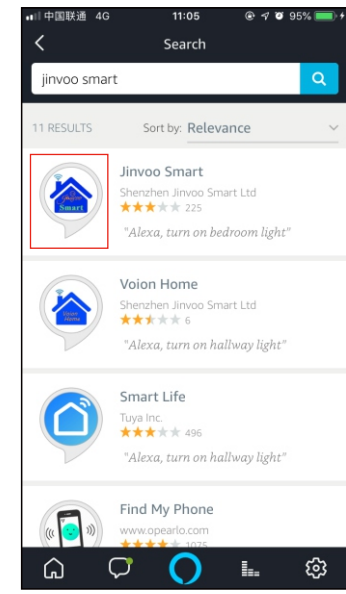

8

4. Click **ENABLE**.

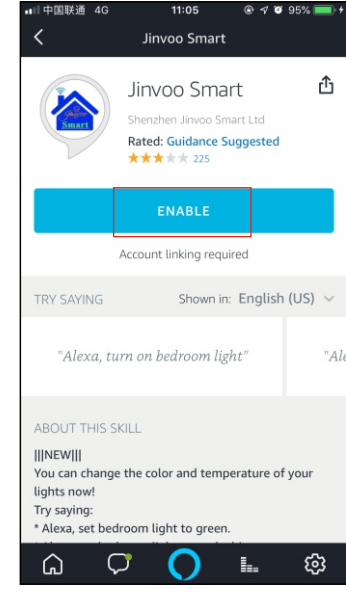

9

5. Select your country **+**, input your Jinvio SmartApp account and password which you have registered. (Attention: this is not the account and password of Alexa App). Click **Link Now**.

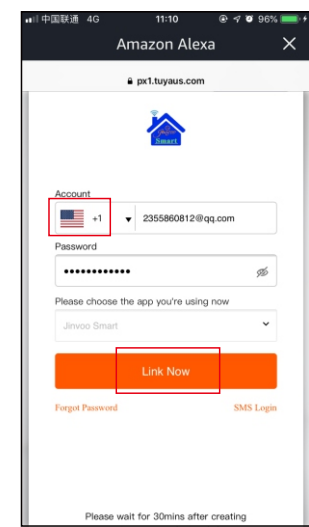

10

6. Click "Authorize", setting finished, Click close **X**.

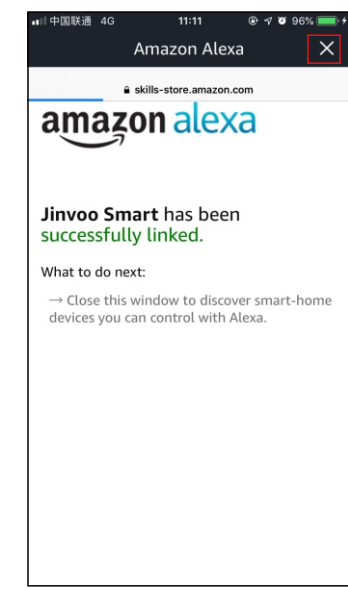

11

7. Back to Menu, click **Home**, and then click **Smart Home**.

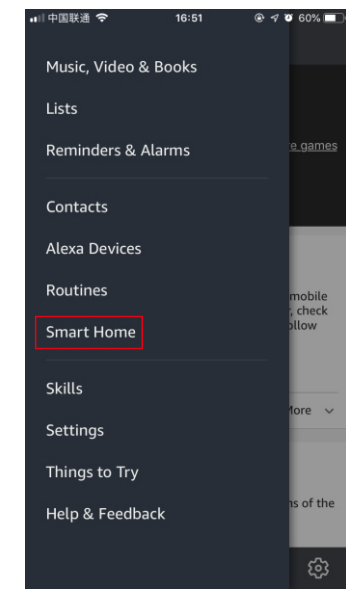

12

8. Scroll down to bottom, click **+** to search.

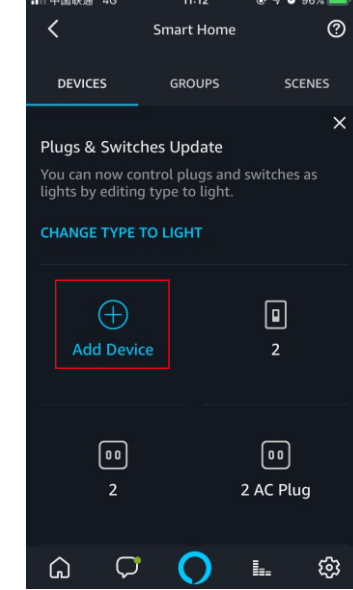

13

9. Search the device **+**.

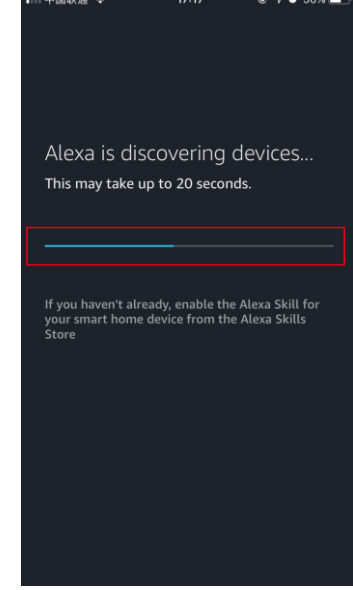

14

10. Find device **+**. Also, you can create a group to control these devices together.

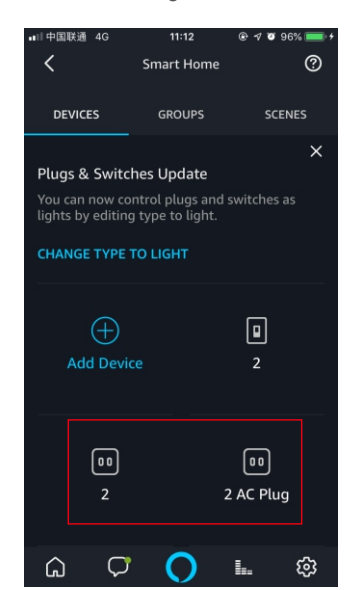

15

Using Google Home to control smart devices

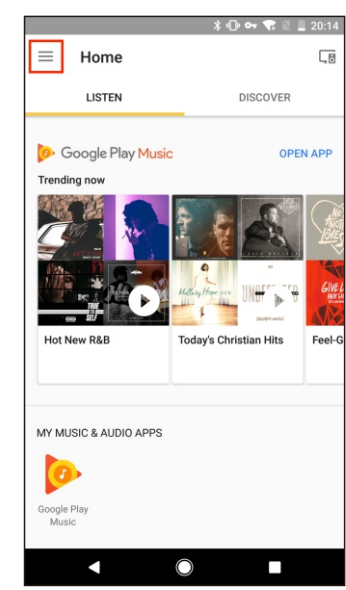

16

1. Tap "Home Control" in the hamburger menu on the Google Home app's home page.

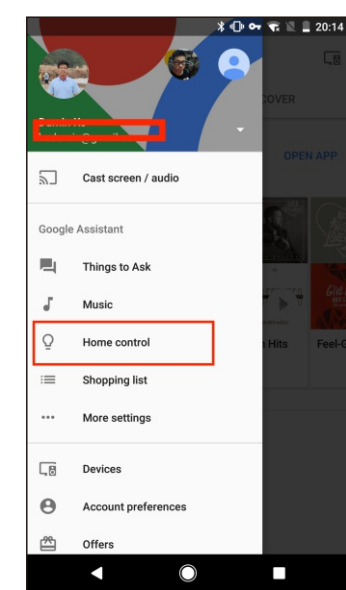

17

2. Then tap "+".

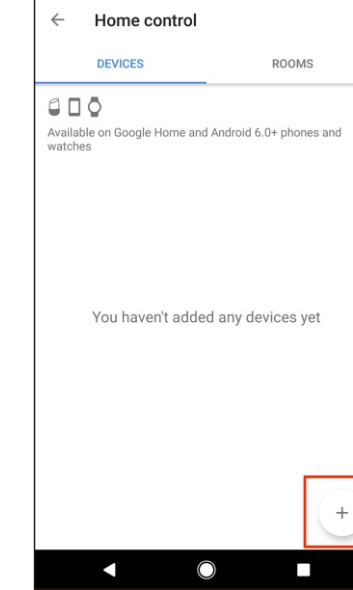

18

3. Find "Jinvio Smart" in the list.

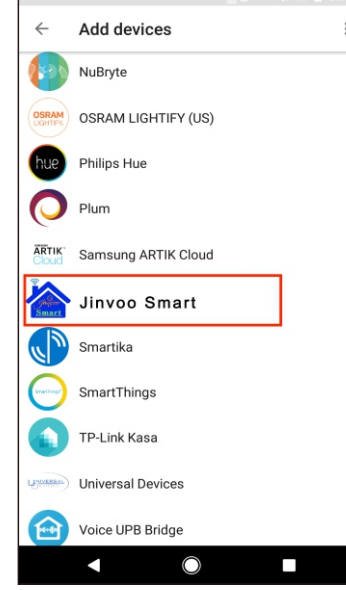

19

4. In the new window, select your Jinvio Smart account's region, type your Jinvio Smart account and password, then tap "Link Now".

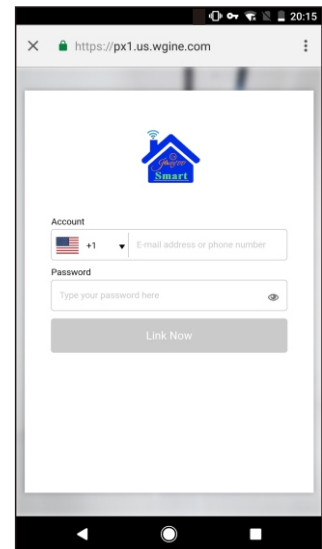

20

5. After you assign rooms for devices.

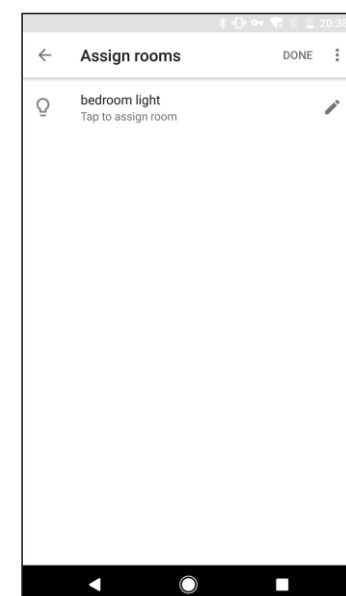

21

6. Your devices will be listed in the Home Control page.

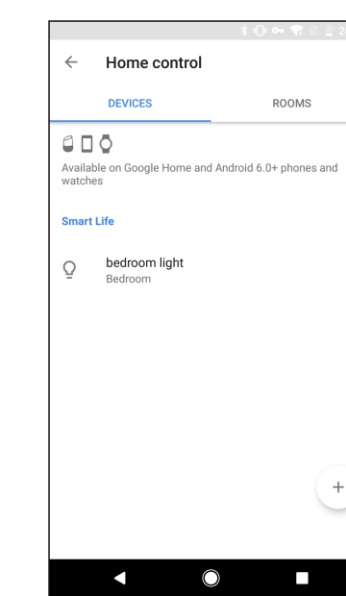

22

Alexa Skills:

Now, you can use Echo to control two different smart plugs. Like Alexa, turn on the living room/Alexa, turn on the dining room. Alexa will turn on different devices separately. When you say Alexa, turn off the living room/Alexa, turn off the dining room. Alexa will turn off the different devices separately.

Google Assistant:

Now you can control your smart devices through Google Home. Take bedroom light as the example, the supported voice commands are as below:

- Ok Google, turn on/off bedroom light.
- Ok Google, brighten bedroom light.
- Ok Google, dim bedroom light.
- Ok Google, set bedroom light to red.

23

FCC Warning

This device complies with part 15 of the FCC rules. Operation is subject to the following two conditions: (1) this device may not cause harmful interference, and (2) this device must accept any interference received, including interference that may cause undesired operation.

Changes or modifications not expressly approved by the party responsible for compliance could void the user's authority to operate the equipment.

NOTE: This equipment has been tested and found to comply with the limits for a Class B digital device, pursuant to part 15 of the FCC Rules. These limits are designed to provide reasonable protection against harmful interference in a residential installation. This equipment generates uses and can radiate radio frequency energy and, if not installed and used in accordance with the instructions, may cause harmful interference to radio communications. However, there is no guarantee that interference will not occur in a particular installation. If this equipment does cause harmful interference to radio or television reception, which can be determined by turning the equipment off and on, the user is encouraged to try to correct the interference by one or more of the following measures:

- Reorient or relocate the receiving antenna.
- Increase the separation between the equipment and receiver.
- Connect the equipment into an outlet on a circuit different from that to which the receiver is connected.
- Consult the dealer or an experienced radio/TV technician for help.

Radiation Exposure Statement

This equipment complies with FCC radiation exposure limits set forth for an uncontrolled environment. This equipment should be installed and operated with minimum distance 20cm between the radiator and your body.