

Bluetooth Blood Pressure Monitor

INSTRUCTIONS FOR USE

1. Download APP.
Scan the QR code below to directly download the APP or download and install it in the application market search "Conmo Health".



Android

IOS

2. Enter the login page to log in/register a user account.
Or select to skip, only the current measurement record can be seen, and the history record cannot be saved.



3. Turn on the Bluetooth function of mobile phone. After wearing the cuff according to the video/instructions, click the blood pressure monitor page on the home page of mobile phone APP, and at the same time press or key of blood pressure monitor to start and pair with the mobile phone. After agreeing to pair, the measurement results are synchronized to the mobile phone APP.

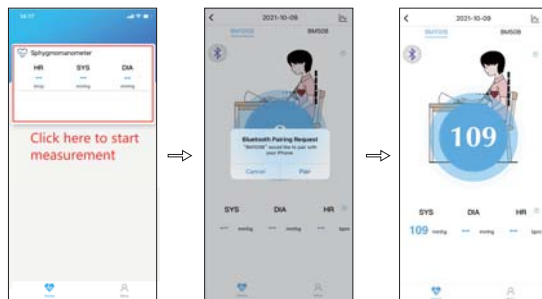

※ **Note:** Press to start up, it will be unable to pair with the mobile phone.

4. If the Bluetooth blood pressure monitor device cannot be found, click the Bluetooth symbol at the upper left corner to refresh the device.



5. The trend icon in the upper right corner allows you to view the user's blood pressure measurement trend/history.



CONMO ELECTRONIC COMPANY LIMITED

[Product Name] _____ Upper Arm Electronic Blood Pressure Monitor

[Manufacturer] _____ CONMO ELECTRONIC COMPANY LIMITED

[Residence] _____ Floor 3 and 4, building 4, Chengnan Industrial Park, Chengguan Town, Xincheng County, Laibin City, Guangxi Province, China

[Production Address] _____ Floor 3, building 4, Chengnan Industrial Park, Chengguan Town, Xincheng County, Laibin City, Guangxi Province, China

[After-sales Service Unit] _____ CONMO ELECTRONIC COMPANY LIMITED

[Contact] _____ 0772-5513028

This device complies with part 15 of the FCC rules. Operation is subject to the following two conditions: (1) this device may not cause harmful interference, and (2) this device must accept any interference received, including interference that may cause undesired operation.

NOTE: The manufacturer is not responsible for any radio or TV interference caused by unauthorized modifications or changes to this equipment. Such modifications or changes could void the user's authority to operate the equipment.

NOTE: This equipment has been tested and found to comply with the limits for a Class B digital device, pursuant to part 15 of the FCC Rules. These limits are designed to provide reasonable protection against harmful interference in a residential installation. This equipment generates uses and can radiate radio frequency energy and, if not installed and used in accordance with the instructions, may cause harmful interference to radio communications. However, there is no guarantee that interference will not occur in a particular installation. If this equipment does cause harmful interference to radio or television reception, which can be determined by turning the equipment off and on, the user is encouraged to try to correct the interference by one or more of the following measures:

- Reorient or relocate the receiving antenna.
- Increase the separation between the equipment and receiver.
- Connect the equipment into an outlet on a circuit different from that to which the receiver is connected.
- Consult the dealer or an experienced radio/TV technician for help.

FCC Caution: Any changes or modifications not expressly approved by the party responsible for compliance could void the user's authority to operate this equipment.