

# Dongguan Lixinwei Electronics Co., Ltd

## Antenna Specification for Approval

Customer Name: Logic Electronics Technology Co., Ltd.

Address: \_\_\_\_\_

Product Name: FPC antenna feed line with a total length of 220 black

Part NO. : C113H-IPXHY2406-220

Write By: Zhou Min

Issued Date: 2022-10-22

### Customer :

| R&D Dept | Business Dept | Approved By |
|----------|---------------|-------------|
|          |               |             |

### Supplier

| R&D Dept | Engineer Dept | Approval |
|----------|---------------|----------|
| Ni Sheng | Zhang Ming    | xiong    |

|    |    |      |    |    |
|----|----|------|----|----|
| 标记 | 次数 | 更改内容 | 签字 | 日期 |
|    |    |      |    |    |

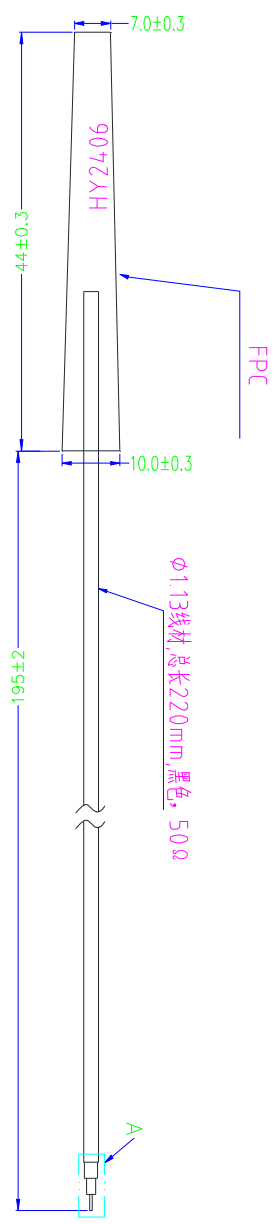

1代端子

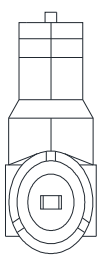

A  
4:1

- 规格说明:
1. 频率范围: 2.4GHz-2.5GHz;
  2. 功率增益: 3.53dB<sub>i</sub>。

|           |                     |        |          |           |              |           |       |
|-----------|---------------------|--------|----------|-----------|--------------|-----------|-------|
| TITLE:    | 天线                  |        |          | MATERIAL: | ??           | FINISH:   | 表面处理  |
| PART/NO.: | C113H-IPXHY2406-220 |        |          | LINEAR ?? | TOLERANCE ?? | ANGULAR?? |       |
| UNIT IN   | mm                  | SCALE: | 2.5:1    | 1.6-3.0   | ±0.10        | X.XX      | ±0.1° |
| 单位        |                     |        |          | 3.0-4.5   | ±0.20        | X.X       | ±0.2° |
|           |                     |        |          | 4.6-100   | ±0.25        |           |       |
|           |                     |        |          | 100       |              |           |       |
| DRAWING   | 数量                  | DATE   | 22-10-15 | CHECKING  | ??           | DATE      | ??    |
| 制图        |                     |        |          | OTHERWISE | ??           | SPECIFIED |       |
|           |                     |        |          | REV       | 01           | 版本        |       |

东莞市利信威电子有限公司

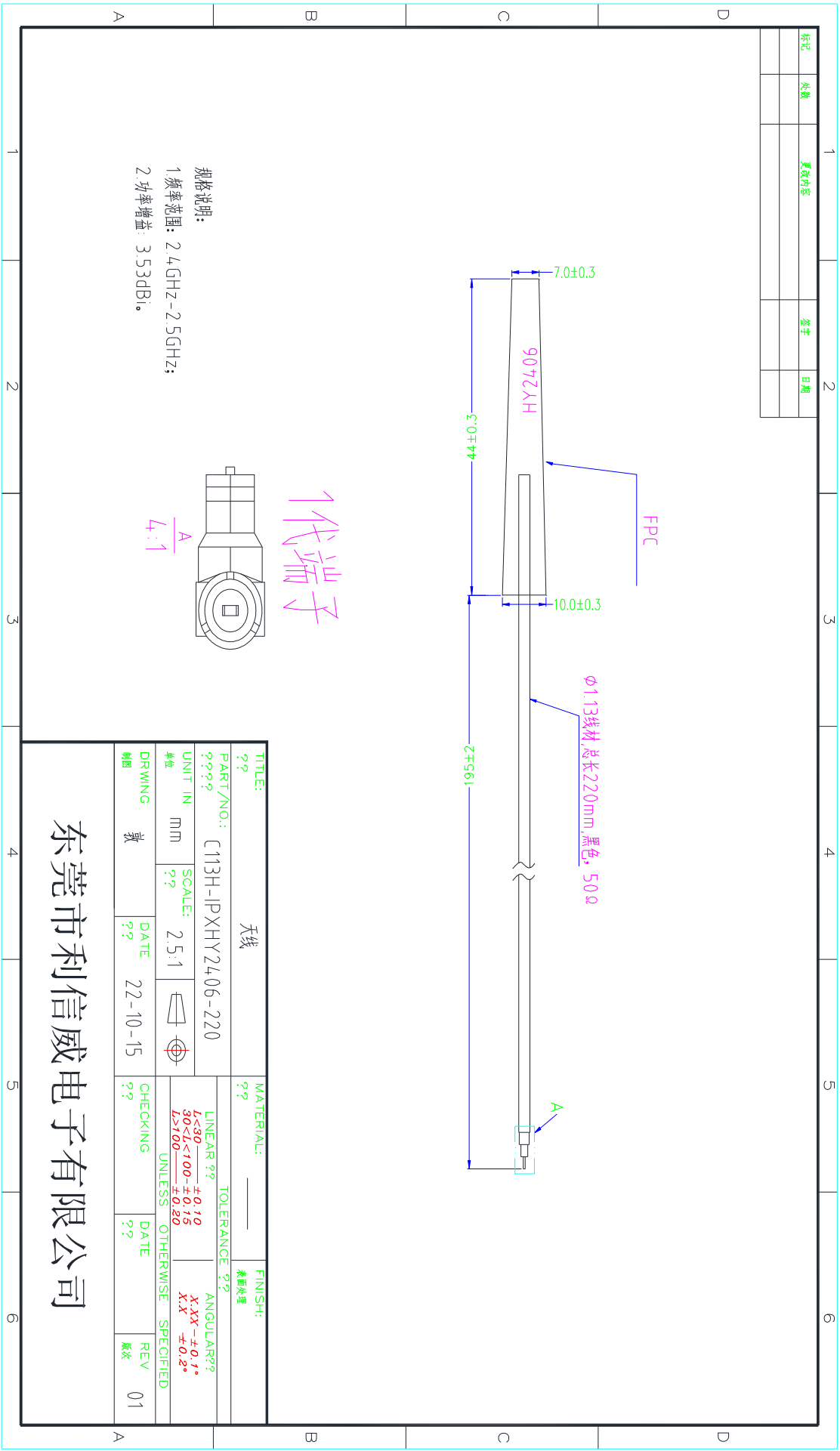

# Product Specification

## A. Electrical Characteristics

Frequency 2400MHz ~2500MHz

VSWR <2.0

Efficiency 81.71%

Impedance 50 Ohm

Polarization Line

Gain 3.53DBi

## B. Material & Mechanical Characteristics

Material of Radiator Cu

Cable Type 1.13 black

Connector Type : IPEX1

Dimension

## C. Environmental

Operation Temperature - 30 °C ~ + 80 °C

Storage Temperature - 30 °C ~ + 85 °C

## Test Equipment & Conditions

### 1. Network Analyzers :

Agilent 8753D 5071B

### 2. Communications Test Set:

Agilent E5515C

### 3. 3D Chamber Test System

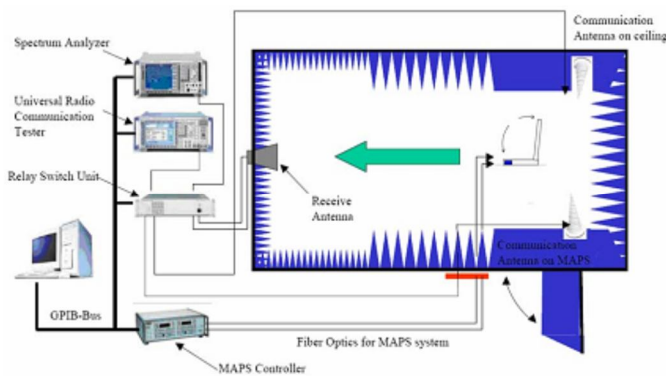

(Testing by 3D anechoic chamber)

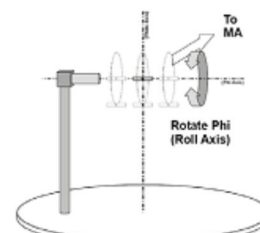

Phi axis test

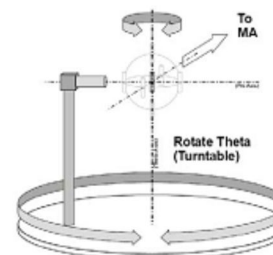

Theta axis test

# Efficiency & Gain

| Fre (MHz) | Eff (%) (dB) | Gain (dB) |
|-----------|--------------|-----------|
| 2400      | 80.93        | 3.43      |
| 2410      | 78.48        | 3.12      |
| 2420      | 76.86        | 2.96      |
| 2430      | 76.67        | 2.94      |
| 2440      | 76.86        | 3.08      |
| 2450      | 78.99        | 3.27      |
| 2460      | 80.22        | 3.28      |
| 2470      | 77.01        | 3.03      |
| 2480      | 79.32        | 3.2       |
| 2490      | 81.71        | 3.45      |
| 2500      | 80.38        | 3.53      |

# S11

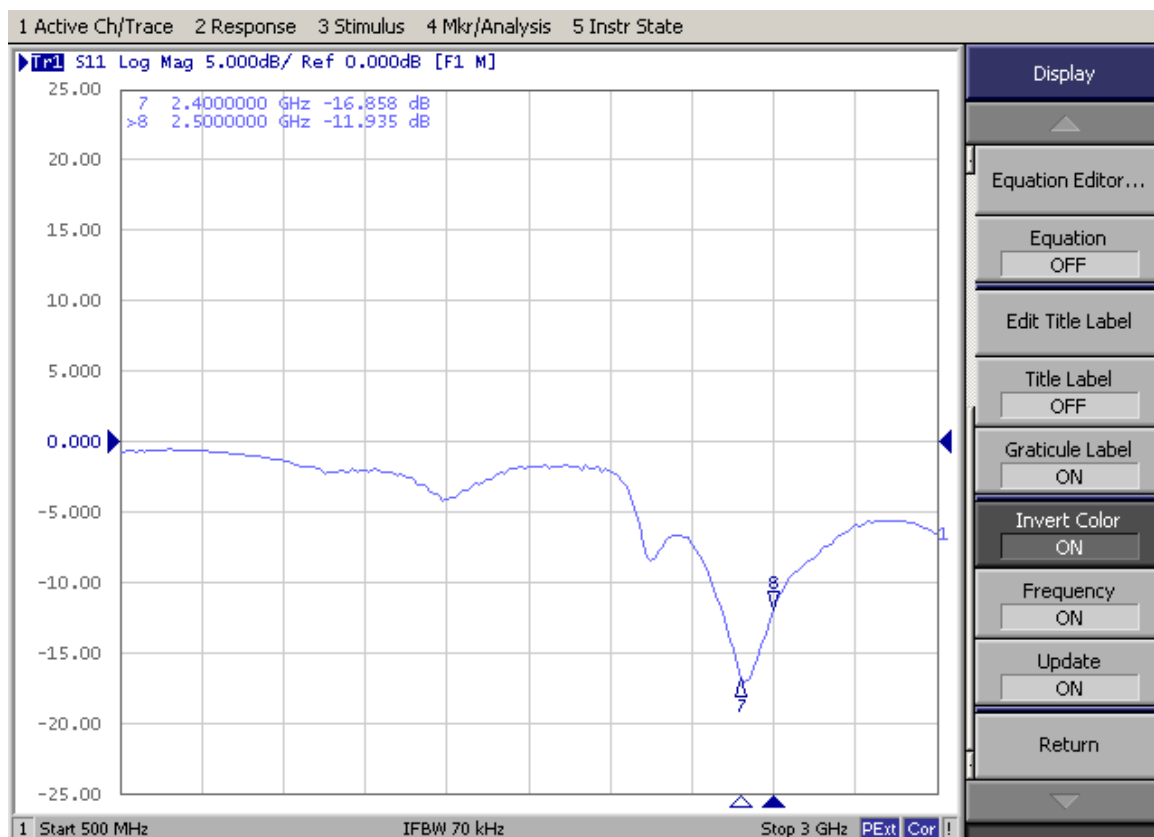

H face

2400

2450

2500

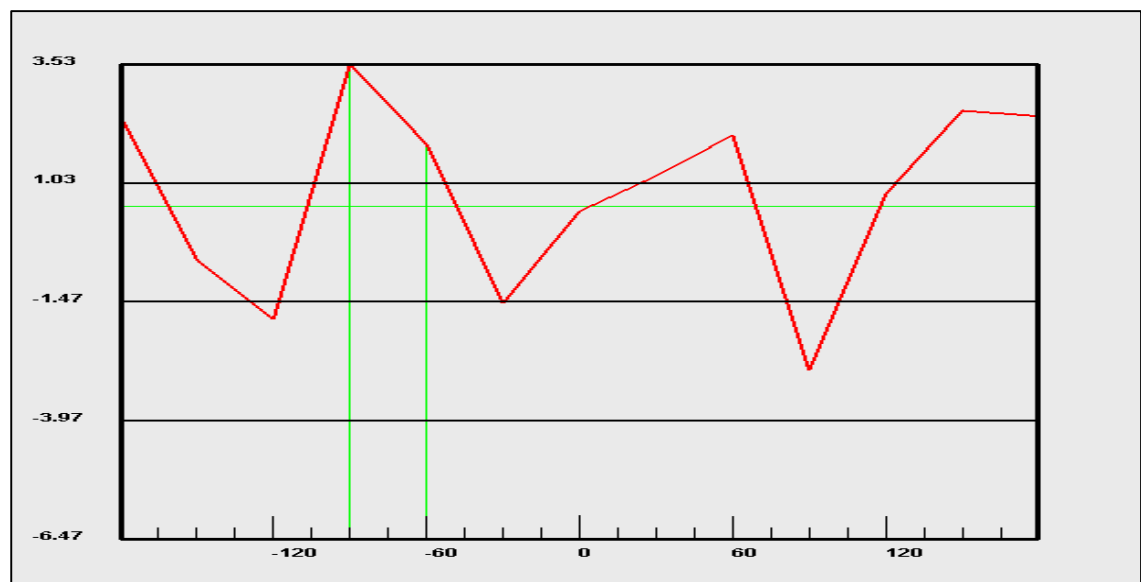
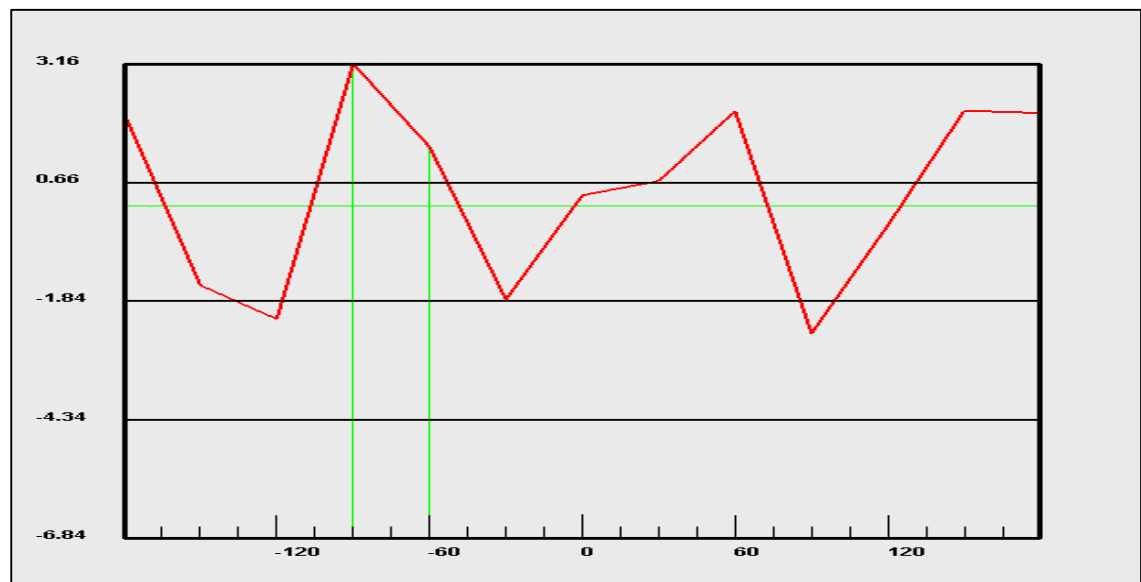
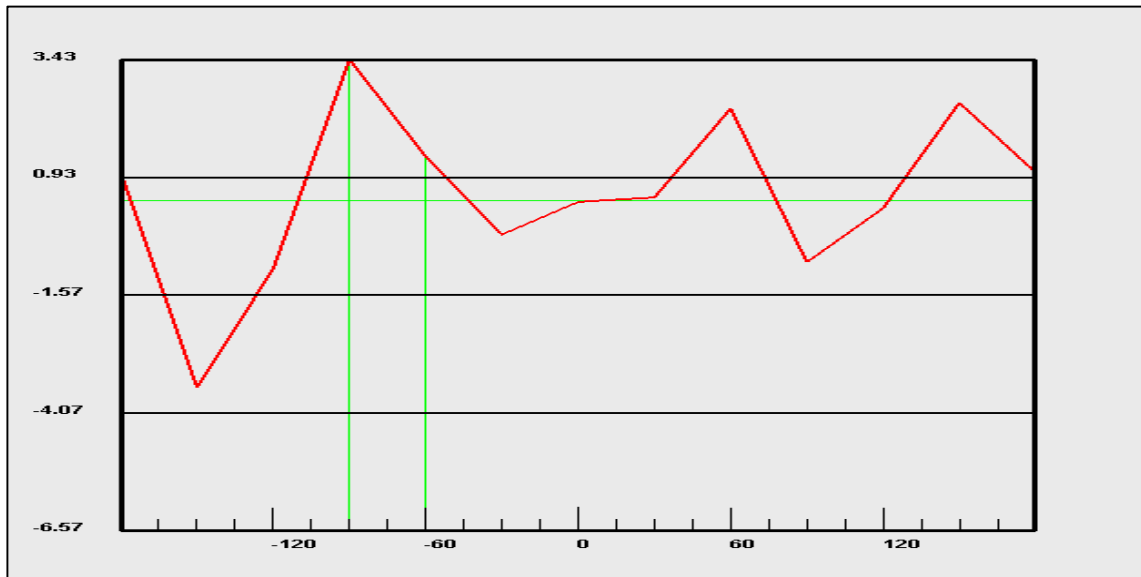

E1 face

2400

2450

2500

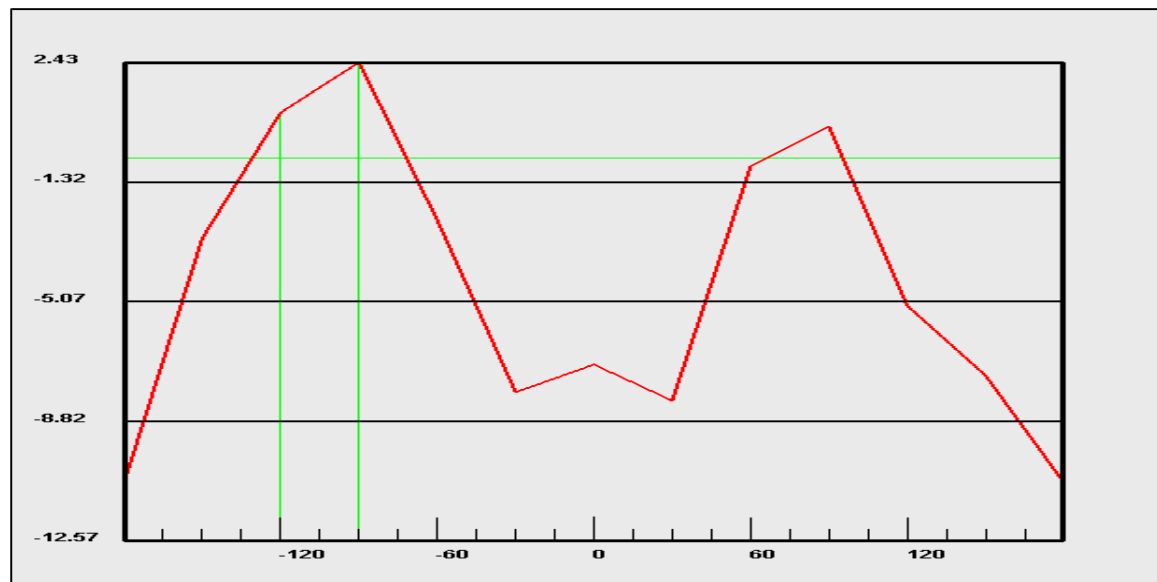
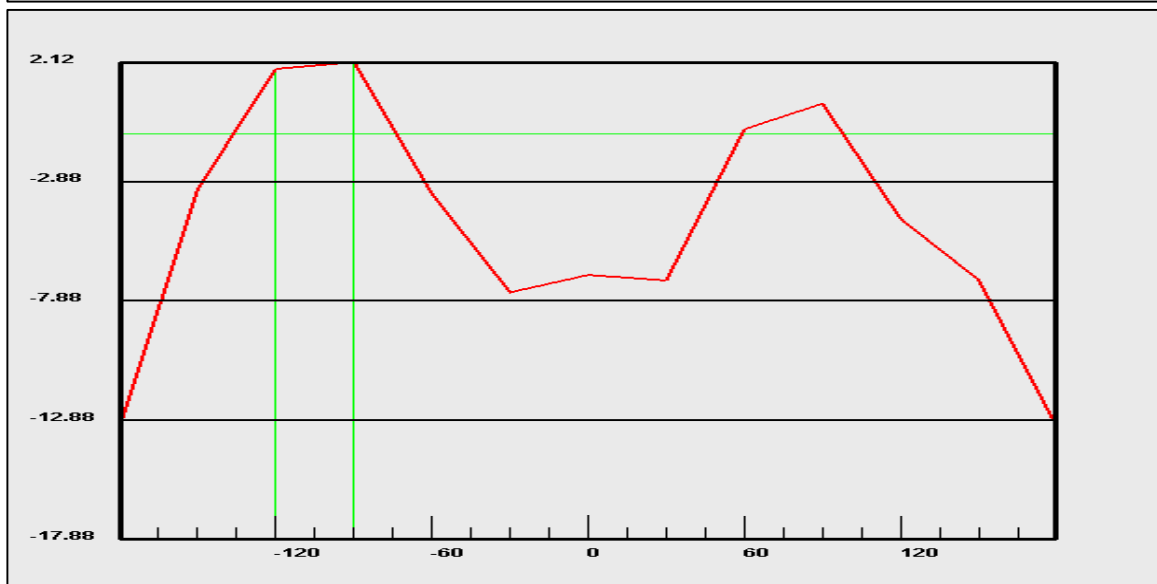
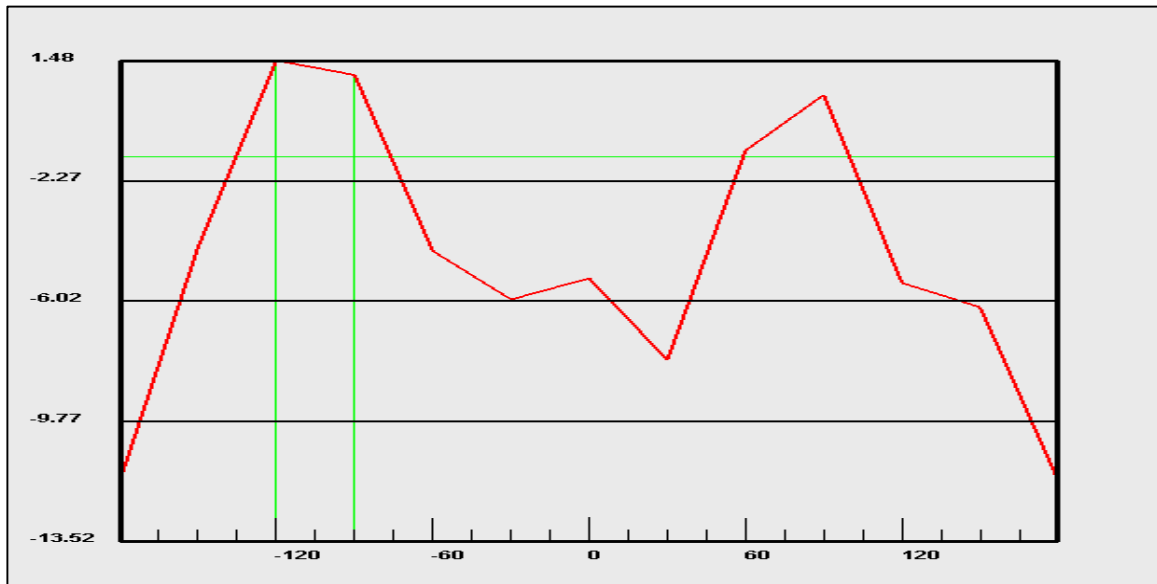

E2 face

2400

2450

2500

