

| | | | |
|---|---|---|---|
| 杆 | 杆 | 杆 | 杆 |
| 杆 | 杆 | 杆 | 杆 |
| 杆 | 杆 | 杆 | 杆 |
| 杆 | 杆 | 杆 | 杆 |

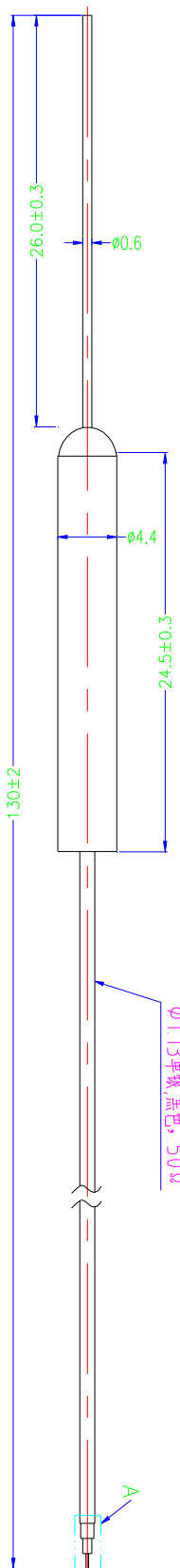

铜管，黄铜，镀锡-套管4.5×MM

∅13单银黑色，50Ω

规格说明：
1 频率范围：2.4GHz-2.5GHz；
2 功率增益：2.0dBi。

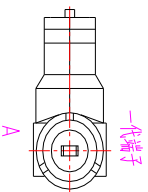

| | | | | | | | |
|----------|----------------------|----------|---------|----------------------------|----|--------------------|-------|
| TITLE: | 2.4GHz铜管天线 | | | MATERIAL: | 铜管 | FINISH: | 桶漆/喷油 |
| PARTNO.: | 130H-IPXBT44-26-130R | | | TOLERANCE: | 桶漆 | ANGULAR TOLERANCE: | 桶漆 |
| UNIT IN: | mm | SCALE: | 2.5:1 | LINEAR 桶漆 | | ANGULAR 桶漆 | |
| DRAWING | 数量 | DATE | 22-4-20 | 30<L<100 ±0.15 | | XX ±0.1° | |
| 秦气 | | CHECKING | 机气 | L>100 ±0.20 | | XX ±0.2° | |
| | | DATE | | UNLESS OTHERWISE SPECIFIED | | | |
| | | REV | 喉棒 | 01 | | | |

东莞市利信威电子有限公司

Product Specification

A. Electrical Characteristics

Frequency 2400MHz ~2500MHz

VSWR <2.0

Efficiency >75%

Impedance 50 Ohm

Polarization Line

Gain 2.97DBi

B. Material & Mechanical Characteristics

Material of Radiator Cu

Cable Type 1.13 黑色

Connector Type : IPEX1

Dimension

C. Environmental

Operation Temperature - 30 °C ~ + 80 °C

Storage Temperature - 30 °C ~ + 85 °C

Test Equipment & Conditions

1. Network Analyzers :

Agilent 8753D 5071B

2. Communications Test Set:

Agilent E5515C

3. 3D Chamber Test System

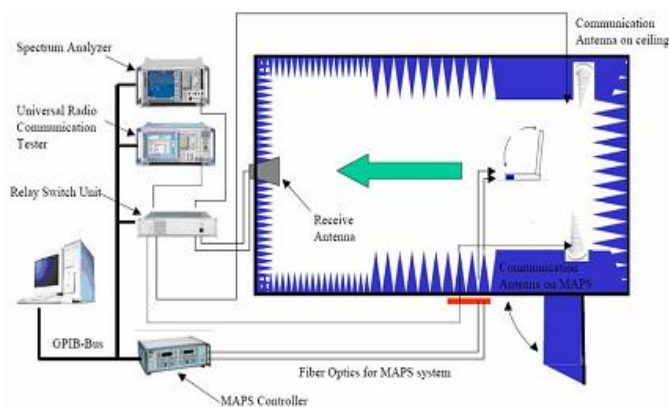

(Testing by 3D anechoic chamber)

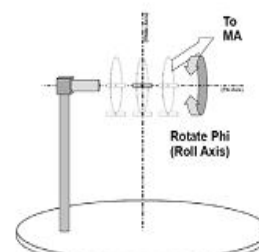

Phi axis test

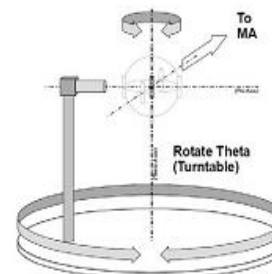

Theta axis test

Efficiency & Gain

| Freq (MHz) | Effi (%) | Gain (dBi) |
|------------|----------|------------|
| 2400 | 73.92 | 2.41 |
| 2410 | 73.73 | 2.87 |
| 2420 | 74.52 | 2.8 |
| 2430 | 72.42 | 2.97 |
| 2440 | 68.66 | 2.41 |
| 2450 | 71.22 | 2.72 |
| 2460 | 73.87 | 2.87 |
| 2470 | 72.94 | 2.81 |
| 2480 | 73.46 | 2.78 |
| 2490 | 68.51 | 2.73 |
| 2500 | 65.92 | 2.34 |

S11

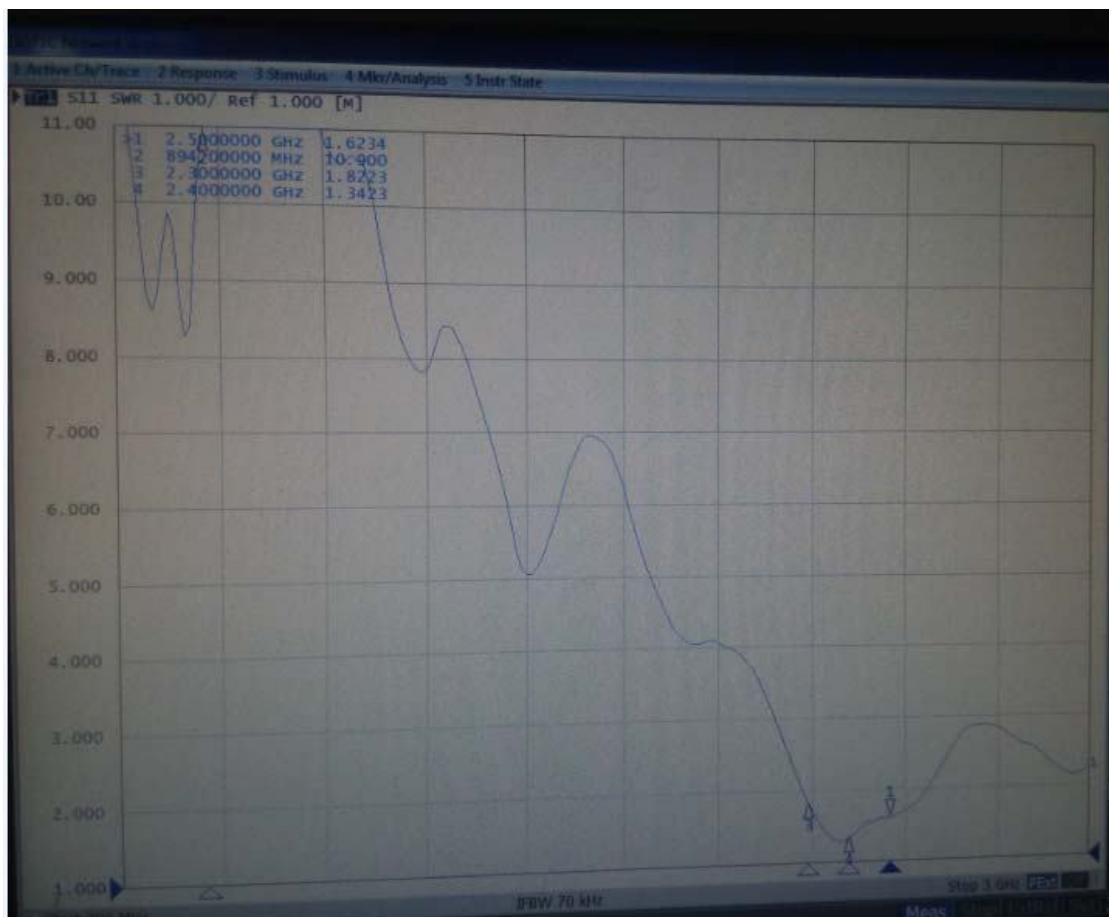

Radiation Pattern:

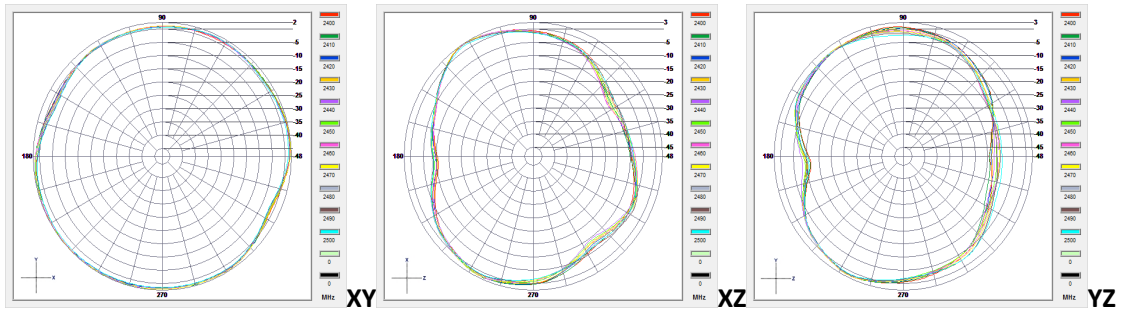

2400 2410 2420 2430 2440 2450 2460 2470 2480 2490 2500

