

Quick Start Guide

HD Network Camera

Wireless Camera RS-CH728H4C-WA28PW

1 Camera Connection Diagram

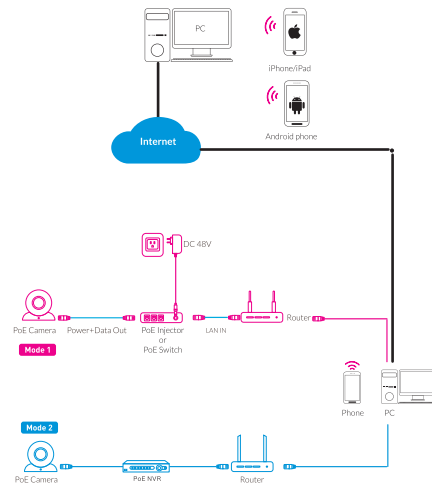

Attention: There are two connection modes:
1. For non-PoE router, pls connect the camera by a PoE switch or a PoE injector.
2. For a POE NVR, pls connect the camera directly to the POE NVR, then follow the below steps.

2 Installation

Bullet Camera Installation Ceiling Mounting

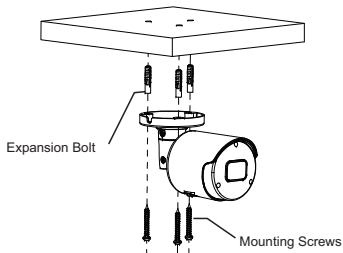

Insert three expansion bolts in place into the ceiling and fix the equipment with three mounting screws.

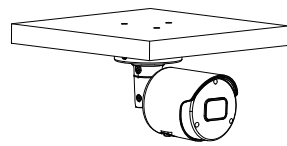

Completion of Installation

Dome Camera Installation Ceiling Mounting

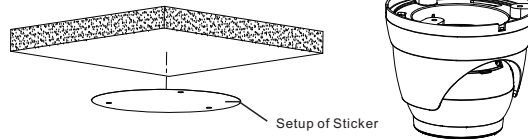

Paste the sticker in place at the proper position as selected.

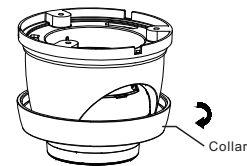

Remove the collar off the camera by rotating it down

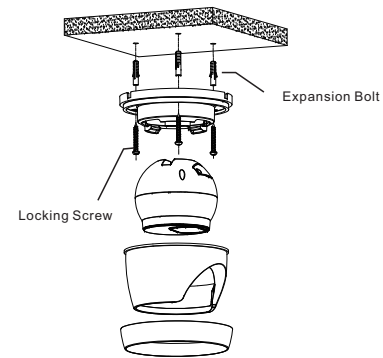

Fix the pedestal by drilling locking holes around the sticker and inserting three expansion bolts into the holes and fastening it with three locking screws.

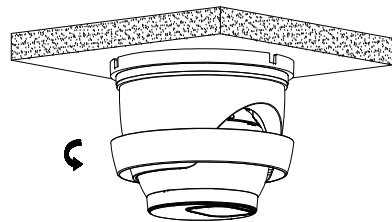

Mount the collar back by rotating it up

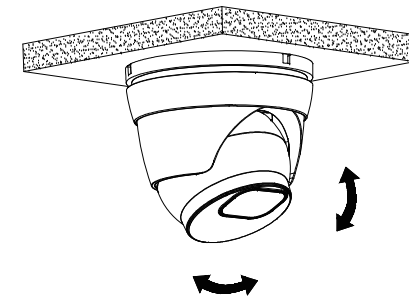

Adjust it to an appropriate angle.

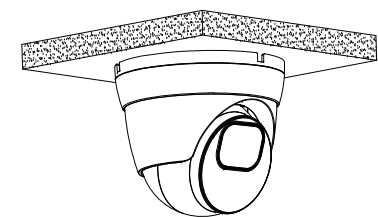

Completion of Installation

Vandal-Proof Dome Camera Installation Ceiling Mounting

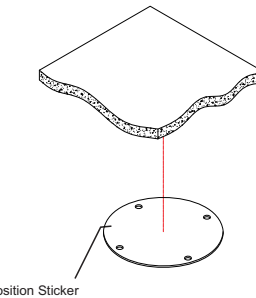

Apply the position sticker to the desired camera mounting position.

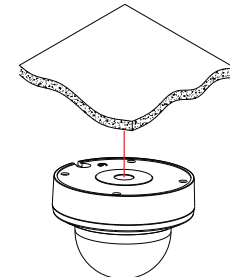

Cover Component

Remove the cover component by loosening the three locking screws with the included hex wrench.

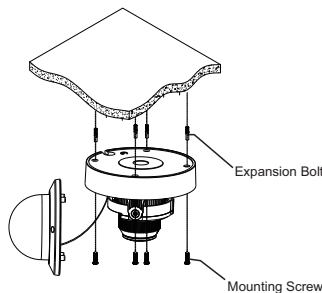

Use the position indicated on the position sticker to drill the holes needed to mount the camera base. Insert the expansion bolt into the holes. Match the base's mount openings to the expansion bolts position, then place the mounting screws through the base's mount opening into the expansion bolt. Tighten the mounting screws to ensure the camera base mounted securely.

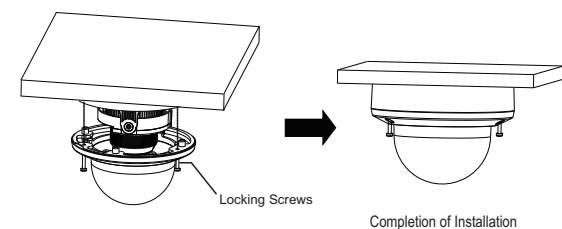

- ※ Place the cover component back onto the base.
- ※ Please make sure the locking screw position on the cover component matches the locking post on the base.
- ※ Tighten the locking screws after the cover component is in the correct position.

3 Install the APP

There are two methods to install the App.

- Search for "RXCamView" in App Store or Google Play.

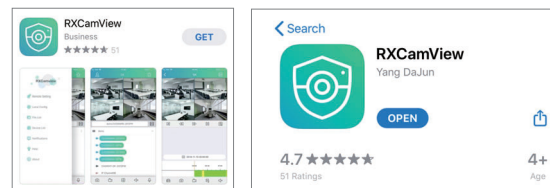

- Scan the QR code below to download the App.



4 Camera Settings

Open "RXCamView", you will see the following interface to add the cameras.

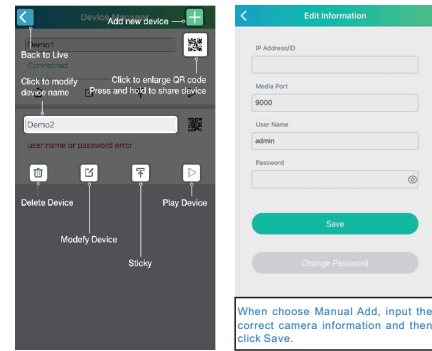
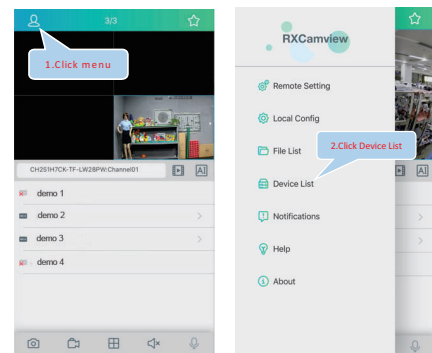

If add the device successfully, you will see the following interface.

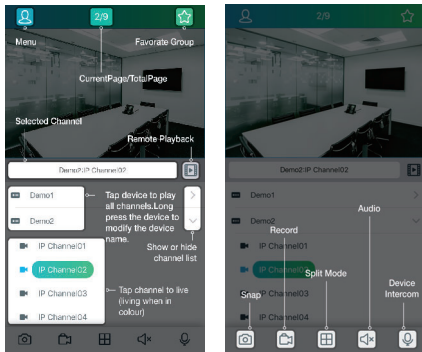

※ Please refer to "Help" section for more detailed instruction.

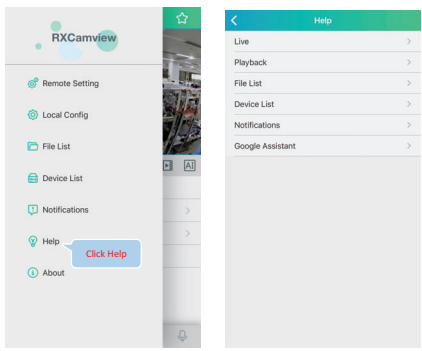

5 In Windows

1. log in the website www.al8.co and click "Device Search for Windows" to download "Device Config Tool", it will help to search all the available devices on your local network.

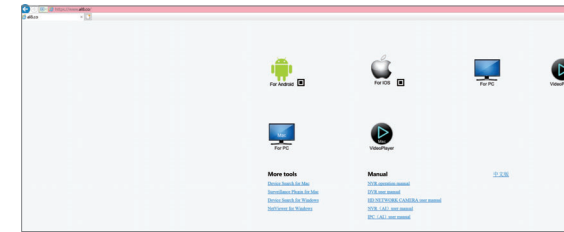

2. Under "Device Config Tool", you can modify the information of a selected device. Including IP, Media Port, Web Port, Gateway, Net Mask, Net Mode. (The default username & password is: admin & admin)

Device No.	IP	Media Port	Web Port	Channel	Device Name	Device Version	Net ID
2	192.168.0.2	8000	80	8	NET704	V2.2.0-179200	255.255
8	192.168.0.1	8000	80	1	CH04E0A	V2.1.3.1-160608	255.255
1	192.168.0.23	8000	80	8	8060-HEC	V2.2.0-179207	255.255
10	192.168.0.211	8000	80	1	IP-E0100R	V2.1.3.1-179110	255.255
7	192.168.0.252	8000	80	1	CH04E0A(BU)	V2.1.3.1-179110	255.255
13	192.168.0.253	8000	80	1	CH04E0A(BU)	V2.1.3.1-179110	255.255
4	192.168.0.254	8000	80	1	CH04E0A(BU)	V2.1.3.1-179110	255.255
6	192.168.0.255	8000	80	1	CH04E0A(BU)	V2.1.3.1-179110	255.255
19	192.168.0.256	8000	80	1	IP CAMERA	V1.1.1-160608	255.255
5	192.168.0.262	8000	80	4	CH04E0A(BU)	V2.1.3.1-179110	255.255
15	192.168.0.258	8000	80	1	IP CAMERA	V1.1.1-160608	255.255
6	192.168.0.258	8000	80	1	CH04E0A	V2.1.3.1-179121	255.255
14	192.168.0.259	8000	80	1	IP CAMERA	V1.1.1-160607	255.255

3. Open the Internet Explorer and input the device's IP address; Input the username & password in the following interface to login the device.

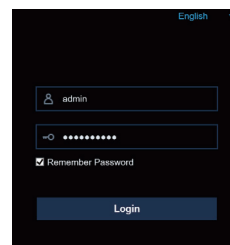

4. After login, click "Remote Setting" to change the setting.

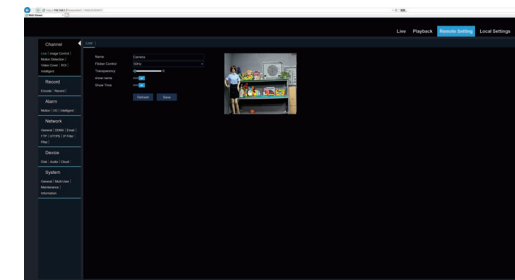

6 In MAC OS

1. Open your router web interface and login.
2. Find the "Attached device" or "Connected device" menu. Find the device's IP address according to its MAC address. The Mac address is labeled on the device.

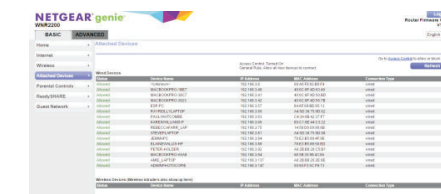

Picture for reference only

3. Input the device's IP address in Safari, login with your username & password.
4. After login, click "Remote Setting" to modify the setting.

FCC Statement

Changes or modifications not expressly approved by the party responsible for compliance could void the user's authority to operate the equipment. This equipment has been tested and found to comply with the limits for a Class B digital device, pursuant to Part 15 of the FCC Rules. These limits are designed to provide reasonable protection against harmful interference in a residential installation. This equipment generates uses and can radiate radio frequency energy and, if not installed and used in accordance with the instructions, may cause harmful interference to radio communications. However, there is no guarantee that interference will not occur in a particular installation. If this equipment does cause harmful interference to radio or television reception, which can be determined by turning the equipment off and on, the user is encouraged to try to correct the interference by one or more of the following measures:

- Reorient or relocate the receiving antenna.
- Increase the separation between the equipment and receiver.
- Connect the equipment into an outlet on a circuit different from that to which the receiver is connected.
- Consult the dealer or an experienced radio/TV technician for help.

This device complies with part 15 of the FCC rules. Operation is subject to the following two conditions (1) this device may not cause harmful interference, and (2) this device must accept any interference received, including interference that may cause undesired operation.

This equipment complies with FCC radiation exposure limits set forth for an uncontrolled environment. This equipment should be installed and operated with minimum distance 20cm between the radiator & your body