

## CONTENTS

- Gun Aware Firearm Sensor
- Gun Aware Magazine Charger
- Quick Start Guide
- AC Power Cord
- AC Power Adaptor
- Serial Number Reference Card

## SUPPORT

support@yardarmtech.com | 1-888-347-5155

YARDARM, YARDARM TECHNOLOGIES, YARDARM GUN AWARE and the Stylized Y logo are trademarks of Yardarm Technologies, Inc. and are used under license. All other trademarks are the property of their respective owners. © 2017 Yardarm Technologies, Inc. All rights reserved.

[www.yardarmtech.com](http://www.yardarmtech.com)

 Firearm Sensor FCC/IC Label  
FCC 2AJ3810232 / IC 22055-10232

Magazine Charger FCC/IC Label  
FCC ID: 2AJ3810199  
IC ID: 22055-10199

This device complies with Part 15 of the FCC Rules. Operation is subject to the following two conditions: (1) This device may not cause harmful interference, and (2) this device must accept any interference received, including interference that may cause undesired operation.

Le présent appareil est conforme aux CNR d'Industrie Canada applicables aux appareils radio exempts de licence. L'exploitation est autorisée aux deux conditions suivantes : (1) l'appareil ne doit pas produire de brouillage, et (2) l'utilisateur de l'appareil doit accepter tout brouillage radioélectrique subi, même si le brouillage est susceptible d'en compromettre le fonctionnement.

### INFORMATION TO USER

The users manual or instruction manual for an intentional or unintentional radiator shall caution the user that changes or modifications not expressly approved by the party responsible for compliance could void the user's authority to operate the equipment. In cases where the manual is provided only in a form other than paper, such as on a computer disk or over the Internet, the information required by this section may be included in the manual in that alternative form, provided the user can reasonably be expected to have the capability to access information in that form. The users manual or instruction manual for an intentional or unintentional radiator shall caution the user that changes or modifications not expressly approved by the party responsible for compliance could void the user's authority to operate the equipment. In cases where the manual is provided only in a form other than paper, such as on a computer disk or over the Internet, the information required by this section may be included in the manual in that alternative form, provided the user can reasonably be expected to have the capability to access information in that form.



# Gun Aware™

by Yardarm™



## Installing the Sensor

---



### Step 1

Remove the magazine from your firearm and clear the chamber before proceeding. Install Gun Aware in the weapon by firmly pressing the Sensor into the open space at the bottom of the grip.

*NOTE: Any Glock Modular Backstrap must be removed prior to installation.*



### Step 2

Insert the **Gun Aware Magazine Charger** and connect to power using the equipment included in the packaging. Both LED lights on the Charger should be on (one blue, one green).

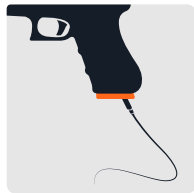

### Step 3

Charge for 8 hours prior to first use. See your administrator for more information.

## Pairing the Sensor

---

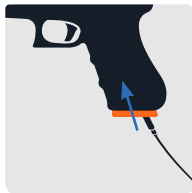

### Step 1

Insert **Charger** and connect to power and put the Sensor into pairing mode.



### Step 2

Open the Motorola PSX Cockpit app on your mobile device.

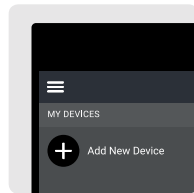

### Step 3

Tap 'Add New Device' and then select your Sensor based on its serial number.

*Note: Your serial number will appear as YA XXXXNN*



## To unpair

Use your mobile device's Bluetooth settings.