

**Infinix X682B**  
**User Manual (A)**

FCC ID: 2AIZN-X682B

INFINIX MOBILITY LIMITED



## Explosion diagram specification

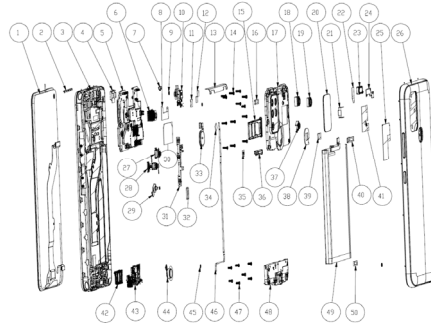

1	FL(CTP+LCM) 6.78HD+h	2	REC Deco partasm X682 Black
3	F hsg asm X682 Black	4	F CAM frame asm
5	PCBA MB	6	CAM AF 16M SSK3P9SX
7	Distance Sensor rubber	8	Shield Seal Cop foil X682 PA
9	Waterproof label paper 3mm RoHS	10	CAM FF 8M
11	R CAM Con foams microspur	12	REC con foam
13	TOP seal mylar	14	machine screw M1.4* L3.5*D2.5*H0.5 black
15	card holder asm X682	16	F CAM Con Sealrubber
17	LP frame X682	18	R CAM rubber X682 2M

			microspur Black
19	R CAM rubber X682 2M Grey	20	R CAM lens X682
21	MAIN CAM radiating Cop foil	22	F CAM con fb
23	REC_1206W_H20 9.4*3.5*0.75 black	24	FPC REC X682
25	Shield graphite film	26	Bat cover asm
27	CAM_FF_2M_OV2685	28	CAM_FF_2M_GC02M1B
29	CAM_FF_8W	30	Shield Seal Cop foil X682 BB
31	FPC Side key	32	Vignette R CAM Con Sealrubber
33	FM(SW9008)	34	R CAM Con foams 8W
35	BAT con imp steelAds	36	BAT con imp steel asm
37	R CAM rubber X682 8W Black	38	FP support PC slice
39	FP support PC slice	40	LCM FPCcon rubber
41	Shield Seal Cop foil X682 RF	42	Speaker
43	PCBA SUB	44	Vibräte
45	Fragile label paper 2.5mm general	46	coaxial cable
47	mc screw M1.4*12.5* D2.5*H0.5 silver glue	48	SPK frame asm
49	Battery	50	MAIN FPC con rubber

## Know your phone

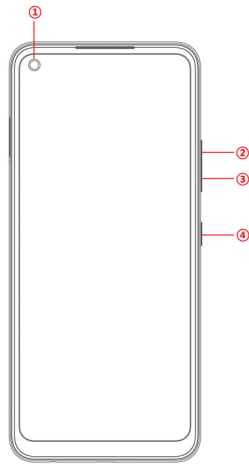

1. Front camera
2. Volume + key
3. Volume - key
4. Power key

## SIM/SD card installation

1. Power off mobile.
2. Refer to the following picture for SIM / SD card installation.

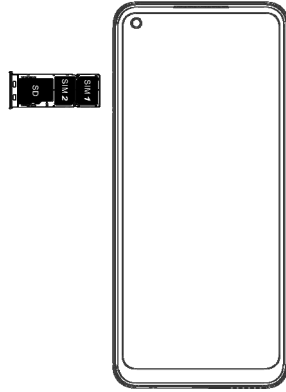

## Charging the phone

You can charge your device using a charger or by connecting it to the computer using a USB cable (comes with the phone).

1. Please remind the front and back of the plug.
2. Use only INFINIX charger and cables. Other chargers or cables may damage the device. This will invalidate your phone warranty.

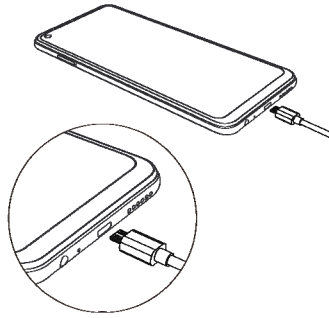

**Emergency call**

If any emergency arises, dial 112/911 (or other emergency call number) for emergency help.

Due to the nature of cellular networking, the success of emergency call is not guaranteed.

**FCC Warning:**

This device complies with part 15 of the FCC Rules. Operation is subject to the following two conditions: (1) This device may not cause harmful interference, and (2) this device must accept any interference received, including interference that may cause undesired operation.

Any Changes or modifications not expressly approved by the party responsible for compliance could void the user's authority to operate the equipment.

This equipment has been tested and found to comply with the limits for a Class B digital device, pursuant to part 15 of the FCC Rules. These limits are designed to provide reasonable protection against harmful interference in a residential installation. This equipment generates uses and can radiate radio frequency energy and, if not installed and used in accordance with the instructions, may cause harmful interference to radio communications. However, there is no guarantee that interference will not occur in a particular installation. If this equipment does cause harmful interference to radio or television reception, which can be determined by turning the equipment off and on, the user is encouraged to try to correct the interference by one or more of the following measures:

- Reorient or relocate the receiving antenna.
- Increase the separation between the equipment and receiver.
- Connect the equipment into an outlet on a circuit different from that to which the receiver is connected.
- Consult the dealer or an experienced radio/TV technician for help.

The SAR limit of USA (FCC) is 1.6 W/kg averaged over one gram of tissue. Device types X682B (FCC ID: 2AIZN-X682B) has also been tested against this SAR limit. The highest reported SAR values for head, body-worn accessory, and product specific (Hotspot) are 1.17 W/kg, 0.47 W/kg, and 0.54 W/kg respectively. The Max simultaneous SAR is 1.56 W/kg. This device was tested for typical body-worn operations with the back of the handset kept 10mm from the body. To maintain compliance with FCC RF exposure requirements, use accessories that maintain a 10mm separation distance between the user's body and the back of the handset. The use of belt clips, holsters and similar accessories should not contain metallic components in its assembly. The use of accessories that do not satisfy these requirements may not comply with FCC RF exposure requirements, and should be avoided.