

ISOtunes Free TWS Bluetooth Headset User Manual

Bluetooth headset should be used with the compatible devices which support Bluetooth wireless technology. This allows you to make two calls and enjoy the music streaming at any time freely. Please read this user manual carefully before using the headset, and also read your device's user manual regarding the Bluetooth function, and pay attention to those important safety and maintenance information. Please keep the headset away from children.

Specifications

Bluetooth Version :	V5.0
Bluetooth Profiles Supported :	HFP, HSP, A2DP, AVRCP
Audio Decoding Protocol :	SBC, AAC, APTX
Transmission Power :	Class 2
Operation Range :	Up to 10 meters
Frequency Range :	2.4GHz-2.48GHz
Battery of Headset :	45mAH Li-polymer Battery
Charging Voltage of Headset :	5V±0.2V
Charging Time of Headset :	About 1.5 hours
Battery of Base :	420mAH Li-polymer Battery
Charging Voltage of Base :	5V±0.2V
Charging Time of Base :	About 2hours
Charging Headset Times from	
Charging Base :	2-3 times
Music Playing Time :	≥ 7.0 hours
Talk Time :	≥ 7.0 hours
Standby Time :	About 100 hours
Driver :	φ6mm
Driver sensitivity :	90±3dB
Driver impedance :	16Ω±15%
Driver frequency ring range :	20HZ-20kHz
Dimensions of Charging	
Base(mm) :	L80×W33×H31
Dimensions of Headset(mm) :	L26×W16.6×H24.8
Weight(one headset) :	About 4.6g
Total Weight :	About 54g

*The time mentioned above may vary due to user's operation mode and device settings.

Structure Sketch

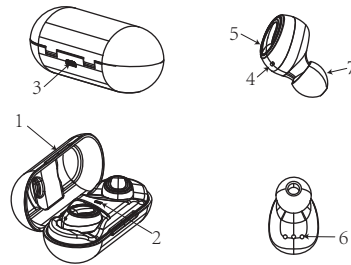

- 1) Charging Base Opening Snap
- 2) Charging Base Indicator
- 3) Micro USB Charging Port
- 4) Indicator and Mic Hole
- 5) MFB
- 6) Charging Pogo Pin
- 7) Ear Tips

Headset Mode

Status No.	Status	Charging Base Performance
1	The Single Pairing headset(R)	The indicator light of headset(R) flashes red and blue alternately
2	TWS Pairing Mode	After TWS pairing successful, the indicator light of right headset alternately flashing red and blue, when the right headset pairing successful with mobile phone, the indicator light flashes blue once every 5 seconds
3	Standby Mode	The indicator light of the headset flashes blue once every 5 seconds
4	Call Mode	When in a call, the indicator light of the headset flashes red every 5 seconds
5	Headset Charging Mode	The indicator light of the headset is red when being charged, and will turn off automatically after being fully charged
6	Power On State	The indicator light flashes blue for three times.
7	Power Off State	The indicator light flashes red for three times.
8	Low Voltage Alarm State	The indicator light flashes red once every 20 seconds

Charging Base Mode

Status No.	Status	Headset Performance
1	Charging Mode of the Charging Base	1.The indicator flashes red when being charged. The red will flash according times until the battery is up to the corresponding level. 2. No being charged or discharging to the earbuds, the indicator is off 3.The indicator light is red when being fully charged
2	Charging Base Battery Indication	The indicator flashing red once every 5 seconds means 25% battery, twice means 50%, 3 times means 75% and 4 times means full battery(100%).

Identify according to L&R and wear the headset (R) and headset (L) respectively



Wearing Steps:

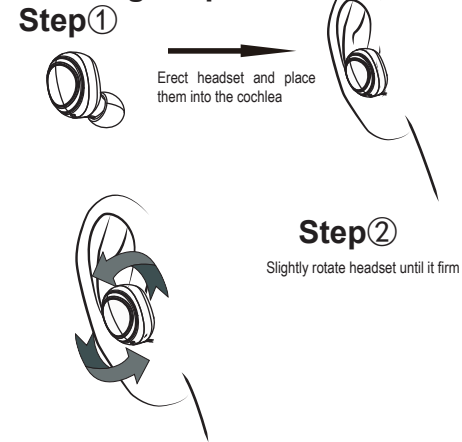

Step 3

Make the headset to cochlear edge tightly

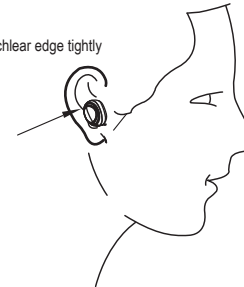

Charging Ways of Headset

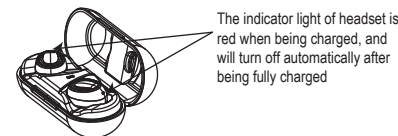

Put the headset (L) (R) to the corresponding position in the bottom of the charging base.

Charging Ways of Charging Base

Use the USB charging cable to charge
The red will flash according times until the battery is up to the corresponding level and will be always on when it is fully charged,

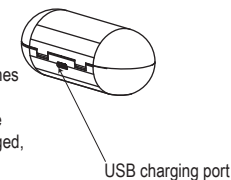

Use the USB cable to connect with computer

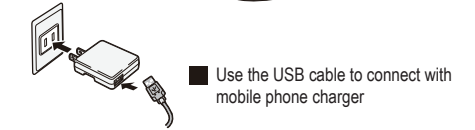
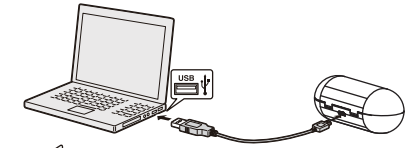

- Note 1: Check the charging device is suit to the headset or not.
 Note 2: Use only the supplied charger to charge the headset, if use other device may violate the validation or the maintenance article of this product and may cause danger.
 Note 3: Do not attempt to force open the built-in battery as this could damage the headset.
 Note 4: A fully charged headset will lose its power automatically if left unused. It is recommended to charge the headset each three months.
 Note 5: Do not leave the headset in a too hot or too cold condition (best between -10 C and 50 C) which may affect the headset's operations although it is fully charged.
 Note 6: Do not dispose of the headset into fire or water.

Turning ON/OFF

1 Method

Pick up the headsets from the charging base to turn on automatically. Put them back to power off and charge the headset.

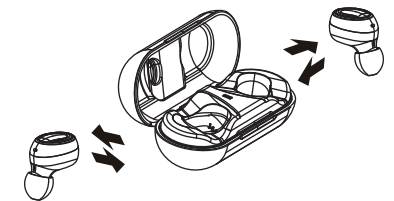

2 Method

In OFF MODE, press and hold headset(R) or headset(L) MFB for 2 seconds to turn on.
 In ON MODE, press and hold headset(R) or headset(L) MFB for 5 seconds to turn off.

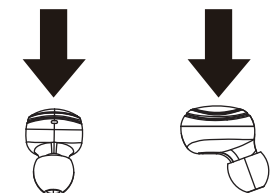

TWS Pairing

1

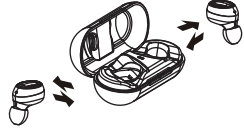

Pick up the two headsets from the charging base to power on and waiting about few seconds, the two headsets will enter auto-pairing mode. The two headsets connect with each other after few seconds, the headset (R) alternately flashing red and blue, and then open the phone's bluetooth device to search "iSOTunes Free-R".

Note: When the first time to pairing or after delete the pairing records, the headsets should be paired under 20cm unobstructed.

2

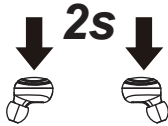

In OFF state, press MFB key for 2 seconds to power on and waiting for few seconds, the two headsets will enter auto-pairing mode. The two headsets connect with each other after few seconds, the headset (R) alternately flashing red and blue, and then open the phone's bluetooth device to search "iSOTunes Free-R".

Operate as the above ways: 1 or 2.

It prompts "Pairing successful" after TWS paired successfully. After TWS connection, the headset (R) enters the pairing mode with the phone and prompts "pairing".

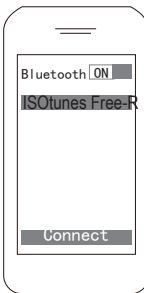

Cell phone begins to search for bluetooth devices (see the user guide of your phone instructions), and select "iSOTunes Free-R" from bluetooth device list, the right headset prompts "Pairing successful". the left and right headset prompts "dengdong", and the right headset prompts "Connected".

After the right headset paired with mobile phone successfully, the mobile phone will have a Bluetooth pairing request (iphone must be connected to the Bluetooth interface on the mobile phone), select the match, and the left headset prompts "paring successful". Unpairing headset(L) can't use master and slave function.

Note: When the headsets TWS pairing failures, double press the headset R and headset L to enter TWS pairing, then pair with phone.

Master-slave switching

The master and slave headset are automatically paired after being turned on. The right headset is default as master headset. When the master headset is placed in the charging box, the slave headset will automatically connect to the mobile phone and can be used continuously.

When the left headset is turn on first and reconnected with mobile phone, the left headset is the master headset; the right headset is the slave headset.

Note: Single connection instructions: TWS and mobile pairing records are required for single use.

TWS Reconnected

Method1: Press MFB of headset(R) or headset(L) for 2 seconds to power on wait for few seconds, the two headsets connect automatically, the headset pairs with the mobile phone that has ever paired after few seconds reconnected successfully.

Method2: Pick up the headsets from charging base to power on wait for few seconds, the two headsets connect automatically the headset pairs with the mobile phone that has ever paired after few seconds ,reconnected successfully.

Note: the right and left headset will prompt "Dengdong" after TWS reconnected successfully, the right headset prompts "connected" after reconnected with mobile phone successfully.

Answer /End a Call

When call incoming, short press MFB of headset (R) or headset (L) to answer the call ; In call mode, short press MFB of headset (R) or headset (L) to end the call when you hear "Call End".



Reject a call

Press and hold MFB of headset(R) or headset(L) for 2 seconds to reject the call, the speaker prompts "Doo, Call Reject".

Voice Dialing

On standby mode or music playing state, short press the MFB of headset(L). (This function only supports phone with voice dialing function)

Two-call Handling

(Only support the mobile phone which has the function of handling two phones.)

When you are answering a call, there is another call coming :

Long press and hold MFB for 2 seconds to end the current call and answer the incoming call;

Short press MFB to hold the current call and answer the incoming call;

After the second implementation, short press MFB to switch between two calls;

After the second implementation, long press MFB for 2 seconds to end the current call, and short press MFB to end the other call.

Note:All the above operations have to respect the preconditionssupported Bluetooth hands free profile V1.5 and Phones areholding function (Network services) from telecom.

Music Pause/Playing



In standby mode, shortly press MFB of headset(R) to play music. On music playing state, shortly press MFB of headset(R) to PAUSE music.

Volume +/-

In call mode or music playing mode, double click MFB of headset(R) to volume up; double click MFB of headset(L) to volume down, once "Doo" can be heard from headset R/L when volume is up to maximum or minimum.

Forward/Backward

In music playing mode, long press MFB of headset(R) for 2 seconds to next song; long press MFB of headset(L)for 2 seconds to previous song.

Delete Pairing Records on the Headset

In OFF mode, press MFB of headset(R) or headset(L) for 10 seconds(OFF MODE→On Mode (2 seconds)→Delete Pairing Records (10 seconds) until hearing "Doo" 3 times and indicators flash red and blue twice at the same time.

Maintenance

Do not use abrasive cleaning solvents to clean the headset.

Do not allow the headset to touch with any sharp objects as this will cause scratching and damages.

Please keep headset away from high-temperature, humidity and dust.

Trouble Shooting

Trouble	Reasons	Solutions
Can not turn on	low battery protection	Charging headsets for 1-2 hours
Can not turn on by picking up the headset.No indicator light when headset being charged	Charging base low battery protection	Charging both the headsets and charging base for 1-2 hours
No sounds after pairing	Wrong pairing	Pairing again
The two headsets TWS pairing failure/TWS paired successful but can not find the headset(R)	Too many pairing records	Delete pairing records
Charging base without indicator light when charging	DC power supply doesn't output power	Check whether the micro USB charging line is plugged well or not.
Headsets without indicator light when charging	The headsets couldn't being charged in charging base	1)Checking headset charging interface whether has touched to POSO PIN of correct or not. 2)Charging for charging base
Turning off automatically	Low battery	Charging headset for 1-2 hours
Headset echo	Volume is too loud or environment is noisy	Adjust the volume at phone change a place
Noise in call	Environmental interference caused or distance between headset and mobile is too far	Change a place or move the headset close to the mobile phone
Low voice of the calling party	Wearing headset is wrong	Adjusting wearing position of headset

NOTE: This equipment has been tested and found to comply with the limits for a Class B digital device, pursuant to part 15 of the FCC Rules. These limits are designed to provide reasonable protection against harmful interference in a residential installation. This equipment generates uses and can radiate radio frequency energy and, if not installed and used in accordance with the instructions, may cause harmful interference to radio communications. However, there is no guarantee that interference will not occur in a particular installation. If this equipment does cause harmful interference to radio or television reception, which can be determined by turning the equipment off and on, the user is encouraged to

try to correct the interference by one or more of the following measures:

- Reorient or relocate the receiving antenna.
- Increase the separation between the equipment and receiver.
- Connect the equipment into an outlet on a circuit different from that to which the receiver is connected.

- Consult the dealer or an experienced radio/TV technician for help

Changes or modifications not expressly approved by the party responsible for compliance could void the user's authority to operate the equipment.

This device complies with Part 15 of the FCC Rules. Operation is subject to the following two conditions:

- (1) this device may not cause harmful interference, and
- (2) this device must accept any interference received, including interference that may cause undesired operation.