

版本：V1.0
 修改时间：2023-6-16
 版本变更：
 料号：

成品尺寸：73x73mm
 颜色：1C+1C
 材质：128g哑粉纸，正反面过哑油
 页数：12P
 装订方式：风琴折

BS531J2A Quick Start Guide

Bluetooth Pairing

Open the case lid with the earbuds inside, the earbuds are ready for pairing. Turn on Bluetooth on your phone, search for "BS531J2A" from the device list to complete pairing.



Pick your ear tips

Proper size ear tips are very important for sound quality and comfort. Please try the ear tip of different sizes. Please note that different sizes of ear tips may be required for your left and right ears.

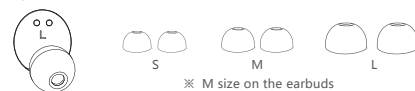

1

Touch Controls

No.	Function	Operation	Voice Prompt
1	Power On	3s / Open the case lid	Power on
2	Power Off	5s / Put the earbuds back into the case and close lid	Power off
3	Play/Pause	• × 2	
4	Volume +	• × 1 R	Volume to maximum "Di"
5	Volume -	• × 1 L	Volume to minimum "Di"
6	Previous song	More than 1.5s L	
7	Next song	More than 1.5s R	
8	Voice Assistants	• × 3	
9	Gaming Mode On/Off	• × 4	Low latency On/ Low latency Off
10	Answer/End calls	• × 2	
11	Reject calls	2s	

※ Volume up/down function can only be adjusted up to 8 frames by long press once. To adjust again, press and hold the MFB button for the second time.

Wearing way



2

Charging

Earbuds Charging

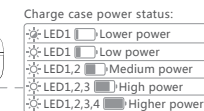
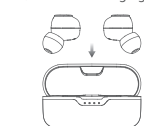

Charging case charging

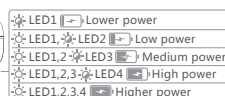
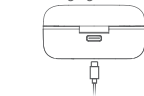

- ※ Indicator light always on ; The indicator flashes.
- ※ After the earphone is put into the charging case, the charging case shows the power status.
- ※ The first light on the left of the charging case is LED1, followed by LED2, LED3, LED4, a total of four lights
- ※ When the charging case is extremely low-energy, the charging case will stop charging the earphones, at that time you need to charge the charging case to charge the earphones.

Reset. keep the earphone in the off state, long press the MFB button for 8 seconds, the white light of the earphone blinks 6 times, restore factory settings successfully. After resetting, the earphone must be connected to the Bluetooth device again. Some Bluetooth devices may need to delete the pairing name of the original earphone to connect properly.

3

Specifications

Model	BS531J2A	Bluetooth version	V5.3
Bluetooth code	SBC,AAC	Working range	≥10米
Battery capacity (Earbuds)	40mAh Lithium Polymer	Battery capacity (Charging case)	400mAh Lithium Polymer
Input(Earbuds)	DC5 ±0.2V	Input(Charging case)	DC5 ±0.25V
Charging time (Earbuds)	≤1.5h	Charging time (Charging case)	≤2h
Charging case charging cycles	2-3cycles	Standby time	≥60h
Play time (music)	≥6.0h (50%volume)	Talk time	≥4.0h (50%volume)
Driver size	φ8mm	Frequency response	20Hz~20KHz
Earbud size(mm)	17.55x23.7 x24.4(±0.2)	Charging case size (mm)	62.26x32.85 x25.16(±0.2)
Weight (earbud)	approx 3.6g	Weight (whole set)	approx 33.8g
Operation temperature	0°C~45°C	Storage temperature	-20°C~60°C

※ Before charging, please check if the charging cable specification can meet the input voltage requirements of this product; please use the charging cable provided. It may violate the warranty clause of this product and cause product damage, if use the wrong charging cable. Due to the tolerance of different measurement tools, the size and weight may be different; according to the user's different habits and device settings, the above time may be different.

4

Trouble Shooting

Issues	Cause of issues	Solution
Don't turn on	Earbuds low battery level Not on the correct touch area to turn on-Charging case probe or earphone charging Copper column is stained	Charge the earbuds for 2-3h. Tap and hold for 2 seconds on the correct touch area on the earbuds Clean the charging ports on the earbuds and in the charging case
Cannot find the earbud's name on the Bluetooth device list	Too many records on earbuds	Do the factory reset and pair again
One earbud not working	Pairing failed	Do the factory reset and pair again
Echo on the call	The volume is too loud or the environment is too noisy	Turn down the volume or change to a quiet place
Hearing noise on earbuds	Environmental interference or the earphone is too far away from the device	Change place or move closer to the Bluetooth device
Tap not working well Tap control on panel invalid	Touch click, double click or triple click operation Too long / touch failure	Double or triple click requires 700 ms to complete operation / touch failure requires placing in charging case and picking up again
Low calling voice	Improperly wearing Bluetooth device volume too low	Make sure the earbuds fit snug in your ears. Turn up the Bluetooth device volume

5

Safety instructions

Read through the safety instructions before using the product. Electronic equipment

- Do not use this product in places where wireless devices are prohibited, otherwise it will interfere with other electronic devices or cause other hazards.

Medical and health care equipment

- Do not use this product in medical and health care places where wireless devices are prohibited, please follow the regulations of the places and turn off the product.
- The radio waves generated by the product may affect the normal operation of implantable medical devices or personal medical devices, such as pacemakers, Cochlear implants, hearing aids, etc.

If you use these medical devices, please consult their manufacturer for restrictions.

- When using this product, please keep at least 15cm away from the implanted medical devices (such as pacemakers, cochlear implants, etc.).

Hearing protection

- When you listen to music or make call with this product, it is recommended to use the minimum volume to avoid hearing damage. Long term use of high volume may cause permanent hearing loss.

Traffic safety

- Using high volume while driving may distract attention and cause accidents.
- The electronic equipment of the car may fail into work due to the radio interference of the product. Please contact the manufacturer for details.
- Wireless equipment may interfere with the flight system of the aircraft. Please comply with the relevant provisions of the airline on how to use this product on flight.

6

Battery safety

The product is equipped with a non removable built-in battery. Do not replace the battery by yourself to avoid damaging the battery or product. Dispose of used batteries according to local instructions.

- Do not disassemble or modify the battery, immerse in water or other liquids to avoid battery leakage, overheating, fire or explosion.
- Do not drop, squeeze or puncture the battery. Avoid exposing the battery to external pressure, which may cause internal short circuit and overheating of the battery.

Maintenance

- When the product is not in use, please put it back into the charging case for charging.
- Please charge the product every 3-6 months to avoid battery depletion due to long-time storage.
- Please keep the product and its accessories dry, and do not use external heating equipment such as microwave oven or hair dryer to dry them.
- Do not place the product and its accessories in areas where the temperature is too high or too low.
- Before cleaning and maintenance, please turn off the product and disconnect with the power source.
- Do not use chemicals, cleaning agents or detergents to clean the product or its accessories. Please use clean, dry soft cloth to do the clean.
- Do not disassemble or modify the product and its accessories without authorization, otherwise the equipment and accessories will not be covered by our warranty. Please contact the authorized service center in case of product broken.

Environmental protection

- Please comply with the local regulations on the disposal and the recycling.

7

Operating environment

- Do not use this product in a damp place or near the magnetic field.
- Please use the product within the temperature range of 0 ° C~45 ° C, and store the product and its accessories within the temperature range of - 20 ° C~40 ° C.
- Do not place the product in direct sunlight.
- Do not place the product close to heat sources or ignition sources, such as aseptic heaters, microwave ovens, ovens, water heaters, furnace fires, candles or other places where high temperatures may occur.

Child health

- Please keep the product away from children.
- Watch out for children swallowing.

Requirements for accessories

Only use the accessories approved by the product manufacturer and matched with this type of product. If other types of accessories are used, it may violate the warranty terms of the product and the relevant regulations of the country or region where the product is located, and may lead to accidents.

FCC ID:2AIXN-BS531J2A-1

8

Additional instructions

- This product conforms to a specific Bluetooth version and is not guaranteed to be compatible with the functions of all Bluetooth devices. Please consult the Bluetooth device instructions for compatibility and functions.
- When the operation is successful, the earbuds will emit a relevant prompt tone, but this prompt tone may be very small or can not be heard, which is normal.
- The above operations may be slightly different according to the instructions of paired Bluetooth devices.
- The Company has the final right to interpret the above terms.

NOTE: This equipment has been tested and found to comply with the limits for a Class B digital device, pursuant to part 15 of the FCC Rules. These limits are designed to provide reasonable protection against harmful interference in a residential installation. This equipment generates uses and can radiate radio frequency energy and, if not installed and used in accordance with the instructions, may cause harmful interference to radio communications. However, there is no guarantee that interference will not occur in a particular installation. If this equipment does cause harmful interference to radio or television reception, which can be determined by turning the equipment off and on, the user is encouraged to try to correct the interference by one or more of the following measures:

- Reorient or relocate the receiving antenna.
- Increase the separation between the equipment and receiver.
- Connect the equipment into an outlet on a circuit different from that to which the receiver is connected.
- Consult the dealer or an experienced radio/TV technician for help.

Changes or modifications not expressly approved by the party responsible for compliance could void the user's authority to operate the equipment.

NO . :BS531J2A 20230615SMS

9