



# HMDX Craze Sport Buds

## USER GUIDE AND WARRANTY INFORMATION

**HEY THERE!** Thank you for purchasing the **HMDX Dynamite**. Check out the sections below for all the important information about your new speaker.

### WE'RE HERE TO HELP. CONTACT US!

You've got questions? We've got answers. Contact a Customer Relations representative by phone, or email to help answer any questions. Please be sure to have the model number of your product available. (Hint: It's HX-EP270)

[Http://www.soundlv.cn](http://www.soundlv.cn)

**USA**  
 bobwang@soundlv.cn  
 Tel : +86 769-81518466-8013  
 Fax: +86 769-81619229

**CANADA**  
 cservice@homedicsgroup.ca  
 1.888.225.7378  
 8:30am-5:00pm EST M-F

### JUST CHARGE IT

Charging HMDX Craze Sport Buds is so easy you've probably figured it out by now, but just in case, you've got two options: you can charge it using your computer or a wall outlet. HMDX Craze Sport Buds need about 2 hours for up to 6 hours of play time.

1. The cord that came with HMDX Craze Sport Buds – the one with the USB on one end and the Micro USB on the other – will work with your computer.
2. If you want to use the wall outlet, you'll need to pick up a power cord with a Micro USB the next time you're at the store, or use any USB AC adapter, including the one for your cell.

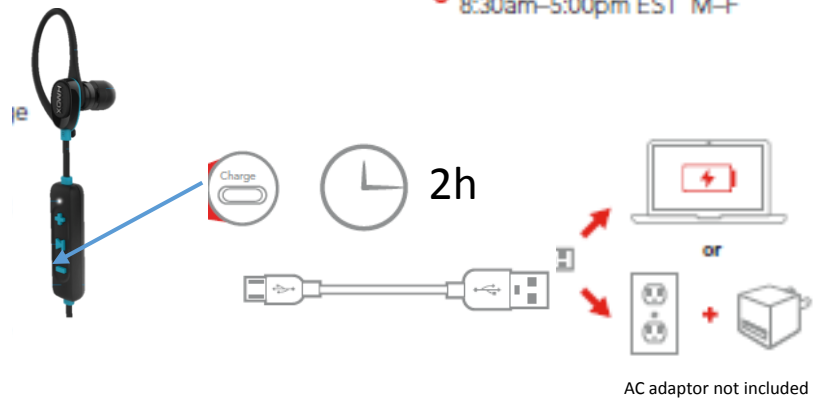

### CONTROL YOUR DESTINY... OR AT LEAST YOUR SPEAKER SHED SOME LIGHT



1. Push it to play, push it again to pause; press and hold for 4 seconds to power on
2. Turn the music up. (Press and hold to skip to the next track).
3. Turn the Music down. (Press and hold to move to the previous track).
4. Shows you when *Bluetooth* is connected. Let's you know how much juice is in your earbud.
5. Power cord goes here

What it looks like	What it Means
Flashing red	Low battery
Quick Flashing Blue	In Pairing Mode
Slow Flash Blue	Paired

### BLUETOOTH® CONNECTION – IT'S A SETUP

Like any amazing couple this one starts with a connection – one between your device and the earbuds' *Bluetooth*. Here's how it works:

1. Make sure the smartphone, tablet or computer you're using with the earbuds has *Bluetooth*.
2. Turn on the earbuds by pressing and holding POWER button for 4 seconds and look for the little blinking light.
3. Do whatever your device needs you to do on its end.
4. Look for HMDX Craze Sport in your device's *Bluetooth* list or click YES.
5. Now hit PLAY on your earbuds and crank it up- or down if you're lame.

The device and the *Bluetooth* will find each other every time just as long as the earbuds are set to *Bluetooth* and your device's *Bluetooth* is, you know, on.

If you're connecting to a computer, you may have some extra steps on that end. You'll have to get that information from the computer company.

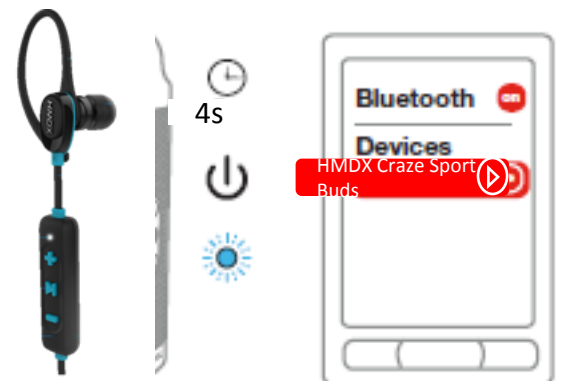

## BLUETOOTH CONNECTION, CONTINUED

Depending on your device you may be prompted to enter a pairing code. If prompted, enter "0000" as the code.

Press and hold the PLAY/PAUSE button 5 seconds to activate pairing mode.

Note: If you turn on your HMDX Craze Sport Buds but haven't started the party yet, it will automatically power off after 2 minutes of unpaired inactivity.

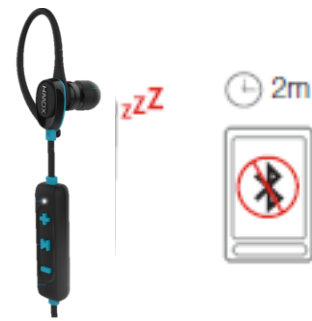

## LOOK MA, NO HANDS!

When friends call asking to join the party – and you know they will – answer the phone without disconnecting from HMDX Craze Sport Buds. Yes, that's right. Your HMDX Craze Sport Buds have hands – free calling too. How amazing is that? Here's how it works:

1. Make sure your phone and HMDX Craze Sport Buds are connected through Bluetooth.
2. Answering and ending a call works the same way: simply click the PLAY/PAUSE button on your HMDX Craze Sport Buds.

3. If you'd rather not talk, hold down the PLAY/PAUSE button on your HMDX Craze Sport Buds for 3 seconds to ignore the call. THE COOLEST PART: The HMDX Craze Sport Buds know when a call is coming in and pauses the music before ringing. When you hang up, the music starts where it left off – and so does the party. If it's you making the call, just start dialing from your phone, and HMDX Craze Sport Buds automatically does its hands-free calling thing. Isn't it refreshing to know your earbuds totally gets you?

Situation	Short Press Play/Pause Button	Long Press Play/Pause Button
1 <sup>st</sup> Incoming call	Pick-Up call	Reject call
On call	End call	Move call from speaker to device
2 <sup>nd</sup> Incoming call	Call 1 on Hold, Pick-Up call 2	Reject call 2
Both calls Active	Hang up call 1, Switch to call 2	Switch between 1 <sup>st</sup> call and 2 <sup>nd</sup> call

## LITTLE BIT OF SWEAT? NO WORRIES!

The smart folks who made these earbuds designed them to keep the party going through just about any activity. But hey, those designers aren't miracle workers. Doing something like sending your earbuds for a swim in the deep end will, at some point, fill those holes you need for incredible sound with water – and that's just not going to bode well for anyone or anything.

Working out? Not a problem. These earbuds are sweat resistant! But, remember to keep the top flap flush with the earbuds for the best protection.

## 1 YEAR LIMITED WARRANTY

For detailed warranty instructions and information visit:  
 USA: [www.hmdxaudio.com/customer-support/warranty-1yr](http://www.hmdxaudio.com/customer-support/warranty-1yr)  
 CAN: [www.hmdxaudio.ca/warranty-1yr](http://www.hmdxaudio.ca/warranty-1yr)

## COMING CLEAN

A soft, dry towel is all you need to clean off your speaker. Using water, harsh cleaners, or anything else only starts messing with the mechanics inside. So, yeah, don't do it.

To obtain warranty service on your HMDX product, contact a Consumer Relations representative by telephone or email for assistance (you can find their contact info on page 1). Please make sure to have the model number of the product available.

## STUFF OUR LAWYERS MAKE US SAY

### STUFF THE GOVERNMENT MAKES US SAY

#### FCC Disclaimer:

Note: This device complies with part 15 of the FCC Rules. Operation is subject to the following two conditions: (1) This device may not cause harmful interference, and (2) this device must accept any interference received, including interference that may cause undesired operation.

Note: This equipment has been tested and found to comply with the limits for a Class B digital device, pursuant to part 15 of the FCC Rules. These limits are designed to provide reasonable protection against harmful interference in a residential installation.

This equipment generates, uses, and can radiate radio frequency energy and, if not installed and used in accordance with the instructions, may cause harmful interference to radio communications. However, there is no guarantee that interference will not occur in a particular installation.

If this equipment does cause harmful interference to radio or television reception, which can be determined by turning the equipment off and on, the user is encouraged to try to correct the interference by one or more of the following measures:

- Reorient or relocate the receiving antenna.
- Increase the separation between the equipment and receiver.
- Connect the equipment into an outlet on a circuit different from that to which the receiver is connected.
- Consult the dealer or an experienced radio/TV technician for help.

Note: Changes or modifications not expressly approved by HMDX could void the user's authority to operate this equipment.

#### IC Caution: RSS-GEN Issue 4 December 2014

Le présent appareil est conforme aux CNR d'Industrie Canada applicables aux appareils radio exempts de licence. L'exploitation est autorisée aux deux conditions suivantes :  
 (1) l'appareil ne doit pas produire de brouillage, et  
 (2) l'utilisateur de l'appareil doit accepter tout brouillage radioélectrique subi, même si le brouillage est susceptible d'en compromettre le fonctionnement.

## STUFF OUR LAWYERS MAKE US SAY

#### IMPORTANT SAFEGUARDS:

When using an electrical product, basic precautions should always be followed, including the following:

#### READ ALL INSTRUCTIONS BEFORE USING

- WARNING: Do not place speakers too close to ears. May cause damage to eardrums, especially in young children.
- Use this product only for its intended use as described in this manual. Do not use attachments not recommended by HMDX.
- HMDX is not liable for any damage caused to smartphones, iPod/iPad/MP3 players, or any other device.
- Do not place or store this product where it can fall or be dropped into a tub or sink.
- Do not place or drop into water or any other liquid.
- Not for use by children. THIS IS NOT A TOY.
- Never operate this product if it has a damaged cord, plug, cable or housing.
- Keep away from heated surfaces.
- Only set on dry surfaces. Do not place on surface wet from water or cleaning solvents.

#### Attention California Residents:

**WARNING: This product contains chemicals known to the State of California to cause cancer, birth defects, and other reproductive harm.**

### A MESSAGE FROM THE ENVIRONMENT

#### WARNING:

This product has an internal, non-replaceable lithium battery. Please dispose in accordance with your local, state, province, and country guidelines.

This product contains small parts that may present a choking hazard for young children.

CAUTION: All servicing of this product must be performed by authorized HMDX Audio Service Personnel only.

