

# volkano<sup>®</sup>

Race Series

## **BLUETOOTH<sup>®</sup> SPORTS EARPHONES**



## **INSTRUCTION MANUAL**

*Please read these instructions carefully and retain for future reference.*

V1.2

VK-1008-BK/BL/RD/BKGN



## FEATURES

- Bluetooth®
- Walk and Talk
- Comfort Fit Ear Hooks

## SPECIFICATIONS

- Bluetooth®
  - Version: 5.0
  - Range: 10 m
- Battery Capacity: 100 mAh
- Charge Time: 2 Hours
- Play Time: 5 Hours
- Driver Size: Ø13 mm
- Sensitivity: 108 dB ± 3 dB

## WHAT'S IN THE BOX:

- Volcano Race Series Bluetooth® Sports Hook-In Earphones
- USB to Micro USB Charging Cable
- 3 x Sets Sized Ear Caps
- Instruction Manual

## IDENTIFYING PARTS

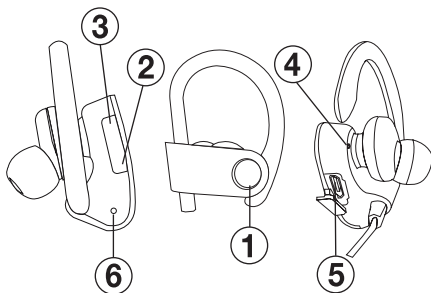

1. Multifunction Button (Answer, End, Reject Call, Play, Pause, On / Off)
2. Next Song / Volume Up
3. Previous Song / Volume Down
4. Microphone
5. USB Charging Port
6. Indicator Light

## CHARGING

Please ensure that the battery is fully charged before using the device for the first time.

- Connect the provided micro USB charge cable to the DC 5V charging slot on the earphones, connect the other end of the USB to a wall charger or an available USB port on a compatible device.
- The red LED indicator light will display in a solid light.
- When the earphones are fully charged, the LED indicator light will turn off.
- The red LED indicator light will flash when the battery is low.

## POWERING UP

- To switch on the device, press and hold the multifunction key for about 3 seconds until the red LED lights come on and start flashing.
- To switch off the device, press and hold the multifunction button for about 6 seconds until the red LED lights come on and go off.

## LOCATING THE BLUETOOTH MENU

### **iPhone, iPad, and iPod Touch:**

- a) On your device, go to Settings.
- b) Select Bluetooth®. If Bluetooth® is not on, turn it on.
- c) The iPhone / iPad / iPod will automatically search for new devices.

### **Android Phones and Tablets:**

- a) On your device, go to the Settings Menu.
- b) Select Bluetooth® (on older Android devices Bluetooth® is found in the Wireless and Networks Menu). If Bluetooth® is not on, turn it on.
- c) Select “Search for Devices” if your phone or tablet does not automatically search for new devices.

## CONNECTING WITH PAIRED DEVICES

Once the earphones are switched on, they will automatically connect with the last paired Bluetooth® device that is on and within range. If the earphones do not connect automatically, open the Bluetooth® Menu on your device and select “Race” from the Bluetooth® device list.

## BLUETOOTH PAIRING AND PLAYING MUSIC

- Ensure that the earphones are off before pairing them for the first time.
- Press and hold the multifunction key for about 3 seconds until the red LED lights come on and start flashing.
- This means the earphones are now ready to pair with your Bluetooth® device.
- Ensure that your device's Bluetooth® is on. Search for the device "Race". Confirm pairing by selecting the device from the list.
- If prompted for a password, enter "0000" on your device.
- When successfully paired, the blue LED light will flash twice every 4 seconds.
- The device is now ready to make/receive calls and playback music.
- To play the next or previous track, press the volume up/ next track selection or volume down/previous track selection
- To adjust the volume, press and hold the volume up/ next track selection or volume down / previous track selection accordingly
- To play or stop the music, press the multifunction key.
- To perform a quick disconnect, double press the volume up/ next track button and the headset will disconnect from the device you are playing from.

## CALLING FUNCTIONS

Answering a call:

To answer an incoming call, press the multi-function button once.  
The earphones will answer the call.

Rejecting a call:

To reject an incoming call, press and hold down the multi-function button,  
or use your mobile phone to reject the call.

Hang up a call:

To end a call, press the multifunction button once or use your mobile  
phone to end the call.

Redial the last dialed call:

While in standby mode, double click the multi-function button, the earphones  
will redial the last number dialed.

## **SAFETY PRECAUTIONS**

- Never use your earphones near water or in areas where it can come into contact with water. Never handle the earphones if they were dropped in water or any other liquid. If the product comes into contact with water while switched off, but still plugged in, this is a safety hazard.
- Always make sure your hands are dry before touching the plug or power connections.
- Do not operate the product with a damaged cord or plug, or after it malfunctions, has been dropped, or damaged in any manner.
- These earphones are not intended for use by children, or persons with reduced physical, sensory or mental capabilities, or lack of experience and knowledge, unless they have been given supervision or instruction concerning use of the device by a person responsible for their safety. Extreme caution must be exercised.
- Children should be supervised to ensure that they do not play with the earphones. Packaging must never be left within reach of children, as it is potentially dangerous.

## ENVIRONMENTALLY FRIENDLY DISPOSAL



Do not dispose of electrical appliances as unsorted municipal waste, use separate collection facilities. Contact your local government for information regarding the collection systems available. If electrical appliances are disposed of in landfills or dumps, hazardous substances can leak into the groundwater and get into the food chain, damaging your health and well-being.

	<p>This product can expose you to chemicals including lead, which is known to the State of California to cause cancer and reproductive harm. For more information, go to <a href="http://www.P65Warnings.ca.gov">www.P65Warnings.ca.gov</a>.</p>
<b>WARNING</b>	



## DISCLAIMER

All product and company names are trademarks™ or registered® trademarks of their respective holders. The use of them does not imply any affiliation with or endorsement by them.

## WARRANTY

The Volkano Race earphones come with a standard 12-month limited warranty against manufacturing defects and faults. Should your Volkano Race earphones be unboxed with any faulty parts, poor finishing or visible damage, or fail to perform due to a manufacturing defect or poor workmanship, please return it with your proof of purchase (till slip or invoice) to the store of purchase for an exchange, or repair, depending on the store's returns policy.

This warranty commences from the date of purchase.

Kindly retain your proof of purchase as well as the packaging for your warranty period.

### **NOTE:**

The warranty does not apply to a product that:

- a.) Has failed due to excessive wear and tear beyond what is considered to be reasonable.
- b.) Has been misused or neglected.
- c.) Has been damaged accidentally or by Force Majeure including fire and flooding.
- d.) Has been used or operated contrary to operating or maintenance instructions outlined in this manual.

The Store of Purchase / Seller cannot accept any returned products that have not been returned in accordance with this warranty or which does not follow their own Returns Policy. Please refer to the Store of Purchase / Sellers Returns Policy for details.

Should you require any further assistance or have any questions on your warranty, please contact the store of purchase.



**FCC Warning Statement**

Changes or modifications not expressly approved by the party responsible for compliance could void the user's authority to operate the equipment. This equipment has been tested and found to comply with the limits for a Class B digital device, pursuant to Part 15 of the FCC Rules. These limits are designed to provide reasonable protection against harmful interference in a residential installation. This equipment generates uses and can radiate radio frequency energy and, if not installed and used in accordance with the instructions, may cause harmful interference to radio communications. However, there is no guarantee that interference will not occur in a particular installation. If this equipment does cause harmful interference to radio or television reception, which can be determined by turning the equipment off and on, the user is encouraged to try to correct the interference by one or more of the following measures:

- Reorient or relocate the receiving antenna.
- Increase the separation between the equipment and receiver.
- Connect the equipment into an outlet on a circuit different from that to which the receiver is connected.
- Consult the dealer or an experienced radio/TV technician for help.